

# MEADOW GLEN SUBDIVISION PHASE 4

SITUATED IN THE VILLAGE OF MILLERSBURG  
 LOCATED IN LOT 36 OF THE FIRST QUARTER OF  
 T-9 N, R-7 W, HARDY TOWNSHIP, HOLMES COUNTY, OHIO

20210015254  
 B: 2 P: 620  
 FILED FOR RECORD IN  
 HOLMES COUNTY, OH  
 ANITA HALL, COUNTY RECORDER  
 05/11/2021 11:59 AM  
 PLAT LARGE . 86.40  
 PAGES: 1  
 CRV 276 PG 7389  
 CRV 276 PG 7402

## MASTER PLAT

THE PURPOSE OF THIS SURVEY

- ACTION 1) CONVEY NEW LOTS 1065, 1066, 1067, 1068, 1069, 1070, 1071, 1072, 1073, 1074, 1075, AND 1076  
 ACTION 2) CONVEY THE 0.780 ACRE PARCEL TO THE VILLAGE OF MILLERSBURG

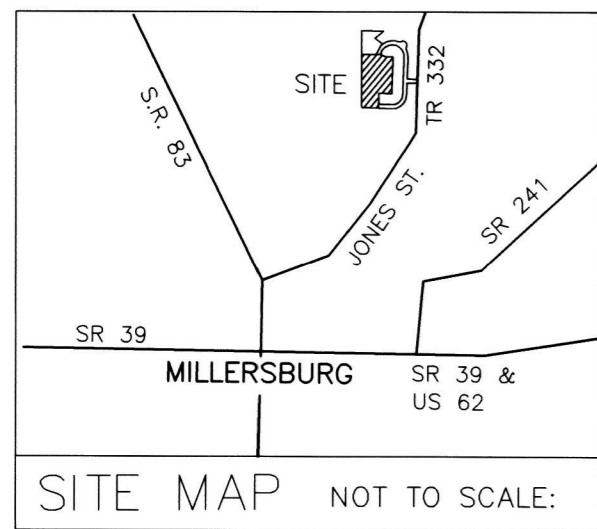

- 5/8" REBAR FOUND UNLESS OTHERWISE NOTED
- 5/8" REBAR SET WITH I.D. CAP I.D. CAP MARKED "BAKER SURVEYING LLC"

### REFERENCES

- O.R. VOL. 222 PAGE 3205
- O.R. VOL. 126 PAGE 250
- O.R. VOL. 270 PAGE 1725
- O.R. VOL. 272 PAGE 5567
- PLAT VOL. 2 PAGE 387
- PLAT VOL. 19 PAGE 2007
- PLAT VOL. 19 PAGE 3946
- PLAT VOL. 19 PAGE 3843

BEARINGS FROM OHIO STATE PLANE COORDINATE SYSTEM, NORTH ZONE, N.A.D. 83

AREA IN LOTS 4.235 ACRES  
 AREA IN ROAD DEDICATION 0.780 ACRES  
 TOTAL AREA IN ALLOTMENT 5.015 ACRES



NOTE: SIGN IN PERMANENT BLACK INK.

Know all men by these presents that we, the undersigned, Owners of the land shown on this plat have caused the same to be surveyed and replatted as shown and do hereby acknowledge the same to be our own free act and deed. We do hereby dedicate to public use the streets as shown hereon.

Witness our hands this 21st day of December 2020

OWNERS: Melissa Biltz, Sarah M. Roach  
 WITNESSES: Garrett M. Roach

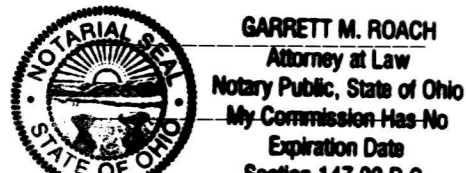

Before me, a Notary Public in and for said county and state, personally appeared the above named Owners, who acknowledge that they did sign the foregoing plat and that the same was their own free act and deed.

Signed and sealed this 21st day of December 2020

Sarah M. Roach, Notary Public, My Commission Expires NONE

CERTIFICATE OF APPROVAL FOR RECORDING  
 I hereby certify the subdivision shown hereon complies with the subdivision regulations of the Village of Millersburg, Ohio and that this plat is approved for recording in the office of the County Recorder.  
 This 6 day of January 2021  
 Nathan Troyer, Millersburg Planning Commission

CERTIFICATE OF ACCEPTANCE AND DEDICATION:  
 The subdivision as shown on this plat the streets and easements as noted in graphic symbols were accepted for dedication by the Council of the Village of Millersburg, by Ordinance 2021-101  
 This 26 day of April 2021  
 Karen Shaffer, Clerk of Village of Millersburg

Approved by the Village of Millersburg, Ohio.  
 This 26 day of April 2021  
 Devone Polen, President of Council

TRANSFER NOT NECESSARY  
 DATE May 11, 2021  
 AUDITOR Jacob M. Miller



I CERTIFY THIS SURVEY TO BE CORRECT TO THE BEST OF MY KNOWLEDGE.  
 Aaron L. Gerber, P.S. 8379  
 DATE: NOVEMBER 6, 2020  
 ALG  
 FILE NAME: WORKS\5-594-20 COMP.

BAKER SURVEYING, LLC  
 138 N. CLAY STREET  
 MILLERSBURG, OHIO 44654  
 PH. 330-674-4788  
 FAX 330-674-6027  
 EMAIL: bakersurveying@gmail.com

LOT 1033 MEADOW GLEN SUBDIVISION PHASE 1 (P. 2-387)  
 MEADOW GLEN HOMEOWNERS ASSOCIATION, INC.  
 O.R. 184-875

LOT 1032 MEADOW GLEN SUBDIVISION PHASE 1 (P. 2-387)