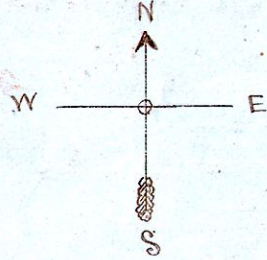
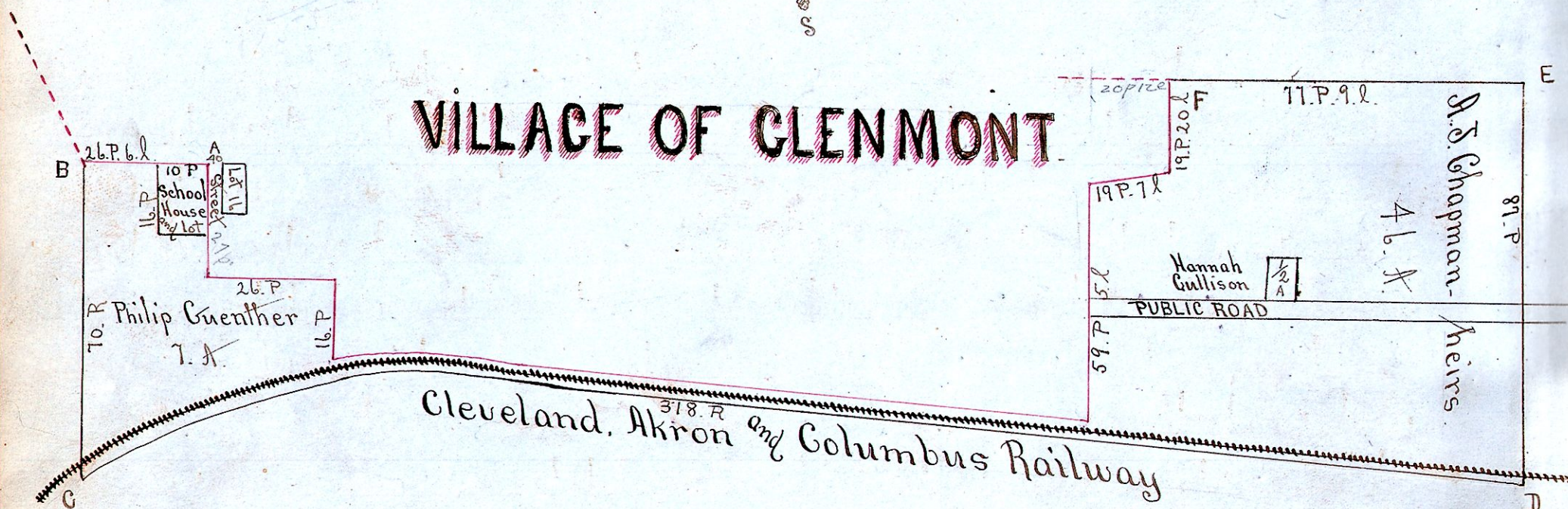

Exhibit "C"



VILLAGE OF GLENMONT



The red lines represent lines of the present corporate limits of the Village of Glenmont adjacent to land sought to be attached to the present corporate limits.

The above plat represents territory sought to be attached to the Village of Glenmont in Holmes County, Ohio.

The survey made was for the council of said village May 22, 1903.

A. H. Robinson,

county surveyor of Holmes County, O.

321

Certified copy of proceedings.

In the matter of the annexation of contiguous territory to the Incorporated Village of Glenmont, Ohio.

— Copy of petition —*—*

Before the Board of Commissioners of Holmes County, Ohio.

In the matter of the annexation of contiguous territory to the Incorporated Village of Glenmont, Ohio.

- Petition -

The undersigned petitioners represents that the council of the Incorporated Village of Glenmont, Holmes County, Ohio, did on the 1st day of June, 1903, at a meeting thereof, duly pass an ordinance authorizing that the contiguous territory herein-after described be annexed to said village and that the undersigned petitioner prosecute the necessary proceedings to effect the annexation of said territory to said village.

A copy of said ordinance containing an accurate description of said contiguous territory sought to be so annexed is hereto attached and made a part of this petition and marked Exhibit "A".

Your petitioner further represents that an accurate map of said contiguous territory accompanies this petition, is attached hereto and made a part hereof and marked Exhibit "B". Wherefore, your petitioner prays on behalf of said village that you take such proceedings in the premises as will cause said territory herein described to be annexed to the village of Glenmont.

W. S. Hanna,

Solicitor and agent of the Village of Glenmont in the premises.

Exhibit "A"

An ordinance authorizing the annexation of certain territory that is contiguous to the Incorporated Village of Glenmont, Holmes County, Ohio.

Section 1: Be it Ordained by the Council of the Village of Glenmont, in the county of Holmes and State of Ohio, that the following contiguous territory be and the same is hereby authorized to be annexed to said village of Glenmont, to wit: commencing at a post on the line of

said village as it is now incorporated forty feet west of the north west corner of lot number 16 of said village; thence west 26 perches and 6 links to a post; thence south seventy perches to a post on the south line of the right of way of The Cleveland, Akron and Columbus Railway Company; thence easterly along the south line of said right of way of said Railway Company, 318 perches to a post on the east line of lands belonging to the Chapman heirs; thence north 93 perches to a post; thence west 77 perches and 9 links to a post; thence south 19 perches and 20 links to a post; thence in a westerly direction along the present line of said village as incorporated 17 perches and 7 links to a post; thence south 59 perches and 5 links to the north line of the right of way of The Cleveland, Akron and Columbus Railway Company; thence west along the north line of said right of way of said Railway Company to a post where the west line of said village as incorporated meets said right of way of said Railway Company; thence north 16 perches to a post; thence west 28 perches to a post; thence north 24 perches and 8 links to the place of beginning.

Section= 2: That W. S. Hanna, Solicitor of said Village be and he is hereby directed, authorized and empowered to prosecute the proceedings necessary to effect such annexation and do all things pertaining thereto, in pursuance to the statute in such case made and provided.

Section= 3: This ordinance shall take effect and be in force from and after its passage and publication as required by law.

Wm. Vogel, Clerk.

George L. Robinson, Mayor.

Copy of Journal Entries.

Before the Board of Commissioners of Holmes County, Ohio.
In the matter of the annexation of certain contiguous Territory
to the Incorporated Village of Glenmont, Ohio.

—*— Journal Entry —*—

This 7th day of September, 1903, this board being in regular session, a petition to annex certain contiguous Territory to the Incorporated Village of Glenmont, Holmes County, Ohio, was presented to this board, and upon consideration of the same, said petition is ordered filed by the Auditor of said county, in his office, for the inspection of all interested persons.

It is further ordered that said petition be for hearing before us at our office in the Court House in Millersburg, Ohio, on Monday the 2nd day of November, 1903, at two o'clock P. M. and it is further ordered that W. S. Hanna, Solicitor and agent for said Village of Glenmont, cause notices of the time and place of said hearing to be published and posted as is provided by law in such cases.

T. M. Deetz.

B. G. Fisher.

Levi Shaffer.

Commissioners of Holmes Co., O.

Before the Board of Commissioners of Holmes County, Ohio.
In the matter of the annexation of certain contiguous
territory to the Incorporated Village of Glenmont, Ohio.

—*— Journal Entry —*—

This matter came on to be heard, on the 2nd day of November, 1903, on the petition and application, accompanying plat and the evidence in pursuance to the notice heretofore ordered to be given by this Board of Commissioners at a regular session thereof, on the 7th day of September, 1903, when said petition and application and accompanying plat were ordered filed, and upon consideration the Board of Commissioners finds that notice of the time and place of the hearing of the petition and application herein were duly given as provided by law by being published in the Holmes County Farmer, a paper printed in and of general circulation in said

Holmes bounty, for six consecutive weeks prior to this date, and commencing on September 10th 1903, and that a copy of said notice was posted in a conspicuous place on the territory sought to be annexed herein on the 12th day of September, 1903, the same being more than six weeks prior to this date; that proofs of the publication of said notice and the posting of the copy of the same are duly filed herein.

The Board of commissioners further finds that the statements contained in the petition and application herein are true; that the council of the Incorporated Village of Glenmont, on the 1st day of June, 1903, duly passed an ordinance authorizing the annexation of the territory in the petition described to said village; that said territory is contiguous; that the petition contains an accurate description of said territory and is accompanied by an accurate plat of the same; that the petition was filed by the duly authorized agent of said Incorporated Village, and it seems right and proper that the prayer of said petition be granted.

It is therefore ordered that the territory described in said petition and application, to wit:

commencing at a post on the line of said village as it is now incorporated forty feet west of the north west corner of lot number 16 of said village; thence west 26 perches and 6 links to a post; thence south 70 perches to a post on the south line of the right of way of the Cleveland, Akron and Columbus Railway company; thence easterly along the south line of said right of way of said Railway company, 318 perches to a post on the east line of lands belonging to the Chapman heirs; thence north 93 perches to a post; thence west 77 perches and 9 links to a post; thence south 19 perches and 20 links to a post; thence in a westerly direction along the present line of said village as incorporated, 17 perches and 7 links to a post; thence south 59 perches and 5 links to the north line of the right of way of the Cleveland, Akron and Columbus Railway company; thence west along the north line of said right of way of said Railway company to a post

where the west line of said village as incorporated meets said right of way of said Railway company; thence north 24 perches and 8 links to the place of beginning, be and the same is hereby annexed to the Incorporated Village of Glenmont, Ohio, for all the uses and purposes of said Incorporated Village, and it is further ordered that a certified transcript of the orders and findings of the Board of Commissioners in this matter, together with the original petition and the accompanying plat be forwarded to, deposited with, and filed by the clerk of said Incorporated Village of Glenmont.

P. M. Deetz.
B. C. Fisher.
Levi Shaffer.

Commissioners of Holmes Co. Ohio.

"An Ordinance"

Accepting the application for the annexation of certain contiguous territory to the Incorporated Village of Glenmont Holmes county, Ohio.

Whereas on the 1st day of June, 1903, this council passed an ordinance authorizing the annexation of certain contiguous territory to this village, and therein appointed W. S. Hanna to prosecute the proceedings necessary to affect the annexation, and Whereas said W. S. Hanna filed his petition with an accompanying plat of the proposed territory to be annexed with the commissioners of Holmes county, Ohio, at their regular September session, 1903; that said commissioners thereupon fixed the hearing of said petition for November 2nd, 1903, and notice was duly given to all interested parties of the time and place of said hearing that such proceedings were had thereon that on said 2nd day of November, 1903, granted the prayer of said petition, and ordered that said proposed territory described in said petition be annexed to this village and Whereas the final transcript of the proceedings of said commissioners in said matter, together with the petition and the accompanying map were deposited with the clerk

of this village as is provided by law, on the 8th day of November, 1903 and more than sixty days having elapsed since said time, and the certificate of said clerk having been presented to this council that he had received no notice from any interested person that further proceedings were enjoined, therefore,

Sec-1: Be it ordained by the council of the Incorporated Village of Glenmont, Ohio. that the territory described in said petition and accompanying map and proposed to be annexed to this village be and the same is hereby accepted, and said territory is hereby annexed to said village as is provided by law, in such cases, for all the purposes and uses of said Municipal corporation.

Sec. 2: That the clerk of this village cause two copies of the petition, plat transcript of the proceedings of the commissioners and the ordinances in relation to said annexation together with his certificate to each that each copy is correct, and deliver one to the Recorder of Holmes county, Ohio. and forward one to the Secretary of State of the State of Ohio.

Sec. 3: This ordinance shall be in full force and effect from and after its passage and publication as provided by law.

George Reese, clerk.
George L. Robinson, Mayor.

The State of Ohio, Holmes county }
Incorporated Village of Glenmont } ss:

I, George Reese, clerk of said village, hereby certify that the foregoing is a true and correct copy of the petition, plat and transcript of the proceedings had before the commissioners of said county. the ordinances duly passed by said village, and all in relation to the annexation of the territory described in the petition to said Incorporated Village of Glenmont, Holmes county, Ohio.

Witness my signature and the seal of my office this 15th day of February, 1904.

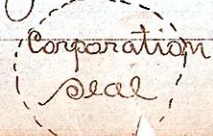

Geo. T. Rees, clerk of the Incorporated Village of Glenmont, Holmes county, Ohio.

Received for record at 3 P.M. Feby 17" 1904.

Recorded at 10 A.M. Feby 19" 1904.

A. A. Uhl

Recorder