

VILLAGE OF MILLERSBURG
 PART OF LOTS 805 & 824
 LAKEVIEW ADDITION
 (P.2-38)

HARDY TOWNSHIP
 S.E. & S.W. QTRS. SECTION 11
 T-9 N; R-7 W
 HOLMES COUNTY OHIO
 SURVEYED FOR: TOM MILLER

REFERENCES

DEED VOL. 151 PAGE 356
 DEED VOL. 160 PAGE 400
 DEED VOL. 255 PAGE 354
 O.R. VOL. 165 PAGE 225
 O.R. VOL. 170 PAGE 2445
 O.R. VOL. 171 PAGE 1713
 O.R. VOL. 173 PAGE 3005

PLAT VOL. 5 PAGE 160
 PLAT VOL. 7 PAGE 549
 PLAT VOL. 8 PAGES 23, 181 & 278
 PLAT VOL. 89 PAGE 211
 PLAT VOL. 10 PAGE 34
 PLAT VOL. 15 PAGE 93
 PLAT VOL. 16 PAGES 601, 823 & 882

SURVEY RECORD 5 PAGE 124
 BEARINGS FROM PLAT VOL. 16 PAGE 823

CHURCH OF CHRIST OF MILLERSBURG
 D.V. 151-356

WILLIAM G. &
 KAREN F. CONKLE
 D.V. 181-24
 D.V. 196-168
 D.V. 207-773
 D.V. 229-824
 O.R. 171-1713

D.V. 181-24
 D.V. 196-168
 D.V. 207-773
 D.V. 229-824
 O.R. 230-176
 O.R. 171-1713

$\Delta = 03^{\circ}22'22''$
 $R = 1509.73'$
 $L = 88.87'$
 $T = 44.45'$
 $C \text{ LEN} = 88.86'$
 $\text{BRG} = N 80^{\circ}10'15'' W$

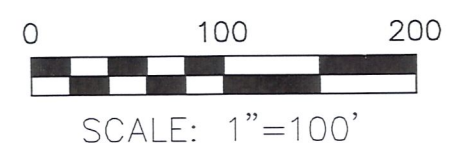

- STONE FOUND
- ▲ R.R. SPIKE FOUND
- 5/8" REBAR FOUND
- UNLESS OTHERWISE NOTED
- 5/8" REBAR SET WITH I.D. CAP
- I.D. CAP MARKED "BAKER 6938"

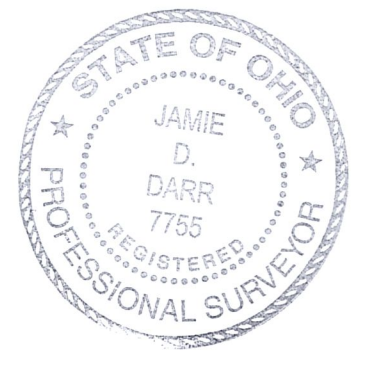

I CERTIFY THIS SURVEY TO BE CORRECT
 TO THE BEST OF MY KNOWLEDGE.

JAMIE D. DARR P.S. 7755
 DATE: DEC. 20, 2005
 JDD\ERZ-ALG
 FILE NAME: WORK3\S-413-05\ERZ
 REVISED JANUARY 20, 2006

DONALD C. BAKER SURVEYING
 138 N. CLAY STREET
 MILLERSBURG, OHIO 44654
 PH. 330-674-4788
 FAX 330-674-6027