

BEARINGS EST. FROM
SUR. PLAT 14/560

- LEGEND:**
- = STONE FOUND
 - = IRON PIN/PIPE FOUND
 - = POINT-OF-DEPARTURE
 - = 5/8" X 30" RE-BAR W/I.D. CAP SET
 - ⊞ = RAILROAD SPIKE SET
 - △ = R/R SPIKE FOUND

REFERENCE DOCUMENTS:
TAX MAP
DEEDS AS SHOWN
SURVEY PLATS:
14/4

I CERTIFY THIS TO BE A TRUE PLAT OF A FIELD
SURVEY COMPLETED ON JUNE 9, 1995:
SURVEY PLAT UPDATED OCTOBER 19, 2001.

JIM SHAMP, REG. SUR. NO. S-6088

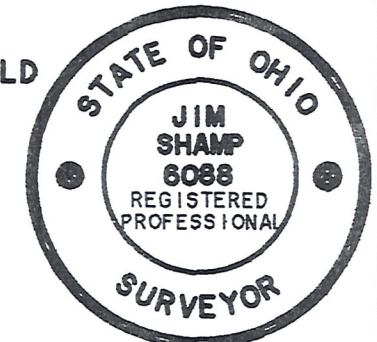

HEARTLAND Surveying			
Jim Shamp			
5210 Twp. Rd. 257		Millersburg, OH 44654	
Phone: 216-674-4698			
SURVEY		DATE	
THOMAS BIRD		JUNE 12, 1995 REVISED: OCT. 19, 2001	
STATE	COUNTY	TOWNSHIP	RANGE
OHIO	HOLMES	HARDY	7 WEST
TOWNSHIP	VILLAGE OF MILLERSBURG		CRD
9 NORTH			94/11 94/229 5/95 950614.PL

