

Legend

- - Iron Pin Found- 5/8" rebar (unless shown otherwise)
- - Stone Found
- - Iron Pin Set- 5/8" x 30" solid reinforcing bars with plastic identification cap.

Curve Data

#	Radius	Arc	Chord	Tangent	Central Angle
1	301.55'	64.64'	N. 66°39'51" E. 64.52'	32.44'	12°16'56"

Pertinent Documents

Deeds as shown, tax map, and survey plats prepared Donald C. Baker, Reg. Surv. #6938, for Willis Dean Chanay dated July 28, 1993, for Mike Patterson dated October 24, 1996, and for Conrad Miller dated December 4, 1997.

BOUNDARY SURVEY

FOR

Bart H. Mohler

Situated in the N.E. Qtr. of Section 18, T 8N, R 7W, U.S.M.L.
Killbuck Township, Holmes County, Ohio

Being part of the property conveyed to Willis Dean & Martha Chanay as recorded in Deed Volume 176, page 702.

Bearing Reference

The bearings shown on this plat are based on the bearings in the deed to Bart H. & Janice L. Mohler as recorded in Deed Volume 261, page 858.

Willis Dean & Martha Chanay
D.V. 176-702

Russell E. & Lydia Madison
D.V. 256-1023

200100006976
Filed for Record in
HOLMES COUNTY, OH
SALLY MILLER
03-14-2001 03:08 pm.
SMALL PLAT 20.00
OR Book 17 Page 811 - 811
OR vol 69 pg 584

INDEXED

Bart H. & Janice L. Mohler
D.V. 261-858

200100006976
PAUL A.
MILLER LAW
MILLERSBURG,

13.3099 Ac.

Certification

I hereby certify this plat to be true and accurate based on an actual field survey made under my supervision during January of 2001.

James M. Matchett
Hitchens & Associates

by: James M. Matchett, Reg. Surveyor #7975
January 24, 2001

job #2014-12-00

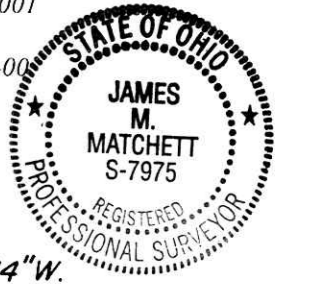

N. 86°07'44"W.
13.89'

PLAT APPROVED

3/14/2001 B

