

0.95 acre

INDEXED

9600004283
 Filed for Record in
 HOLMES COUNTY, OH
 SALLY MILLER
 On 11-08-1996 At 11:05 am.
 PLSM 20.00
 Vol. 16 Page 273
 of 276 page 121

0.62 acre tract surveyed in 1965

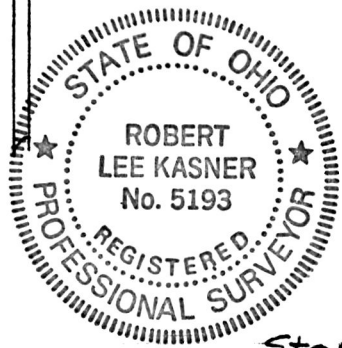

Stone at the Southeast corner
 of Lot 4, 1st Qtr. Twn. 9 & R. 5

- Indicates Iron Pin (Set)
- Indicates Iron Pin Set 1965

9600004283
 JUDSON C SCHULER ATTY
 MILLERSBURG,

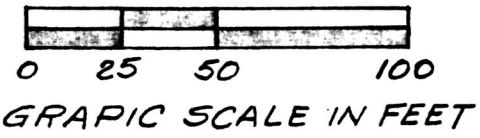

PLAT of SURVEY
 FOR BEN & KATE WEAVER
 known as part of the East
 Half of Lot 4, 1st Qtr. Twn. 9 &
 R. 5. Walnut Creek Twn.,
 Holmes Co., Ohio.
 Robert Lee Kasner
 Registered Surveyor #5193

PLAT APPROVED

9/24/68

11/7/96