

I CERTIFY THIS TO BE A TRUE PLAT OF A FIELD SURVEY COMPLETED ON MARCH 25, 1994:

# HEARTLAND Surveying

Jim Shamp  
5210 Twp. Rd. 257 Millersburg, OH 44654  
Phone: 216-674-4698

SURVEY			DATE
JOHNNY MILLER JR.			APRIL 4, 1994
STATE	COUNTY	TOWNSHIP	RANGE
OHIO	HOLMES	PRAIRIE	13 WEST
TOWNSHIP		SECTIONS 25 & 26	
14 NORTH			

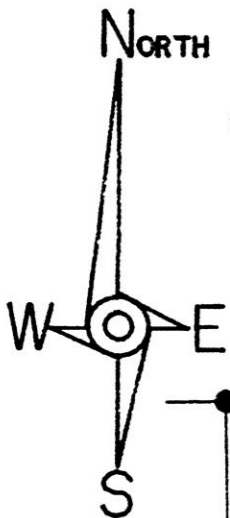

\* BEARINGS ESTABLISHED FROM SURVEY PLAT V. 12, P. 972

JIM SHAMP, REG. SUR. NO. S-6088

DONALD D. & CATHERINE BEAM  
V. 168, P. 282

JOHN N. & MATTIE J. COBLENTZ  
V. 214, P. 331

I.P. FOUND  
S 89°56'26"E  
5.00'  
FROM PROP. COR.

JOHNNY JR. & MARY MILLER  
V. 255, P. 1057

C.L. T.R. 566  
60' R/W

7.18 ACRES TOTAL  
(4.638 AC.) (2.542 AC.)

VERNON J. & MARY B. YODER  
V. 256, P. 18

10.474 ACRES

JOHN A. MILLER  
V. 255, P. 1055

DONALD W. & VICTORIA L. HAMILTON  
V. 221, P. 245

- LEGEND:
- - STONE FOUND
  - - IRON CORNER FOUND
  - - POINT-OF-DEPARTURE
  - - 5/8" X 30" RE-BAR W/I.D. CAP SET
  - ⊠ - RAILROAD SPIKE SET

REFERENCE DOCUMENTS:

- TAX MAP  
DEEDS AS SHOWN  
SURVEY PLATS:  
V. 6, P. 87  
V. 9, P. 199  
V. 10, P. 174  
V. 10, P. 613  
V. 12, P. 599  
V. 12, P. 972

JUN 15 1994  
Rec'd \_\_\_\_\_ AT 2:15 O'CLOCK PM  
Recorded JUN 16 1994 Holmes Co. Ohio Fees \$20.00  
Plat Vol. 14 533 Recorder Sally Miller  
Deed vol. 264 Pgs 838-840 55

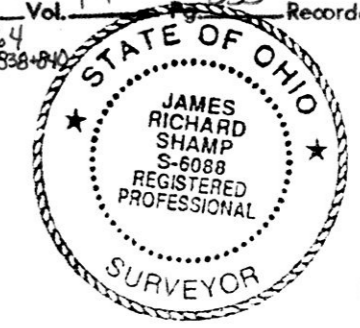

PLAT APPROVED  
6/1/94

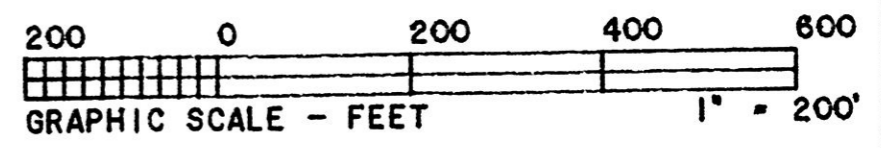

VOL. 14 PAGE 533