

Donald & Virginia Land fair
Vol. 170 Pg. 577
586°46'46"E 1,345.01'

I.P.Fd. N.W. corner
E 1/2 S.E. 1/4 Sec. 20

I.P. set N.E. corner
S.E. 1/4 Sec. 20
T9N, R7W

Courses around T. Marzetti Co.

- A N26°36'23" W 396.13'
- B N17°52'45" W 90.00'
- C N77°51'35" E 18.00'
- D N 6° 24' 05" W 140.34'
- E S 88° 26' 15" E 136.28'
- F N15° 19' 15" E 274.34'
- G N56° 58' 25" W 117.28'
- H N 1° 15' 00" E 257.05'
- I N 87° 07' 45" W 269.84'
- J S 1° 50' 35" W 705.65'
- K S 43° 07' 15" E 300.13'
- L S 30° 40' 15" E 107.43'
- M S 1° 02' 10" E 94.82'

Easement 1
N is centerline of 12'
casement N7°15'45"W 194.65'
for access to the remainder
over lands of T. Marzetti
Company

Paul F. Reining
Vol. 171 Pg. 421

SEC. 20, T9N, R7W

72.500 acres
part of Vol. 171 Pg. 421
Vol. 184 Pg. 675

20.00'
N78°17'25"E
Easement 2 is a joint sewer
56°29'05"E 40.00' casement.

N9°16'25"W
40.00'
Point X
Easement Scale
1" = 100'

577°51'35"W 18.00'

587°46'05"E
50.00'

N2°13'55"E 1449.33'
1450.00' 50' Easement for land in Sec. 16
I.P. set 1597.30'
I.P. set 491.58'
52°13'55"W 2,663.07'

NORTH

Donald T. & Betty J. Bertler
Vol. 184 Pg. 224
N10°42'28"E 2,371.51'

INDEXED

187237

REC'D
AT 12:57 o'clock PM
APR 20 '94

RECORDED
FEE \$20.00
APR 21 '94

Deed
Vol. 264 pg 142
Deed vol. 264 pg 142

RECORDED
65

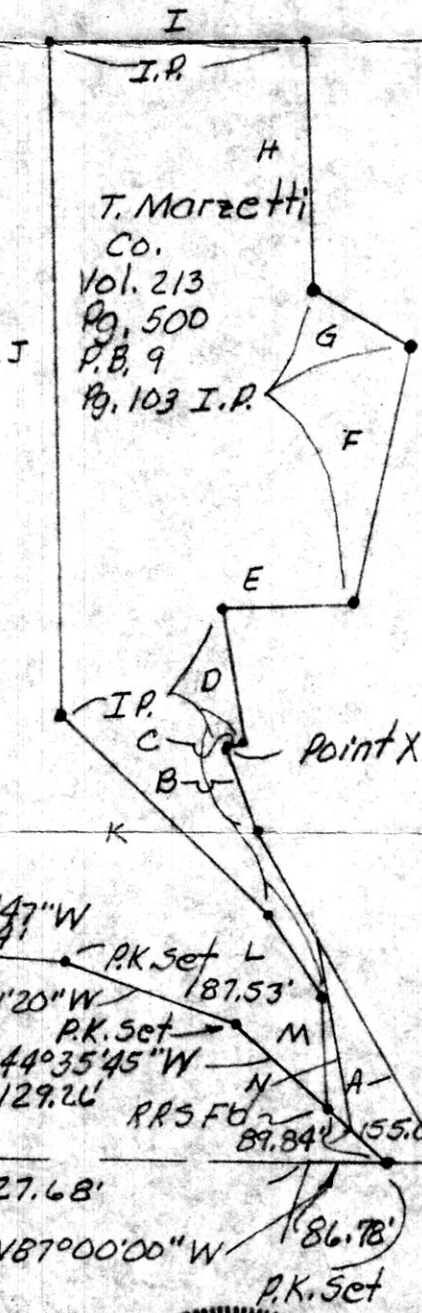

Anna Mary Tope
Vol. 223 Pg. 432

SEC. 16, T9N, R6W

I.P.Fd
S.W. corner
E 1/2 S.E. 1/4
Sec. 20

Paul F. Reining
Vol. 170 Pg. 295

NB7°00'00" W
54.62', 70.24', 392.54'

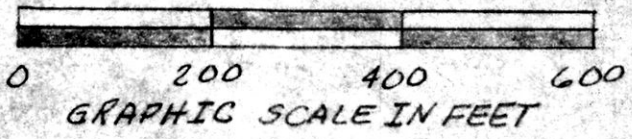

PLAT OF A SURVEY FOR
PAUL F. REINING
KNOWN AS part of the E. 1/2 of
S.E. 1/4, Sec. 20, T9N, R7W
Hardy Twp., Hol. Co., Ohio

Robert L. Kasner P.S. 5193
P.E. 28880
6127193