

LEGEND: O = I.P. SET (5/8" X 30" RE-BAR W/PLASTIC CAP MARKED "JIM SHAMP 6088")  
▲ = P.K. NAIL SET  
BEARINGS ASSUMED.

NORTH

NOTE: TWO MONUMENTS LOCATED HERE - SEE EXPANDED VIEW FOR DETAIL.

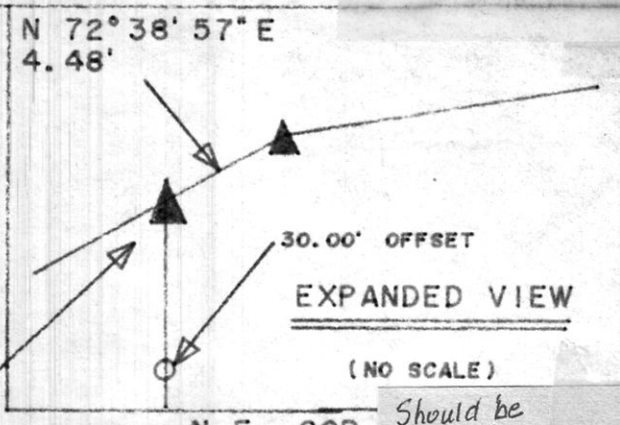

WILLIAM P. & CAROL L. GRASSBAUGH V. 197-P.31

DURIS ATCHERSON V. 206-P.592

C.L. S.R. 520 60' R/W

S 87°53'01"E 308.41'  
N 88°22'57"E 167.84'  
N 72°37'41"E 196.42'

N 83°26'21"E 201.01'  
N 76°00'12"E 200.81'

S 89°25'49"E 265.84'  
(NOTE: THIS COURSE LEAVES THE C. L. OF S.R. 520)

HENRY ROY & KATHLEEN FRIEDRICH V. 226 - P. 444

N 02°51'09" E TOTAL DIST. = 2451.59' (DEED CALLS FOR 2522.3')  
2421.59' (I.P. TO I.P.) + 30.00' (I.P. TO P.K.)

N 02°50'45" E TOTAL DIST. = 2531.70'  
2501.70' (I.P. TO I.P.) + 30.00' (I.P. TO P.K.)

S 02°50'45" E 2630.07'  
(DEED CALLS FOR 2649.7')

CLYDE R. & NORMA JOHNSON V. 125 - P. 560

NOTE: See P.V. 14 Page 486 for re-recorded plat showing the correct Quarter Section Location

INDEXED JUN 18 1991  
REC'D. JUN 18 1991  
AT 11:04 O'CLOCK AM  
RECORDED JUN 18 1991  
Plat VOL 12 PG. 681  
Holmes Co. Ohio Fee: 19.35  
Mary Ellen Sigrist Recorder

37.389 ACRES (SUBDIVISION OF ANGELO & KAREN PRIVITERA V. 226 - P. 749)

39.421 ACRES (SUBDIVISION OF ANGELO & KAREN PRIVITERA V. 226 - P. 749)

Deed Vol. 251 Page 797

Should be SW cor E 1/2 SW 1/4

Should be SE cor E 1/2 SW 1/4

S.W. COR. S.E. QTR.

S.E. COR. W. HALF S.E. QTR.

S 87°34'04"E 660.35'

S 87°34'04"E 660.35'

SEC. 3 SEC. 8

CLYDE R. & NORMA JOHNSON V. 125 - P. 560

I CERTIFY THIS TO BE A TRUE PLAT OF A FIELD SURVEY COMPLETED ON FRIDAY, MAY 10, 1991:

JIM SHAMP, REG. SUR. # S-6088  
MAY 21, 1991



PLAT APPROVED 6/18/91

SURVEY PRIVITERA		
STATE OHIO	COUNTY HOLMES	TOWNSHIP RICHLAND
RANGE 9W	TOWNSHIP 8N	SECTION 3
QUARTER NORTHWEST	DATE MAY 10, 1991	
HEARTLAND SURVEYING 5210 TWP. RD. 257 MILLERSBURG, OHIO 44654 PHONE: 216-674-4698		