

This 3.446 acre lot is approved for the existing residential wastewater system.

*Mat Miller*  
Sanitarian  
Date 8-26-86

### SURVEY PLAT

PART OF LOT 2 and PART OF LOT 3  
THIRD QUARTER  
R-8-N, R-6-W  
Mechanic Township  
HOLMES COUNTY, OHIO

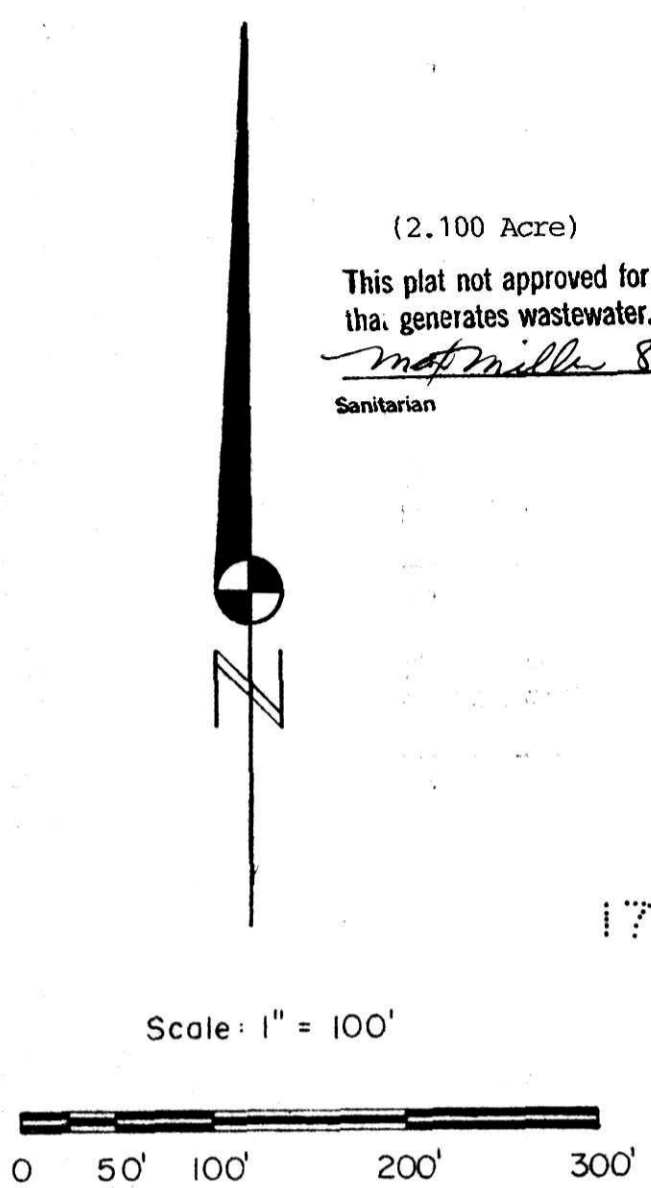

- - Stone with "X" Fd.
- - I. P. Fd.
- - Rebar Set

#### References

Deed Vol. 195, Pg. 485  
Plat Vol. 7, Pg. 745  
Plat Vol. 7, Pg. 765  
Previous R.G.R. Survey  
in Lot 3, Sept. 1980

Survey For Frederick C. &  
Dorothy I. Smith  
Vol. 195, Pg. 485

3.446 Ac.

2.502 Ac.

(2.100 Acre)  
This plat not approved for any use  
tha. generates wastewater.

*Mat Miller* 8-26-86  
Sanitarian Date

2.100 Ac.

SPLIT  
APPROVE  
# 800230

2.311 Ac.

(2.502 Acre)  
This plat not approved for any use  
that generates wastewater.

*Mat Miller* 8-26-86  
Sanitarian Date

(2.141 Acre)  
This plat not approved for any use  
that generates wastewater.

*Mat Miller* 8-26-86  
Sanitarian Date

2.141 Ac.

2.132 Ac.

(2.132 Acre)  
This plat not approved for any use  
tha. generates wastewater.

*Mat Miller* 8-26-86  
Sanitarian Date

25.507 Ac.

NE Corner of LOT 2  
Stone with "X" Fd.  
48" W. Oak NE 8.72'  
54" W. Oak SE 20.15'  
18" Walnut W 21.85'  
24" Hickory SW 39.0'  
I.P. in Center T.R. 63  
W on Line 8.14'

Rec'd. AUG 28 1986 AT 11:01 O'CLOCK AM  
Recorded *Aug 28 1986* Holmes Co. Ohio Fees *17.85*  
Plat Vol. 11 Pg. 89 Recorder *Richard Haver*  
*Judson*

Deed Vol 232 Pg. 134

I Certify This Survey And Plat To Be  
Correct To The Best Of My Knowledge.

Date *7-3-82*  
Ronald G. Rudolph - R.S. 6449  
R.G. RUDOLPH SURVEYING, Inc.  
1175 Summer set Dr  
Wooster, Ohio 44691

NW Cor. 3.00 Ac.  
Plat Vol. 7, Pg. 745