

154324
PRAIRIE TOWNSHIP
SE QTR. SEC. 34, T-14N:R-13W
HOLMES COUNTY, OHIO

S-17B-86 R-1

VOL 10 PAGE 673



FLORENCE WILLIAMS (GRANTOR)
 DEED VOL. 220 PAGE 338, Vol. 232 Page 618

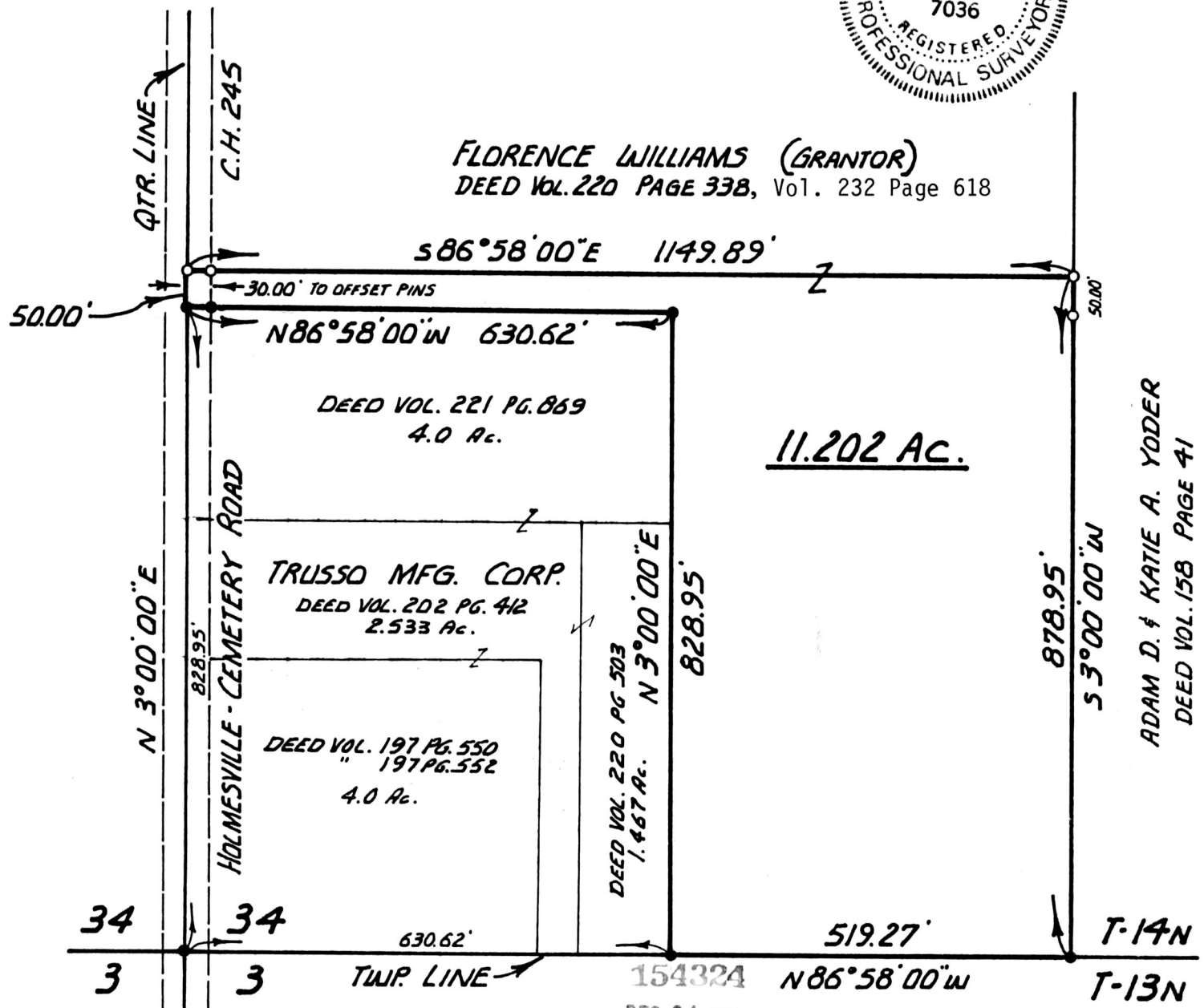

ADAM D. & KATIE A. YODER
 DEED VOL. 158 PAGE 41



NOTE: BEARINGS ARE COMMON TO PRIOR SURVEY PERFORMED BY US AND COMPLETED 23RD AUG. 1983. IT IS ON FILE AT HOLMES CO. TAX MAP OFFICE.

REC'D: DEC 24 1986
 AT 10:46 O'CLOCK a.m.
 Recorded Dec. 26, 1986 Holmes Co. Ohio Fee: 5.00
 Plat Vol. 10 Pg. 673 Recorder Richard Gruen

I CERTIFY THIS PLAT TO BE CORRECT TO THE BEST OF MY KNOWLEDGE.

Edward A. Gasbarre
 EDWARD A. GASBARRE P.S. 7036

R.W. GASBARRE & ASSOCIATES INC.
 SURVEYING & MAPPING
 P.O. BOX 44 (401 S. MARKET ST.)
 WOODSTER, OHIO 44691
 PH. (216) 264-9499

SCALE 1" = 200'

- — NO. 5 RE-BAR SET (30" LONG WITH I.D. CAP. (15" LONG IN ROAD))
- — IRON PIN FOUND

COMPLETED: 11TH DEC. 1986