

I hereby certify this plat to be a true delineation of a field survey by Hudnut - Laughery and Assoc. in March, 1974.

Ronald L. Laughery 4/3/74
 RONALD L. LAUGHERY
 Reg. Surveyor No. 6111

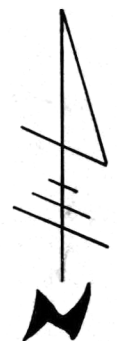

SYMBOLS

- → Iron Pin Set
- S.R. → State Route
- T.R. → Township Road

INDEXED 105627

RECD: September 9th, 1975

AT 10:25 O'CLOCK a. m.

RECORDED Sept. 9, 1975

HOLMES CO. PLAT VOL. 7 PG. 511

FEE: \$ 2.00

Richard Craven RECORDER

Deed Vol. 191 - Page 708

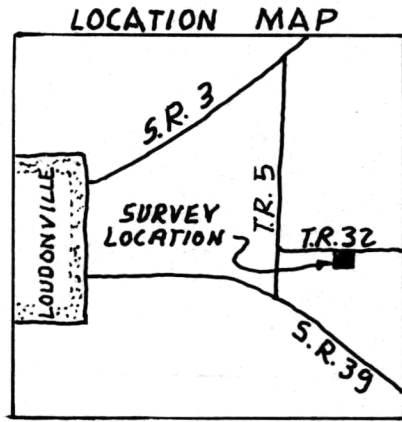

HUDNUT, LAUGHERY & ASSOC.
ENGINEERING & SURVEYING
 1283 CENTER LANE DRIVE
 ASHLAND, OHIO 44805

Washington Twp., Sec. #6, Twp #19, R. #15
 Holmes County, Ohio

Drawn By: RLP: 4/3/74: Scale 1"=100'