

j. Be it known that I, Wayne J. Hochstetler owner of the land shown on this plat do hereby acknowledge that I ordered same to be surveyed and platted to my satisfaction and by signing this plat I do dedicate to public use, forever, the streets shown hereon, the same being subject to the regulations of the Holmes County Regional Planning Commission.

Owner: Wayne J. Hochstetler
 Witness: Walter A. K...

k. I hereby certify that this plat is a true presentation of the survey made by me and the surveys on record of the 3 phases of development of the Wayne J. Hochstetler Allotment.

William Sallner
 Reg. Sur. No. 3915

l. This is to certify that the sewage disposal and water systems are approved by the Holmes County Health Commissioner.

William Sallner
 Holmes County Health Commissioner

m. This is to certify the approval of the roads, sewer and water systems in this allotment.

Carl Snyder
 Holmes County Engineer

o. This is to certify that this plat was approved by the Holmes County Commissioners at a regular meeting held JUNE 5 1972

John Oswald
 Clerk of Commissioners

Wayne J. Hochstetler

q. I hereby certify that at a regular meeting of the Holmes County Regional Planning Commission held JUNE 1, 1972 this plat was approved.

Donald L. Sullivan
 Chairman Holmes County Regional Planning Commission

95614
 FILED June 9, 1972
 AT 3:25 O'CLOCK P.M.
 RECORDED June 8, 1972
 HOLMES COUNTY, OHIO
 FILE # 11-54
Richard Brasen RECORDER

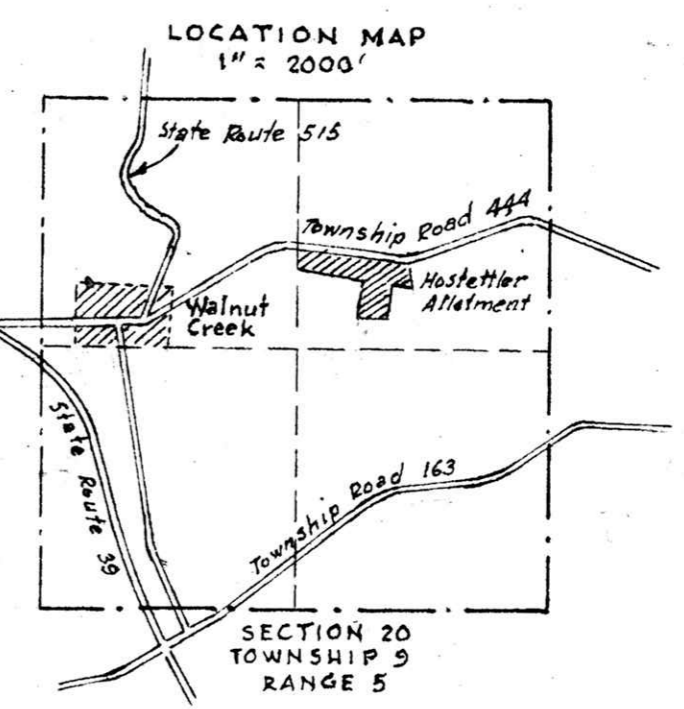

MAP OF THE
 3 PHASES OF DEVELOPMENT
 OF THE
**WAYNE J. HOCHSTETLER
 ALLOTMENT**
 IN
 Section 20 - Township 9 - Range 5
 Walnut Creek Township, Holmes County
 Ohio

Scale 1" = 50 ft. May 1972
 Drawn from a survey and records by
William Sallner
 Reg. Sur. No. 3915

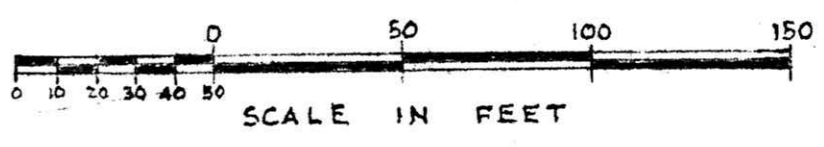

S.W. Cor.
 N.E. Qr.
 Sec. 20

South Drive to be extended to intersect with Township Road 444.

Indicates location of Iron Pipes

