

Irvine & Enos Addition to the town of Millersburg (2 additions)

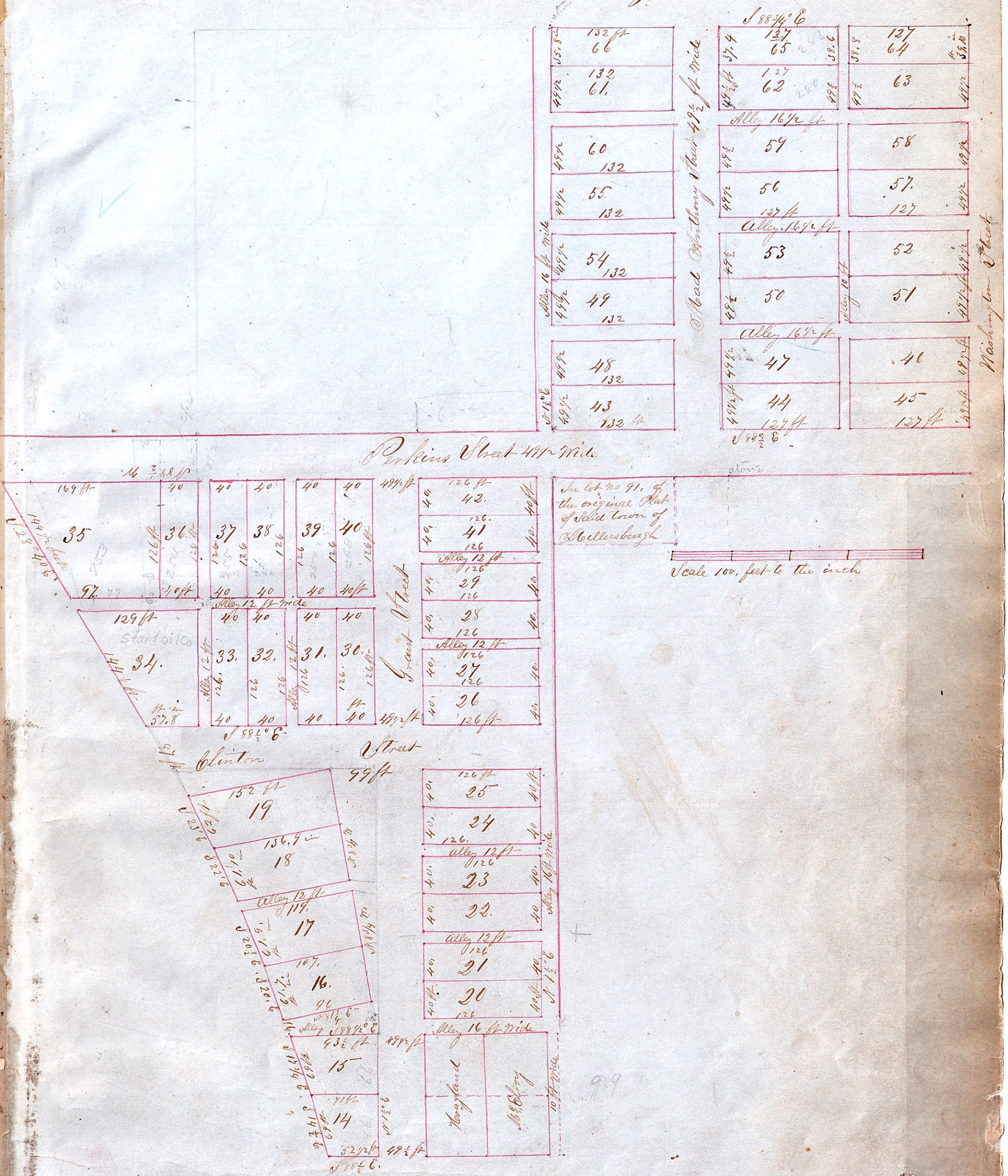

Washington Street August 13th 1854.

I, Manuel Robinson a Surveyor and resident of Holmes County, Ohio hereby certify the above to be a true and correct plat of in lots by me surveyed, staked out and platted for James S. Irvine & Robert H. Enos in continuation of their addition to the town of Millersburg the Seat of Justice for said County, the same being a part of and situate on the South West quarter of Sec. twelve (12) Township Nine (9) of Range Seven (7) County of Holmes, State of Ohio. The relative situation of said continuation of said addition of lots to the original Plat of said town and their additions thereto being as indicated by said plat the lots being in the same number the streets and alleys being of the size, extent and bearings as noted on said Plat. I have also caused a stone of about two feet in length and about six inches square at top to be fixed at the South West corner of lot number three the North West corner of the stone being the corner of the lot, also fixed a stone of like dimensions at the North West corner of lot number six the South East corner of said stone being the corner of said lot. Manuel Robinson Surveyor