

6 9 6 NE



A survey made for Henry Walters, being the middle part of the north east quarter of section 6, in Township 9, of Range 6.  
 April 30<sup>th</sup> 1903.

H. H. Robinson  
 County Surveyor  
 witness

- B - Red oak - 18" - S 85° E - 2 1/2' L.
- " " 18" - N 71° W - 4 1/2' L.
- C - Beech 34" - S 23 1/2° E - 9' L.
- " " 12" - N 13 1/2° W - 9' L.

Chain Carvers, W. P. Findley, W. Opliger.

9 9 lot Nos

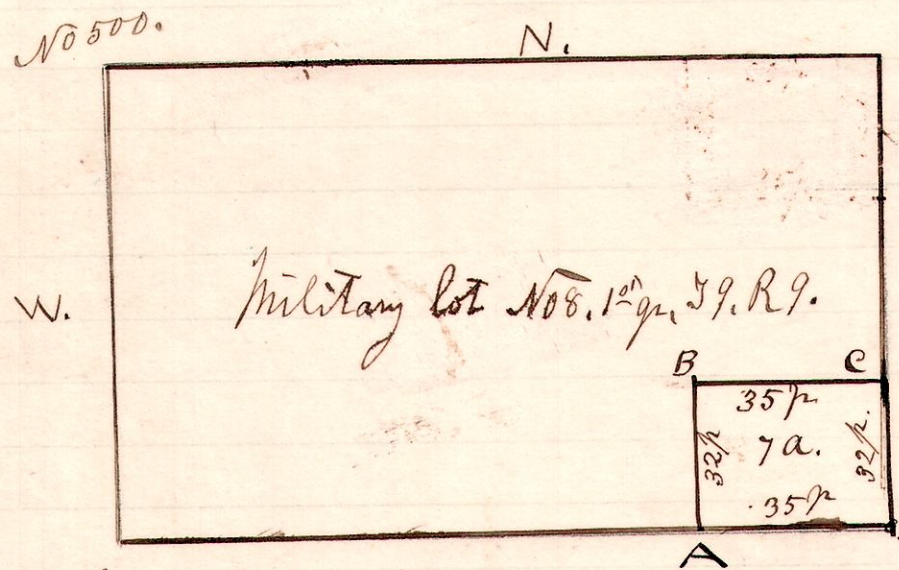

A survey made for Ed Mitchhart, being the south east part of Military lot No 8, in the first quarter, in Township 9, of Range 9.  
 Field notes of witness.

- A - Chestnut 30" - N 67 1/2° E - 25' L.
- B - Double Walnut, 45" - Corner.
- C - Walnut, 5" - N 37 1/2° W - 14' L.

Chain Carvers, H. H. Robinson, Ed Mitchhart.

May 1<sup>st</sup> 1903  
 H. H. Robinson  
 County Surveyor.

7. 8 4 24

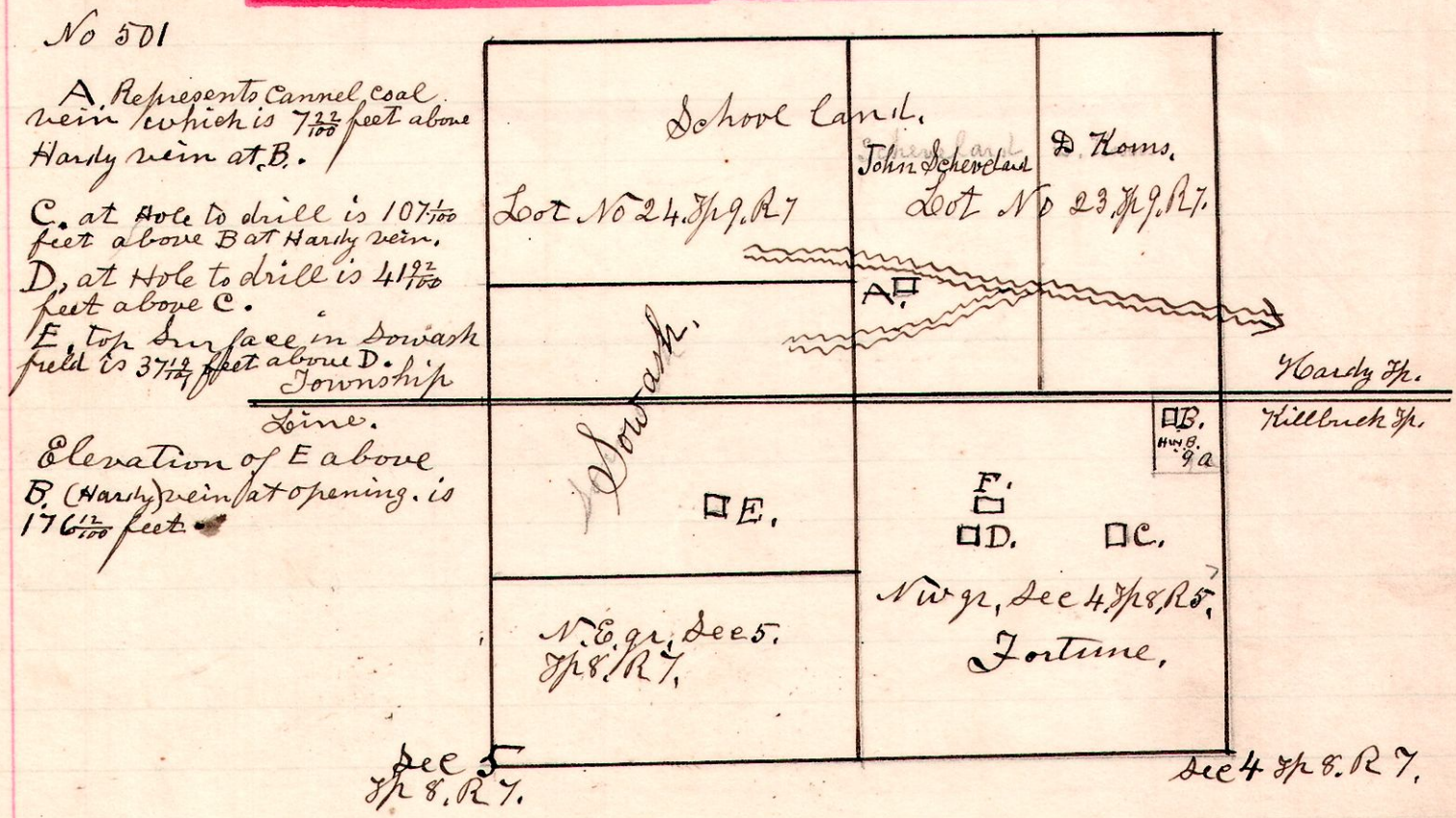

A. Represents Cannel coal vein which is 7 1/2 feet above Hardy vein at B.  
 C. at hole to drill is 107 1/2 feet above B at Hardy vein.  
 D. at hole to drill is 41 1/2 feet above C.  
 E. Top surface in Dowdash field is 37 1/2 feet above D.  
 Elevation of E above B (Hardy vein) at opening is 176 1/2 feet.

A survey of levelings taken for F. E. Dussel of Barberton, with reference to what are known as the Hardy and Cannel coal veins.

May 6-8-1903.  
 H. H. Robinson  
 County Surveyor.