

No 428

7 8 1 NE

The following is a survey of a change in the state road leading from Coshocton to Millersburg, on Sand Run hill, in the north east quarter of section number one (1) in Township number eight of Range number seven (7) Commencing at a stone in said State Road, thence South 53° East 5 perches and 7 links to a post; thence South 48° East 7 perches and 12 links to a post; thence South 44° East 6 perches and 12 links to a post; thence South 33½° East 4 perches and 22 links to a stone; there to end. Whole distance 24 perches and 3 links.

Sta	Bearing.	Distance.
1	S 53° E.	5p 7l.
2	S 48° E.	7p 12l.
3	S 44° E.	6p 12l.
4	S 33½° E.	4p 22l.
Whole Dis-		24p 03l.

John V Farver et. Al.
Petitioners.

Viewers.

John Metzler.
A. W. Logsdon.
J. W. Altman.

Chain Carriers
Guy R. Palmer.
James Devore.

Marker.
James Rinehart.

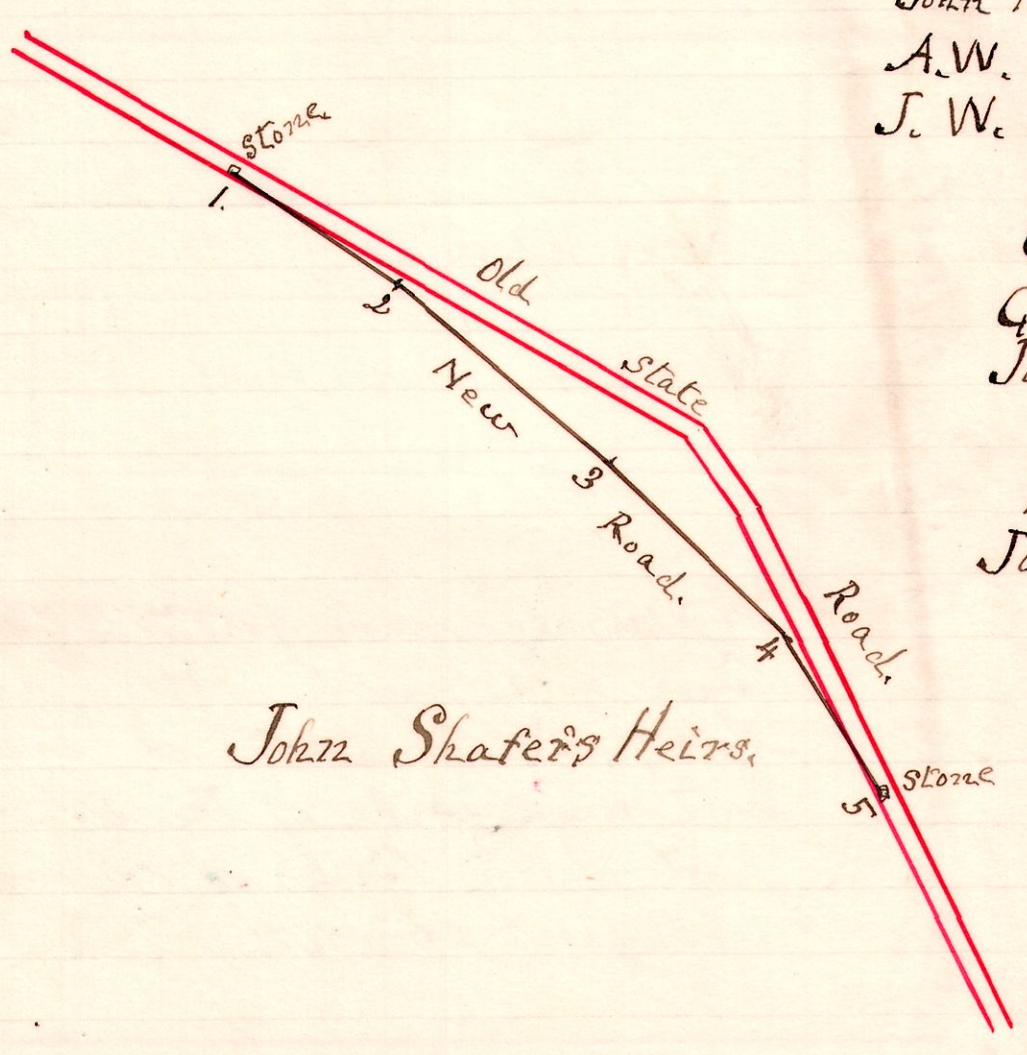

John Shafers Heirs.

August 22nd 1902

H. H. Robinson
County Surveyor.