

The above represents the lots of land belonging to the Estate of Catharine Zondler deceased; in Probate Court, B. C. Gill administrator; vs Ida Wirthrich et al. The following is a description of the several pieces consolidated.

Commencing at a post on the north line of the South quarter of Section 11, in Township 9 of Range 7, 42 perches East of the north west corner of said quarter, Thence South 4° west, 74 perches and 4 links to a post in the public road; Thence South 84° East 14 perches and 3 links to a post in the public road; Thence North 4° East 42 perches and 21 links to a post; Thence South 86° East 82 perches and 11 links to a post; Thence North 15 1/4° East 33 perches and 20 links to a post on the north line of said quarter; Thence North 86° west 105 perches and 12 links to the place of beginning containing 24 65/100 acres more or less, Excepting 1 acre heretofore sold to the Millerburg Creamery Company, and recorded in volume 54, Page 545 Deed Record and containing after said exception 23 65/100 acres more or less.

June 15th 1901.

H. H. Robinson
County Surveyor.

7 8 4 sw. n.e.

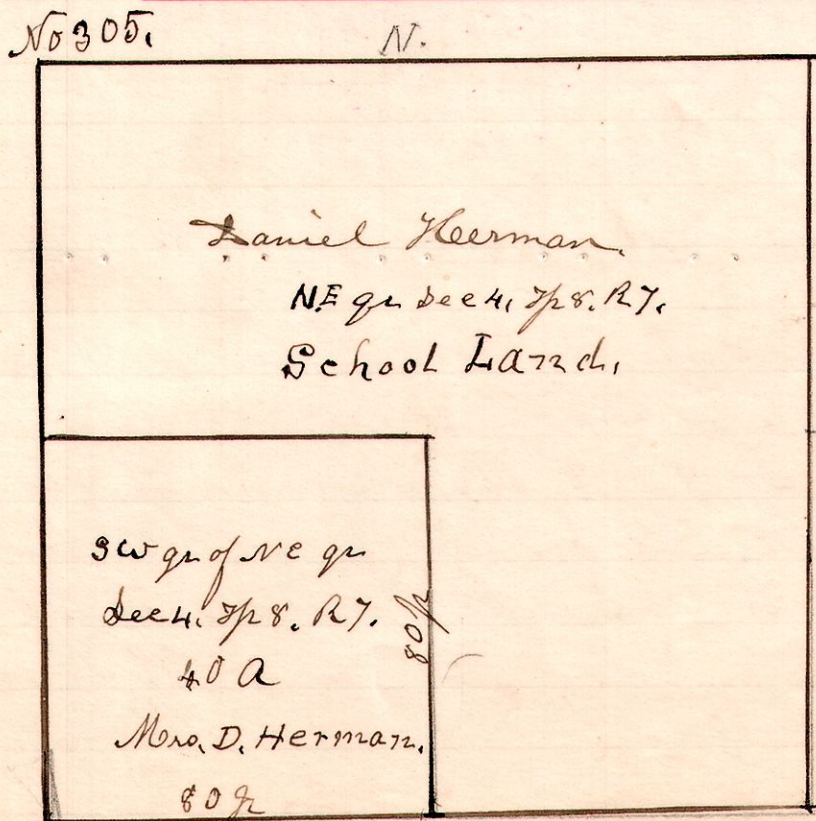

A survey made for Daniel Heerman and wife, being the South east quarter of the north east quarter of Section 4, in Township 8, of Range 7.

June 17th 1901.

H. H. Robinson
County Surveyor.