

The following road survey was made by order of the County Commissioners, to re-locate part of the county road which commences near the north East corner of Sec 29, T^h 15, Range 11, and runs southwardly 5 miles, and ends in the road from Berlin to Winesberg, and on lot 31, 3rd T^h 10, R 5. The portion surveyed for re-location commences in the County road, ^{East + West,} on the centerline north and south through section 32, T^h 15, R 11.

Commencing in said road 1 perch East of said center section line; ¹ Thence South 2° west, 12 perches; ² Thence South 5° E. 13 perches; ³ Thence South 24° East 10 perches; ⁴ Thence South 11° East 30; ⁵ Thence South 16½° west 9½ links + 20 perches to woods line; ⁶ Thence South 30° west 28 perches; ⁷ Thence South 2° west 69 perches; ⁸ Thence South 46° west 56 perches; ⁹ Thence South 33½° west 28 perches; ¹⁰ Thence South 23½° west 41 perches and 14 links to north line of south west quarter of section 5, Township 15 Range 11; ¹¹ Thence South 15° west 39 perches and 20 links; ¹² Thence South 28° west 38 perches and 3 links; ¹³ Thence South 11° west 66 perches; ¹⁴ Thence South 32° west 34 perches and 13 links to south line of Crow quarter section; ¹⁵ Thence South 6° west 112 perches and 21 links to Mt Hope and Winesberg road.

No 263
Paint T^h Road.
N + S.

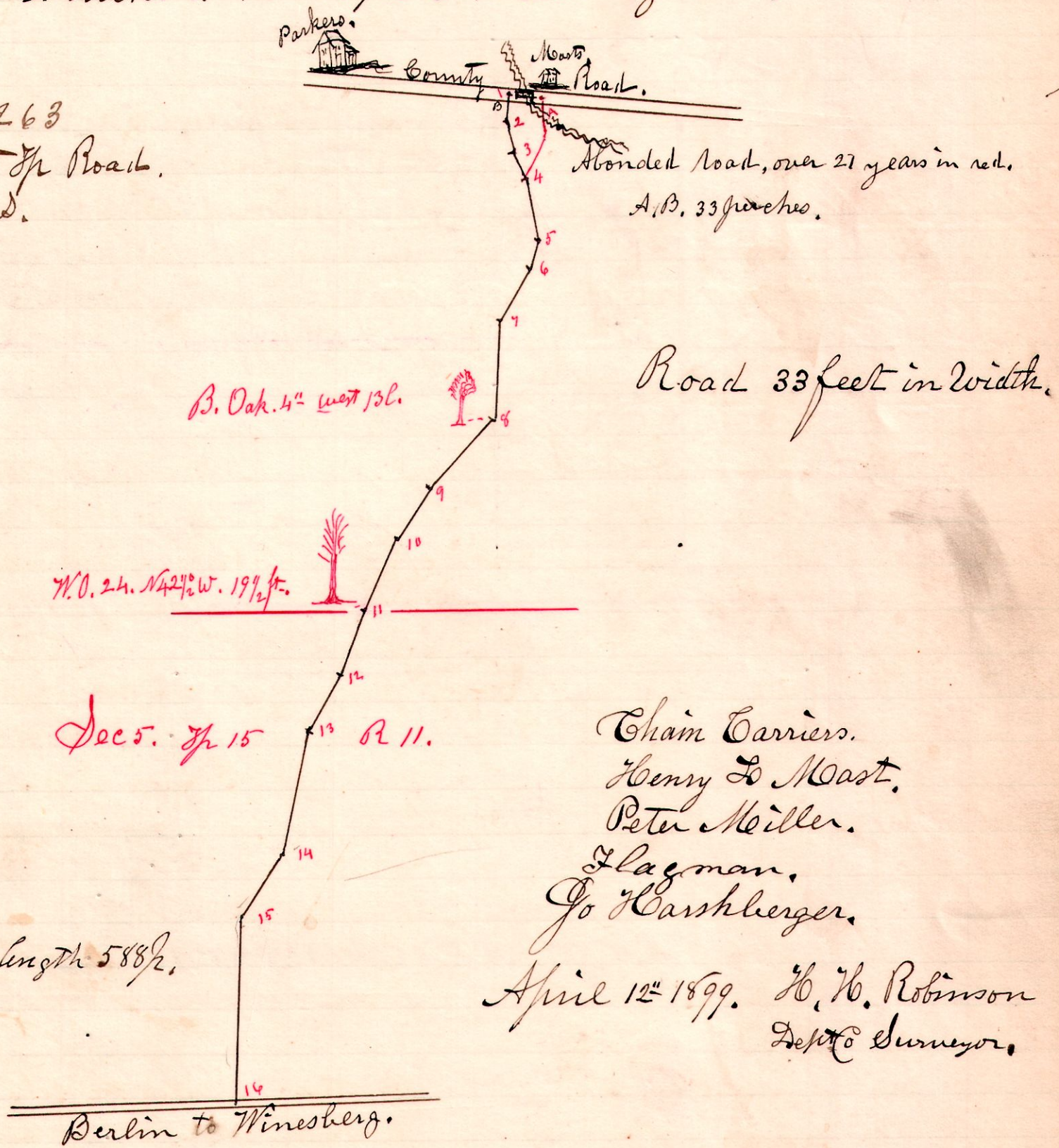

Road 33 feet in width.

Chain Carriers.
Henry D. Mast.
Peter Miller.
Flagman.
Jo Harshberger.

April 12th 1899. J. W. Robinson
Dep^y Co. Surveyor.

Total length 588².

Approved by G. G. Leole
Co. Surveyor, Holmes Co.