

No. 433

N pt SW 1/4 Sec 27, Tp 14 R 13

George R Lemon

Notes

"A" post on line between NW 1/4 sec. 34 Tp 14 R 13 and SW 1/4 sec 27, Tp 14 R 13 and east of the stone at NW 1/4 said NW 1/4 sec 34 the place of beginning of proposed Dedication. "B", a post on said line east of A and is the terminus of proposed dedication.

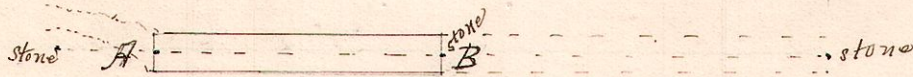

R Tp Sec 27
13 14 { 27 SW 1/4
 { 34 NW 1/4

N pt NW 2r Sec 34 Tp 14 R 13

James W. Miller

A survey made for Geo R. Lemon and James W Miller and Trustees of Prairie Tp. - Miller & Lemon dedicating so much of their land as lies between the posts and and 1 rod wide, for a township road.

July 13, 1892.

Frank H Genet,
County Surveyor.

No. 434

Notes

"A", the northeast corner of the northeast quarter of section 29, Tp 20 R 15, a post on line between Holmes and Ashland Counties. "B", a stone at the southeast corner of said Dr 11° W perches from A

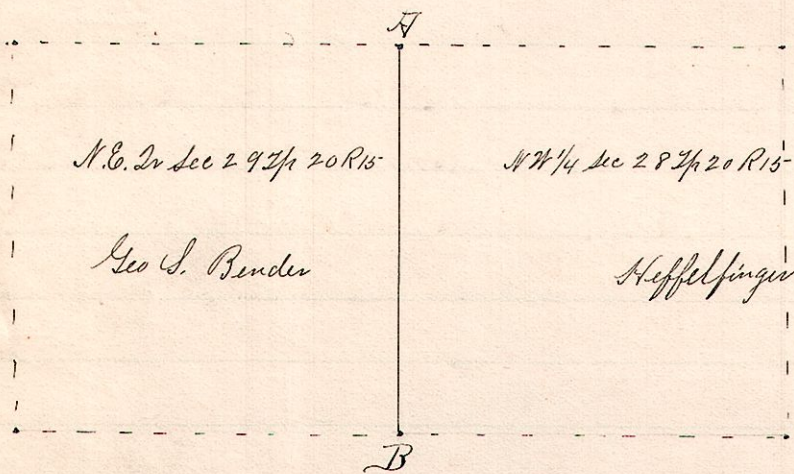

15 28 29 NE
 28 NW

Surveyed the above for the Trustees of Washington Township the line of a County Road between Sections 28 and 29 of the Tp 20 R 15, the line between lands of Geo S. Bender and Heffelfinger. July 25, 1892.

Frank H Genet,
County Surveyor.