

No. 401.

Notes.

R 7th Sec 20 pt
6 8 19 16 E & pt

"A" is a stone at the southeast corner of the northeast quarter of section 19, T₈S, R. 6W
 "B" a stone on the south line of said quarter N 86 3/4° W. 38 p. 15 l. from A.
 "C", a post, N 3 1/4° E 8 p. 9 l. from B.
 "D" a post, N 3 1/4° E 50 p. from B; 41 p. 17 l. from C.
 "E" a post, N 3 1/4° E 20 p. from D.
 "F" a post, N 36° E 11 p. 15 l. from E.
 "G" a post, N 34° W 11 p. 15 l. from F.
 "L" a post, N 86 3/4° W 18 1/2 p. from G.
 "P" a post, S 3 1/4° W 40 p. from L, and 18 1/2 p. N 86 3/4° W from D.
 "K" a post on East line of section N 3 1/4° E 8 p. 9 l. from A.
 "I" a stone at northeast corner of said section N 3 1/4° E 152 p from "K".
 "H" a stone, at Northwest corner of Elijah Logsdon's land, on the north line of said section in the public road N 86 3/4° W 38 p. 15 l. from I.

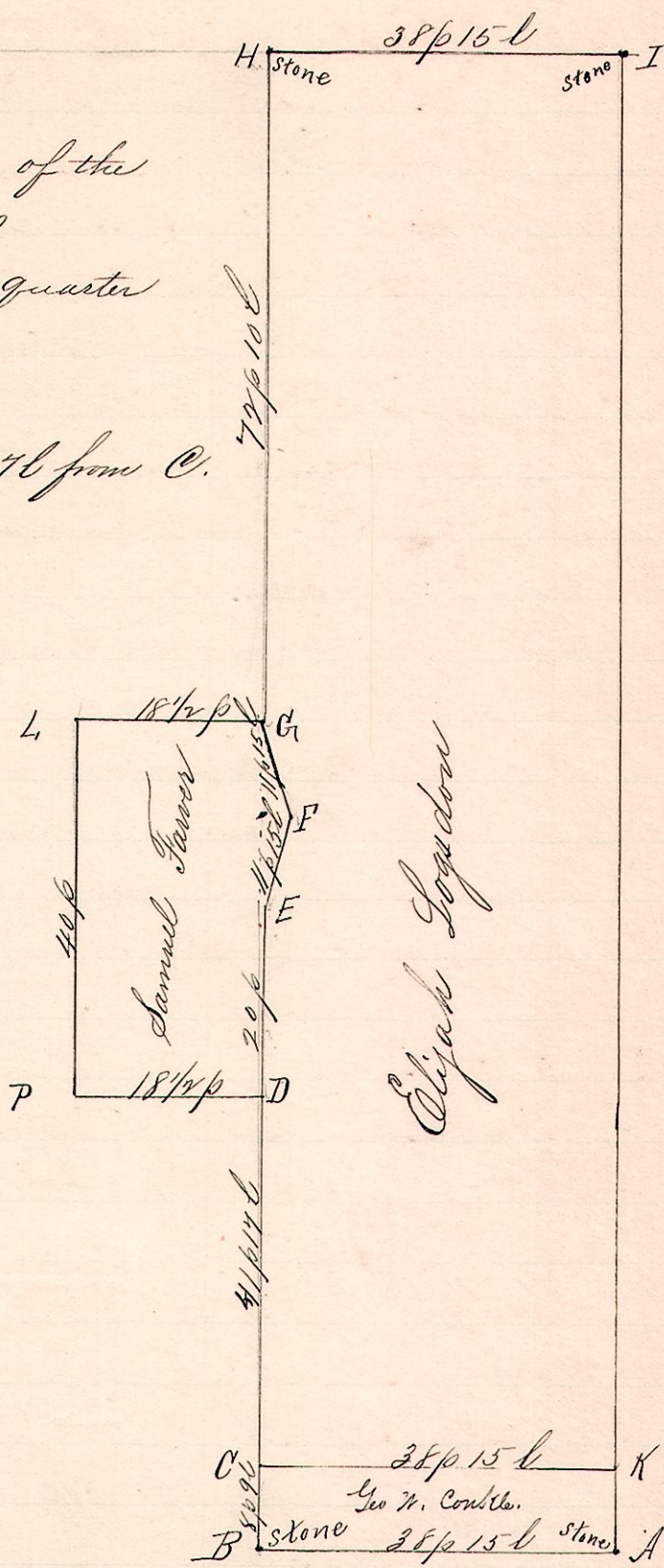

The above is a correct representation of the several tracts of land surveyed in sections 19th and 20th of T₈S, R. 6W, agreeable to the legal notices given.
 May 10, 13, 1892.

Frank H. Genet,
 County Surveyor,
 Holmes Co., O.