

Notice of Legal Survey.

7 8 21 SE Dr

To J. Carpenter, Oliver Carpenter, Curtis Carpenter, Mrs. Thos. Carpenter, Mrs. J. Luke, Eliza Duncan, Mary Ann Duncan, Almira Buckle, Mrs. Thomas Headington, Mrs. J. Carr, George Duncan, John Duncan, J. Augustus Evans, A. M. Maxwell, C. Craig and Mrs. Patterson.

You are hereby notified that a survey will be made and testimony taken by the County Surveyor of Holmes County, Ohio, on the 27th day of August 1891, between the hours of 10 A.M. and 6 P.M., and to continue from time to time at the request of said County Surveyor until the lines, boundaries and corners of the following described tract of land, now owned and held by the Edward Carpenter heirs and situate in Mechanic Township, Holmes County, Ohio, can be established;

Being the north part of the north half of the S.E. Dr. of Sec 21 T. 8. R. 7.

Interested parties are hereby notified to give said Surveyor the names of witnesses they wish subpoenaed and to be present at said survey.

Signed this 4th day of August, 1891

John Coukle, Jr.

A copy of the above notice was duly served on each of the within named parties on August 5, 1891.

John Coukle, Jr.

On the day set therein, I proceeded to the premises, agreeable to said notice, selected as Chairman Augustus Evans and Tipton Luke, and as markers - Coukles

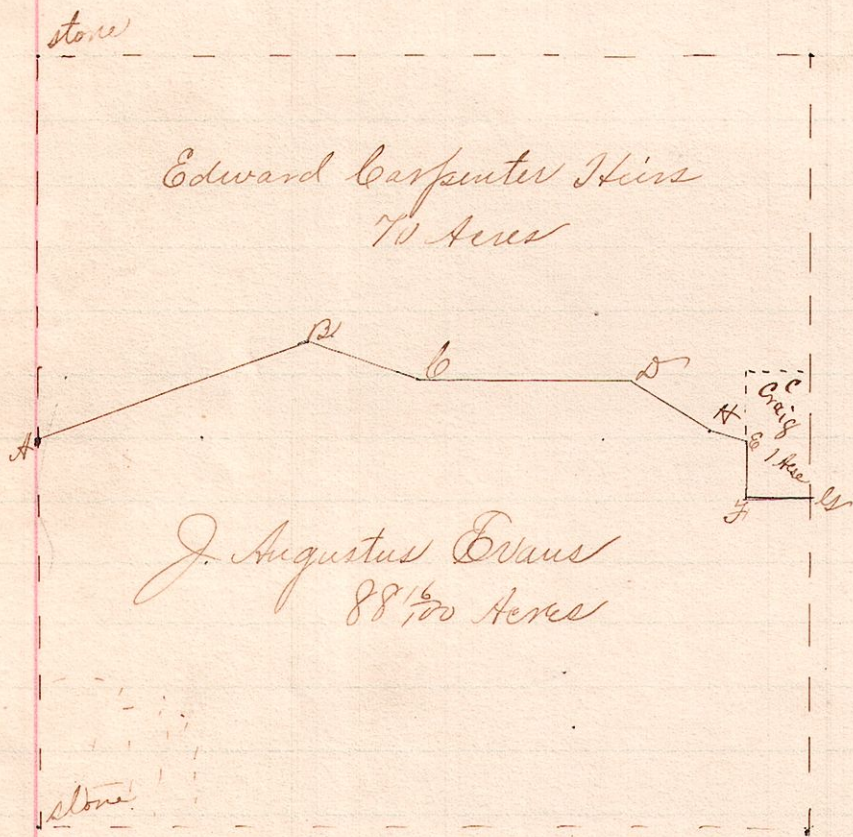

Notes.

- "A" is 84 rods North of the stone at the S.W. corner of the S.E. Dr. of Sec. 21 T. 8. R. 7 (a stone at S side of road.
- AB is north 69° E 58 rods 12 links.
- BC is S 70 3/4° E 23 rods 12 "
- CD is S 89° E 47 "
- DE is S 68 1/2° E 23 rods 4 links
- EF is S 74° E 10 "
- FG is S 3 1/2° W 10 "
- FH is S 86 1/2° E 8 "

Surveyed the above at the request of J. Augustus Evans and John Coukle Jr to determine the line ABCDEFGH. Aug. 27, 1891.

Frank H. Geisler,
County Surveyor.