

No. 332

68 12 NW  
73 NE



The above is a correct plot of a survey made by order of the Court of Common Pleas to set off dower of Susan Logsdon.  
 June 5, 1891.

Commissioners { H. H. Robinson  
 Adam Lowe  
 Frank H. Geis  
 Frank H. Geis  
 County Surveyor.

No. 333

69 14 1/4  
24 1/4

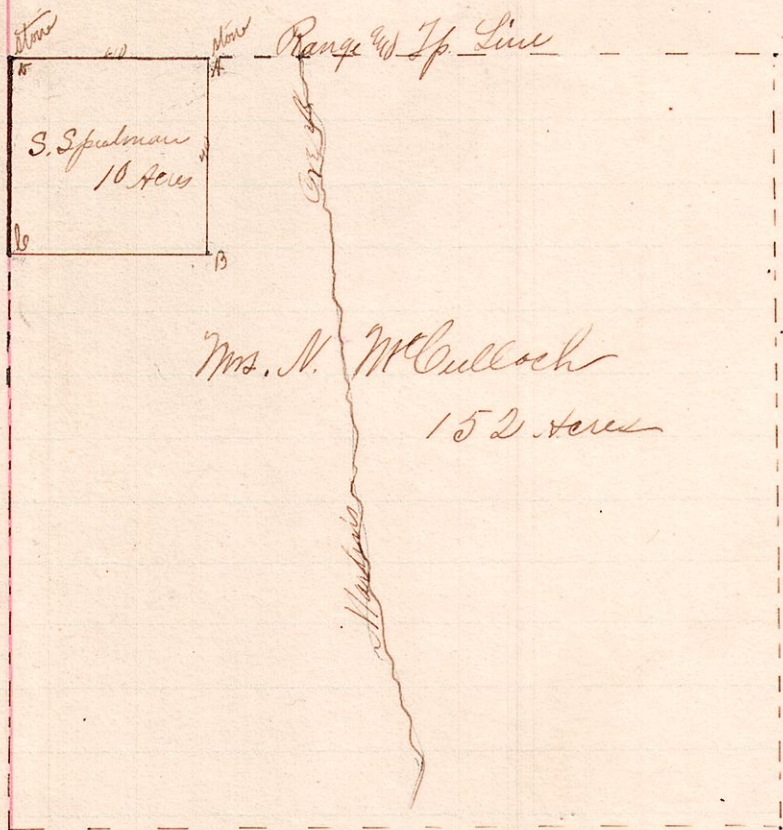

Description  
 15<sup>th</sup>, a stone at NW cor lot 4 on Range line  
 " " " 40 rods east of 2<sup>d</sup> " " "  
 From A to B is 40 rods  
 " B to C " " "  
 Bearing 3 1/4° to right.

Surveyed the above for J. McCulloch, June 8, 1891,  
 to determine the lines A B C D etc.  
 Frank H. Geis  
 County Surveyor