

R 268
 4/5 10 3/4

Description of Route.

A	S 62 E	3 91
B	S 85 E	10 00
C	N 72 E	16 41
D	S 87 1/2 E	11 50
E	N 64 E	12 21
F	N 16 E	2 02
G	N 29 1/2 E	3 64
H	N 7 E	2 02 1/2
I	S 87 E	18 50
K	N 51 E	19 29
L	N 36 E	7 18
M	N 27 1/2 E	3 18
N	N 6 1/2 E	8 50

Explanation.
 A is a point in the public road leading from mine to Winesburg and on the line between Chas. Stahl & F. Lugmbyhl.

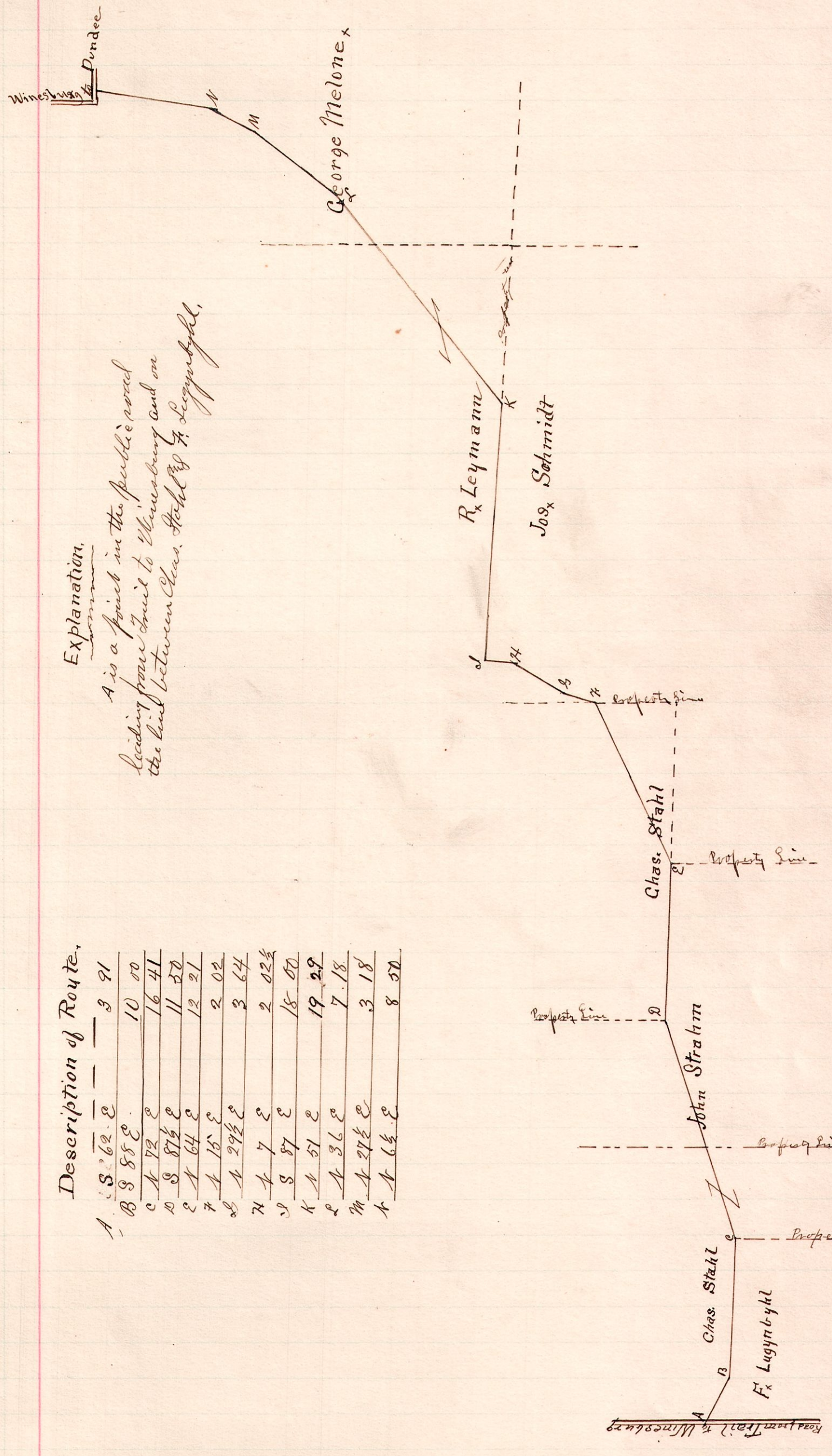

A survey made by order of the County Commissioners of the county road petitioned for by - Miller et al
 March 22^d 23, 1887. W.S. Howard
 Surveyor