

13 14 35 T-14⁴

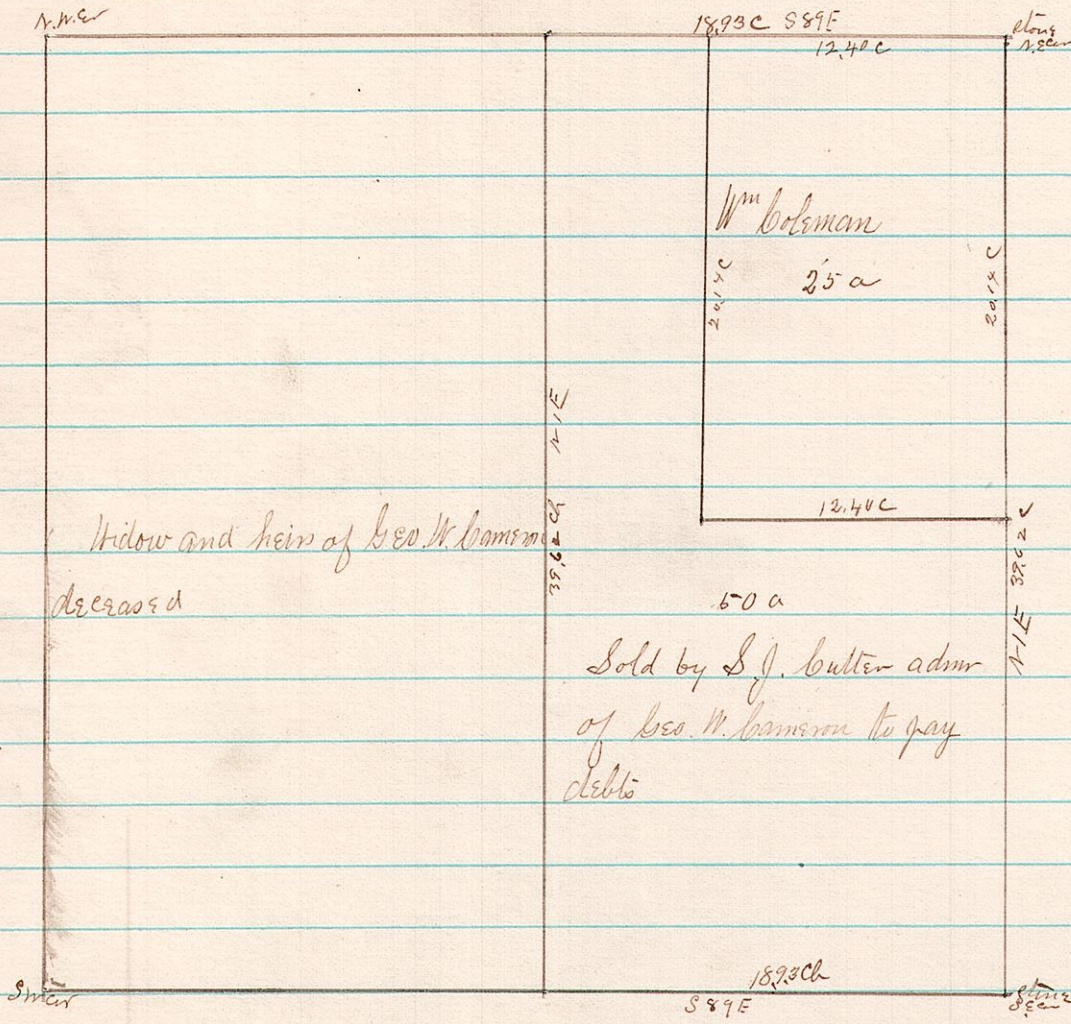

A Survey made for Samuel J. Butler administering the estate of Geo. W. Cameron cutting 50 acres off of the East-side T-14 R-13 Sec 35 T-14 R-13 Survey Aug 4th appraised December 6th 1885-

James C. Calhoun
County Surveyor

12 14 56718 Road
T.R. 187

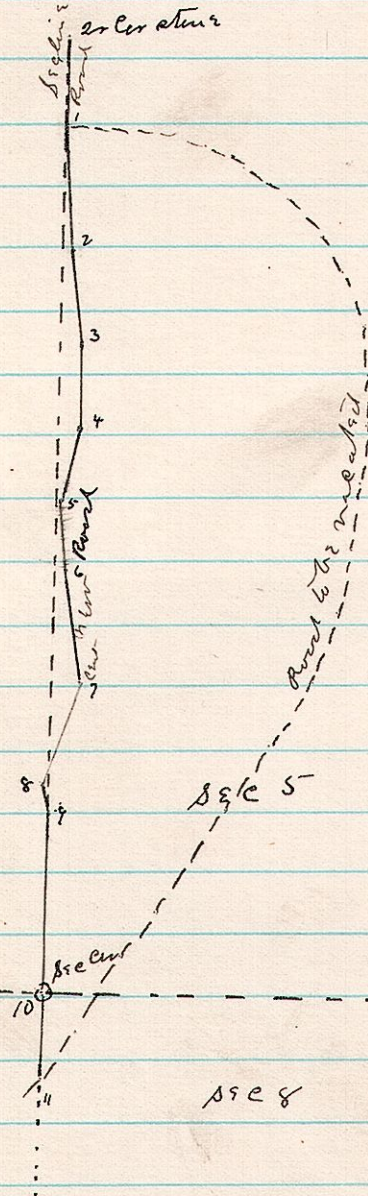

Notes commencing on Sec line 8th E

South of 2nd Cor for Sec 576 T-14 R-12 for 1st

Line	Bearing	Dist	Notes
1	S 2° W	4.95	to Sec corner
2	S 5 3/4° E	3.94	
3	S 3 1/2° W	3.70	
4	S 12 3/4° W	2.92	
5	S 2 1/4° E	3.16	24 l. E of line
6	S 7° E	5.43	
7	S 19 1/2° W	4.65	
8	S 7 1/2° E	1.12	
9	S 2° W	11.33	to Sec corner
10	S 2° W	3.50	to Public Road & terminus of new road

The alteration of a county road & situated for by Skilgus and others Harry Mast McCallouch and visors John J. Speelman flagman Henry J. Schmitt + Co W. Maxwell chairman all sworn

Surveyed Oct 1885

James C. Calhoun
County Surveyor