

448

461

79
Rudy & Hull
addition to
Gullenberg, L.

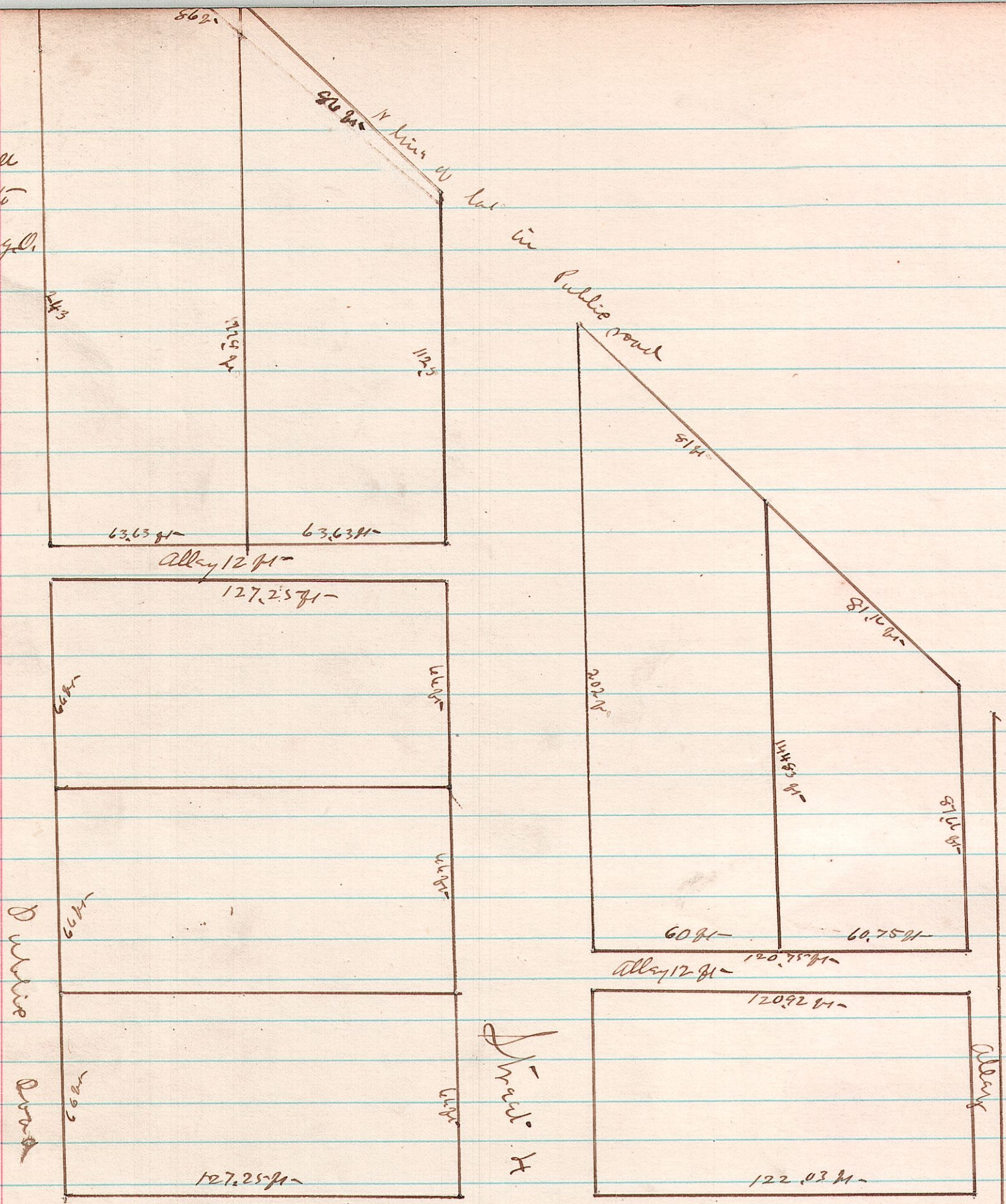

Public Road

H. H. H.

Adams Street 49 1/2 ft - 30 ft

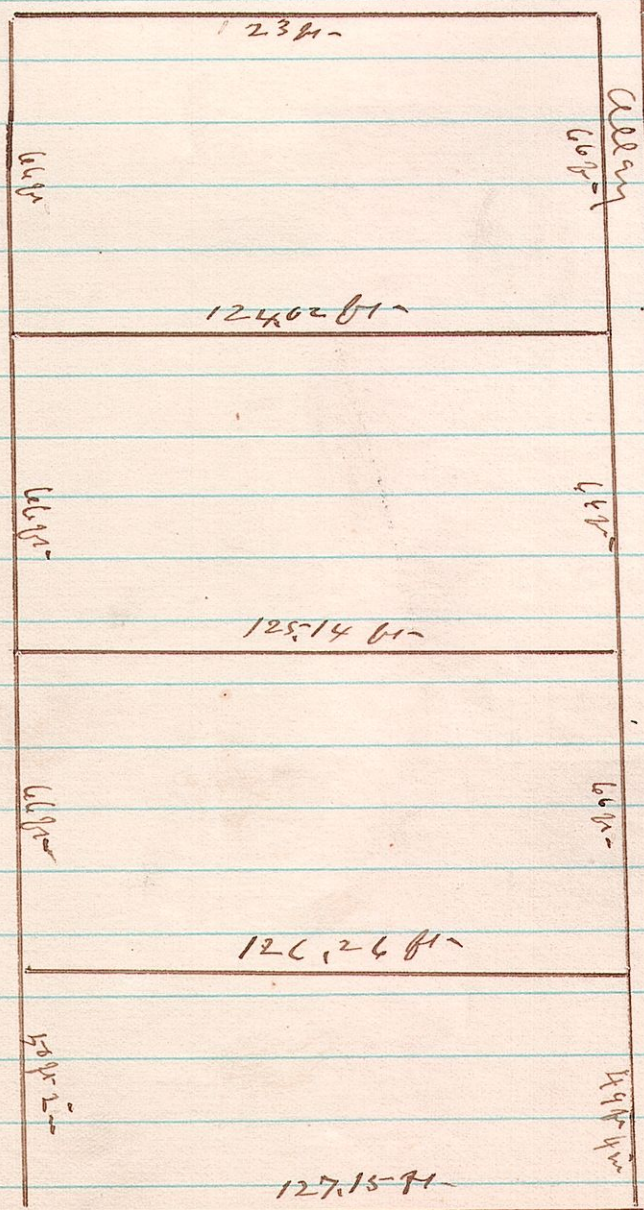
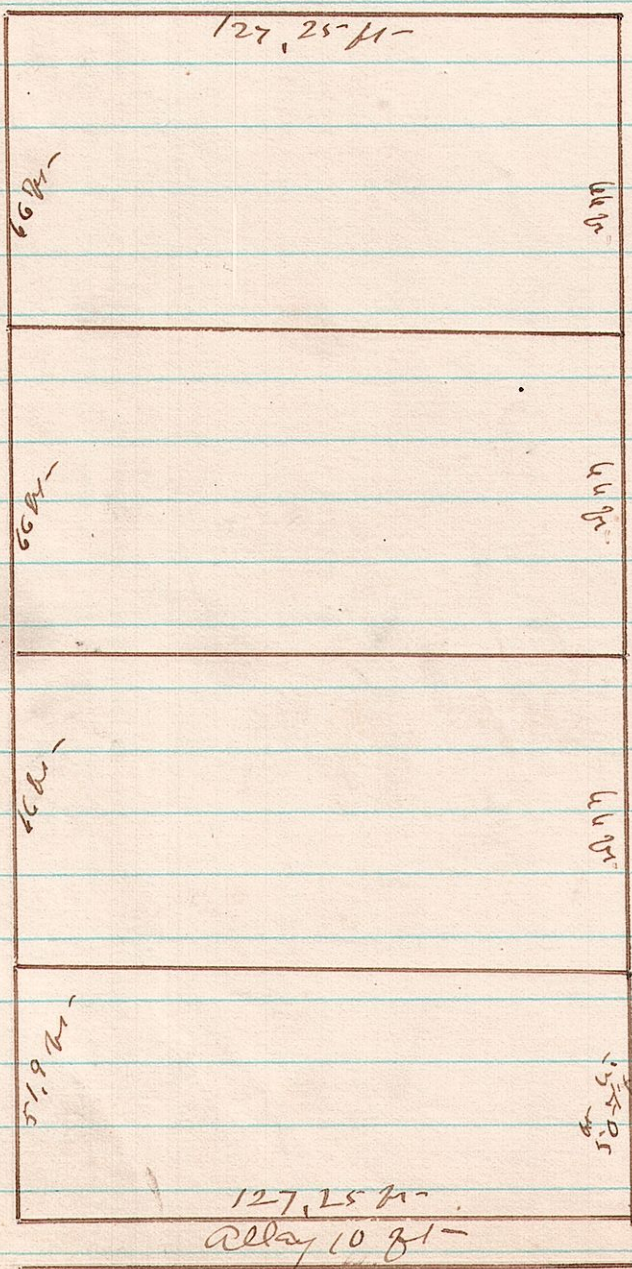

Boundary to Conditium

At Survey made for Rudy & Hull laying out their addition to lot 1
 out of lot 26 being part of the E. & S. 1/4 Sec 27 T. 9 R. 3 E. Dred Record 4 Page 315
 Survey ed April 27, 1888 James C. Gallagher
 60 Surveyor