

N.W. 1/4 of Sec. 20 Twp 8 R 6 (Mechanic)

No 27

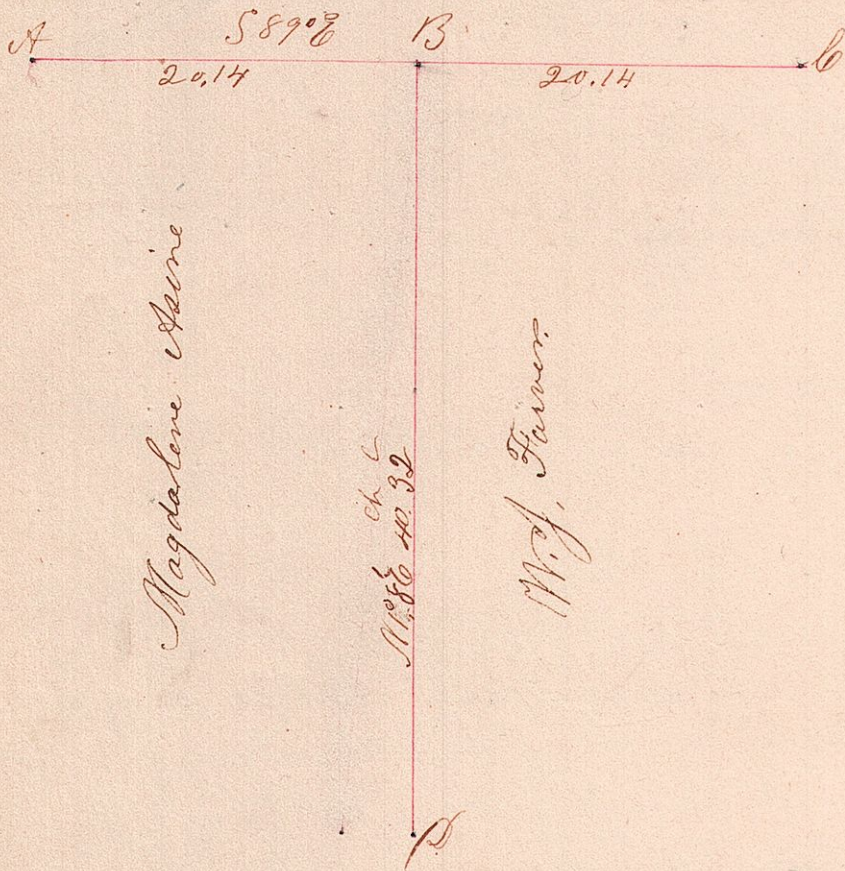

A section corner, O 24 post. Stone planted by
 S Robinson surveyor — B Stone planted with Mine
 W. ash. 6 N 19° E 28. — D Iron nail 4. S 48° E 48 —
 A, B, C North line of the North west qtr of Sec. 20,
 Twp 8, R 6. Myself & Joseph G Couser
 carried the chain.
 I hereby certify the above to be a correct plot &
 notes of the survey of the above named lines
 Surveyed Apr 11 1861.

Joseph Edgar County Surveyor
 for Holmes Co Ohio.