

196

Map of Range 6 Sect. 13. N. E. 2^d. (Mechanic)

East

No. 21,

North

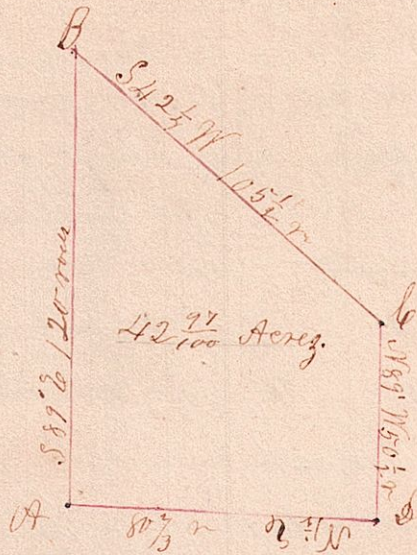

AB to D = stones planted

Surveyed the above for William Logsdon on the Sept. the first, A.D. 1860. being a parcel of land out of the North West corner of the North East corner of of the above named section,

Chain carriers, Henry McLaughlin & Samuel Mitten

Joseph Edgar, County surveyor for Holmes County Ohio,