

(A)

(H)
3

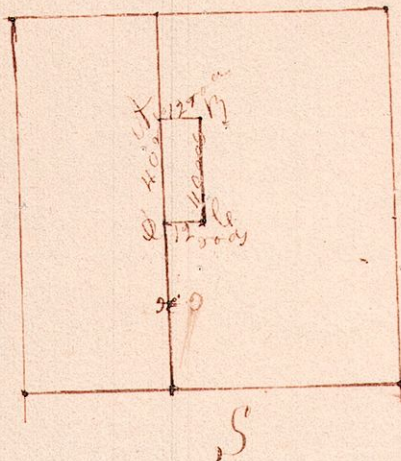

(M)

(C)

(A stone
B stone
C stone
D stone)

(A bearing trees) nearly
the corners marked by stones

Surveyed the above for Aaron Reim Widnes,
Mar. 14. 1860 being 3 acres out of the North East
Quarter of sec. five R. 4 T. P. 8. commencing & described
as follows: commencing 80 rods east of a stone on the
west line of said q. (said stone on said line being ninety seven
rods north of the south west ^{corner} of said q.)
thence West 40 rods; thence south 12 rods; thence East
110 rods; thence North 12 rods to the place of beginning

A. ought to have been platted at S. & Sat. &
chain carriers Jacob Shoop & Joseph Estance
Widnes

Joseph Edgar C. S. No. 6