

Section 4 T. 7. Range 6  
E.S.

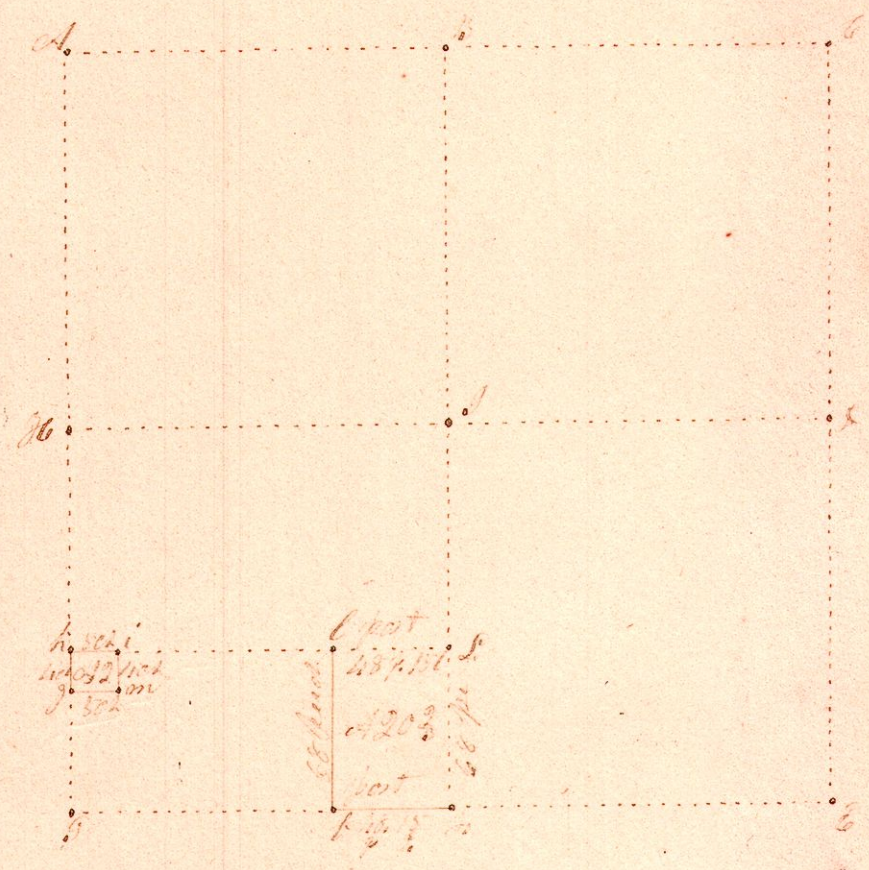

Surveyed the above September the 22<sup>nd</sup> 1834.  
 Being a dower taken out of the south part of  
 the south west quarter of section 4 T. 7. Range 6  
 which south part contains 68 acres. Dower bounded  
 as follows commencing at the south east corner of said  
 quarter thence west 48 paces thence north 16 1/2  
 to a post thence east 16 paces thence south 16 paces  
 to a stone the place beginning containing 20 3/4 acres  
 Also commencing at a post 16 paces north of the south  
 west corner of said quarter thence east 16 paces to a post  
 thence south 16 paces to a post thence west 16 paces to a  
 post thence north 16 paces to the place of beginning contain  
 2 acres.  
 J. Mable Secy of W. M. D. Co.  
 W. M. D. Co. 18 1/2 W. M. D. Co.  
 J. Fagwood & S. 18 1/2 W. M. D. Co.