

Section 8 Twp 13 N 13

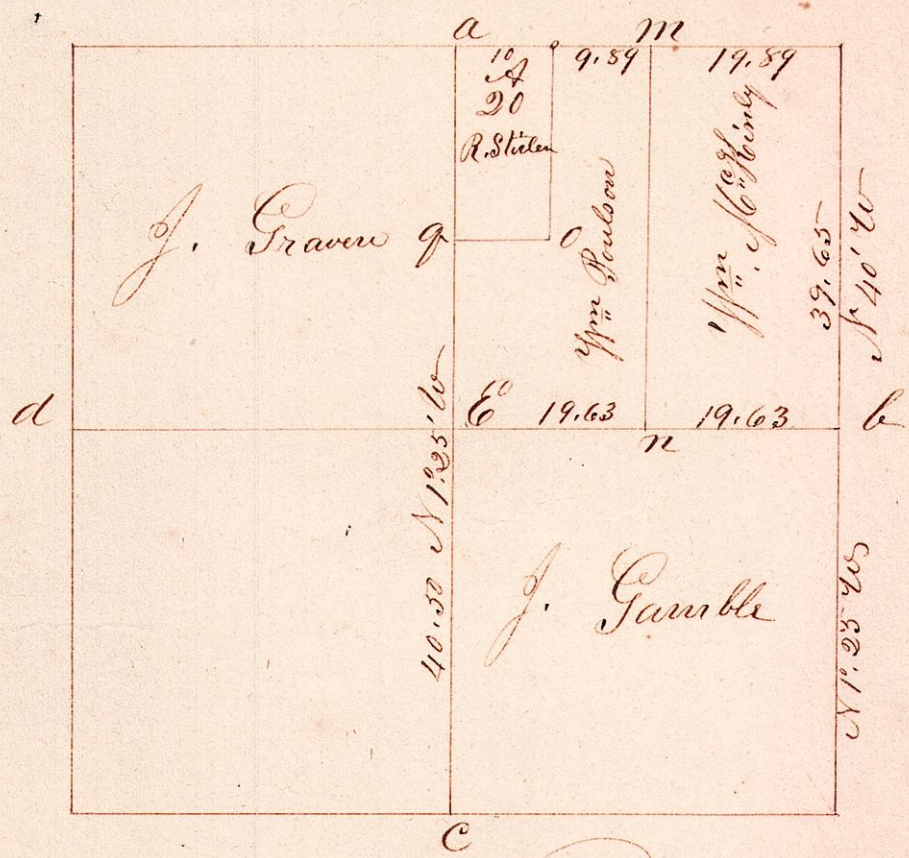

Bearing Trees

Station	Timber	It	Course	Distance in Links
m	W. Oak	23	S 9° W	38 links
	do	20	N 28° W	16 "
n	W. Oak	30	N 69° W	30 "
	do	20	S 29° E	31 1/2 "
o	W. Oak	18	N 30° E	16 1/2 "
	do	16	N 38° W	21 "
q	Dogwood	4	N 24° E	15 "
	B. Oak	4	S 39° W	7 1/2 "
e	W. Oak	23	N 45° W	41 "
c	W. Oak	18	S 88 3/4° W	25 "
b	W. Oak	24	N 29 1/2° E	63 " Established by Testimony of Wm McKinley
d	W. Oak	22	N 25° E	40 "

Surveyed the above for Wm Poulson and others - lawful notice being given to the landholders - The East of course could not be found, it was established by testimony of Wm McKinley -
 April 1851
 Jackson Silcott S. & C.