

Map 8. Range 4 Section 4 S. E. Q.

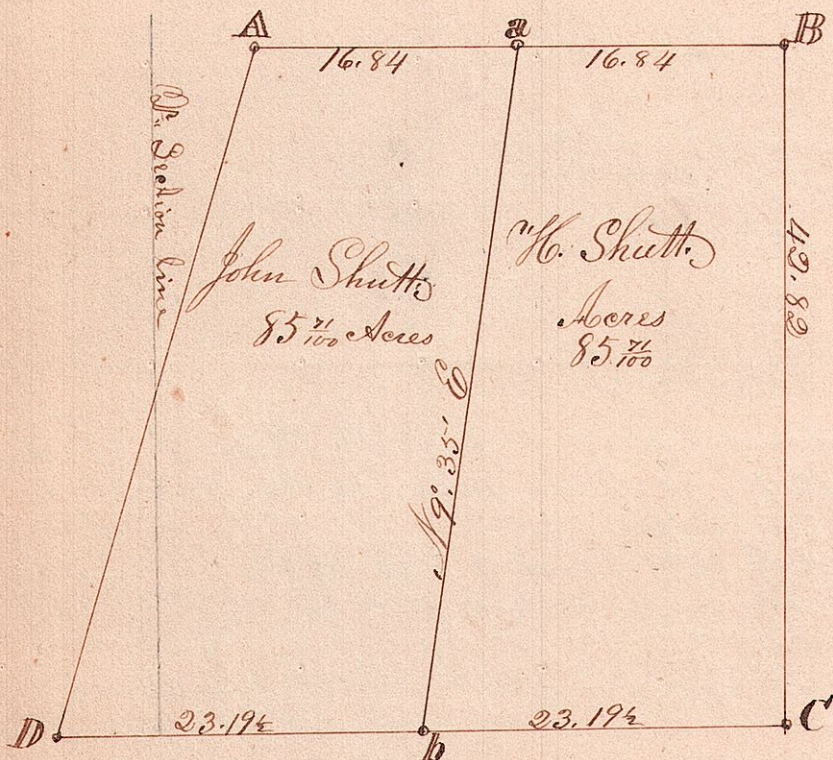

Notes of the Above Survey

- A. Corner made by Surveyor Robison
- a. Hickory 9 S 22 W, 16 S Chest 15 S 22 E 55
- B. Elm 13 S 72 W, 56 S W. Oak 30 N 32 E 56
- C. W. Oak 20 N 64 E 40
- b. Swamp White Oak 30 S 86 E 55

D. Stone, planted by order of Surveyor Robison
 The above was surveyed by me on the 7th of February
 1857 for John & Henry Shutt, being parts of the S. E. and
 S. W. qrs of the above described section, as shown by
 the above Plat

Jackson Gilcott, Co. S. H. C.