

Township 8 Range 8 Section 11 (Hillbuck)



The above is 20 Acres sold for Taxes, out of the N.W. corner of the S.E. 1/4 of section 10 T⁸ R⁸ S. Surveyed according to the above Plat. A being the N.W. corner of the Quarter Surveyed for Hugh James. May 1848

J. Silcott (Co. Surveyor)

In Surveying the above there was not a thorough survey made. I commenced at A, a corner already made, as to the correctness of it, I cannot say.

Township 9 Range 9 (On Kenose Sp)

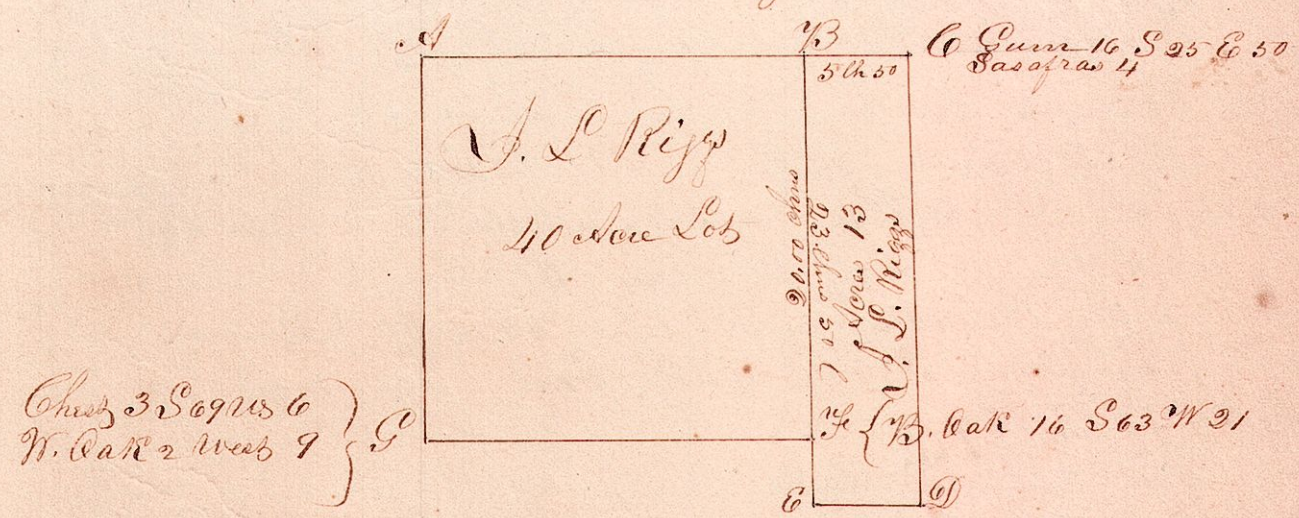

The above is the Plat & notes of two Lots Surveyed for John L. Riggs May 1848. The 40 Acre lot is the N.E. 1/4 of the East-half of sec 13 T⁹ R⁹ S. The 13 Acre lot is part of Lot No 44 (Military)

Remarks

The Original bearings at B are not to be found. I took a corner made by A. Wheaton

J. Silcott (Co. Surveyor)