

EXHIBIT A

LPA RX 851 WD

Page 1 of 2

Rev. 06/09

Ver. Date 7/26/22

PID 111413

**PARCEL 2-WD1
HOL-SOUTH WASHINGTON STREET SIDEWALKS
ALL RIGHT, TITLE AND INTEREST IN FEE SIMPLE
IN THE FOLLOWING DESCRIBED PROPERTY
WITHOUT LIMITATION OF EXISTING ACCESS RIGHTS
IN THE NAME AND FOR THE USE OF THE
VILLAGE OF MILLERSBURG, HOLMES COUNTY, OHIO**

Grantor/Owner, for himself and his heirs, executors, administrators, successors and assigns, reserves all existing rights of ingress and egress to and from any residual area (as used herein, the expression "Grantor/Owner" includes the plural, and words in the masculine include the feminine or neuter).

[Surveyor's description of the premises follows]

Situated in the State of Ohio, County of Holmes, Village of Millersburg, and being a part of the Northeast Quarter of Section 19, Township 9, Range 7,

Being part of Out Lot 83 conveyed to Millersburg MHP LLC by Volume 282, Page 2589 of Holmes County Official Records, being on the left side of a centerline of right of way of United States Route 62, State Route 83 and South Washington Street, 50 foot right of way, project HOL-SOUTH WASHINGTON STREET SIDEWALKS and bounded and described as follows:

Beginning for the same at a 2 inch iron pipe found, known as the Southwest corner of the Northeast Quarter of Section 19;

Thence S 88° 14' 47" E, 518.50 feet along the quarter section line to a point in the centerline of right of way of South Washington Street, Station 1050+61.98;

Thence N 09° 46' 58" W, 118.03 feet along the centerline of right of way of South Washington Street to a point, station 1051+80.01, being a southeasterly corner of the Grantor's lands and the True Place of Beginning of the parcel herein described;

Thence with the following FOUR courses:

- 1) **N 88° 40' 39" W, 30.57** feet along the Grantor's southerly line and in part the northerly line of the lands conveyed to Midflow Holdings, LTD., (O.R. V-258, P-1488), to a point being 30.00 feet left of and at right angles to centerline of right of way station 1051+85.90;

EXHIBIT A

LPA RX 851 WD

- 2) **N 09° 46' 58" W, 25.48** feet to a MAG nail set in the Grantor's northerly lot line and the southerly lot line of the lands conveyed to the Grantor by O.R.V.-282, P-2586, being 30.00 feet left of and at right angles to centerline of right of way station 1052+11.38;
- 3) **S 88° 40' 39" E, 30.57** feet along the Grantor's interior lot line to a point in the centerline of right of way of South Washington Street, Station 1052+05.49;
- 4) **S 09° 46' 58" E, 25.48** feet along the centerline of right of way of South Washington Street to the place of beginning and containing 0.018 of an acre, more or less, of which the present road occupies 0.015 of an acre, more or less, resulting in a net take of 0.003 of an acre, more or less.

The above described parcel being part of auditor's permanent parcel number 07-01413-000

Bearings are based upon Grid North of the Ohio State Plane Coordinate System, NAD83 (2011), North Zone.

This description was prepared and reviewed by Mark E. Purdy, P.S. No. 7307 and is based on a survey in 2020 by Shaffer, Johnston, Lichtenwalter & Associates, Inc. made for the Village of Millersburg.

The Stations are from the centerline of right of way of United States Route 62 as found on Right of Way Plan HOL-62-30.649.

Survey Recorded in Plat Vol. 19, Pg. 4793.

Parcel Number: 0701413001

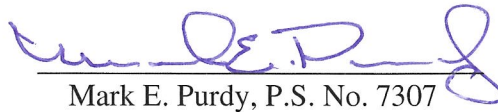
Mark E. Purdy, P.S. No. 7307

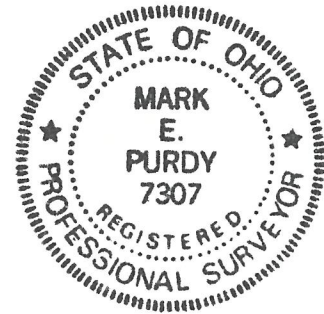

FILE DESCRIPTION
Holmes County Map Office
10/4/2022

2 of 2