

*Holmes County Recorder*

**HOLMES COUNTY  
OHIO**

**1979 PLAT BOOK**







*Compliments of*

**THE  
KILLBUCK SAVINGS  
BANK COMPANY**

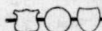
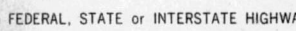
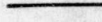
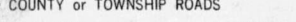
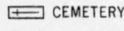
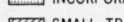
**KILLBUCK - BERLIN, OHIO**

*T & C*  
PUBLICATION

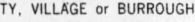
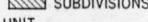
 FEDERAL, STATE or INTERSTATE HIGHWAYS  
 COUNTY or TOWNSHIP ROADS  
 RAILROADS  
 CANAL  
 CEMETERY  
 INCORPORATED CITY, VILLAGE or BURROUGH  
 SMALL TRACTS  
 DWELLING or FARM UNIT  
 LEGEND  
 INCORPORATED CITY, VILLAGE or BURROUGH  
 SUBDIVISIONS

TOWNSHIP 9-N.  
RANGE 5&6-W.

**BERLIN**

SCALE IN MILES  
1/2 1

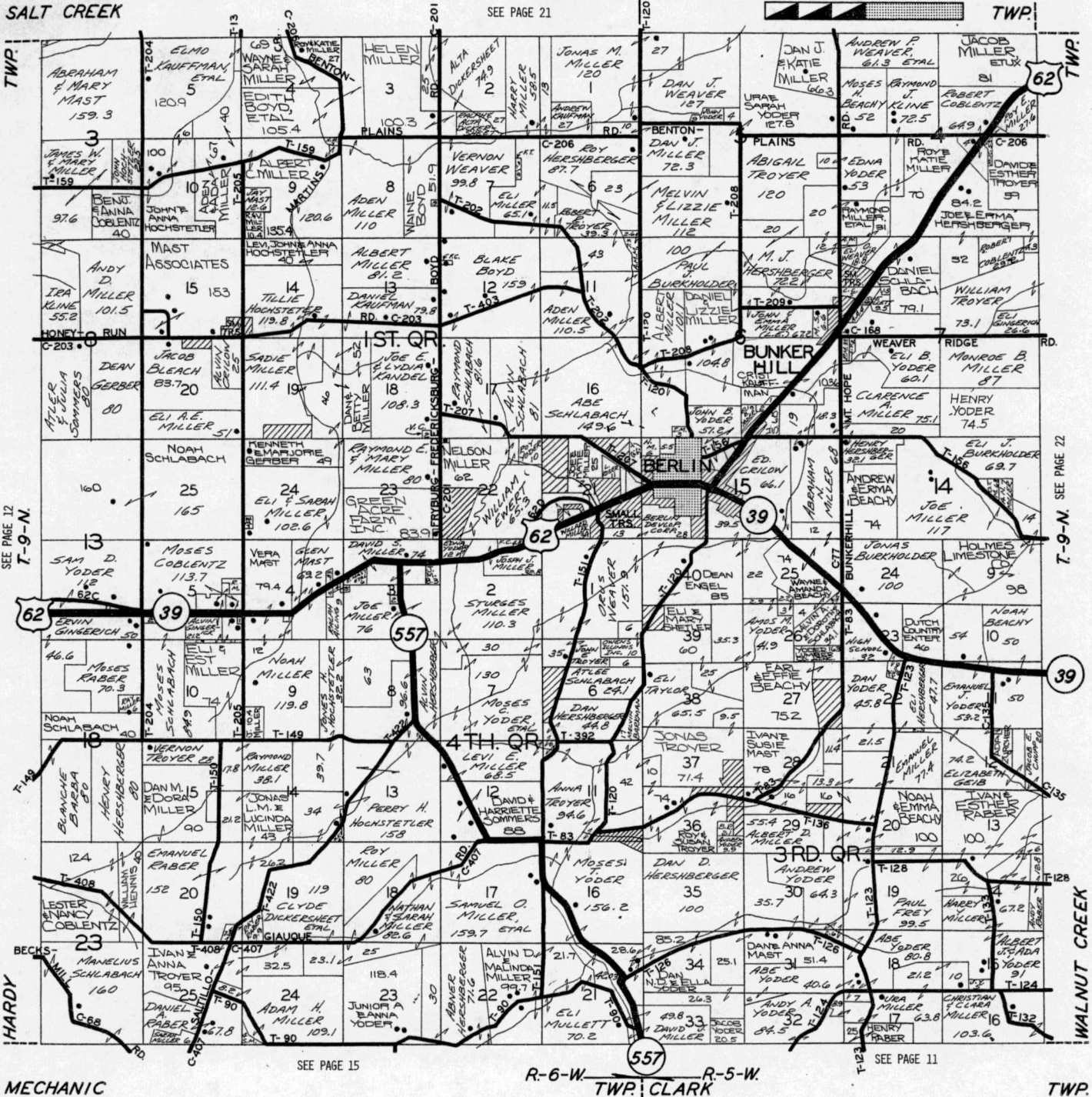

Town & Country Publishing Co., Inc.

Please Contact Us When . . .

1. YOU NEED A MAP
2. YOU NEED A PLAT BOOK
3. YOU KNOW OF MISTAKES IN OUR BOOK
4. YOU KNOW HOW TO MAKE THIS BOOK MORE USEFUL

PHONE: 219/362-8508  
P.O. BOX 689 • LA PORTE, IN 46350

# CLARK

## TOWNSHIP 8-N. RANGE 4&5-W.

BERLIN TWP.

TWP. WALNUT CREEK

SEE PAGE 22

R-5-W  
R-4-W  
SEE PAGE 22

TWP.

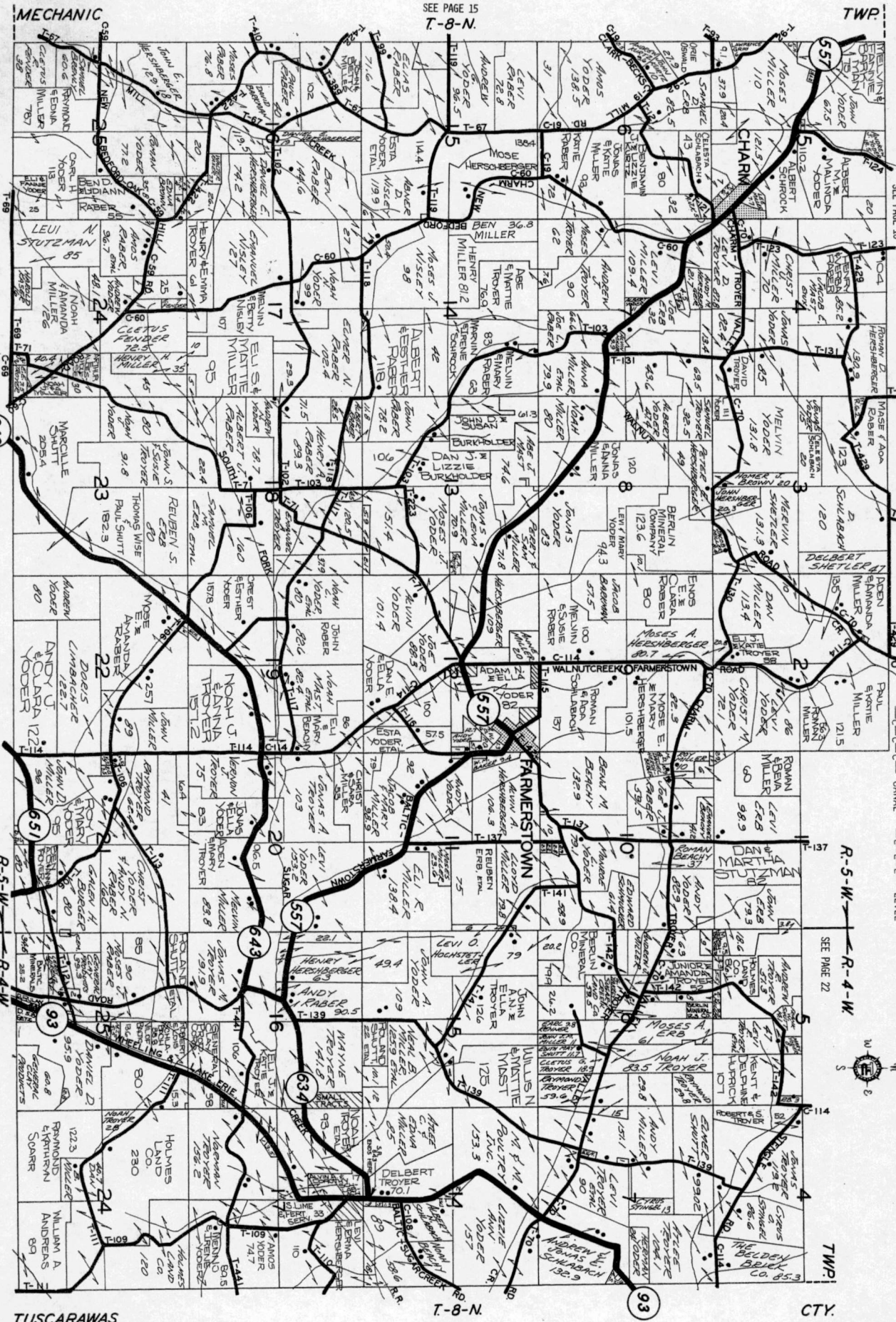
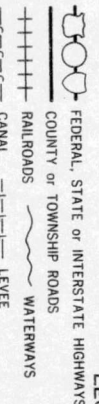

SEE PAGE 15  
T-8-N.

COSHOCTON

T-89

T-88

T-87

T-86

T-85

T-84

T-83

T-82

T-81

T-80

TUSCARAWAS

T-8-N.

CTY.

**LEGEND**

- FEDERAL, STATE or INTERSTATE HIGHWAYS
- INCORPORATED CITY, VILLAGE or BURROUGH
- TOWNSHIP ROADS
- RAILROADS
- WATERWAYS
- CANALS
- LEVEL
- CEMETERY
- SMALL TRACTS
- SUBDIVISIONS
- DWELLING or FARM UNIT

**TOWNSHIP 9-N.**  
**RANGE 6&7-W.**

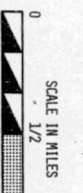

**HARDY**

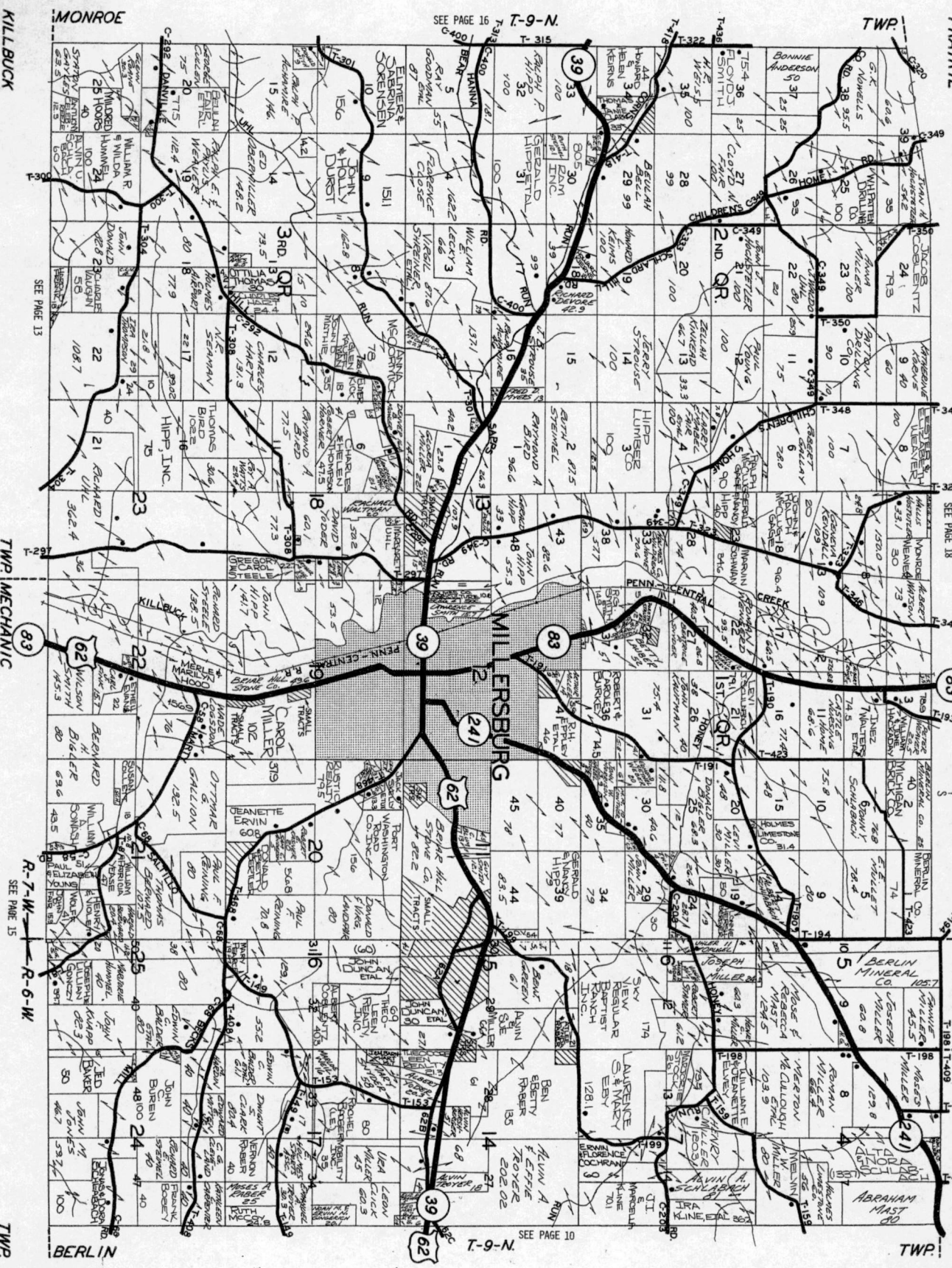

SEE PAGE 16 T-9-N.

SEE PAGE 10 T-9-N.

TWP. 18-N

TWP. 17-N

TWP. 16-N

TWP. 15-N

TWP. 14-N

TWP. 13-N

TWP. 12-N

TWP. 11-N

TWP. 10-N

TWP. 9-N

TWP. 8-N

TWP. 7-N

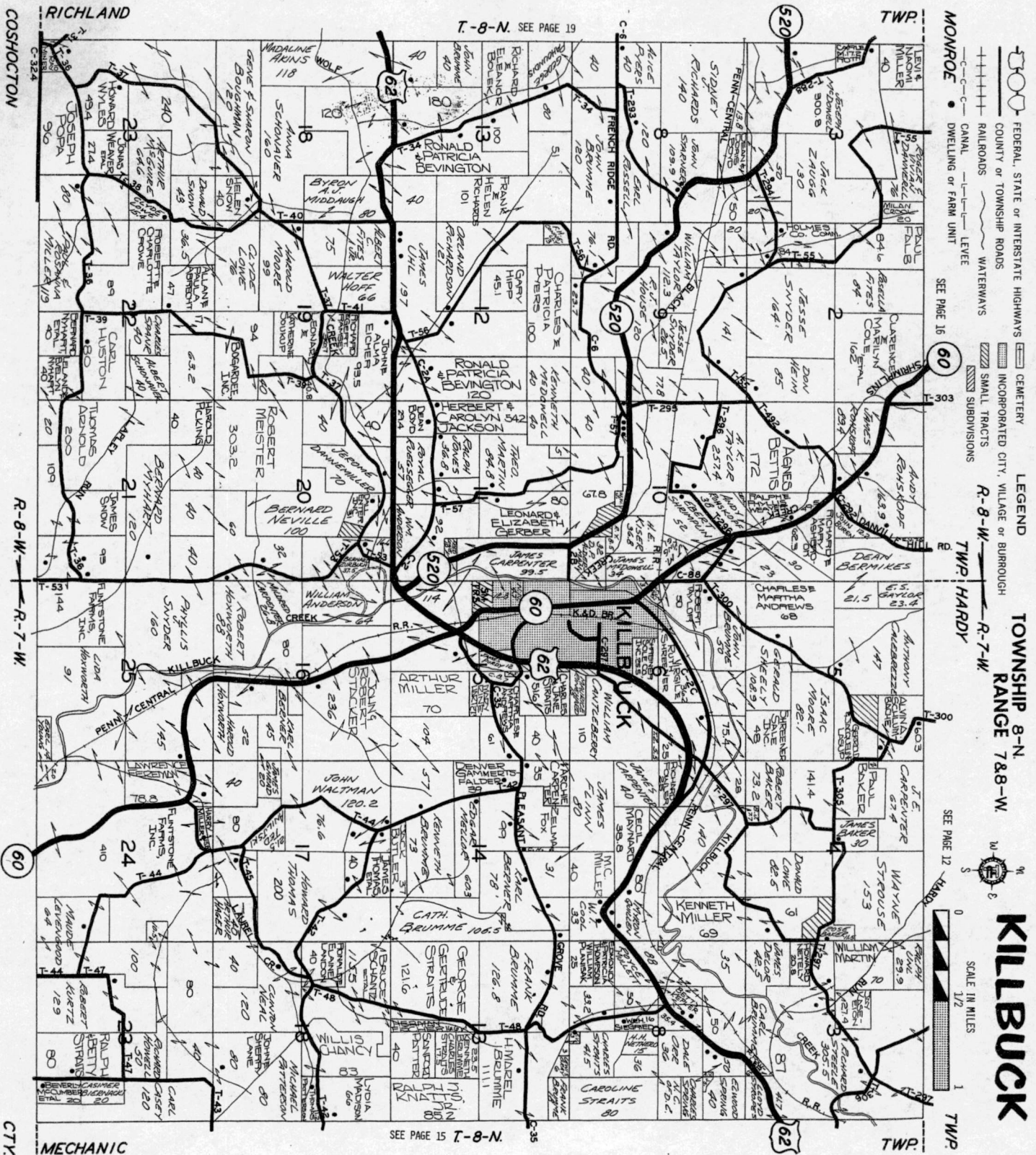

MILLERSBURG  
(216)674-8075

LOUDONVILLE  
(419)994-5030

# DONAHUE

## REALTORS

FARMS • HOMES • ACREAGE

LOTS • COMMERCIAL

WOOSTER  
(216)264-8055

NASHVILLE  
(216)378-3300

CTY.

TOWNSHIP 19-N  
RANGE 14 & 15-W

- LEGEND
- FEDERAL, STATE or INTERSTATE HIGHWAYS
  - COUNTY or TOWNSHIP ROADS
  - RAILROADS
  - WATERWAYS
  - CANAL
  - LEVEL
  - CEMETERY
  - INCORPORATED CITY, VILLAGE or BURROUGH
  - SMALL TRACTS
  - SUBDIVISIONS
  - DWELLING or FARM UNIT



SEE PAGE 23

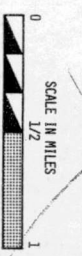

SEE PAGE 20

ASHLAND  
T-9-N T-19-N

KNOX

KNOX

KNOX  
RICHLAND

R-9-W  
SEE PAGE 19

TWP.

CTY.

NASHVILLE

TWP. RIPLEY  
R-15-W  
R-14-W

TWP.

SEE PAGE 16

MONROE

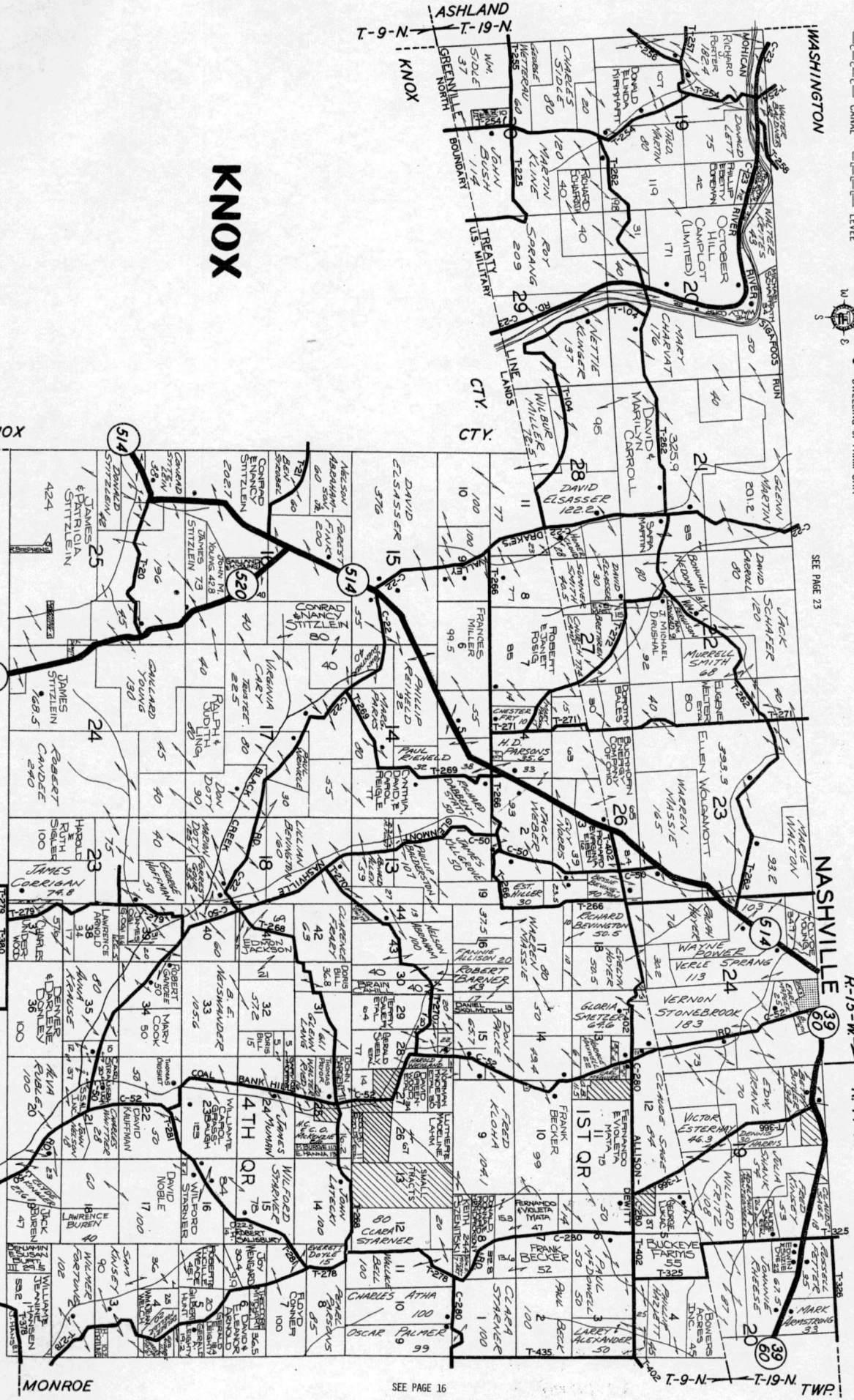

# MECHANIC

SCALE IN MILES  
1/2 1



SEE PAGE 10  
557 TWP.

TWP. BERLIN  
SALTILLO

R-7-W  
R-6-W

HARDY  
TWP.

TOWNSHIP 8-N.  
RANGE 6&7-W.

- LEGEND**
- FEDERAL, STATE or INTERSTATE HIGHWAYS
  - COUNTY or TOWNSHIP ROADS
  - RAILROADS
  - CANAL
  - LEVEE
  - CEMETERY
  - INCORPORATED CITY, VILLAGE or BURROUGH
  - SMALL TRACTS
  - SUBDIVISIONS
  - WATERWAYS
  - DWELLINGS or FARM UNIT

SEE PAGE 13 T-8-N.

T-8-N. SEE PAGE 11

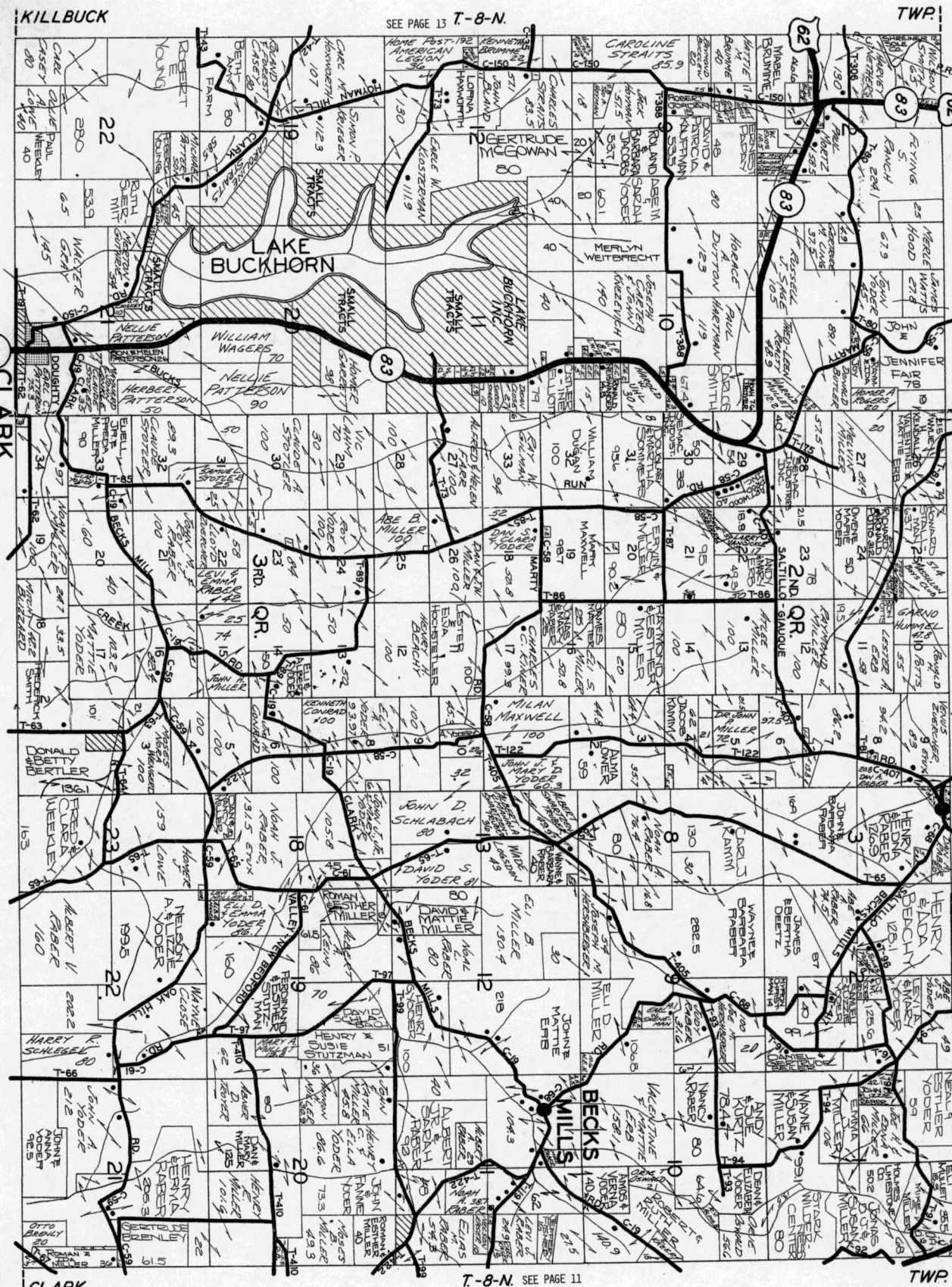

KILLBUCK

COSHOCTON

CLARK

CLARK

22

22

22

22

22

22

22

22

22

LAKE BUCKHORN

BECKS MILLS

3RD CR.

62

63

64

65

66

67

68

69

70

71

72

73

74

75

76

77

78

79

80

81

82

83

84

85

86

87

88

89

90

91

92

93

94

95

96

97

98

99

100

101

102

103

104

105

106

107

108

109

110

111

112

113

114

115

116

117

118

119

120

121

122

123

124

125

126

127

128

129

130

131

132

133

134

135

136

137

138

139

140

141

142

143

144

145

146

147

148

149

150

151

152

153

154

155

156

157

158

159

160

161

162

163

164

165

166

167

168

169

170

171

172

173

174

175

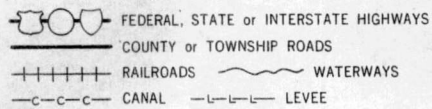

**LEGEND**  
 CEMETERY  
 INCORPORATED CITY, VILLAGE or BURROUGH  
 SMALL TRACTS  
 DWELLING or FARM UNIT

**TOWNSHIP 9-N.**  
**RANGE 8-W.**  
**14-W.**  
**MONROE**  
 SCALE IN MILES  
 0 1/2 1

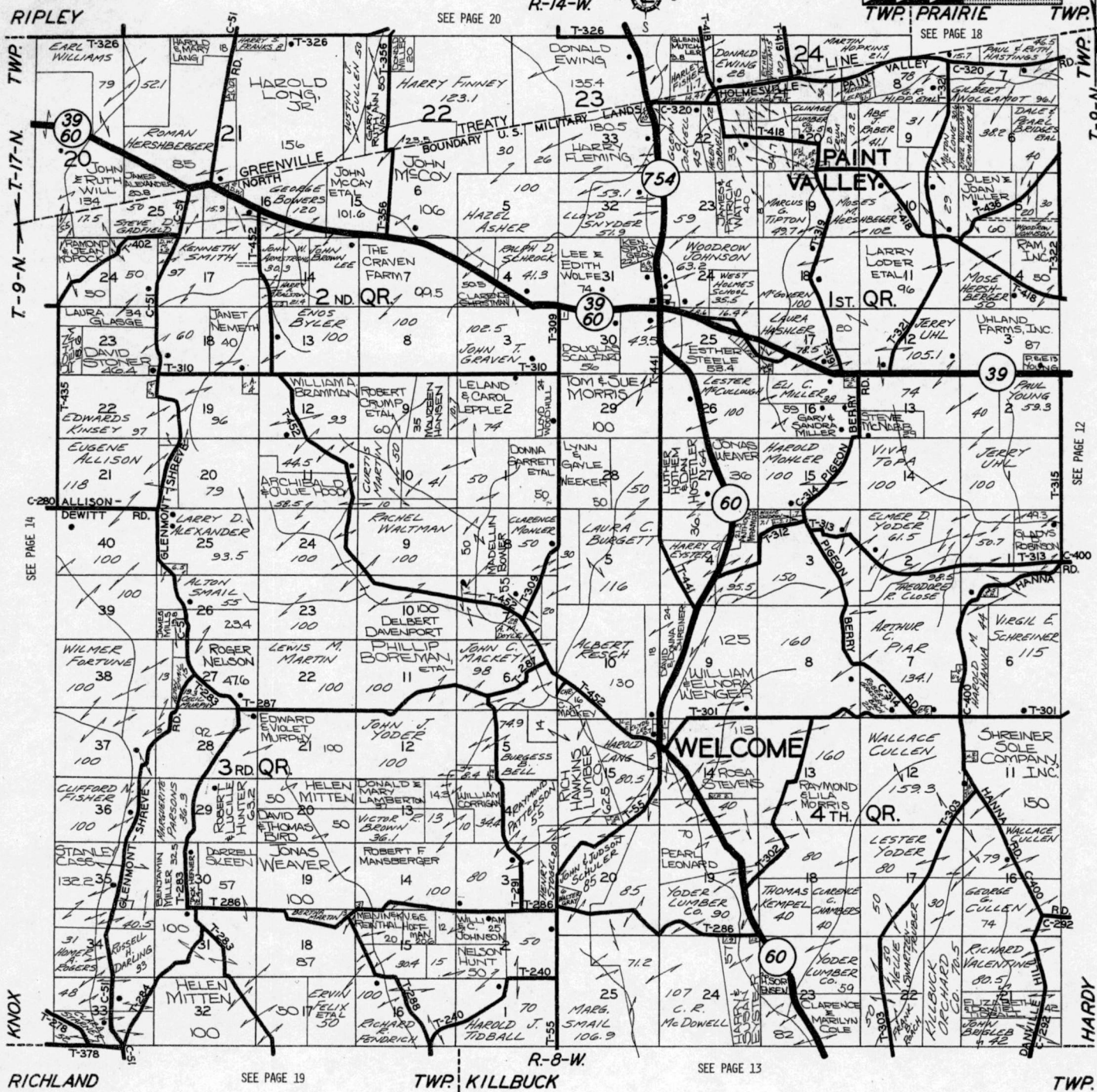

**RIFLES • SHOTGUNS • PARTS & SERVICE**  
**HERSBERGER GUN SHOP**  
 SHOOTING ACCESSORIES • CUSTOM RELOADING  
 JONAS HERSBERGER - GUNSMITH  
 On County Road 60 - 1 1/2 miles South of Charm

Rural Route #3  
 Millersburg, OH 44654



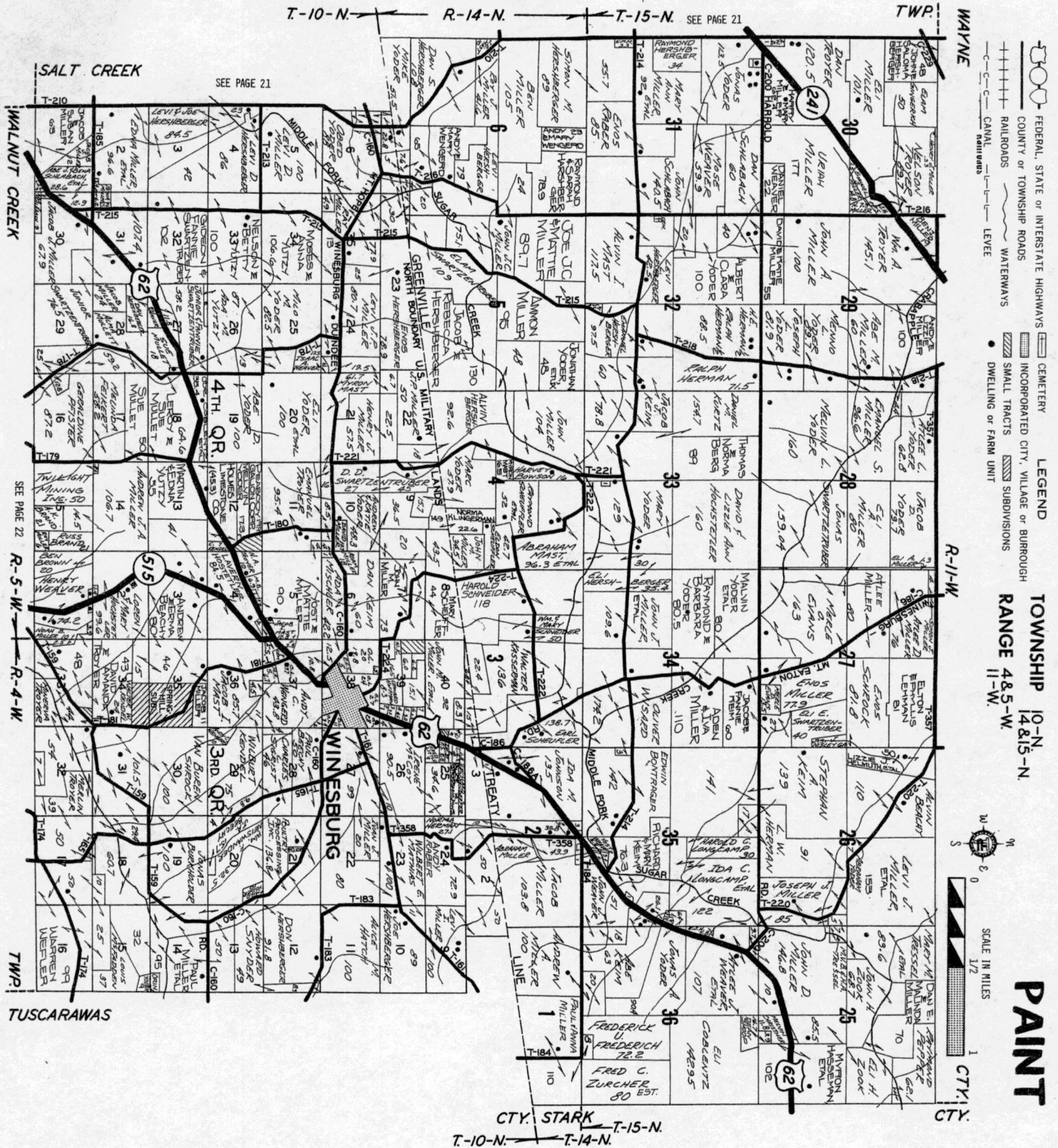

FOR FURTHER INFORMATION PLEASE CONTACT.....

**FARM ORGANIZER - Record Books**

TOWN & COUNTRY PUBLISHING CO., INC.

PHONE (219) 362-8508

P.O. Box 689 - 1012 Monroe Street - LaPorte, IN 46350

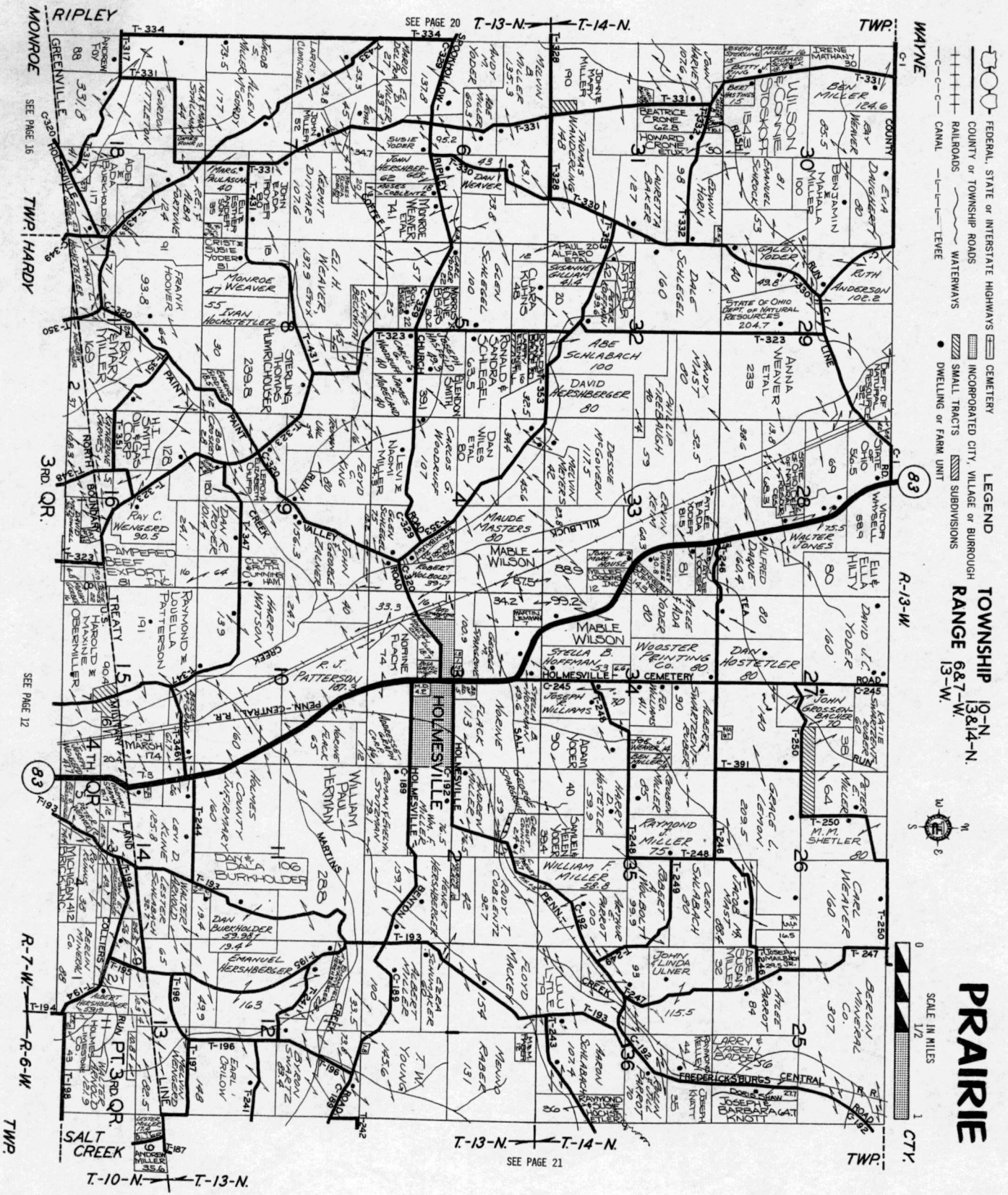

# BALTIC STATE BANK

A FULL SERVICE BANK

Serving a Three County Area

MEMBER FDIC

BALTIC, OHIO 43804

PHONE (216) 897-6401

COSSHOCTON

R-9-W

R-8-W

CTY.

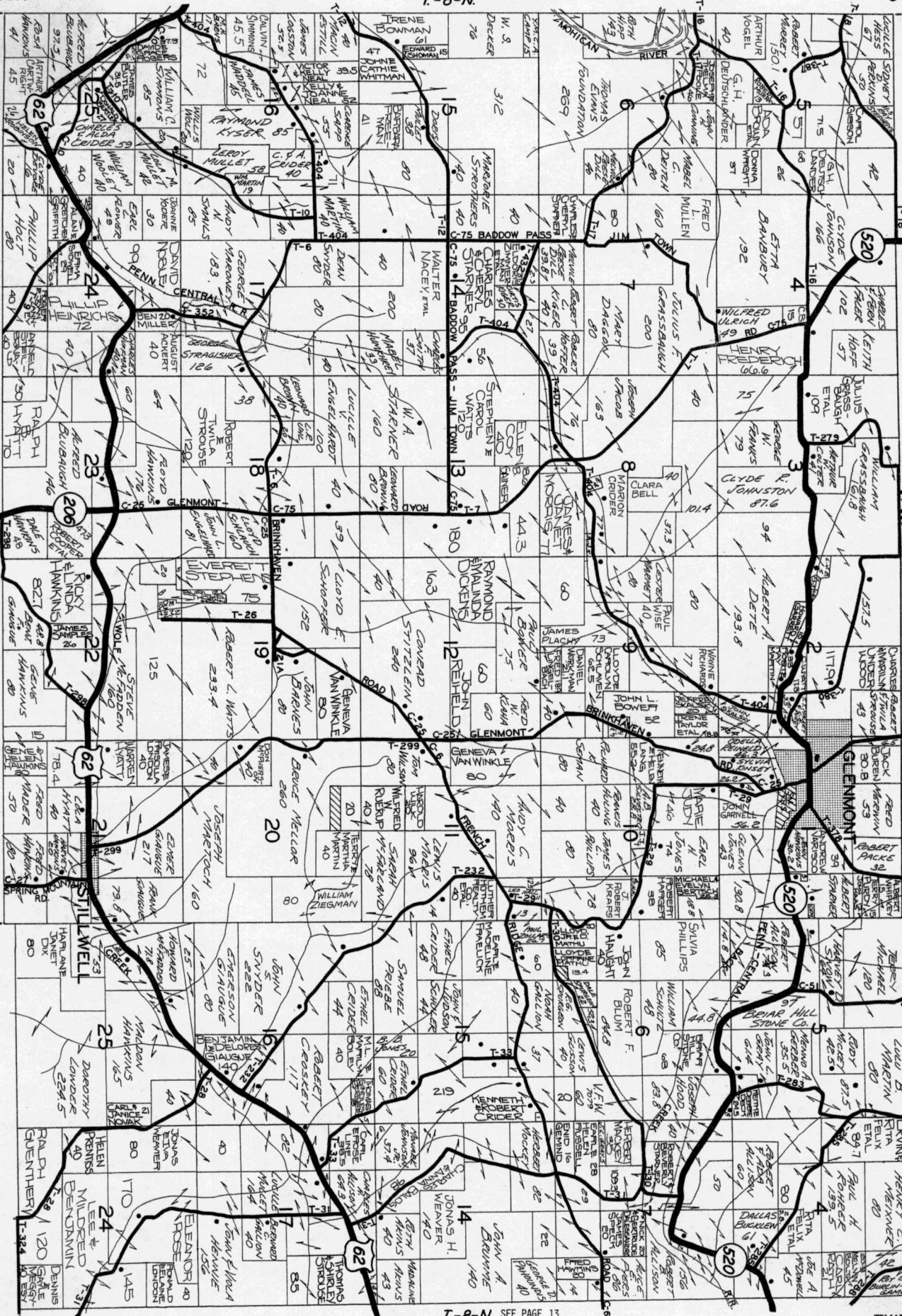

**LEGEND**

- FEDERAL, STATE or INTERSTATE HIGHWAYS
- COUNTY or TOWNSHIP ROADS
- INCORPORATED CITY, VILLAGE or BURROUGH
- RAILROADS
- WATERWAYS
- CEMETERY
- SMALL TRACTS
- SUBDIVISIONS
- DWELLING or FARM UNIT

SEE PAGE 14 T-8-N  
SCALE IN MILES 0 1/2 1  
SEE PAGE 16 T-8-N

TOWNSHIP 8-N.  
RANGE 839-W.

TWP. MONROE

**RICHLAND**

TWP.

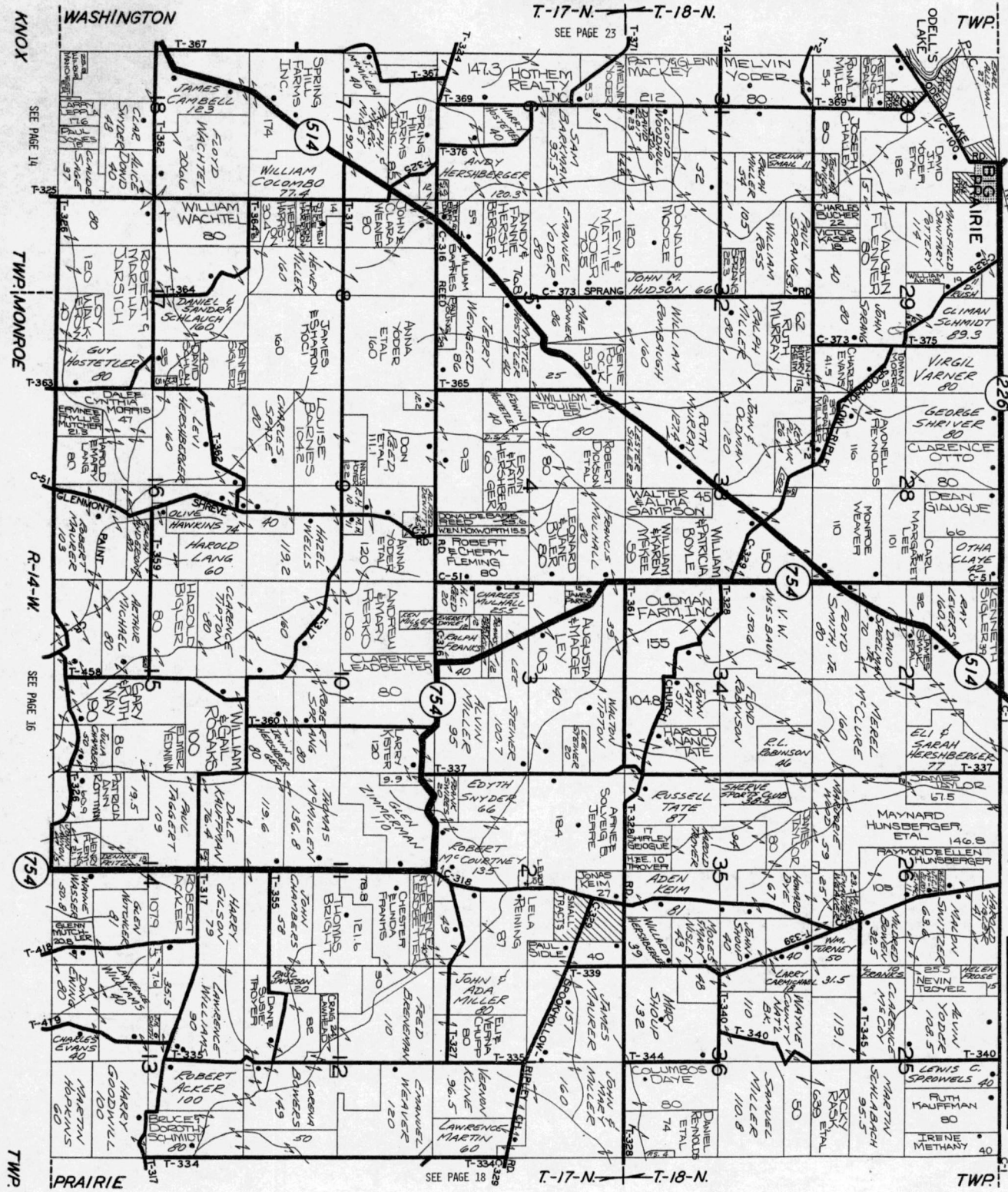

FEDERAL, STATE or INTERSTATE HIGHWAYS  
 COUNTY or TOWNSHIP ROADS  
 RAILROADS  
 WATERWAYS  
 CANAL  
 LEVEE  
 LEGEND  
 INCORPORATED CITY, VILLAGE or BURROUGH  
 SMALL TRACTS  
 SUBDIVISIONS  
 DWELLING of FARM UNIT  
 TOWNSHIP 17 & 18 - N.  
 RANGE 14 - W.  
 RIPLEY  
 SCALE IN MILES  
 0 1/2 1  
 C.T.Y.

**Wayne Savings** "WE MAKE HOUSES HAPPEN"  
 AND LOAN COMPANY  
 11 NORTH CLAY STREET - MILLERSBURG, OHIO  
 PHONE 674-5085  
 ASHLAND • WOOSTER • BARBERTON • RITTMAN



FEDERAL, STATE or INTERSTATE HIGHWAYS CEMETERY  
 COUNTY or TOWNSHIP ROADS INCORPORATED CITY, VILLAGE or BURROUGH  
 RAILROADS WATERWAYS SMALL TRACTS SUBDIVISIONS  
 CANAL LEVEE DWELLING or FARM UNIT

# WALNUT CREEK

TOWNSHIP 8&9-N.  
 RANGE 4&5-W.

R-5-W

R-4-W

SEE PAGE 17

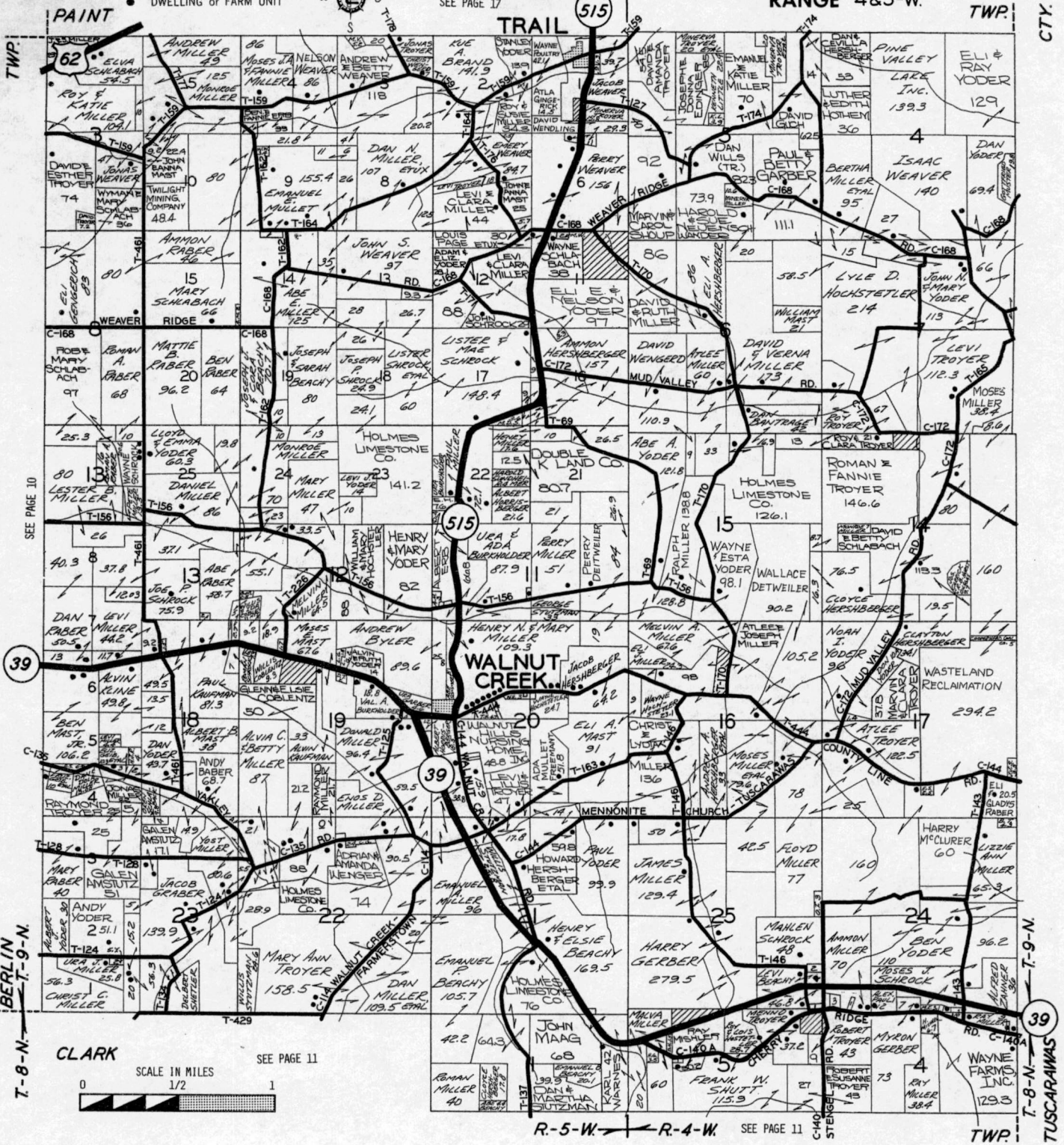

## MAP SERVICE

Town & Country Publishing Co., Inc. reproduces individual maps found in this book on an enlarged size and sells individual maps as well as a county package. Write for further information



**Town & Country Publishing Co., Inc.**

PHONE (219) 362-8508

P.O. Box 689, 1012 Monroe St, LaPorte, IN 46350

ASHLAND

T-19-N T-20-N

CTY. ASHLAND

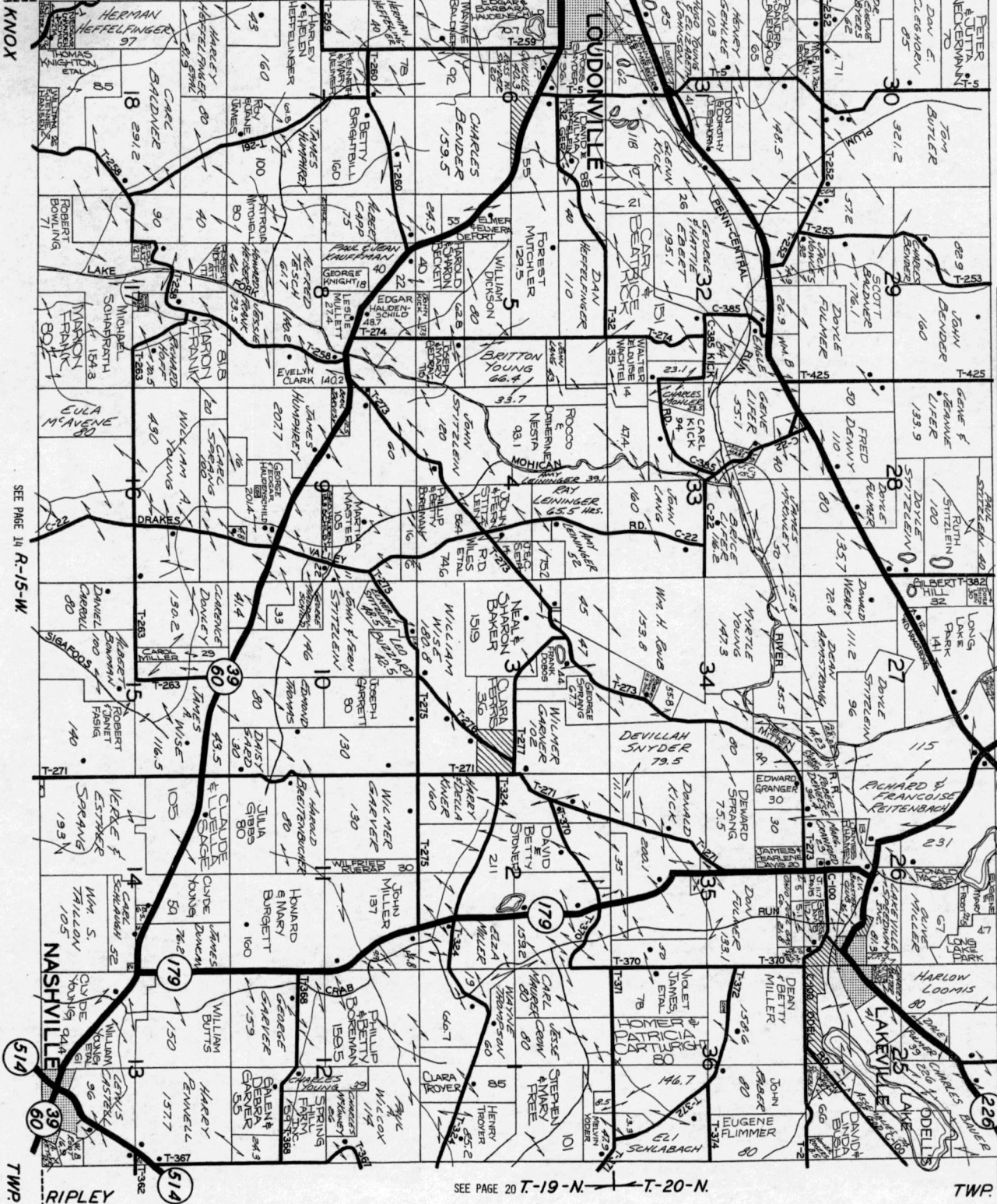

**LEGEND**

- FEDERAL, STATE or INTERSTATE HIGHWAYS
- COUNTY or TOWNSHIP ROADS
- RAILROADS
- CANAL
- CEMETERY
- INCORPORATED CITY, VILLAGE or BURROUGH
- SMALL TRACTS
- SUBDIVISIONS
- DWELLING or FARM UNIT

SCALE IN MILES  
0 1/2 1

R-15-W

CTY. WAYNE

TOWNSHIP 19&20-N RANGE 15-W

WASHINGTON CTY. WAYNE

SEE PAGE 20 T-19-N T-20-N

**SOLD** also WAS HERE!

**Swinehart** realty

**264-2511**

146 E. Bowman St. Wooster, O.

Whether buying or selling Real Estate...  
Call on us for Quick Courteous Service!

**REALTOR**

**MLS**