

- Stutzman Subdivision**
- First Stutzman Subdivision, Plat 2A-167 Platted 9/16/1977 Lots 1 thru 7
 - Second Stutzman Subdivision, Plat 6-174, 175 Platted 7/6/1978 Lots 8 thru 16 (Lots 12 and 13 re-platted see P.2-250)
 - Third Stutzman Subdivision, Plat 2A-169 Platted 6/22/1979 Lots 17 thru 28
 - Revision of Lot 28, Plat 9-80 Platted 12/18/1980 Revised Lot 24 and Lot 24A
 - Report of Lots 18 and 19, Plat 12-208 Platted 5/8/1989 Lots 18A, 18B and Revised Lot 19
 - Report of Lot 21, Plat 13-134 Platted 5/9/1991 Lots 29 and 30
 - Report of Lots 29 and 30, Plat 16-988 Platted 1/27/1999 Lots 34 and 35
 - Report of Lots 22 and Part Lot 23, Plat 13-160 Platted 5/27/1992 Lots 31, 32 and 33
 - Report of Lots 24 and 24A and Part Lot 23, Plat 19-1440 Platted 12/29/2008 Lots 36 and 37
- Richard Weaver Allotment No. 1**
- Plat 2-250 Platted 7/26/1995
- Somerset Allotment No. 1**
- Plat 2-417 Platted 4/8/1999 Lots 1 thru 3
 - Report of Lots 1 and 2, Plat 19/857 Platted 11/3/2006 Lots 4 and 5
- Garden View Subdivision**
- Plat 2-417 Platted 12/30/2005 Lots 1 thru 3 (also on map B-14)
 - Report of Lots 1 and 3, Plat 2-517 Platted 9/13/2012 Lots 4 and 5 (also on map B-14)
- Water's Edge Subdivision**
- Plat 19-698 Platted 5/5/2006
- Coblenz Drive Subdivision**
- Plat 15-103 Platted 8/20/1996 Lots 1 thru 5 (also on map B-14)
- Berlin West Subdivision**
- Plat 17-196 Platted 7/28/1999
- Walnut Grove Allotment No. 1**
- Plat 17-534 Platted 6/21/2000 Lots 1 and 2
- Parkview Subdivision**
- Plat 2-129 Platted 1/10/1968 (also on map B-18A)
- Willard Miller Allotment Number One**
- Plat 2-63 Platted 5/27/1957
- Berlin Hills Condominium (D.V.242-615 3/20/1989)**
- Condominium terminated 10/26/2012 OR 238-2758
- Laurel Run Condominium**
- 243-718 6/14/1989
 - 248-645 9/13/1990
- Unit 5545A** Jared and Emily Coblenz
0150003006 OR.238-2527 10/25/2012
- Unit 5545B** Rachel Kaufmann
0150003007 245-147 10/25/1989
- Unit 5545C** Dustin A. Kaufman
0150003008 OR.235-425 6/6/2012
- Unit 5547A** Chester D. Mullet
0150003002 OR.178-18 2/2/2005
- Unit 5547B** Duane A. Yoder
0150003003 OR.215-1658 12/16/2009
- Unit 5549A** Steven D. Hershberger
0150003004 OR.185-2984 12/30/2005
- Unit 5549B** Bonnie Miller
0150003005 245-350 10/25/1989
- Unit 5567A** Nathan S. Mast and Karla N. Mast
0150003010 OR.217-2227 4/13/2010
- Unit 5567B** Sandra S. Coast
0150003011 OR.126-223 10/23/2002
- Unit 5569A** James E. Hershberger
0150003001 OR.185-467 12/2/2005
- Unit 5569B** Michael D. Troyer
0150003009 OR.210-1967 5/5/2009

- 0100563000 ① Timothy and Crystal Hochstetler
OR.180-3154 6/15/2005
0.152 ac p.8-377
- 0100003000 ② East Holmes Board of Education
DV.239-88 5/20/1988
0.093 ac p.7-414
- 0100439001 ③ East Holmes Board of Education
OR.471-822 2/25/2000
0.018 ac p.17-603
- 0100546001 ④ Ronald K. and Marlene A. Oswald
276-233 11/20/1996
0.085 ac
- 0100281000 ⑤ Ronald K. and Marlene A. Oswald
231-916 8/8/1986
231-918 8/8/1986
0.110 ac p.3-298
- 0100545001 ⑥ Ronald K. and Marlene A. Oswald
276-233 11/20/1996
0.147 ac
- 0100000000 ⑦ not used
- 0101214002 ⑧ NW part Lot 17 Stutzman SD (p.12-208)
Duane A. and Carol Miller
OR.167-863 10/17/2003
0.019 ac p.16-243
- 0101215001 ⑨ E part Lot 18A Stutzman SD (p.12-208)
Corey Lee and Christina Conn
275-859 10/24/1986
0.053 ac p.16-243
- 0100000000 ⑩ not used
- 0100208000 ⑪ Christopher J. Dages and
Debra L. Mullet
OR.201-1078 11/30/2007
0.078 ac p.5-22
- 0100134000 ⑫ Marie R. and Rosalyn J. Mullet
281-763 12/9/1997
0.135 ac p.7-152
- 0100212000 ⑬ E part Lot 2 Willard Miller Allot. (p.2-63)
Martha S. Mast, trustee
OR.46-86 1/25/2000
0.05 ac p.4-135
- 0100089000 ⑭ W part Lot 4 Willard Miller Allot. (p.2-63)
Lavonne S. DeBolis
OR.56-946 8/15/2000
0.057 ac
- 0100651000 ⑮ Laner Corporation
OR.226-1556 6/2/2011
0.042 ac p.3-92
- 0100867004 ⑯ Marion B. and Valerie L. Blazer
OR.78-71 6/13/2001
0.134 ac p.17-895
- 0100156001 ⑰ Dutchland Realty, Inc.
OR.100-22 1/17/2002
0.091 ac p.12-507
- 0100643002 ⑱ Nelson J. and Fannie E. Troyer
OR.167-863 10/10/2003
0.216 ac p.16-812

- 0100867005 ⑲ James A. and Carol S. Yoder
OR.194-329 1/3/2007
0.097 ac p.19-906
- 0101393000 ⑳ Lavonne Sheree Chunney
OR.27-362 3/4/1999
Lavonne S. DeBolis
OR.180-132 5/10/2005
OR.225-372 4/7/2011
0.1577 ac p.6-174

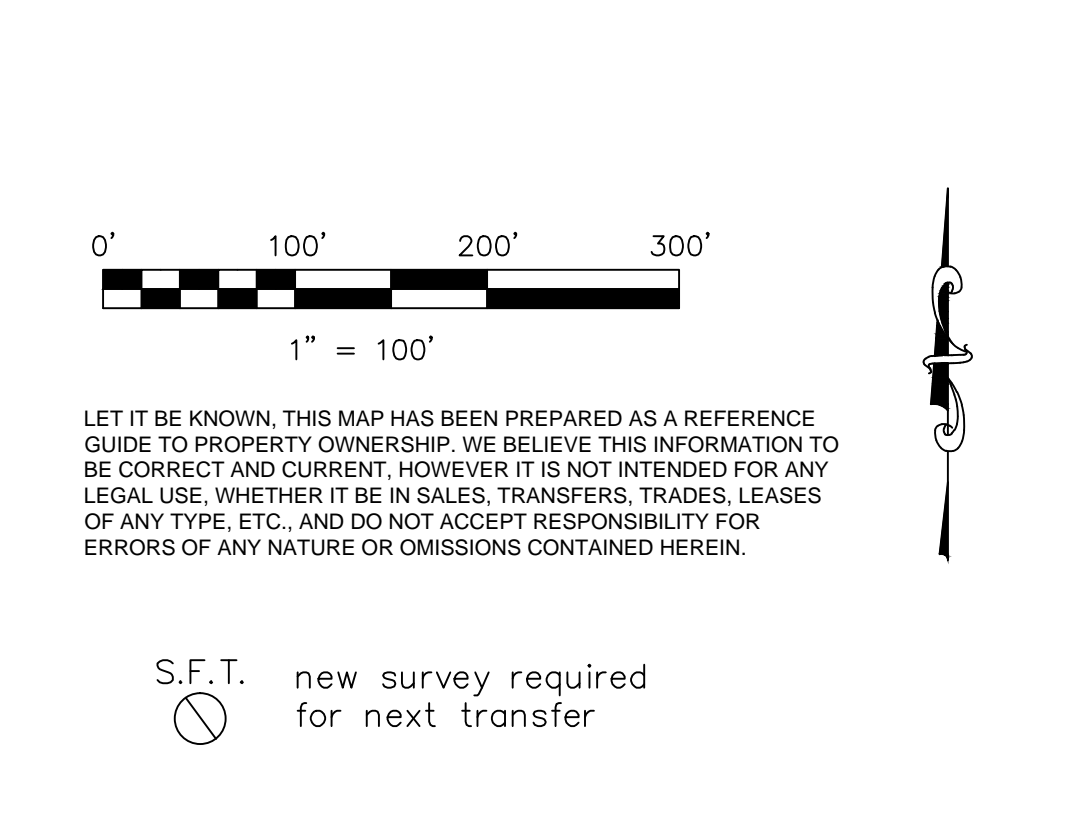

Last Revision: 12/27/2012

**T-9, R-6,
1st Qtr., Lot 21
Berlin Twp.
Holmes County, Ohio**

B-13B