

Sunday 9th July 1797 began a Survey of the line accord-  
ing to treaty by Gen<sup>l</sup> Wayne of Aug<sup>st</sup> 3<sup>rd</sup> 1795 at the upper  
place of the Tuscarawas branch of the Muskingum river above  
Fort Lawrence at a bottom Oak tree 10 inches in diameter  
standing on the west bank of said fork or river, which tree is  
notched with three notches on the North and west sides, with  
this inscription - Surveyed according to treaty by Gen<sup>l</sup> Wayne  
a line to Lincum S 78° 50' W

From which tree a hackberry  
3 inches in diameter, and a Cherry 14 inches in diameter bear  
South 51° 30' West - the Hackberry 25 lbs and Cherry 51 lbs  
distant - and a white Walnut 3 inches diameter bears North  
West 45 lbs distant - and a Sycamore on the East side of the  
river 8 inches in diameter bears South 51° East - the white wood  
ed with three notches and blazed above - Thence

Thence South 78° 50' West through a brushy plain of

S. 78° 50' W  
Ch. Pks.  
80.00

quality for the production of small grain -  
a post from which a white Oak 14 inches in diameter bears  
N 77 1/2° E 6.50 distant, Notched with 3 Notches and blazed, and  
marked #1 - One other white Oak 18 inches in diameter bears  
N 85 1/4° E - Notched & blazed as aforesaid - this Mile forest  
land of good quality - no timber -

S 78° 50' W

Commenced 2 Mile, at 40.00 entered timbered land  
45.6 a white Oak 20 inches in diameter in the line - a small  
arcuate South - 55.00 the Tuscarawas branch of Muskingum  
runs N.E & S.W - crossed the river into a brushy Parson  
a bottom Oak 20 inches in diameter notched on two sides with  
three notches -

80.00

A post from which a white Oak 15 inches in diameter bears  
S 49 1/4° E 1.41 distant, and another white Oak same diameter  
bears S 58° E 1.08 dist. notched 3 Notches & marked #2

Commenced Third Mile. — — —

- 35.90 A white oak 20 inches in diameter in the line —
- 46.75 Another white oak 20 inches in diameter in the line, with 3 notches.
- 52.00 Muskingum river running South 3.00 wide —
- 57.00 A stream 60 paces wide runs South —
- 72.00 a spring runs East rising on a small eminence. — — —
- 80.00 a Post from which a white oak tree 22 inches in diameter bears N. 3 bears North 44 links distant, and another white oak 20 inches in diameter bears N. 33 1/2 W 40 links distant. —

Commenced Fourth Mile

- 3.00 a spring running North —
  - 11.21 a white oak 15 inches in diameter — rising a brushy hill —
  - 25.00 descending the North side of a hill — much young chestnut timber —
  - 30.30 a Black oak 20 inches in diameter in the line —
  - 49.00 a stream runs North
  - 52.00 rising ground — oak timber
  - 58.20 a Black oak 22 inches in diameter in the line — ascending the hill gradually
  - 80.00 A Post from which a white oak 16 inches in diameter bears N 57 1/2 W 17 links distant — another white oak 20 inches in diameter bears North 15 links distant — marked M 4 — + 3 notches —
- this mile generally good farming land — proper for any kind of small grain. timber white & Black oak, hickory & walnut

Commenced Fifth Mile

- 11.70 a white oak 24 inches in diameter in the line, good land and elegant timber. —
- 22.00 a spring runs North — & hill runs South —
- 29.00 a white oak 18 inches diameter in the line, hill runs South
- 53.50 a spring branch runs North
- 54.13 a Hickory 15 inches diameter in the line good land and well situated. —

Ch. lks.  
80.00

a Post from which a Black oak tree 20 inches diameter bears S 44<sup>3</sup> W  
15 links distant, and another Black oak of same diameter  
bears S 44 E 44 links distant notched with 3 notches —

This mile generally first rate wheat land, and well suited for  
cultivation, well timbered with Black and White Oak  
and Chestnut. — " —

### Commenced Sixth Mile

Ch. lks.

10.00 a good spring runs S.W. small hills on both sides —

13.00 the spring branch runs South

17.58 a White oak 15 inches in diameter in the line —

25.00 entered a wet flat of oak land — open woods

40.00 entered a brushy plain —

57.27 a White oak 10 inches in diameter in the line

80.00 a Post from which a White oak 18 inches in diameter bears  
North 75<sup>3</sup> E notched & blazed — marked M. 6 — and another  
White oak 15 inches in diameter bears N 64 E notched  
3 notches & blazed — " —

### Commenced Seventh Mile

Ch. lks.

75.00 a White oak 18 inches in diameter in the line — entered  
timbered land of good quality — Oak, cherry & hickory

80.00 a Post from which a White oak 12 inches in diameter  
bears N 78.50 E, 25 lks distant, and another White oak  
18 inches in diameter bears S 85. W 37 links distant, marked  
M. 7 — and 3 notches — this land generally of excellent  
quality for farming — " —

### Commenced Eighth Mile

Ch. lks.

12.00 crossed Sugar creek 1.00 wide, a rapid stream suitable  
for mills & runs S 30 E — a small rich bottom on East side —

- 15.00 rise a high, bushy bank -
- 19.00 a white oak 22 inches in diameter in the line - much huckle bush  
Cherry and plum trees -
- 35.21 a black jack tree 18 inches diameter in the line, the land  
good but much brush
- 59.53 a white oak in the line
- 80.00 a forked white oak 18 inches in diameter, marked M 8  
and three notches - thin mile through thick brush, Black  
Jack, thorn, plum, Cherry and hazel - some oak timber

Commenced Ninth Mile

- 3.78 a Cherry 18 inches in diameter in the line, entered timbered land
- 3.00 a stream 15 links wide running S.E. out -
- 8.32 a white <sup>oak</sup> 24 inches diameter in the line, a small rising to  
our left, the branch on our right, land well timbered
- 19.40 a white oak 20 inches in diameter in the line, good land and  
well situate -
- 0.00 a Post from which a white oak tree 18 inches diameter bears  
N 7 1/2 W 20 links distant & a Beach tree 12 inches diameter  
bears S 5 1/4 E 27 links distant marked M 9 & 3 notches  
this last 3/4 of the mile stony (sandstone) well timbered with  
oaks, poplar, Chestnut, Beach &c -

Commenced Tenth Mile

- 1.20 a white oak 18 inches diameter in the line
- 3.30 a Sugar tree 10 inches diameter in the line, here is excel-  
lent land, the hill gradually rising south, lofty timber -
- 7.00 a Spring branch runs N.E.
- 4.00 a Spring branch runs North
- 0.00 a Post from which a white oak 18 inches diameter bears  
S 20 E 27 links distant, another white oak 18 inches in

15.00	see a high, bushy bank -
19.00	a white oak 22 inches in diameter in the line - much hazel be Cherry and plum trees -
35.21	a black jack tree 18 inches diameter in the line, the land good but much brush
59.53	a white oak in the line
80.00	a forked white oak 18 inches in diameter, marked M 2 and three notches - this mile through thick brush, Black Jack, thorn, plum, cherry and hazel - some oak timber

Commenced Ninth Mile

13.78	a cherry 18 inches in diameter in the line, entered timbered l.
23.00	a stream 15 links wide running S.E. out -
28.32	a white <sup>oak</sup> 24 inches diameter in the line, a small rising to our left, the branch on our right, land well timbered
49.40	a white oak 20 inches in diameter in the line, good land an well situate -
80.00	a Post from which a white oak tree 18 inches diameter bea N 7 1/2 W 20 links distant & a Peach tree 12 inches diameter bea S 5 1/4 E 27 links distant marked M 9 - 43 notches this last 3/4 of the mile stoney (sandstone) well timbered w Oaks, poplar, Chestnut, Peach &c -

Commenced Tenth Mile

12.20	a white oak 18 inches diameter in the line
33.30	a Sugar tree 10 inches diameter in the line, here is ex lent land, the hill gradually rising south, lofty timber -
51.00	a Spring branch runs N.E.
74.00	a Spring branch runs North
80.00	a Post from which a white oak 18 inches diameter bea S 20 E 27 links distant, another white oak 15 inches in

diameter bears N 24 E 33 links distant, marked M 10 and three notches & blazes - this mile rich land - somewhat stoney - timber, Oak, Walnut Chestnut, some beech & Maple

Commenced Eleventh Mile

- 14.90 a Hickory 18 inches diameter in the line
- 19.00 ascended a hill bearing S & N
- 30.00 a spring branch runs North
- 31.50 another Spring branch runs North East
- 33.75 a White Oak in the line
- 52.22 a Poplar 22 inches in diameter in the line
- 80.00 a Post from which a Beach tree bears S 42 1/2 W 50 links distant, 15 inches diameter, marked M 11 & three notches - and a Hickory 20 inches in diameter bears S 85 1/2 E 50 links distant this mile generally good land, Timber, Walnut, Oak, Hickory, Beach, sugar tree & Chestnut.

Commenced Twelfth Mile

- 1.10 a Spring branch runs North
- 5.00 two large deericks
- 10.00 a spring runs S & E
- 12.92 a Chestnut tree 20 inches diameter in the line
- 37.00 a Hickory tree 18 inches diameter in the line, elegant timber & best wheat land, gradually descending
- 52.50 a water course running North at foot of the ridge
- 80.00 a Post from which a White Oak tree 20 inches in diameter bears N 22 1/2 W 14 lks, and another White Oak 24 inches in diameter bears S 43 W 43 links distant, both blazed & notched with 3 notches, the first marked M 12 land similar to the preceding mile interspersed with gentle crests & descents

Commenced Thirteenth Mile

- 11.02 a White Oak 16 inches diameter in the line, enters a low bottom, Elm, Maple Ash & beach Timber

ch. lks  
 24.00 entered a low bottom, timber as aforesaid  
 33.50 crossed a branch 10 links wide running North  
 41.00 a spring running North  
 55.20 a Hickory 12 inches diameter in the line, on bank of a stream  
 8 links wide running N10E  
 69.00 a Spring branch runs S60E - gradually ascends a ridge  
 80.00 a Post from which a white oak 15 inches diameter bears  
 S15°E 38 links distant marked MM 13 & three notches,  
 another white oak of same diameter bears N27°E 43 links  
 distant, land of best quality for farming, a generally uneven

Commenced Fourteenth Mile

ch. lks  
 10.00 a white oak 22 inches in diameter in the line on a flat ridge  
 39.00 a Spring branch runs North  
 59.14 a white oak 18 inches diameter in the line, on a ridge  
 70.00 on a brushy ridge, began to descend  
 77.00 a stream 10 links wide running East  
 80.00 a Post from which a Sugar tree 18 inches diameter bears  
 S67°W 21 lks distant, marked MM 14 & notched 3 notches -  
 and a Hickory 12 inches diameter bears S13°W 30 links dis-  
 tant - this mile proper for cultivation, composed of gentle  
 ascents & descents and well timbered

Commenced Fifteenth Mile

17.88 a Hickory 19 inches in diameter in the line  
 40.00 on a ridge  
 70.00 descended a hill to a stream running North  
 80.00 rose a bank & set a post from which a white oak tree  
 15 inches diameter bears S43°W 24 links distant marked MM 15  
 and notched - another white oak 12 inches in diameter bears  
 S47°W 10 lks distant blazed & notched

## Commenced Sixteenth Mile

- 15.27 a white oak 15 inches diameter in the line, a spring runs N.W.
- 20.00 another spring runs N.W.
- 28.50 a spring branch runs North
- 35.57 a white oak 12 inches in diameter runs in the line
- 43.00 entered a wet bottom, timber Ash, Elm, and Lypress
- 50.00 crossed a spring branch & began to see small commenced Oak land
- 80.00 a Hickory post from which a white oak 15 inches in diameter bears N 88° E 59 links distant & a Hickory 12 inches in diameter bears N 10° E 22 links distant mark M 10 and notched, generally good farming land interspersed with small hills much brush, & grape vines timber generally oak

## Commenced Seventeenth Mile

- 6.50 A white oak tree 15 inches diameter in the line
- 20.00 a spring runs North, entered a brush plain percut Oak & Hazel
- 33.00 a stream 10 links wide running west, rich brushy bottom
- 43.00 rise into high ground
- 59.13 a white oak 14 inches in diameter in the line
- 80.00 a post from which a white oak 15 inches in diameter bears N 85 1/2° W 13 links distant, another white oak of same diameter bears North 10 links distant marked M 17 and notched 3 notches. — this mill proper for cultivation interspersed with small hills

## Commenced Eighteenth Mile

- 12.76 a white oak 19 inches in diameter in the line
- 20.00 a spring branch runs S 60° E
- 55.30 a Chestnut tree 18 inches diameter in the line
- 68.00 a spring runs S.W.
- 80.00 a Post from which a white oak 12 inches in diameter bears S 25 1/2° E 13 links distant, another white oak 20 inches in



diameter bears N 70° E 18 links distant marked M 18 and three notches — this mile generally good soil, white oak timber —

### Commenced Nineteenth Mile

- Ch. lks  
 12.58 a Red oak 22 inches in diameter in the line  
 32.00 a water course running S.E. here a flat ridge dividing the water of Sugar & Killbuck's Creeks  
 50.40 a white oak 22 inches diameter in the line  
 80.00 a Hickory post from which a white oak 12 inches in diameter bears N 84 1/4 W 17 links distant, another white oak 16 inches diameter bears S 4 1/2 W 28 links distant marked M 19 and 3 notches — this land level and well timbered with tall Red, white, & Black Oak and Hickory, soil of an excellent quality.

### Commenced Twentieth Mile

- 5.61 a white oak 24 inches in diameter in the line  
 24.00 cross'd a stream running N.West  
 35.00 a Spring runs North  
 47.95 a white oak 19 inches in diameter in the line  
 58.00 entered a rich bottom  
 65.00 a stream 10 links wide running S 70° West  
 67.50 a bottom oak 24 inches diameter in the line  
 70.00 rose a bank to high land  
 80.00 a post from which a Sugar tree 14 inches diameter bears S 76° E 32 links distant, and a white oak 25 inches in diameter bears N 70° E 25 links distant marked M 20 & three notches, first rate farming land & well timbered with oak aff and Sugar tree

Commenced Twenty first Mile

- 20.00 a water course runs South
- 47.95 a white ash 18 inches in diameter in the line, the good meadow ground
- 60.60 a white oak 18 inches in diameter in the line
- 77.50 a water course runs South
- 79.00 a Spring runs South
- 80.00 a white oak 15 inches in diameter Marked on East and West sides M 21 generally good farming land & some places proper for meadows, — " —

Commenced Twenty second Mile

- 13.92 a white oak 15 inches in diameter in the line
- 15.00 a water course running South
- 46.00 a water course runs South
- 57.48 a white oak 18 inches in diameter in the line
- 80.00 a post from which a white oak 30 inches in diameter bears S 15° W 35 links distant & another white oak 12 inches in diameter bears S 63/4° W 13 links distant marked M 22 & three notches, this similar to the preceding mile interspersed with good meadow ground

Commenced Twenty third Mile

- 4.00 descended a steep bank into a bottom
- 12.53 a Crab Apple 10 inches diameter in the line
- 19.00 a Creek 30 links wide runs North - a rich low bottom — " —
- 23.00 a forked cherry tree 22 inches in diameter in the line & began rise a bank onto high ground
- 37.00 a stream runs North
- 78.00 a stream running North

30.00 a post from which a white oak tree 24 inches in diameter bears N 78.50 E 33 links distant — and another white oak 18 inches in diameter bears S 84 W 20 links distant marked M 23 and three notches — this land of best quality for farming —

Commenced Twenty fourth Mile

18.00 a forked Maple in the line  
 32.50 a stream runs North, entered rich land  
 36.13 a Black Walnut 30 inches diameter in the line  
 50.00 a spring runs North  
 60.50 a Sugar tree 15 inches in diameter in the line  
 68.00 began to ascend a hill  
 76.00 ascended a hill bearing N. & South  
 80.00 a post from which a Hickory 10 inches diameter bears S 71 E 25 links distant & a white oak 24 inches diameter bears S 29 W 50 links marked M 24 notched and blazed — this mile generally rich, Timber Oak, white Sugar tree, Walnut, Maple & Elm —

Commenced Twenty fifth Mile

15.00 a Sapapass 15 inches in diameter in the line  
 36.00 a Spring runs South  
 41.00 a Spring runs S East — rise a hill  
 50.00 began to descend the hill  
 60.00 the hill descends North  
 72.00 a swampy bottom  
 80.00 a post from which a black ash tree 10 inches diameter bears N 4 W 10 links distant, marked M 25 and notched — another Black ash 12 inches diameter bears S 60 35 links distant this mile generally rich land, but broken with hills — timber Oak —

Commenced Twenty Sixth Mile

- 12.00 a stream runs S.E. through a post bottom
- 15.42 a bottom oak in the line
- 30.50 Killbuck's creek 2.00 wide running S.W. current gentle
- 39.00 the bottom ends - begins to rise a ridge of Oak land
- 52.35 a white oak 24 inches in diameter in the line - the hill descends South
- 80.00 a post from which a Black Oak 20 inches in diameter bears N 64 W 6 links distant, another Black Oak of same diameter bears N 41 E 23 links distant - marked M 26 notched & blazed on the side of the hill - 2 ft heads, 2 inches South, descending South - this mile generally good soil, but broken with hills & flows -

Commenced Twenty seventh Mile

- 6.93 a Black oak 19 inches in diameter in the line in the foot of the ridge
- 20.00 a hill descends North
- 25.00 a water course runs North
- 38.11 a forked beach tree on the Bank of a spring branch running N.West -
- 43.00 a Spring runs N.East
- 52.70 a Chestnut tree 20 inches in diameter in the line, begins to descend the hill
- 80.00 on side of a hill a white oak sapling 4 inches diameter from which a red oak 16 inches diameter bears S 65 E 6 links distant, marked M 27 notched and blazed - This mile generally hilly & stony (with sandstone) timber mostly oak

Commenced Twenty eighth mile

- 2.50 a stream runs North
- 20.25 a white oak 18 inches diameter in the line, enters upon Oak land
- 32.00 a water course runs North

- 36.50 a water course runs North
- 36.50 a stream runs North
- 53.80 a white oak 12 inches diameter in the line - rise a steep h
- 73.00 a stream runs N. West
- 80.00 a Post from which a white oak 15 inches in diameter  
N. 73 1/2 W 8 links distant marked M 28 notched & blaz
- another white oak 24 inches in diameter bears S 15 E 36 lin.  
distant - This mile generally proper for cultivation  
timber Oak Hickory, Sugar tree Cherry Elm & Maple

Commenced Twenty Ninth Mile

- 5.00 entered rich bottom, hill bearing S 20 W
- 18.50 a Sugar tree in the line 15 inches in diameter
- 20.00 a creek running N. East 70 links wide rapid clear, was  
here another stream empties from the N. West 20 links  
wide -
- 35.00 the bottom wet here
- 51.00 began to ascend a hill
- 54.00 a spring branch runs S. East.
- 58.00 rise the hill to good land
- 80.00 a Hickory sapling 4 inches in diameter from which a white  
oak 20 inches in diameter bears S 53 W 30 links marked  
M 29 notched on the side of a hill descending S. East.

This mile generally ~~rich~~ land - timber Oak, Hickory,  
Walnut, Ash and Sugar tree -

Commenced Thirtieth Mile

- 5.00 entered a bottom, a creek on our left 30.00 distant
- 6.53 a cherry tree 18 inches in diameter in the line
- 27.00 a Spring branch runs South, the creek bottom 4.00 to the l
- 35.00 the creek bottom
- 37.00 a Spring branch runs South
- 40.00 a white ash 20 inches in diameter in the line
- 53.80 a white oak 30 inches in diameter in the line - a grade

36.50 a water course runs North  
 36.50 a stream runs North  
 53.80 a white oak 12 inches diameter in the line - rise a steep hill  
 73.00 a stream runs N. West  
 80.00 a Post from which a white oak 15 inches in diameter bears N. 73 1/2 W 8 links distant marked MM 28 notched & blazed  
 another white oak 24 inches in diameter bears S 16 E 36 link distant - This mile generally proper for cultivation  
 timber Oak Hickory, Sugar tree Cherry Elm & Maple

Commenced Twenty Ninth Mile

5.00 entered rich bottom, hill bearing S 20 W  
 13.50 a Sugar tree in the line 15 inches in diameter  
 20.00 a creek running N. East 70 links wide rapid clear water  
 here another stream empties from the N. West 20 link wide  
 35.00 the bottom wet here  
 51.00 began to ascend a hill  
 54.00 a spring branch runs S. East  
 58.00 rise the hill to good land  
 80.00 a Hickory sapling 4 inches in diameter from which a white oak 20 inches in diameter bears S 53 W 30 links marked  
MM 29 Notched on the side of a hill descending S. East  
 This mile generally ~~rich~~ good land - timber Oak, Hickory, Walnut, Ash and Sugar trees -

Commenced Thirtieth Mile

5.00 entered a bottom, a creek on our left 30.00 distant  
 6.53 a Cherry Tree 18 inches in diameter in the line  
 27.00 a Spring branch runs South, the Creek bottom 4.00 to the left  
 35.00 the Creek bottom  
 37.00 a Spring branch runs South  
 40.90 a white oak 20 inches in diameter in the line  
 53.80 a white oak 30 inches in diameter in the line - a good one

Ch. the ascent to the right, the bottom on our left  
 30.00 - a Spring branch runs S.E. set a post from which a white oak 18 inches in diameter bears S36 E 37 links distant marked M30 notched & blazed - saw some wood trees 10 inches in diameter bears N76 1/2 E 28 links distant

This mile rich land composed of gentle ascent & descent

Commenced Thirty first Mile

Ch. the  
 12.42 - a Hickory 14 inches in diameter in the line  
 33.52 - a Hickory 14 inches in diameter in the line the creek bottom to the left 20.00  
 55.00 - a Spring branch runs South  
 63.00 - entered a bottom  
 68.00 - a Spring branch runs S.E.  
 75.00 - a branch of Killbuck's creek 30 links wide running S70 E - bears N70 W -  
 80.00 - a post from which a Maple tree 20 inches in diameter bears S28 W 23 links distant and a Lynn 24 inches in diameter marked and numbered M31 & notched bears S74 W 1.08 distant - This mile well situated for cultivation, having rich plains interspersed with oak land, and bottoms for meadows

Commenced Thirty second Mile

5.00 - rose a bank, good upland - & open woods  
 15.10 - a white oak 24 inches in diameter in the line  
 24.50 - a Stream running North -  
 69.42 - a white oak 18 inches in diameter in the line  
 80.00 - a Post from which a white oak 24 inches in diameter bears N37 W 33 links distant - another white oak of same diameter bears N78.50 E 26 links distant

This mile best wheat land, elegantly situated & excellent timbered white oak & some chestnut

Commenced Thirty third Mile

- 4.00 a water course runs N West
- 10.00 a white oak 30 inches in diameter in the line
- 15.00 a stream running N 70 West
- 35.00 a stream running N 20 West part of Killbuck's creek  
20 links wide
- 46.27 a red oak 18 inches in diameter in the line
- 80.00 a post from which a Black Walnut 15 inches diameter  
bears S 25 E 38 links distant - notched and marked M33  
and a Black oak 15 inches in diameter bears N 35 W  
25 links distant - This mile of first quality for small  
grain - timber - lofty Black & white oak, Walnut  
Hickory &c

Commenced Thirty fourth Mile

- 10.14 a Black Walnut 12 inches diameter in the line
- 20.00 on a stoney ridge - descending -
- 35.00 head of a Spring branch, land of excellent quality
- 41.50 a Spring branch runs N West
- 50.00 a branch 10 links wide runs NE, across small hill
- 56.70 rising the hill a Black 18 inches diameter in the line
- 80.00 A post from which a white oak 22 inches in diameter  
bears N 35 E 25 links distant, notched and marked M34  
and a Chestnut 15 inches in diameter bears N 10 E 127 links  
distant - This mile generally proper for cultivation  
well timbered, good wheat land

Commenced thirty fifth Mile

- the the open woods on a bridge, pleasant descent just
- 19.59 a forked hickory in the line 15 inches in diameter
- 26.00 a Spring branch runs North
- 32.00 another Spring branch runs N East
- 39.75 a Black oak 12 inches in diameter in the line



65.00 rose a hill the timber dead, much brush & grape vines, & stoney  
 70.00 began to descend  
 80.00 descended a hill, and fixed a post from which a white oak 20 inches in diameter bears N 41 E 57 links distant notched and marked M 35, and a Hickory 10 inches in diameter bears S 29 30 W 38 links distant  
 This mile generally broken & stoney, much small brush timber dead by burning.

Commenced thirty sixth Mile

5.00 entered timbered land  
 11.88 a white oak 22 inches in diameter in the line  
 21.00 a Spring branch runs North  
 42.00 rose a bould hill, on which were large rocks  
 45.00 began to descend a rocky hill  
 52.87 a white oak 20 inches in diameter in the line on steep side of the hill rocky, with free stone  
 55.00 descended the hill into good timbered land  
 57.00 a water course runs N East  
 80.00 a Post from which a white oak 22 inches in diameter bears S 43 E 27 links distant notched and marked M 36, and a Gum tree 20 inches in diameter bears N 24 E 21 links distant, similar in quality to N 35 except the last quarter which is first rate wheat land

Commenced thirty seventh Mile

5.00 a stream runs North  
 24.56 a white oak 19 inches in diameter in the line  
 30.00 a stream runs N 10 E  
 45.52 a white oak 15 inches in diameter in the line descending a stoney hill  
 80.00 crossed a stream running Northwest, fixed a post from which a Hickory 12 inches in diameter bears S 30 1/2 W 24 links distant notched and marked M 37

and a Black oak 18 Inches in diameter bears S 82 1/2 W  
35 links distant, This mile well timbered excellent  
land for wheat and situate proper for cultivation

Commenced thirty eighth mile

- 19. 51 a Black oak 15 inches in diameter in the line
- 29. 00 a water course running North & began to ascend steep hill
- 41. 07 rose the hill & began to descend, much brush and no timber
- 55. 00 a hollow, hill descends North
- 63. 15 a black oak 18 Inches in diameter in the line, a stony ridge,
- 80. 00 A Post from which a white oak 15 Inches in diameter bears  
S 50 W 35 links distant, notched and marked MM 38, and  
another white oak of same diameter bears S 57 W 45 links  
distant - This mile generally broken with hills, some  
places stoney & improper for cultivation

Commenced thirty ninth mile

- 9. 38 a maple tree 15 Inches in diameter in the line
- 12. 00 a water course runs North
- 19. 94 a forked Black oak 20 Inches in diameter in the line
- 40. 00 rose the hill timber chestnut and Black oak
- 44. 00 crossed a water course running West
- 54. 27 another Spring branch running North, steep hills both sides
- 75. 00 a Black oak 15 Inches in diameter in the line, on a  
ridge descending South & bearing with the course
- 80. 00 begin to descend a steep hill
- 80. 00 a post from which a white oak 30 Inches in diameter  
bears S 3 E 50 links distant, and another white oak  
18 Inches in diameter bears S 29 W 47 links distant  
notched & marked MM 39 -

This mile generally too hilly to cultivate

Commenced Fortieth mile

- 14.89 a white oak 30 inches in diameter in the line
- 17.50 White Woman's creek running S 20 E 4.50 wide enters a bottom rich land
- 31.28 a white oak 36 inches diameter in the line & began to ascend a hill, good land
- 40.00 land continues rich, Walnut, Ash & Sugar tree timber
- 50.00 a white oak flat, good farming land
- 58.21 a Black oak 22 inches in diameter in the line
- 76.00 a water course runs S East
- 80.00 ascend a hill, & from a post from which a white oak 18 inches in diameter bears N 11 E 27 links distant - another white oak 22 inches in diameter bears S 7 1/2 E 34 links distant, notched & marked M 40 - the last three quarters of this mile good farming land, well situated

Commenced forty first mile

- 15.40 rose a hill long & steep, a Black oak 20 inches in diameter in the line, much brush & small growth of Oak, Hickory & Aspen saplings, no larger timber
- 45.00 a water course runs South
- 52.20 a Chestnut 4 inches in diameter in the line
- 50.00 begin to descend a hill
- 59.00 a Spring branch runs N West, good timber, Oak & Hickory
- 80.00 a white oak tree 15 inches in diameter, notched & blazed on two sides & marked M 41 from which a Black oak 20 inches in diameter bears S 34 W 30 links distant - This mile mostly of inferior quality

Commenced Forty second mile

- 9.09 a white oak 15 inches in diameter in the line
- 40.00 a Spring branch runs N East
- 41.50 a white oak 20 inches in diameter in the line

# Indian Boundary Line

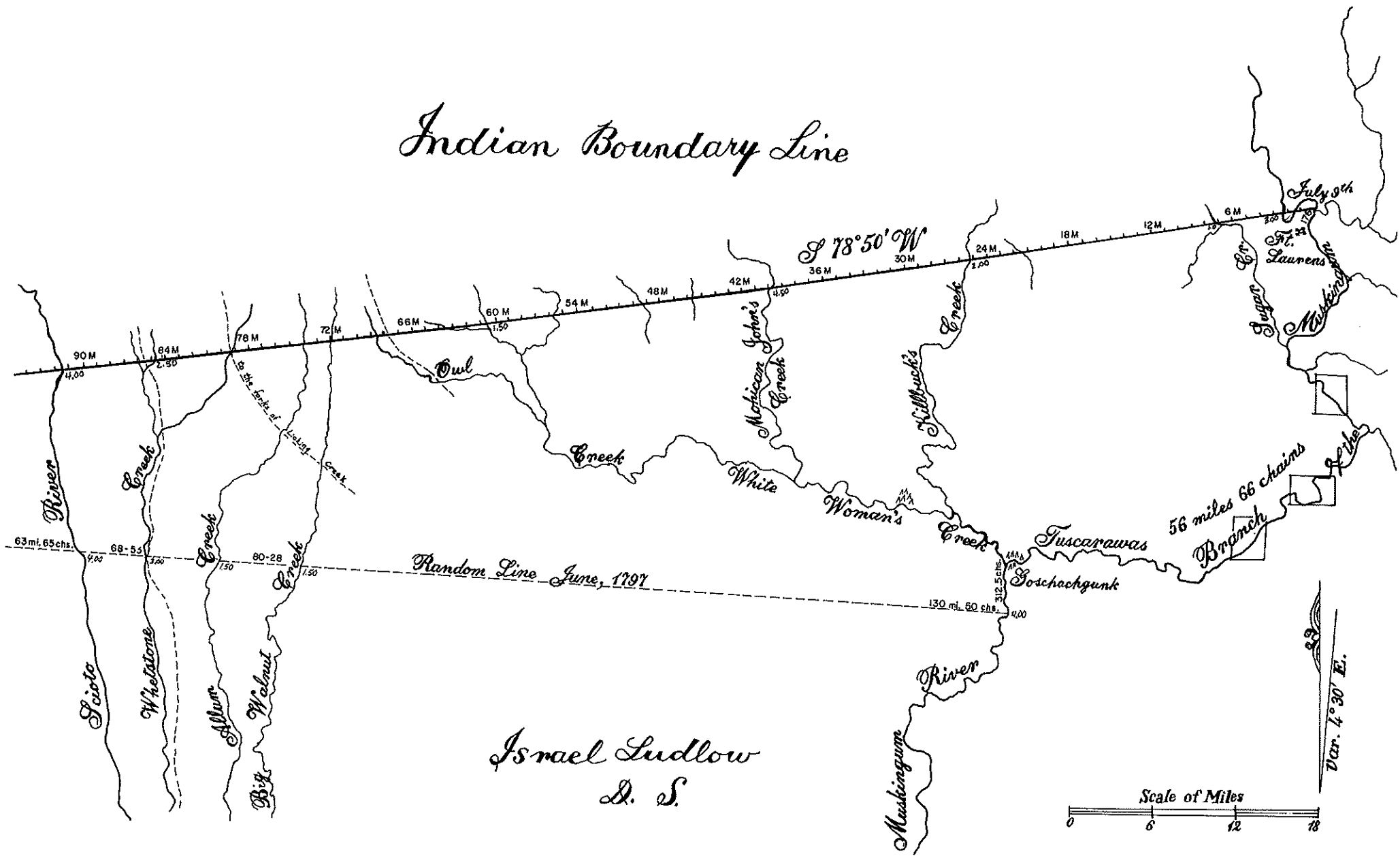

Israel Ludlow  
D. S.

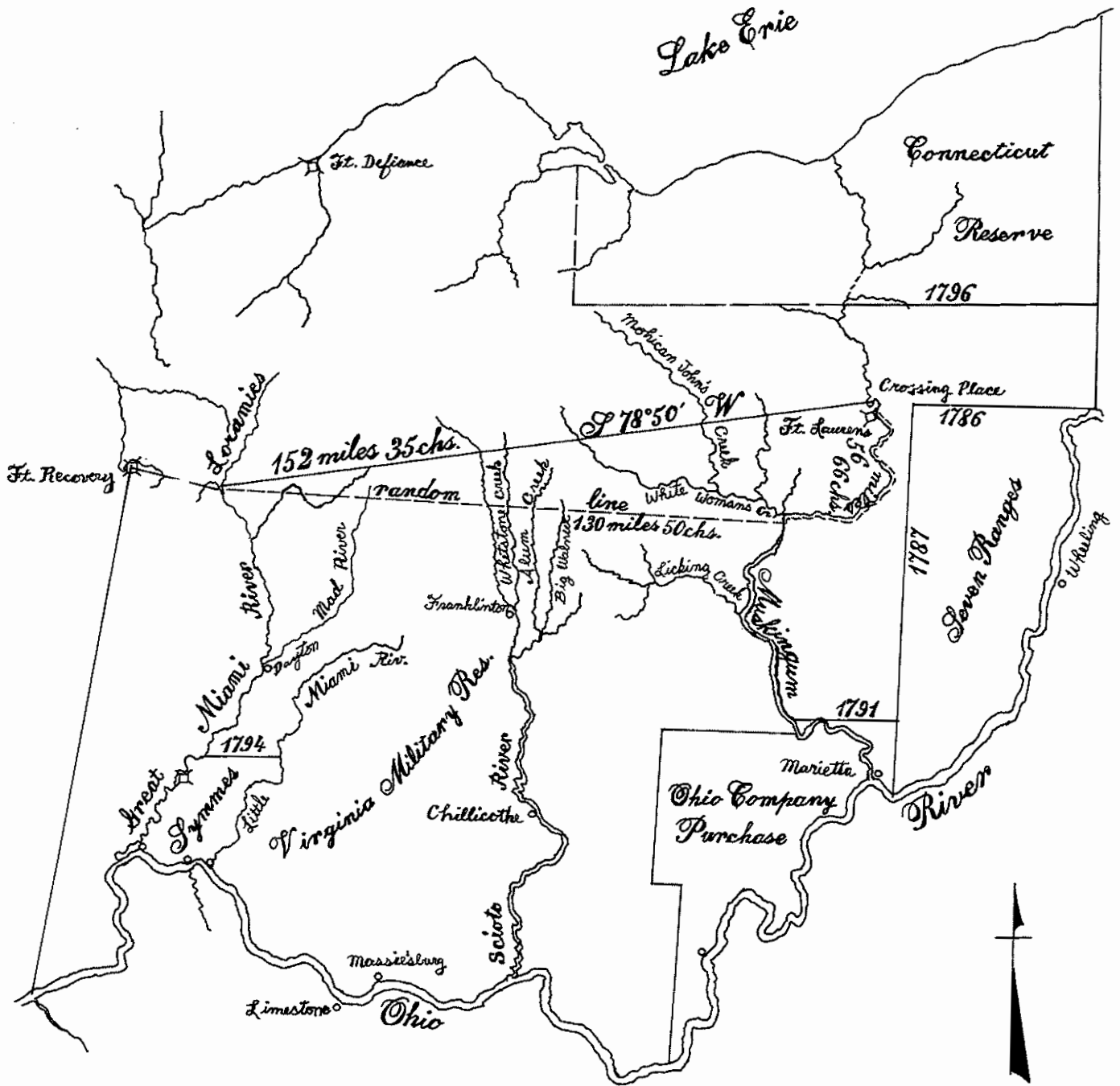

*Indian Boundary Line 1797  
Israel Ludlow  
D. S.*

# Indian Boundary Line

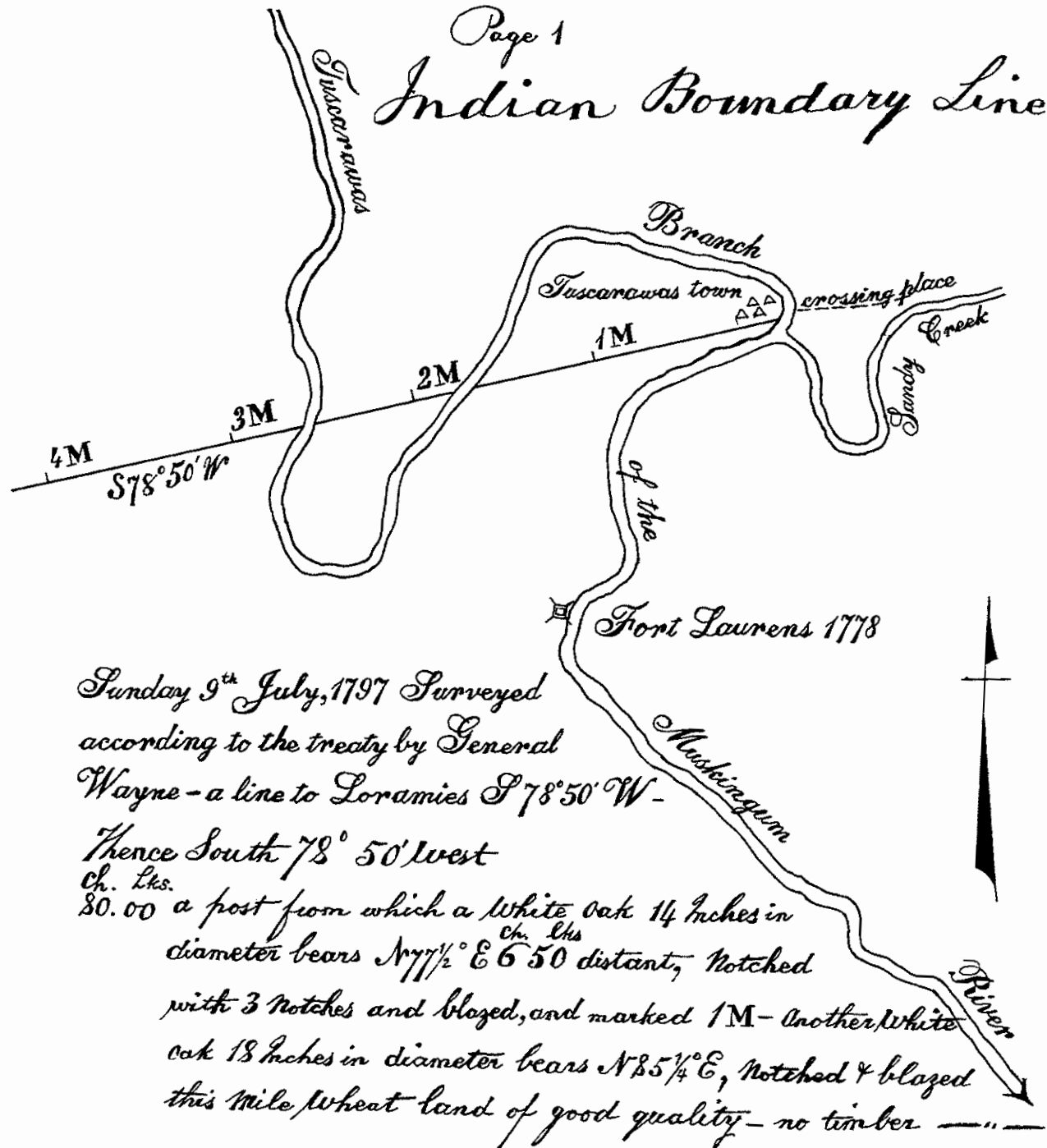

Sunday 9<sup>th</sup> July, 1797 Surveyed according to the treaty by General Wayne - a line to Loramies S 78° 50' W -

Thence South 78° 50' West  
 ch. lks.  
 80.00 a post from which a white oak 14 inches in diameter bears N 77 1/2° E 6 50 distant, Notched with 3 notches and blazed, and marked 1M - Another white oak 18 inches in diameter bears N 85 1/4° E, Notched & blazed this mile, wheat land of good quality - no timber -

---

S 78° 50' W commenced 2<sup>d</sup> Mile, at 40.00 entered timbered land  
 ch. lks.  
 45 6 a white oak 20 inches in diameter in the line  
 55.00 the Tuscarawas branch of Muskingum runs N.E. & S.W. - crosses the river into a brushy Paria - 64 4  
 ch. lks.  
 a bottom oak 20 inches in diameter notched on two sides, 3 notches  
 80.00 a post notched 3 notches & marked 2M from which a white

# Indian Boundary Line

47

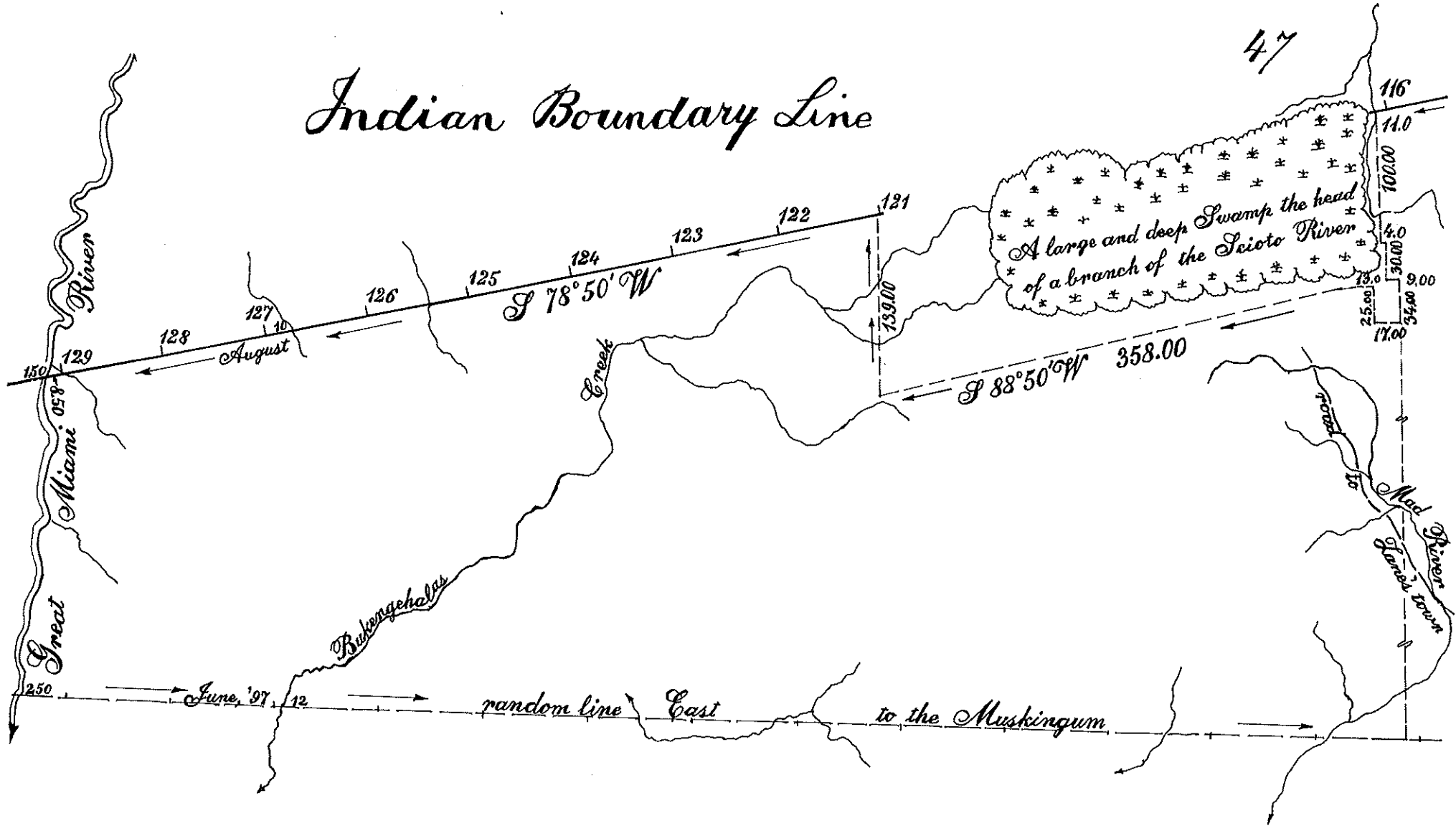

# Indian Boundary Line

according to the treaty by General Wayne

63

Commenced One Hundred & fifty third mile  
 ch. lks.  
 13.42 an Elm tree 12 inches in diameter in the line  
 20.00 a Road leading from Loramies to  
 31.00 a Black Oak tree 30 inches diameter in the line  
 35.00 came to Loramies Creek at a point  
 ch. lks. of Loramies Creek  
 23.50 above the forks on a course  
 S 10° W

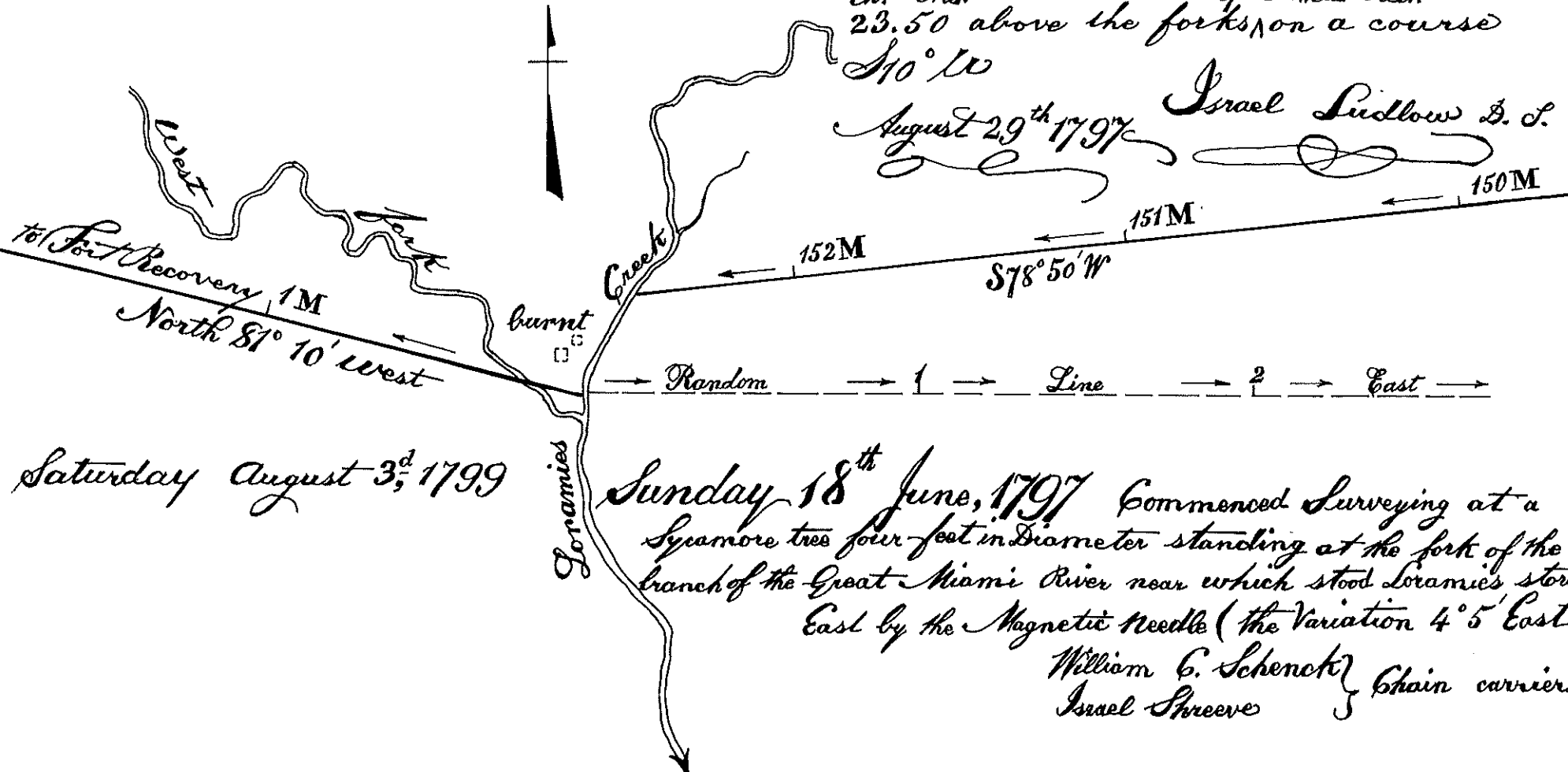

Israel Ludlow D. S.  
 August 29<sup>th</sup> 1797

Saturday August 3<sup>d</sup> 1799

Sunday 18<sup>th</sup> June, 1797 Commenced Surveying at a  
 Sycamore tree four feet in Diameter standing at the fork of the  
 branch of the Great Miami River near which stood Loramies store  
 East by the Magnetic Needle (the Variation 4° 5' East  
 William G. Schenck } Chain carriers  
 Israel Shreve }