

FED. AID DIST. NO.	STATE	FED. AID PROJECT	FISCAL YEAR
10	OHIO		

1
6

S.H. (I.C.H.) 23 SEC. R-BR.
HOLMES COUNTY

STATE OF OHIO

DEPARTMENT OF HIGHWAYS

BRIDGE OVER WOLF CREEK

S.H. (I.C.H.) 23 SE. C. R-BRIDGE

HOLMES COUNTY

RICHLAND TOWNSHIP DECEMBER 1929

The Standard Specifications of the State of Ohio, Department of Highways, in force on date of contract will govern this improvement.

I hereby approve these plans and declare that the making of this improvement will not require the closing to traffic of the highway, and that detour bridge and approaches will be provided as shown on plans and estimates.

Approved: Karl Snyder
Date: 12-31-29 Resident District Deputy Director.

Approved: Ralph H. Strait
Date: Jan 6, 1930. Resident Division Director

Approved: Paul Beightler
Date: 2/4/30 Chief Engineer, Bureau of Construction.

Approved: _____
Date: _____ Chief Engineer Bureau of Maintenance.

Approved: J. W. Burkey
Date: 1-21-30 Chief Engineer Bureau of Bridges

Approved: Tom M. Busby
Date: 2-4-30 Chief Engineer

Approved: Robert M. Ward
Date: 2-4-30 Director of Highways.

Recommended for Approval: _____
Date: _____ District Engineer
Bureau of Public Roads

Recommended for Approval: _____
Date: _____ Chief Engineer
Bureau of Public Roads

Approved: _____
Date: _____ Chief of Bureau.

INDEX	
Title page	Page 1
Plan and profile	" 4
Site plan	" 4
Cross Sections	" 5-6
Structure	" 2-3
Roadway Quantities	" 2
Structure Quantities	" 2

Supplemental prints of Structural Standards.
Drawing R-RA
Drawing B-45-2430

SCALES	
Plan of Roadway	1" = 50'
Profile-Vertical	1" = 5'
Profile-Horizontal	1" = 50'
Cross Sections	1" = 5'

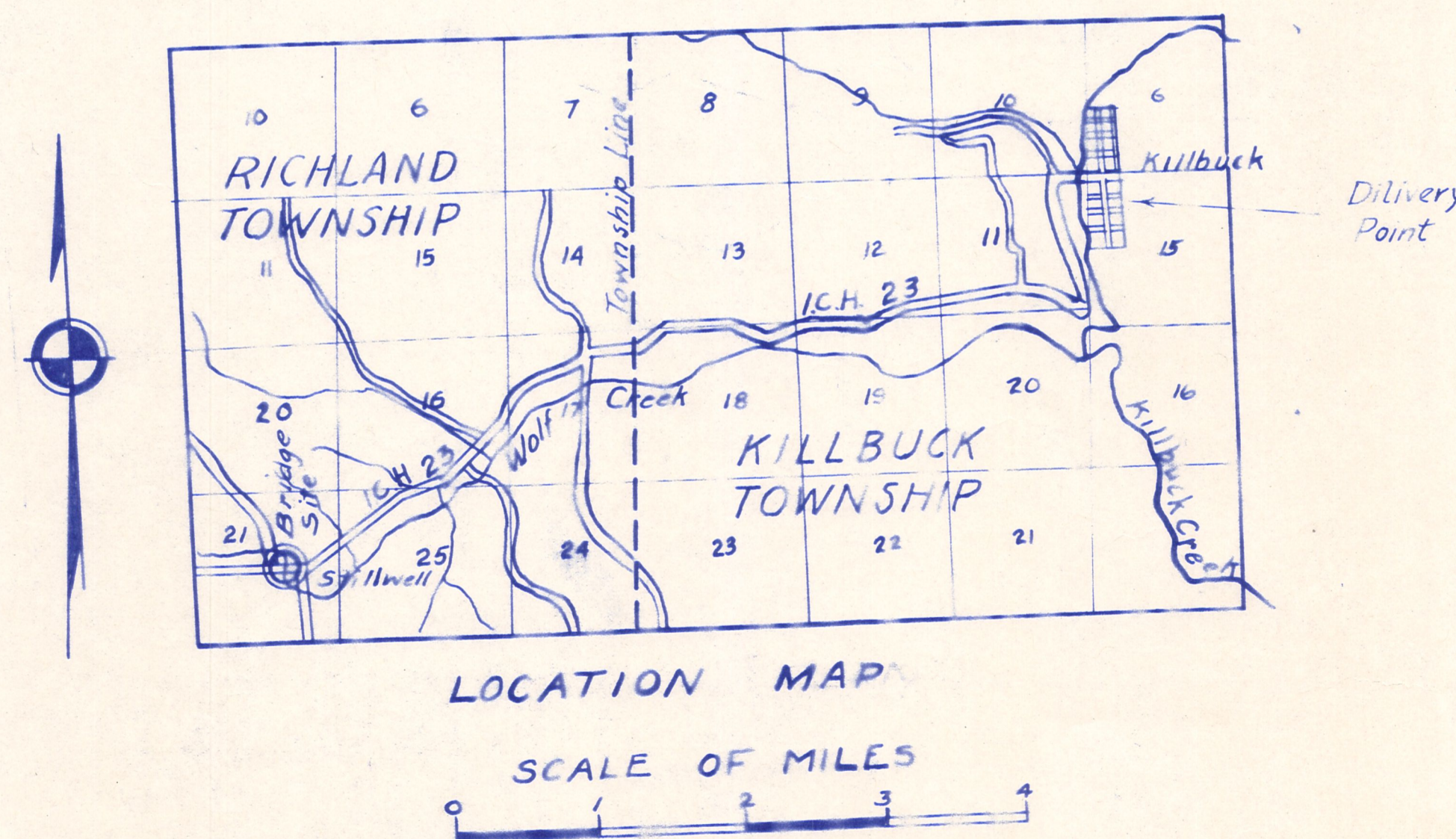

FED. ROAD DIST. NO.	STATE	FED. AID PROJECT	FISCAL YEAR
10	OHIO		

4
6

HOLMES COUNTY SH. (ICH) 23 - Sec. R. Bridge

TEMPORARY BRIDGE NOTE:
 The Contractor shall construct, maintain, and remove (upon the completion of project) a temporary detour bridge and approaches. The bridge shall have a 12-Ton loading capacity, a roadway width of not less than 18 ft, floor elevation not lower than elev. 882.00, adequate waterway opening, adequate supports and suitable railing. The approaches shall have a width of not less than 22 ft of which not less than 19 ft. shall be smoothly surfaced with gravel, crushed stone or slag. The approaches shall have a suitable gradient and shall be free from sharp turns so as to be suitable for 2 lanes of traffic. The temporary detour will be constructed on right of way provided by the State.

B.M. El. 878.46
 2 Spikes in 12' Willow tree
 Left Sta. 2+80

Sta. 2+49 to 3+45 Left: Build 96 feet Type D - Guard rail.
 Sta. 2+47 to 3+75 - Right: Build 128 feet Type D - Guard rail

Remove existing bridge.
 Build new concrete beam bridge
 Sta. 3+95 to 4+75 Left: Build 80 feet Type D Guard rail.

Sta. 4+25 to 4+73 Right
 Build 48 feet Type D
 Guard rail.

1500 Sq. yds. Gravel, Crushed stone or slag surface course, 6" thick 18 feet wide to be placed according to Item "T-2".

Channel Excav.	1912	Cu. Yds.
Excav.	339	Cu. Yds.
Emb.	1749	" "
Emb. +25%	2186	" "
Waste	65	" "

SITE PLAN BRIDGE OVER WOLF CREEK HOLMES-23-R-BRIDGE				
PRESENT TOPOGRAPHY	PROPOSED WORK			
	DESIGNED	DRAWN	CHECKED	REVIEWED
BES. ENG'G. OFFICE.				
	9+00			

FINAL SURVEY PLANNING NOTE BOOK

FINAL SURVEY PLANNING NOTE BOOK

