

**PLAN**  
FOR GRADING KOCH HILL  
ON ROAD I.C.H. N 23 RICHLAND  
TOWNSHIP HOLMES Co. O.  
Co. SURVEYOR

Note: From Sta. 12+91.7 to 16+136 use same Curve Data as before, but Shift P.I. back 53' on back Tan. Making Sta. at P.C. 12+91.7 and 16+13.6 at P.T.  
From Sta. 16+34.0 to Sta. 19+38.2 use Data for 32° Curve as Shown. This P.I. is Shoved ahead 0.5' and from new Curve Data makes the Sta. of P.C. 16+34.0 and the P.T. 19+38.2

**ESTIMATED QUANTITIES**  
7842 Cu.Yds. Excavation  
3100 Lin.ft. Finishing Slopes+Ditches  
Clearing+Grubbing

**CULVERTS**  
100 Cu.Yds. Excavation  
271 " " of 1-2-4 Concrete  
388 Lbs. of 3/8" Steel  
4.5 Cu.Yds. of Loose Stone  
5.0 " " Channel Excavation  
290 Lin.Ft. of 14" Sectional C.I.P.  
38 " " " 12" " "  
44 " " " 16" " "  
140 " " " 24" " "

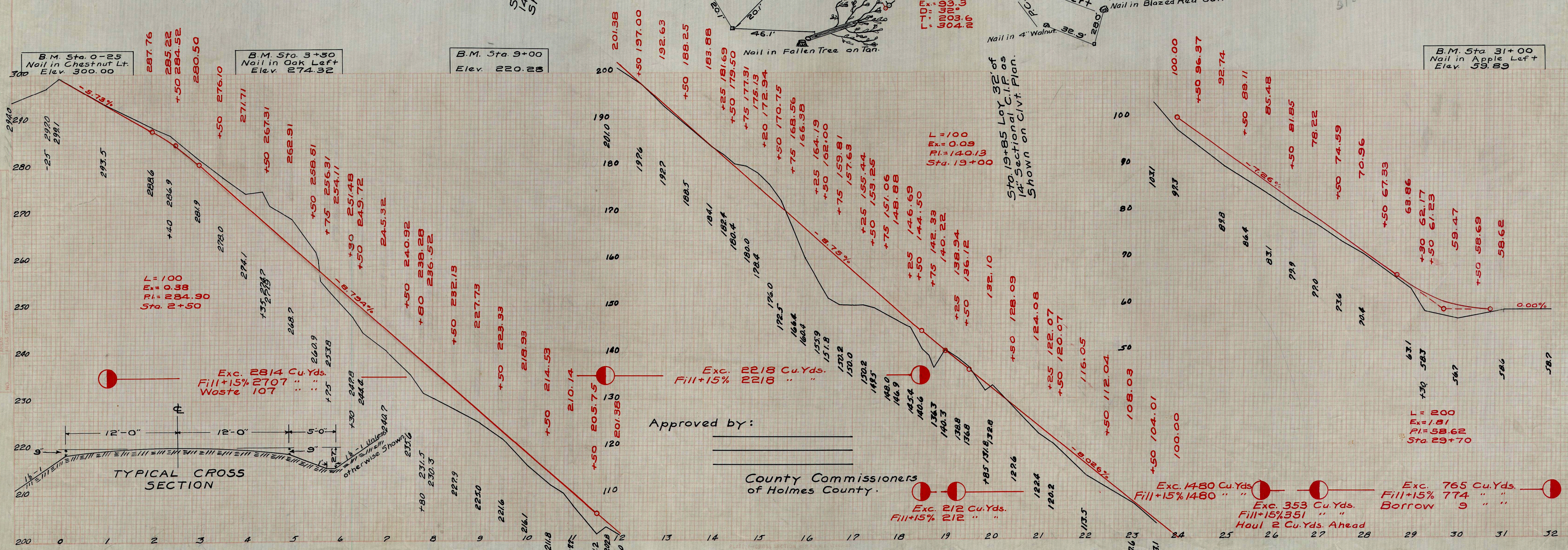

**TYPICAL CROSS SECTION**

Approved by:

County Commissioners  
of Holmes County.

ORIGINAL SURVEYED, PLOTTED, RECALCULATED, AND RECORDED. FIELD BOOK, NOTE BOOK, AND FIELD CHECKED.

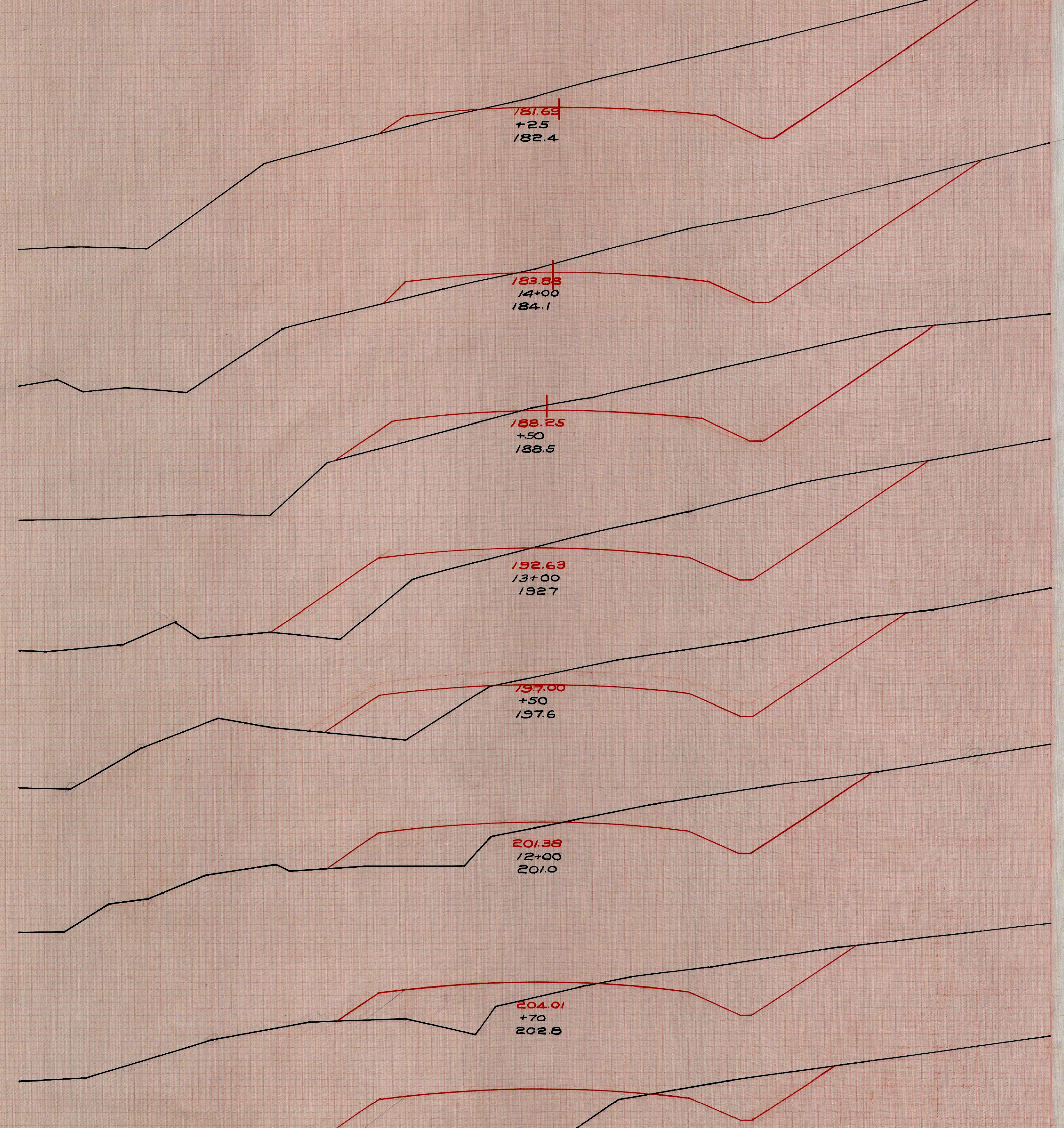
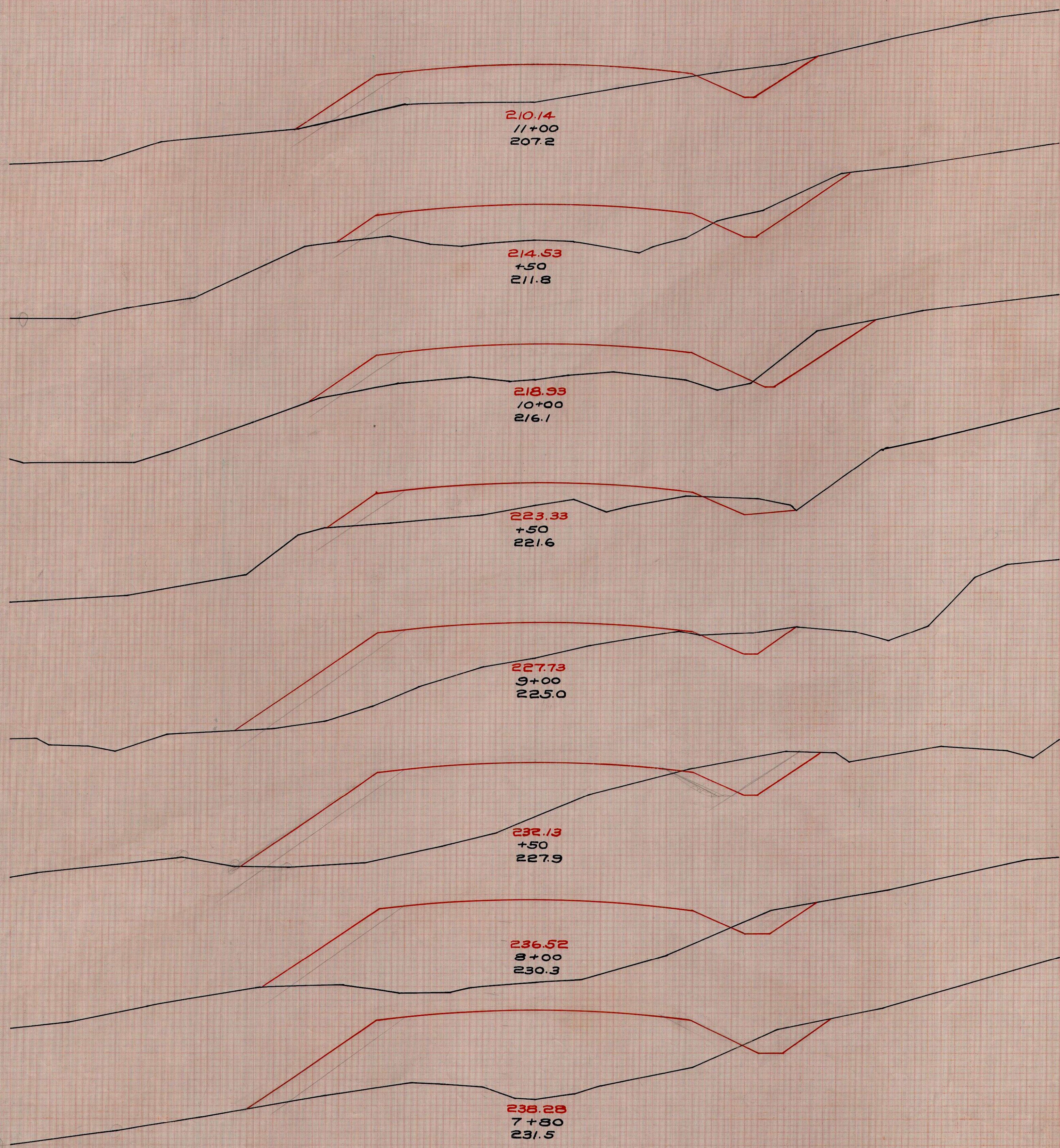

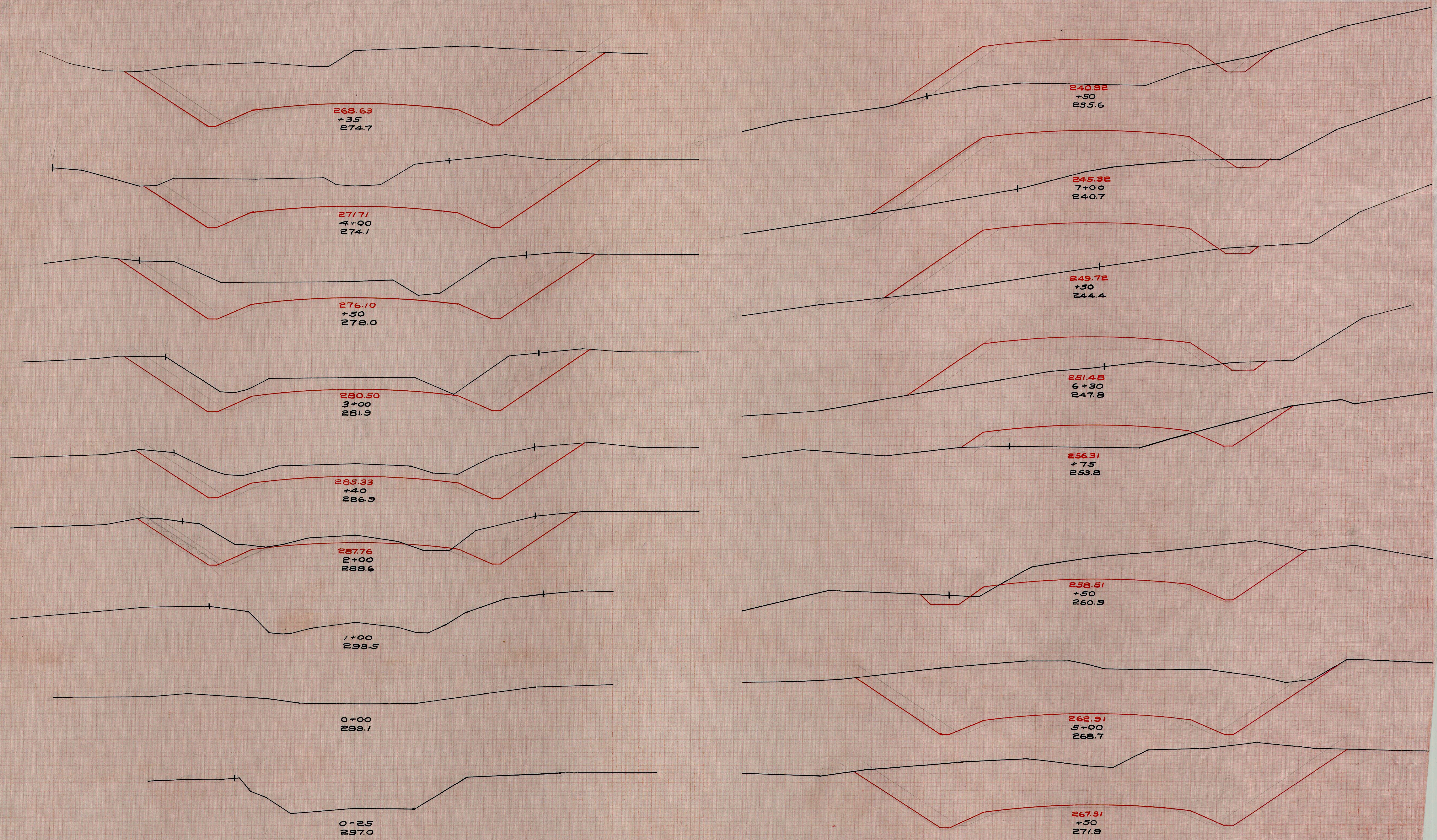

FINAL SURVEY

ORIGINAL SURVEY

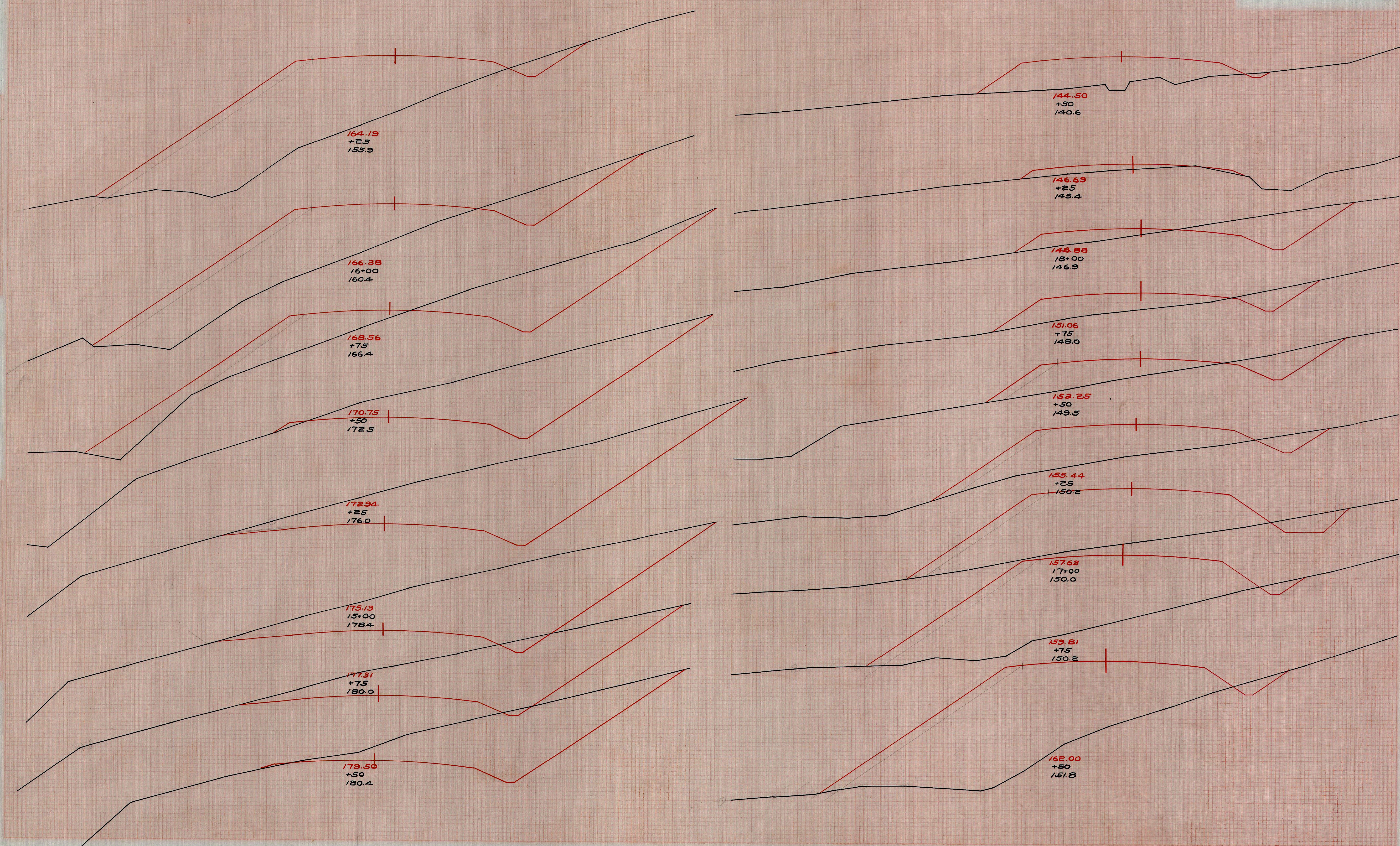

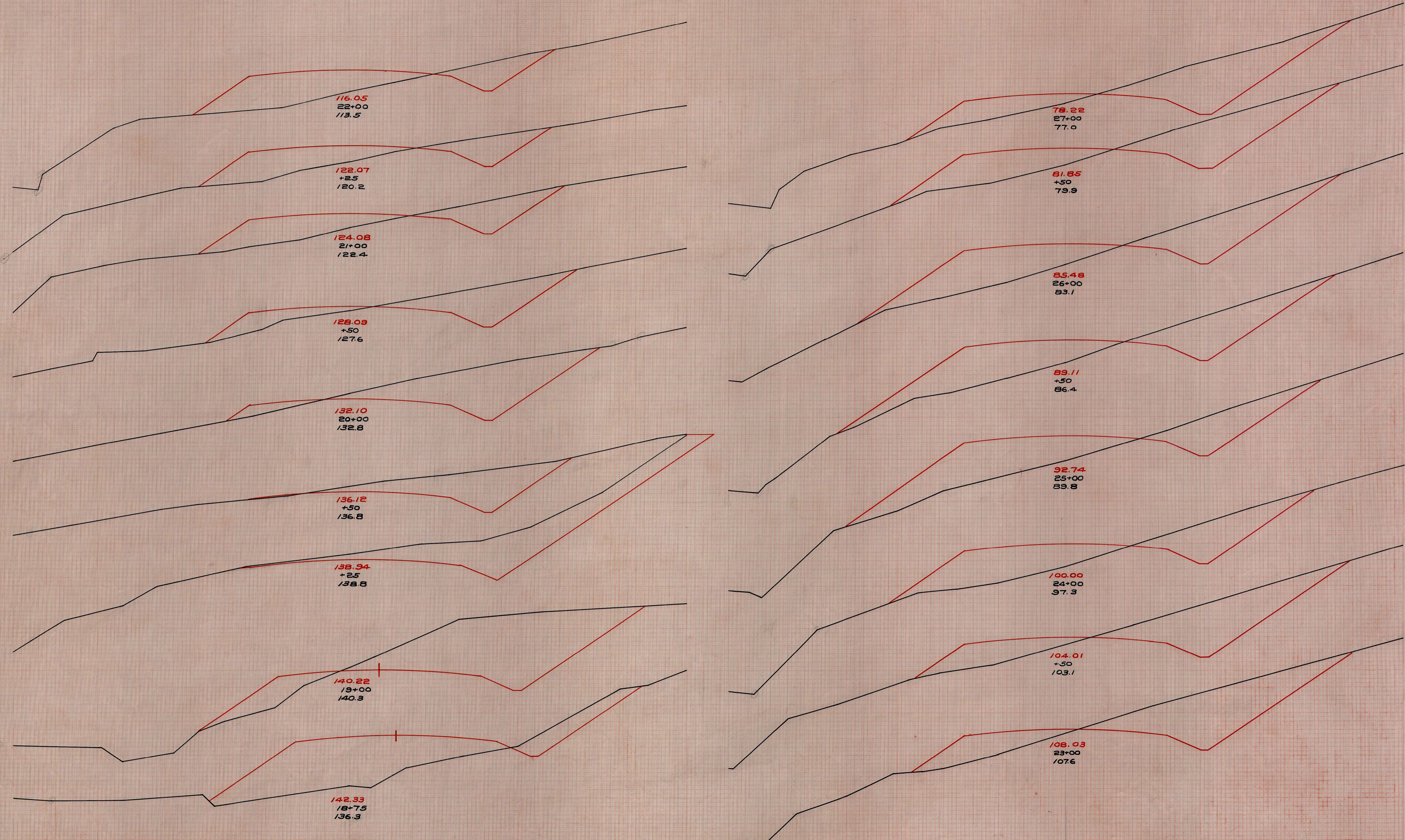

116.05  
22+00  
113.5

122.07  
+25  
120.2

124.08  
21+00  
122.4

128.09  
+50  
127.6

132.10  
20+00  
132.8

136.12  
+50  
136.8

138.94  
+25  
138.8

140.22  
19+00  
140.3

142.33  
18+7.5  
136.3

78.22  
27+00  
77.0

81.85  
+50  
79.9

85.48  
26+00  
83.1

89.11  
+50  
86.4

92.74  
25+00  
89.8

100.00  
24+00  
97.3

104.01  
+50  
103.1

108.03  
23+00  
107.6

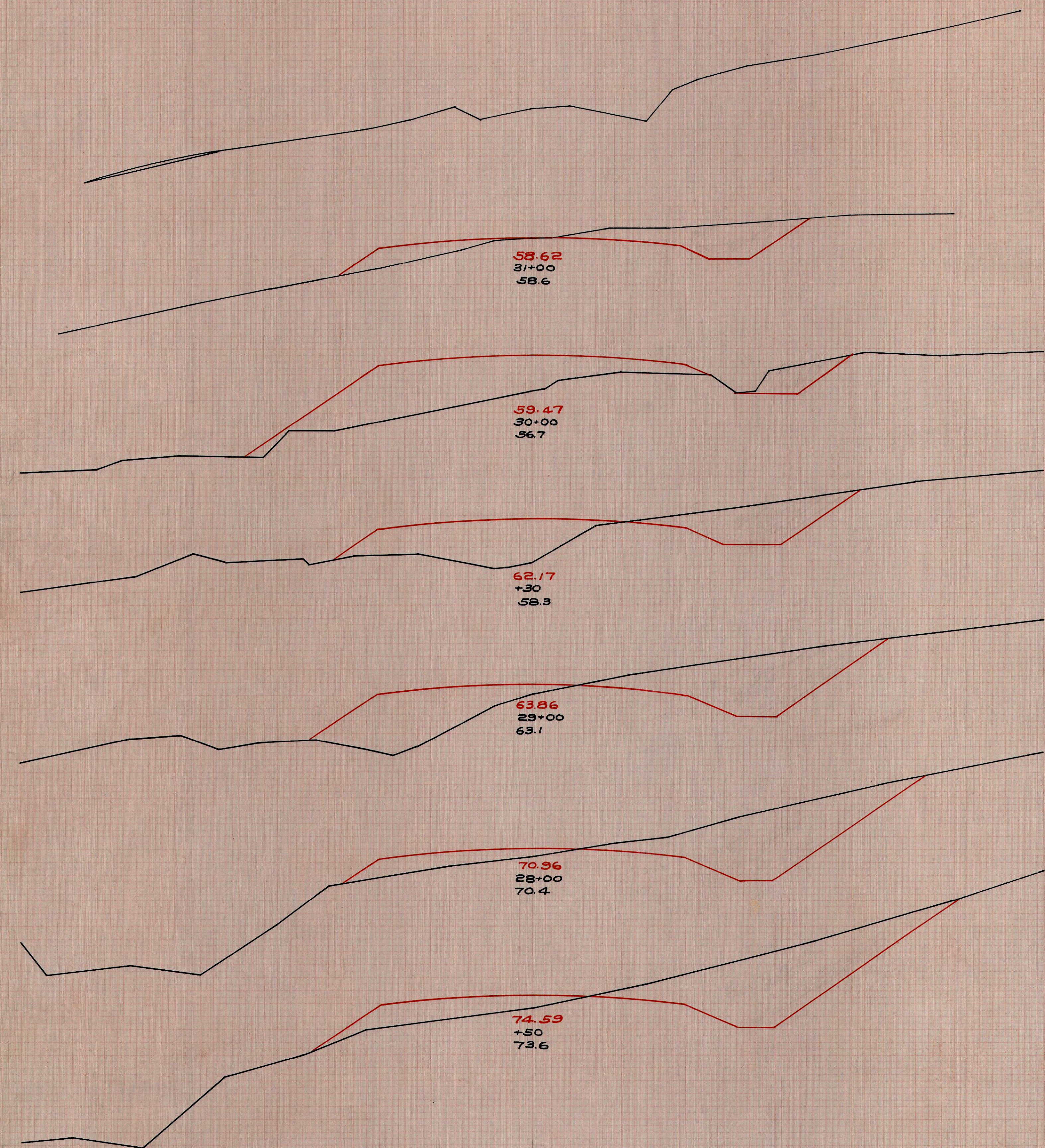

ORIGINAL SURVEY PLANS  
DATE: \_\_\_\_\_  
BY: \_\_\_\_\_  
CHECKED BY: \_\_\_\_\_  
SCALE: \_\_\_\_\_

ORIGINAL SURVEY PLANS  
DATE: \_\_\_\_\_  
BY: \_\_\_\_\_  
CHECKED BY: \_\_\_\_\_  
SCALE: \_\_\_\_\_