

STATE OF OHIO
DEPARTMENT OF TRANSPORTATION

HOL-62-15.24
KILLBUCK TOWNSHIP
HOLMES COUNTY

PROJECT DESCRIPTION

ER EVENT# OH18-01; DSR# HOL-003
IMPROVEMENT OF 0.06 MILE (325') OF S.R. 62 IN
HOLMES COUNTY WITH THE REPAIR OF A FAILED SLOPE.

EARTH DISTURBED AREAS

PROJECT EARTH DISTURBED AREA: N/A MAINTENANCE
ESTIMATED CONTRACTOR EARTH DISTURBED AREA: N/A MAINTENANCE
NOTICE OF INTENT EARTH DISTURBED AREA: N/A MAINTENANCE

2019 SPECIFICATIONS

THE STANDARD SPECIFICATIONS OF THE STATE OF OHIO, DEPARTMENT OF TRANSPORTATION, INCLUDING SUPPLEMENTAL SPECIFICATIONS LISTED IN THE PLANS AND CHANGES LISTED IN THE PROPOSAL SHALL GOVERN THIS IMPROVEMENT.

I HEREBY APPROVE THESE PLANS AND DECLARE THAT THE MAKING OF THIS IMPROVEMENT WILL NOT REQUIRE THE CLOSING TO TRAFFIC OF THE HIGHWAY AND THAT PROVISIONS FOR THE MAINTENANCE AND SAFETY OF TRAFFIC WILL BE AS SET FORTH ON THE PLANS AND ESTIMATES.

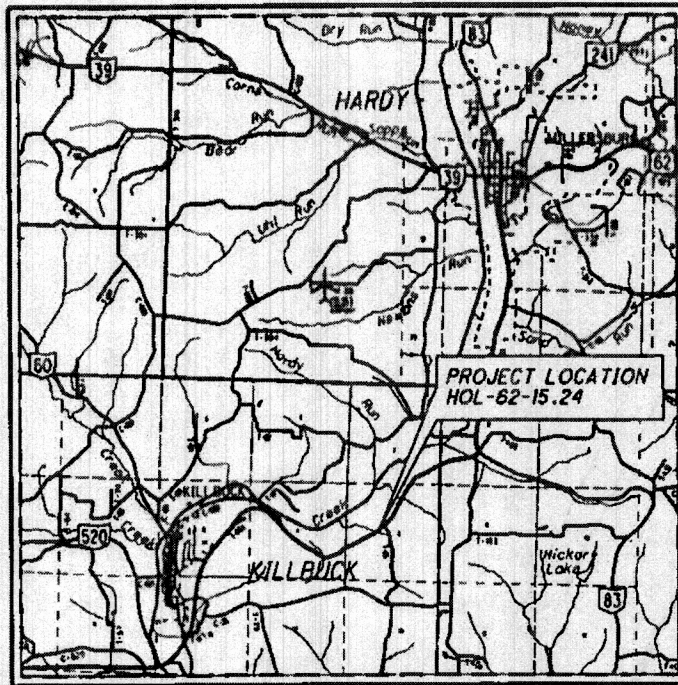

LOCATION MAP

LATITUDE: 40°30'00" LONGITUDE: 81°56'40"

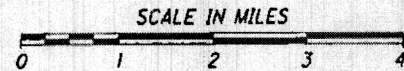

PORTION TO BE IMPROVED	-----
INTERSTATE HIGHWAY	=====
FEDERAL ROUTES	-----
STATE ROUTES	-----
COUNTY & TOWNSHIP ROADS	-----
OTHER ROADS	-----

DESIGN DESIGNATION

CURRENT ADT (2019)	-----	4,500
DESIGN YEAR ADT (2031)	-----	5,100
DESIGN HOURLY VOLUME (2031)	-----	500
DIRECTIONAL DISTRIBUTION	-----	70%
TRUCKS (24 HOUR B&C)	-----	8%
DESIGN SPEED	-----	55 MPH
LEGAL SPEED	-----	55 MPH
DESIGN FUNCTIONAL CLASSIFICATION:		
05 - MAJOR COLLECTOR (RURAL)	-----	
NHS PROJECT	-----	NO

DESIGN EXCEPTIONS

NONE REQUIRED

UNDERGROUND UTILITIES
CONTACT BOTH SERVICES TWO WORKING DAYS BEFORE YOU DIG.

Call Before You Dig
1-800-362-2764

(Non-members must be called directly)

OIL & GAS PRODUCERS
UNDERGROUND PROTECTION SERVICE
1-800-925-0988

PLAN PREPARED BY:
O.D.O.T. DISTRICT II
ENGINEERING
NEW PHILADELPHIA, OHIO

INDEX OF SHEETS:

TITLE SHEET	1
TYPICAL SECTION	2
GENERAL NOTES	3
MAINTENANCE OF TRAFFIC	4
GENERAL SUMMARY	5
PLAN SHEET	6
RIGHT OF WAY	7-9

ATTENTION
Contact the Ohio Department
of Transportation for current
Plans of Record

ROADWAY ENGINEER'S SEAL:

SIGNED: *Daniel J. Lorenz*
DATE: 7/22/19

GEOTECHNICAL ENGINEER'S SEAL:

SIGNED: *C. C. Notz*
DATE: 7/24/2019

STANDARD CONSTRUCTION DRAWINGS						SUPPLEMENTAL SPECIFICATIONS		SPECIAL PROVISIONS	
DM-4.3	1/15/16	MT-96.11	1/18/19	TC-41.20	10/18/13	800-19	7/19/15		
				MT-96.20	7/15/16	832	10/19/18		
DM-4.4	1/15/16	MT-96.26	1/18/19	TC-42.20	10/18/13				
				MT-97.10	4/19/19				
				TC-52.10	10/18/13				
				TC-52.20	7/20/18				
				MT-101.70	7/20/18				
				MT-101.75	7/15/16				
				MT-101.90	7/21/17				
				MT-105.10	7/19/13				

APPROVED: *Thomas D. Croy*
DATE: 7-22-19 DISTRICT DEPUTY DIRECTOR

APPROVED: *Paul R. ...*
DATE: 7/25/19 DIRECTOR, DEPARTMENT OF TRANSPORTATION

HOL-US 62-15.24
197045
DIST 11

PID 108272
8/22/19

Contract Proposal Available
www.Contracts.dot.state.oh.us/home

FEDERAL PROJECT NO. E180(553)
PID NO. 108272
CONSTRUCTION PROJECT NO. -
RAILROAD INVOLVEMENT NONE
HOL-62-15.24
1/9

I:\ProjectData\08272\Design\Roadway\Sheet\08272-GY001.dgn Sheet 18-JUN-2019 11:37PM dlaranz

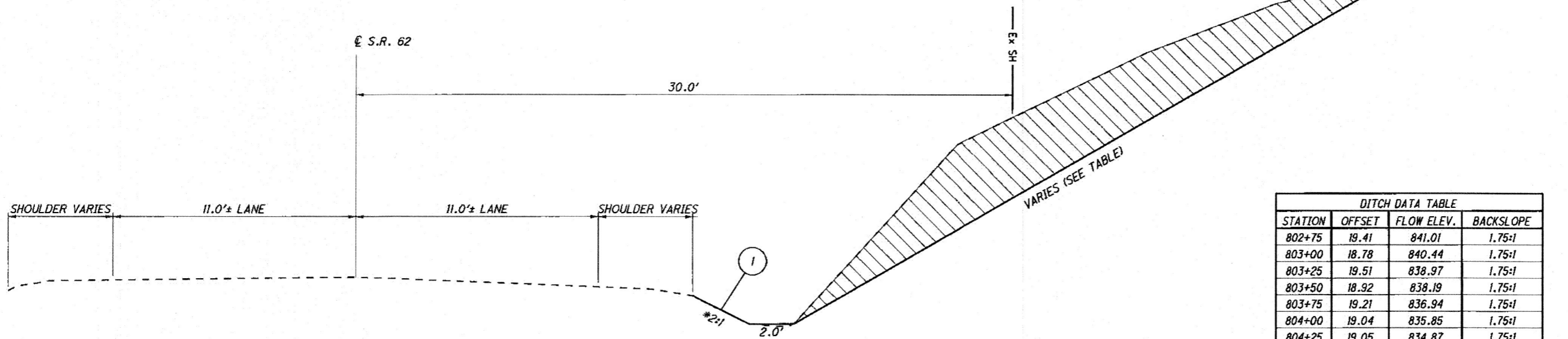

EXISTING TYPICAL SECTION
 WORK LOCATION: STA. 802+75 TO STA. 806+00

DITCH DATA TABLE			
STATION	OFFSET	FLOW ELEV.	BACKSLOPE
802+75	19.41	841.01	1.75:1
803+00	18.78	840.44	1.75:1
803+25	19.51	838.97	1.75:1
803+50	18.92	838.19	1.75:1
803+75	19.21	836.94	1.75:1
804+00	19.04	835.85	1.75:1
804+25	19.05	834.87	1.75:1
804+50	18.36	833.98	2:1
804+75	17.93	832.85	2:1
805+00	17.16	831.78	2:1
805+25	18.12	830.21	2:1
805+50	17.89	829.03	2:1
805+75	17.80	827.53	2:1
806+00	19.29	826.82	2:1

*EXCEPT AT STA. 806+00, THE FORESLOPE IS 3:1

TYPICAL SECTION

HOL-62-15.24

UTILITIES

LISTED BELOW ARE ALL UTILITIES LOCATED WITHIN THE PROJECT CONSTRUCTION LIMITS TOGETHER WITH THEIR RESPECTIVE OWNERS:

FRONTIER COMMUNICATIONS
9444 CAMPBELL STREET
CAMBRIDGE, OHIO 43725
(740) 432-6961
ATTENTION: ASHLEY MILLER

THERE ARE NO KNOWN UNDERGROUND UTILITIES ON THIS PROJECT.

WORK LIMITS

THE WORK LIMITS SHOWN ON THESE PLANS ARE FOR PHYSICAL CONSTRUCTION ONLY. PROVIDE THE INSTALLATION AND OPERATION OF ALL WORK ZONE TRAFFIC CONTROL AND WORK ZONE TRAFFIC CONTROL DEVICES REQUIRED BY THESE PLANS WHETHER INSIDE OR OUTSIDE THESE WORK LIMITS.

CLEARING AND GRUBBING

ALTHOUGH THERE ARE NO TREES OR STUMPS SPECIFICALLY MARKED FOR REMOVAL WITHIN THE LIMITS OF THE PROJECT, A LUMP SUM QUANTITY IS INCLUDED IN THE GENERAL SUMMARY FOR ITEM 201, CLEARING AND GRUBBING. ALL PROVISIONS AS SET FORTH IN THE SPECIFICATIONS UNDER THIS ITEM ARE INCLUDED IN THE LUMP SUM PRICE BID FOR ITEM 201, CLEARING AND GRUBBING.

CONFORMITY TO EXISTING CONDITIONS

THE TYPICAL ON SHEET 2 IS A GENERAL REPRESENTATION OF THE EXISTING ROADWAY. THE PROPOSED LANE WIDTH AND PAVEMENT MARKING PLACEMENT IF NECESSARY SHALL MATCH THE ACTUAL EXISTING CONDITIONS AS CLOSELY AS POSSIBLE.

FIELD VERIFICATION OF QUANTITIES

DUE TO THE NATURE OF THE PROJECT BEING A SLIDE REPAIR, THE CONTRACTOR IS RESPONSIBLE FOR FIELD VERIFICATION OF QUANTITIES PRIOR TO BIDDING AND THEN PRIOR TO CONSTRUCTION. THE ACTUAL WORK LOCATIONS AND QUANTITIES PERFORMED SHALL BE INCORPORATED INTO THE FINAL CHANGE ORDER GOVERNING COMPLETION OF THIS PROJECT.

ENDANGERED BAT HABITAT REMOVAL

THE PROJECT IS LOCATED WITHIN THE KNOWN HABITAT RANGES OF THE FEDERALLY LISTED AND PROTECTED INDIANA BAT AND NORTHERN LONG-EARED BAT. NO TREES SHALL BE REMOVED UNDER THIS PROJECT FROM APRIL 1 THROUGH SEPTEMBER 30. ALL NECESSARY TREE REMOVAL SHALL OCCUR FROM OCTOBER 1 THROUGH MARCH 31. THIS REQUIREMENT IS NECESSARY TO AVOID AND MINIMIZE IMPACTS TO THESE SPECIES AS REQUIRED BY THE ENDANGERED SPECIES ACT. FOR THE PURPOSES OF THIS NOTE, A TREE IS DEFINED AS A LIVE, DYING, OR DEAD WOODY PLANT, WITH A TRUNK THREE INCHES OR GREATER IN DIAMETER AT A HEIGHT OF 4.5 FEET ABOVE THE GROUND SURFACE, AND WITH A MINIMUM HEIGHT OF 13 FEET.

REVIEW OF DRAINAGE FACILITIES

BEFORE ANY WORK IS STARTED ON THE PROJECT AND AGAIN BEFORE FINAL ACCEPTANCE BY THE STATE, REPRESENTATIVES OF THE STATE AND THE CONTRACTOR, ALONG WITH LOCAL REPRESENTATIVES, SHALL MAKE AN INSPECTION OF ALL EXISTING SEWERS WHICH ARE TO REMAIN IN SERVICE AND WHICH MAY BE AFFECTED BY THE WORK. THE CONDITION OF THE EXISTING CONDUITS AND THEIR APPURTENANCE SHALL BE DETERMINED FROM FIELD OBSERVATIONS. RECORDS OF THE INSPECTION SHALL BE KEPT IN WRITING BY THE STATE.

ALL NEW CONDUITS, INLETS, CATCH BASINS, AND MANHOLES CONSTRUCTED AS A PART OF THE PROJECT SHALL BE FREE OF ALL FOREIGN MATTER AND IN A CLEAN CONDITION BEFORE THE PROJECT WILL BE ACCEPTED BY THE STATE.

ALL EXISTING SEWERS INSPECTED INITIALLY BY THE ABOVE MENTIONED PARTIES SHALL BE MAINTAINED AND LEFT IN A CONDITION REASONABLY COMPARABLE TO THAT DETERMINED BY THE ORIGINAL INSPECTION. ANY CHANGE IN THE CONDITION RESULTING FROM THE CONTRACTOR'S OPERATIONS SHALL BE CORRECTED BY THE CONTRACTOR TO THE SATISFACTION OF THE ENGINEER.

PAYMENT FOR ALL OPERATIONS DESCRIBED ABOVE SHALL BE INCLUDED (WITH THE OTHER REQUIREMENTS OF CMS 623) IN THE CONTRACT PRICE FOR ITEM 623, CONSTRUCTION LAYOUT STAKES AND SURVEYING, AS PER PLAN.

ITEM 203 - EXCAVATION

THE FOLLOWING ESTIMATED QUANTITY HAS BEEN INCLUDED IN THE PLAN AND CARRIED TO THE GENERAL SUMMARY:

ITEM 203, EXCAVATION 762 CY

ITEM 203 - EMBANKMENT

THE FOLLOWING ESTIMATED QUANTITY HAS BEEN INCLUDED IN THE PLAN AND CARRIED TO THE GENERAL SUMMARY:

ITEM 203, EMBANKMENT 14 CY

SEEDING AND MULCHING

THE FOLLOWING QUANTITIES ARE PROVIDED TO PROMOTE GROWTH AND CARE OF PERMANENT SEEDED AREAS:

659, SOIL ANALYSIS TEST
2 EACH

659, TOPSOIL
149 CU. YD.

659, SEEDING AND MULCHING
1340 SQ. YD.

659, COMMERCIAL FERTILIZER
.18 TON

659, LIME
.28 ACRES

659, WATER
7 M. GAL.

SEEDING AND MULCHING SHALL BE APPLIED TO ALL AREAS OF EXPOSED SOIL BETWEEN THE RIGHT-OF-WAY LINES, AND WITHIN THE CONSTRUCTION LIMITS FOR AREAS OUTSIDE THE RIGHT-OF-WAY LINES COVERED BY WORK AGREEMENT OR SLOPE EASEMENT. QUANTITY CALCULATIONS FOR SEEDING AND MULCHING ARE BASED ON THESE LIMITS.

TRAFFIC CONTROL QUANTITIES

THE FOLLOWING ESTIMATED QUANTITIES HAVE BEEN INCLUDED IN THE GENERAL SUMMARY FOR THE REMOVAL AND REERECTION OF THE EXISTING S3-1 SIGN AT STA. 805+71±:

ITEM 630, GROUND MOUNTED SUPPORT, NO. 2 POST 13 FT

ITEM 630, REMOVAL OF GROUND MOUNTED SIGN AND REERECTION 1 EACH

ITEM 630, REMOVAL OF GROUND MOUNTED POST SUPPORT AND DISPOSAL 1 EACH

SURVEYING PARAMETERS

PRIMARY PROJECT CONTROL MONUMENTS GOVERN ALL POSITIONING ON ODOT PROJECTS. SEE BELOW FOR A TABLE CONTAINING PROJECT CONTROL INFORMATION.

USE THE FOLLOWING PROJECT CONTROL, VERTICAL POSITIONING, AND HORIZONTAL POSITIONING PARAMETERS FOR ALL SURVEYING:

PROJECT CONTROL

POSITIONING METHOD: ODOT VRS
MONUMENT TYPE: TYPE A

VERTICAL POSITIONING

ORTHOMETRIC HEIGHT DATUM: NAVD 88
GEOID: GEOID 12A

HORIZONTAL POSITIONING

REFERENCE FRAME: NAD 83 (2011)
ELLIPSOID: GRS 1980
MAP PROJECTION: LAMBERT CONFORMAL CONIC
COORDINATE SYSTEM: OHIO STATE PLANE, NORTH ZONE
COMBINED SCALE FACTOR: 1.00004729024511
ORIGIN OF COORDINATE SYSTEM: N 304281.192 E 2122925.849

USE THE POSITIONING METHODS AND MONUMENT TYPE USED IN THE ORIGINAL SURVEY TO RESTORE ALL MONUMENTS RELATED TO PRIMARY PROJECT CONTROL THAT ARE DAMAGED OR DESTROYED BY CONSTRUCTION ACTIVITIES. RESTORE THE DAMAGED OR DESTROYED MONUMENTS IN ACCORDANCE WITH CMS 623.

UNITS ARE IN U.S. SURVEY FEET.

PROJECT CONTROL

POINT	GROUND NORTH	GROUND EAST	ELEVATION	STATION	OFFSET	FEATURE	DESCRIPTION
S600	304,281.19	2,122,925.85	844.554	802+45.04	20.973	IPINS	SIZE: 5/8" NAME:ODOT
S601	304,953.93	2,123,492.07	815.456	808+44.62	24.621	IPINS	SIZE: 5/8" NAME:ODOT

I:\ProjectData\108272\Design\Roadway\Sheets\108272_GN001.dgn Sheet 22-JUL-2019 10:34AM dloranz

CALCULATED
GBS
CHECKED
DUL

GENERAL NOTES

HOL-62-15.24

H:\ProjectData\08272\Design\Roadway\Sheets\08272_MN001.dgn Sheet 18-JUN-2019 1:39PM diorenz

ITEM 614 - MAINTAINING TRAFFIC, AS PER PLAN

MAINTAIN TRAFFIC WITH DRUMS AS PER STANDARD DRAWING MT-96.11 (SEE NOTES 8A-8E ON SCD MT-96.11 SHEET 3 OF 3). THE TEMPORARY SIGNAL TIMING FOR THE WORK ZONE SHALL BE DETERMINED BY THE ENGINEER BASED ON THE LENGTH BETWEEN WORK ZONE STOP BARS.

LENGTH AND DURATION OF LANE CLOSURES AND RESTRICTIONS SHALL BE AT THE APPROVAL OF THE ENGINEER. IT IS THE INTENT TO MINIMIZE THE IMPACT TO THE TRAVELING PUBLIC. LANE CLOSURES OR RESTRICTIONS OVER SEGMENTS OF THE PROJECT IN WHICH NO WORK IS ANTICIPATED WITHIN A REASONABLE TIME FRAME, AS DETERMINED BY THE ENGINEER, SHALL NOT BE PERMITTED. THE LEVEL OF UTILIZATION OF MAINTENANCE OF TRAFFIC DEVICES SHALL BE COMMENSURATE WITH THE WORK IN PROGRESS.

THE CONTRACTOR SHALL MAINTAIN ACCESS TO THE FIELD DRIVES AT ALL TIMES DURING CONSTRUCTION.

THE MAINTENANCE OF TRAFFIC SHALL BE IN CONFORMANCE WITH THE OHIO MANUAL OF UNIFORM TRAFFIC CONTROL DEVICES, LATEST REVISION; THE REFERENCED STANDARD CONSTRUCTION DRAWINGS, INCLUDING DESIGNER NOTES; THE CONSTRUCTION AND MATERIAL SPECIFICATIONS (CMS); POLICY NO. 516-003(P) TRAFFIC MANAGEMENT IN WORK ZONES INTERSTATE AND OTHER FREEWAYS; ODOT LOCATION AND DESIGN MANUAL, VOLUME 1; ODOT TRAFFIC ENGINEERING MANUAL; AND ALL REQUIREMENTS DETAILED IN THESE PLANS.

PRIOR TO BEGINNING WORK, THE CONTRACTOR SHALL SUBMIT A MAINTENANCE OF TRAFFIC PLAN TO THE ENGINEER FOR APPROVAL.

PAYMENT FOR ALL LABOR, EQUIPMENT, AND MATERIALS SHALL BE INCLUDED IN THE LUMP SUM CONTRACT PRICE FOR ITEM 614 - MAINTAINING TRAFFIC, AS PER PLAN.

NOTIFICATION OF TRAFFIC RESTRICTIONS

THROUGHOUT THE DURATION OF THE PROJECT, THE CONTRACTOR SHALL NOTIFY THE PROJECT ENGINEER IN WRITING OF ALL TRAFFIC RESTRICTIONS AND UPCOMING MAINTENANCE OF TRAFFIC CHANGES. THE CONTRACTOR SHALL ENSURE THE WRITTEN NOTIFICATION IS SUBMITTED IN A TIMELY MANNER TO ALLOW THE PROJECT ENGINEER TO MEET THE REQUIRED TIME FRAMES SET FORTH IN THE TABLE BELOW TO INFORM SPECIAL HAULING PERMITS SECTION (HAULING.PERMITS@DOT.OHIO.GOV) AND THE DISTRICT PUBLIC INFORMATION OFFICE (PIO). THIS NOTIFICATION SHALL BE RECEIVED BY THE PROJECT ENGINEER PRIOR TO THE PHYSICAL SETUP OF ANY APPLICABLE SIGNS OR MESSAGE BOARDS.

INFORMATION SHOULD INCLUDE, BUT IS NOT LIMITED TO, ALL CONSTRUCTION ACTIVITIES THAT IMPACT OR INTERFERE WITH TRAFFIC AND SHALL LIST THE SPECIFIC LOCATION, TYPE OF WORK, ROAD STATUS, DATE AND TIME OF RESTRICTION, DURATION OF RESTRICTION, NUMBER OF LANES MAINTAINED, NUMBER OF LANES CLOSED, MINIMUM VERTICAL CLEARANCE, MINIMUM WIDTH OF DRIVABLE PAVEMENT, DETOUR ROUTES, IF APPLICABLE, AND ANY OTHER INFORMATION REQUESTED BY THE PROJECT ENGINEER.

NOTIFICATION TIME TABLE

ITEM	DURATION OF CLOSURE	NOTICE DUE TO PERMITS & PIO
RAMP & ROAD CLOSURES	>= 2 WEEKS	21 CALENDAR DAYS PRIOR TO CLOSURE
	> 12 HOURS & < 2 WEEKS	14 CALENDAR DAYS PRIOR TO CLOSURE
	< 12 HOURS	4 BUSINESS DAYS PRIOR TO CLOSURE
LANE CLOSURES & RESTRICTIONS	>= 2 WEEKS	14 CALENDAR DAYS PRIOR TO CLOSURE
	< 2 WEEKS	5 BUSINESS DAYS PRIOR TO CLOSURE
START OF CONSTRUCTION & TRAFFIC PATTERN CHANGES	N/A	14 CALENDAR DAYS PRIOR TO IMPLEMENTATION

ANY UNFORESEEN CONDITIONS NOT SPECIFIED IN THE PLANS REQUIRING TRAFFIC RESTRICTIONS SHALL ALSO BE REPORTED TO THE PROJECT ENGINEER USING THE NOTIFICATION TIME TABLE.

CALCULATED
GBS
CHECKED
DJL

MAINTENANCE OF TRAFFIC

HOL-62-15.24

4
9

I:\ProjectData\108272\Design\Roadway\Sheets\108272_CP00\dgn Sheet 18-JUN-2019 1:41PM dlorenz

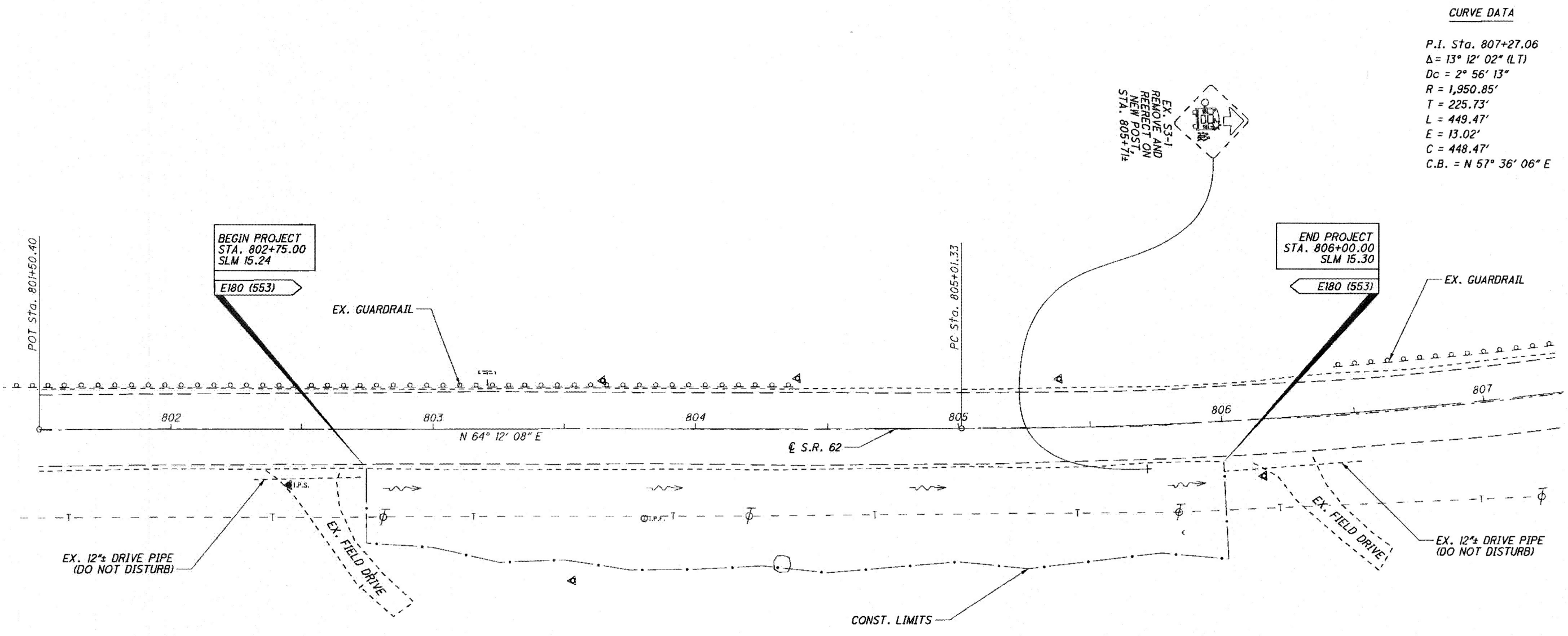

CURVE DATA

P.I. Sta. 807+27.06
 $\Delta = 13^\circ 12' 02''$ (LT)
 $Dc = 2^\circ 56' 13''$
 $R = 1,950.85'$
 $T = 225.73'$
 $L = 449.47'$
 $E = 13.02'$
 $C = 448.47'$
 $C.B. = N 57^\circ 36' 06'' E$

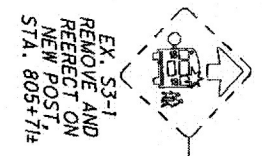

HORIZONTAL SCALE IN FEET	
CALCULATED	G.B.S.
CHECKED	D.U.L.
PLAN SHEET STA. 801+50 TO STA. 807+25	
HOL-62-15.24	