

STATE OF OHIO
 DEPARTMENT OF HIGHWAYS
 HOL-62-19.94
 HOL-76(9.04-9.07-9.27)
 HOLMES COUNTY
 VILLAGE OF MILLERSBURG

FED. RD. DIVISION	STATE	PROJECT	FISCAL YEAR	1 9
2	OHIO		1947	

HOL-62-19.94 (UNIT 1)
 HOL-76(9.04-9.07-9.27) (UNIT 2)

CONVENTIONAL SIGNS

COUNTY LINE	----
TOWNSHIP LINE	-----
SECTION LINE	- - - - -
CORPORATION LINE	====
PROPERTY LINE	-----
FENCE LINE	- x - x - x
CENTER LINE	-----
RAILROADS	- + - + - +

INDEX OF SHEETS

TITLE PAGE	SHEET 1
TYPICAL SECTIONS	" 2
GENERAL NOTES & SUMMARY OF QUANTITIES	" 3
PLAN & PROFILE	" 4-9

LINE DATA

BEGIN PROJECT & UNIT 1	STA. 0+00
END UNIT 1	STA. 17+65
NET LENGTH UNIT 1	1765 Ft. or .334 Mi.
BEGIN UNIT 2	STA. 38+00
END UNIT 2 & PROJECT	STA. 85+41
GROSS LENGTH UNIT 2	4741 Ft.
ADDITIONS (See Sheets NA7&8)	1047 Ft.
NET LENGTH UNIT 2	4845.7 Ft. or .917 Mi.
NET LENGTH PROJECT	6610.7 Ft. or 1.252 Mi.

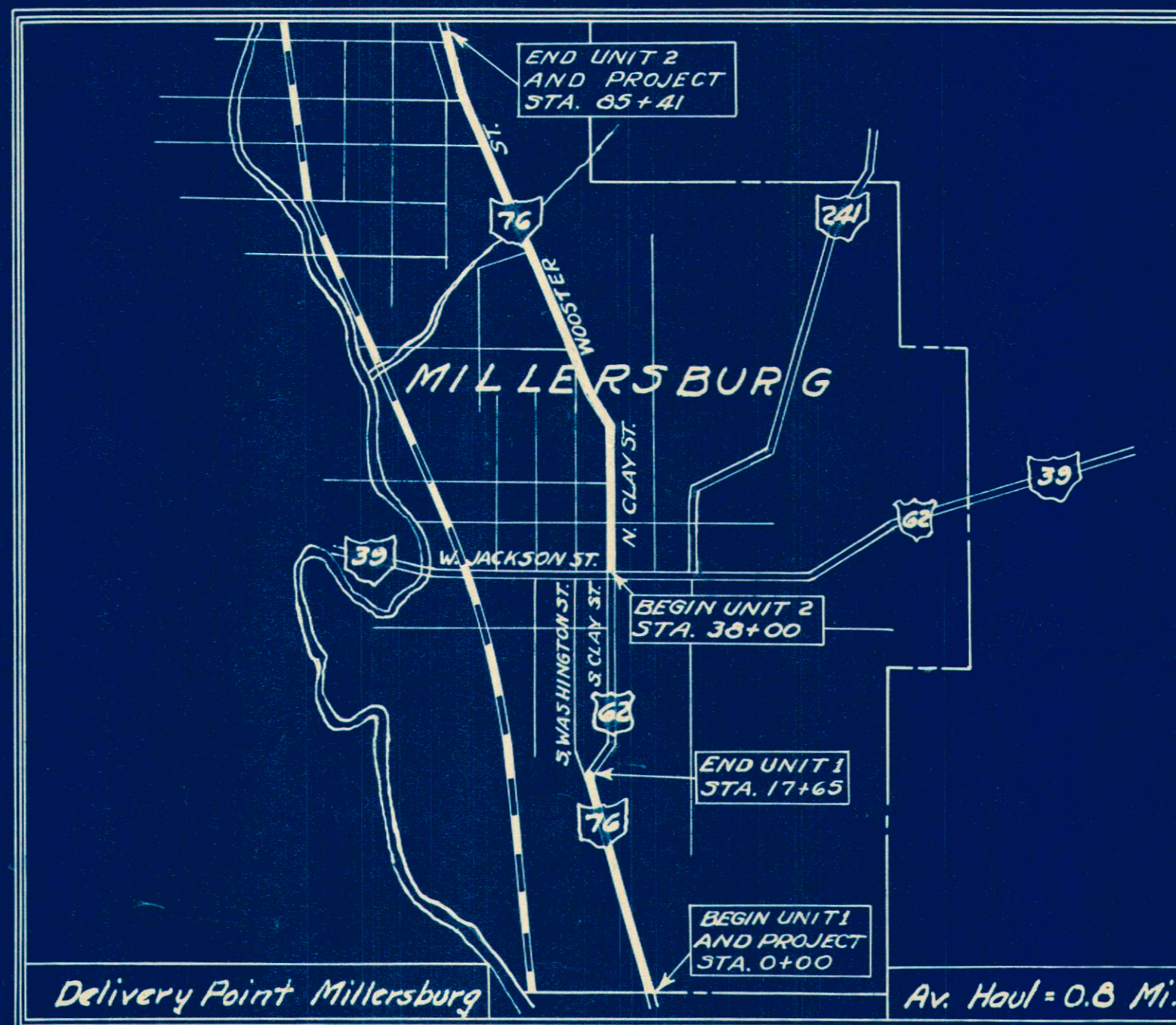
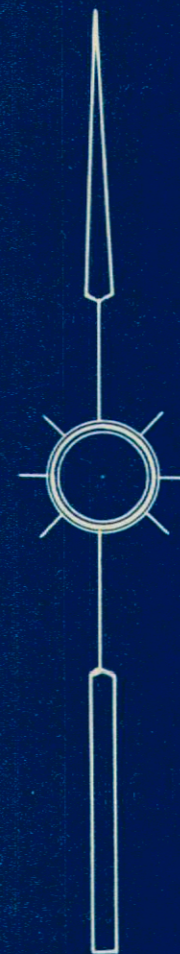

LOCATION PLAN
 Scale 1" = 1200'

PORTION TO BE IMPROVED

FEDERAL HIGHWAYS	====
STATE HIGHWAYS	-----
OTHER ROADS	-----

SCALES

PLAN	1" = 100'
PROFILE-HORIZONTAL	1" = 100'
PROFILE-VERTICAL	1" = 10'

The Standard Specifications of the State of Ohio, Department of Highways, including changes and supplemental specifications listed in the proposal shall govern this improvement.

I hereby approve these plans and declare that the making of this improvement will not require the closing to traffic of the highway, and that provisions for maintenance and safety of traffic will be as set forth in these plans and estimates.

The right of way for this improvement will be provided by the State of Ohio.

Approved E.R. McCallough
 Date 7-10-47 Acting Resident Deputy Director.

Approved E.R. McCallough
 Date 7-10-47 Division Deputy Director.

Approved _____
 Date _____ Chief Engineer Bureau of Maintenance.

Approved George J. Thormyer
 Date 7-20-47 Chief Engineer Bureau of Bridges and R.R. Crossings.

Approved _____
 Date 7-20-47 Chief Engineer Bureau of Location and Design.

Approved _____
 Date _____ First Ass't. Director & Chief Engineer.

Approved Wesley D. Shaffer
 Date 7-31-47 Director of Highways.

FILE NO

HOL-62-19.94
HOL-76(9.04-9.07-9.27)
VILLAGE OF MILLERSBURG
DATE OF LETTING
CONTRACT NO

STANDARD DRAWINGS

6-8.07	2-1-47

SUPPLEMENTAL SPECIFICATIONS

TYPICAL SECTIONS

TYPE T-35

SCALE 1/2"=1'-0"

FED. RD. DIVISION	STATE	PROJECT	FISCAL YEAR
2	OHIO		1947

HOL-62-19.94 (UNIT 1)
HOL-76-(9.04-9.07-927) (UNIT 2)

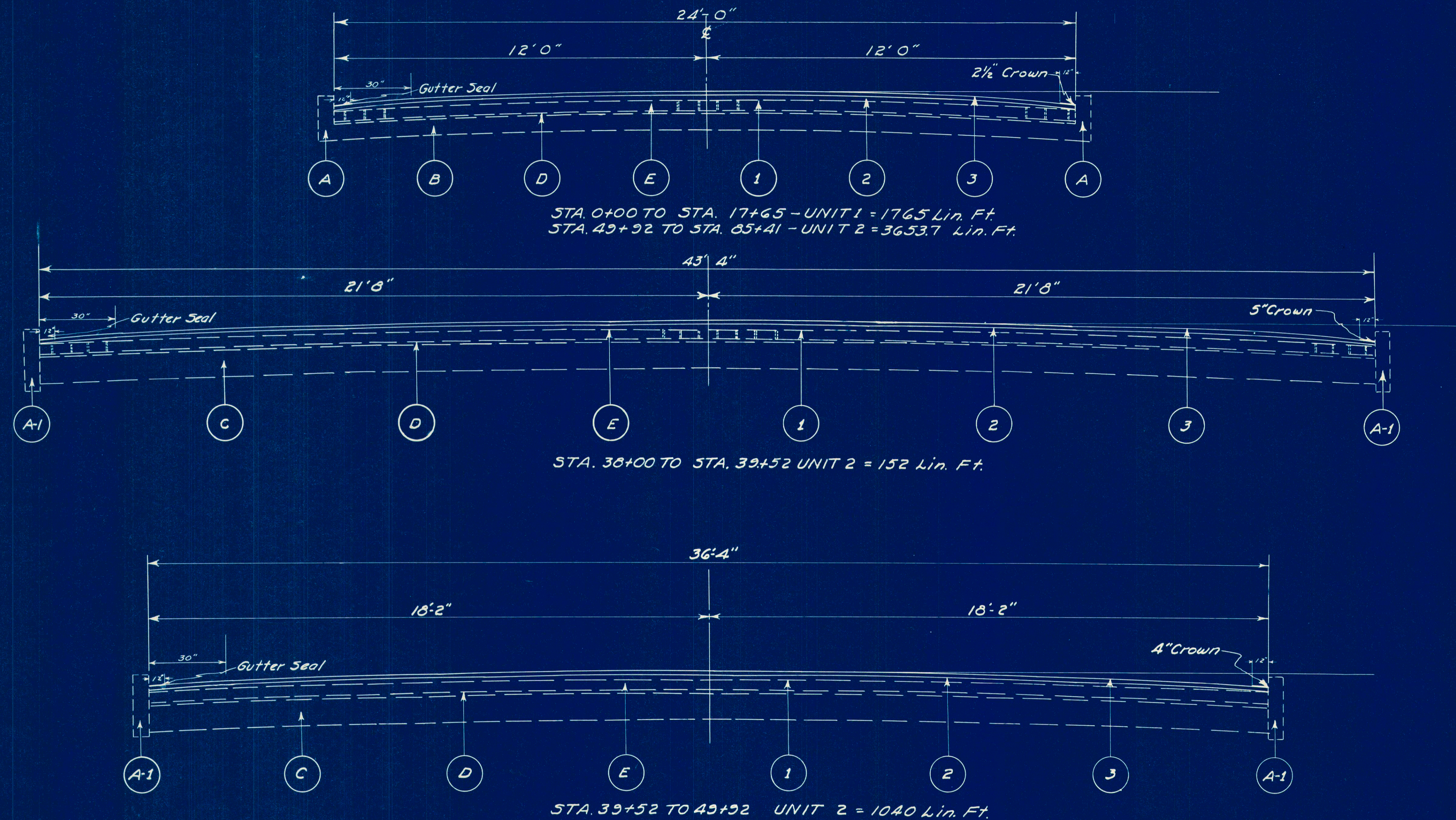

KEY

- (A) EXISTING 6" CONCRETE INTEGRAL CURB.
- (A-1) EXISTING 6" X 24" STONE CURB.
- (B) EXISTING 6" CONCRETE BASE.
- (C) EXISTING 10" SLAG BASE.
- (D) EXISTING 1" SAND CUSHION
- (E) EXISTING 4" BRICK.
- (1) T-30 TACK COAT AT 0.10 GAL. PER. SQ. YD.
- (2) B-35 1 1/2" MIN. ASPHALTIC CONCRETE LEVELING COURSE.
- (3) T-35 1" ASPHALTIC CONCRETE SURFACE COURSE (TYPE C)

DETAILS, NOTES, & SUMMARY OF QUANTITIES

FED. RD. DIVISION	STATE	PROJECT	FISCAL YEAR
2	OHIO		1947

3
9

HOL-62-1994 (UNIT 1)
HOL-76 (9.04-9.07-927) (UNIT 2)

PAVEMENT CALCULATIONS

Net Length Unit 1	1765 Ft. or .334 Mi.
Unit 1 $1765 \times 24 \div 9 =$	4706.66 Sq. Yds.
Extra Pavement (See Plan Sheets)	247.00 Sq. Yds.
Total Area Unit 1	4953.66 Sq. Yds.
Net Length Unit 2	4845.7 Ft. or .917 Miles
Unit 2 $3653.7 \times 24 \div 9 =$	9743.2 Sq. Yds.
$152 \times 43.33 \div 9 =$	731.85 Sq. Yds.
$1040 \times 36.33 \div 9 =$	4198.15 Sq. Yds.
Extra Pavement (See Line Sheets)	882.05 Sq. Yds.
Total Area Unit 2	15,555.15 Sq. Yds.
T-30 TACK COAT	
Unit 1 $4953.66 \times 0.10 =$	496 Gal.
Unit 2 $15,555.1 \times 0.10 =$	1556 Gal.
B-35 LEVELING COURSE	
Unit 1 - $1765 - 50$ (See Sheet A) - $1715 \times 24 \div 9 = 4573 + 247 = 4820$ Sq. Yds.	150 Cu. Yds.
$4820 \times 1.25 \div 36 = 167 - 17$ (Wedge Course in Gutter)	40 Cu. Yds.
Extra Levelling (Estimated)	Cu. Yds.
Total B-35 Unit 1	190 Cu. Yds.
Unit 2 - $15,555.1 \times 1.25 \div 36 = 540 - 47$ (Wedge Course in Gutter)	493 Cu. Yds.
Extra Levelling (Estimated)	125 Cu. Yds.
Total B-35 Unit 2	618 Cu. Yds.
T-35 SURFACE COURSE	
Unit 1 $4953.66 \times 1 \div 36 =$	138 Cu. Yds.
Unit 2 $15,555.1 \times 1 \div 36 =$	432 Cu. Yds.

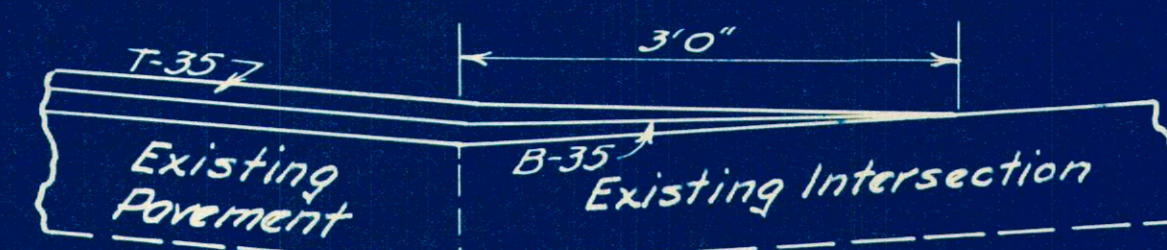

FEATHERING DETAIL AT INTERSECTIONS

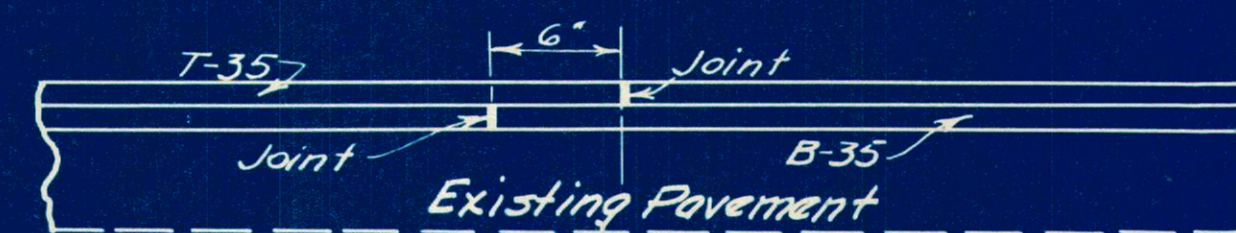

METHOD OF LAPPING LONGITUDINAL JOINTS

GENERAL NOTES

TRAFFIC: - Traffic shall be maintained at all times. The length of one way traffic zones shall be kept to a minimum consistent with the requirements of Sec. T-35.23.

The item of "Maintaining Traffic" shall include furnishing lights, all signs, Barricades and watchmen according to requirements of Sec. G-8.07, Barricades, Danger and Warning Signs to secure the flow of Traffic Twenty four (24) hours daily.

PROFILE: - The profile of the proposed surface course shall be approximately 2 1/4 inches above that of the existing pavement.

FILLING MAJOR DEPRESSIONS: - Major depressions in existing pavement shall be filled and compacted with bituminous concrete leveling material in advance of placing of the surface course. These depressions shall be filled in layers not to exceed 3 inches in depth when compacted.

EXTRA LEVELING MATERIAL: - The Asphaltic concrete leveling course thickness shall be maintained by the use of extra leveling material where necessary.

GUTTER RESURFACING: - Special care shall be exercised during construction to obtain Maximum compaction of Bituminous concrete in all gutters.

SUMMARY OF QUANTITIES

ITEM	QUANTITY		TOTAL	UNIT	DESCRIPTION
	UNIT 1	UNIT 2			
T-30	496	1556	2052	Gals.	Bituminous Tack Coat, Sec. M-5.5 MS-1
B-35	190	618	808	Cu. Yds.	Asphaltic Concrete Leveling Course.
T-35	138	432	570	Cu. Yds.	Asphaltic Concrete Surface Course, Type "C"
	Lump	Lump	Lump	Lump	Maintaining Traffic, including Lights, Signs, Barricades and Watchmen, twenty-four hours daily.

HOL-62-1934 (UNIT 1)
HOL-76(9.04-9.07-927) (UNIT 2)

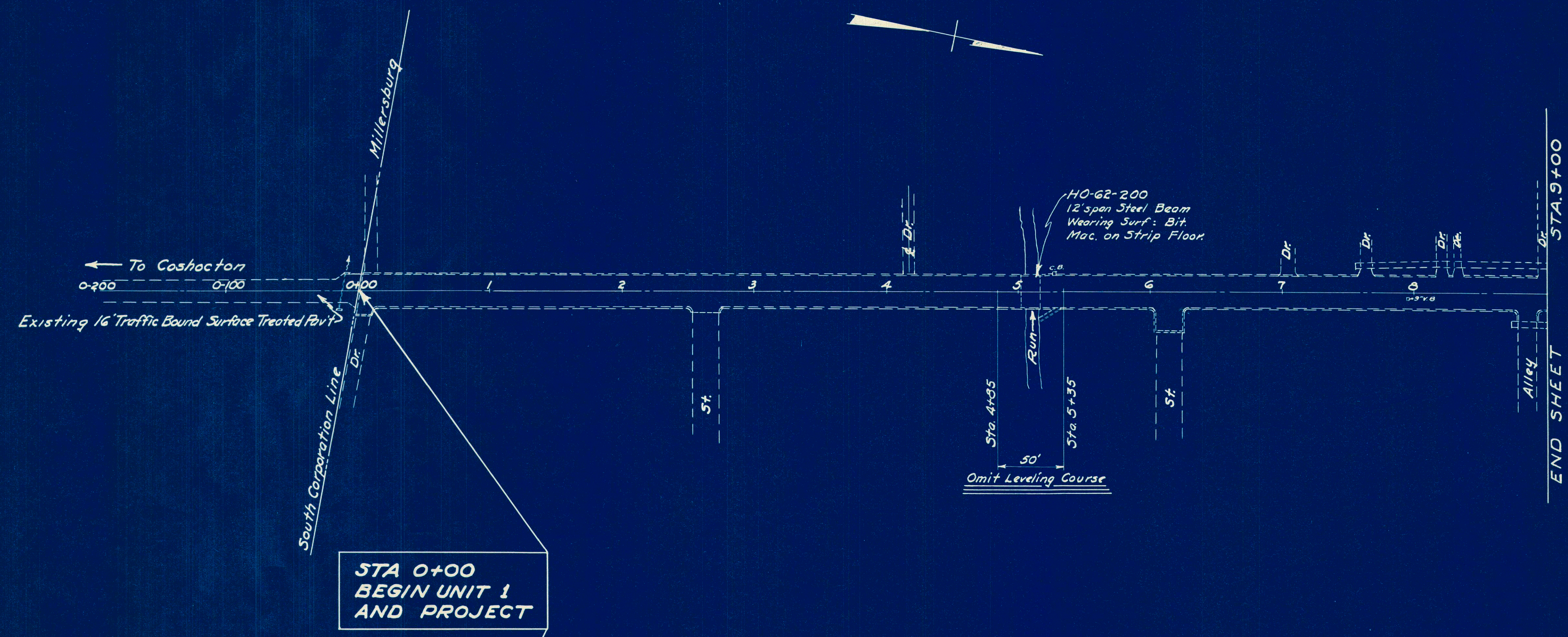

Station	Side &	Sq. Yds.
0+06	Rt.	4
2+60	Rt.	7
4+12	Rt.	7
7+62	Lt.	4
8+20	Lt.	4
8+32	Lt.	4
8+96	Lt.	4
Total		34

**STA 0+00
BEGIN UNIT 1
AND PROJECT**

+ In center of East H.W. of Culvert. Rt Sta. 0-17
B.M. Elev 823.65

U.S.G.S. B.M. (U31X-1934)
18' West of S.W. cor. County Jail
Elev. 839.69

□ On 1st step at curb
Rt. Sta. 7+62
B.M. Elev. 831.39

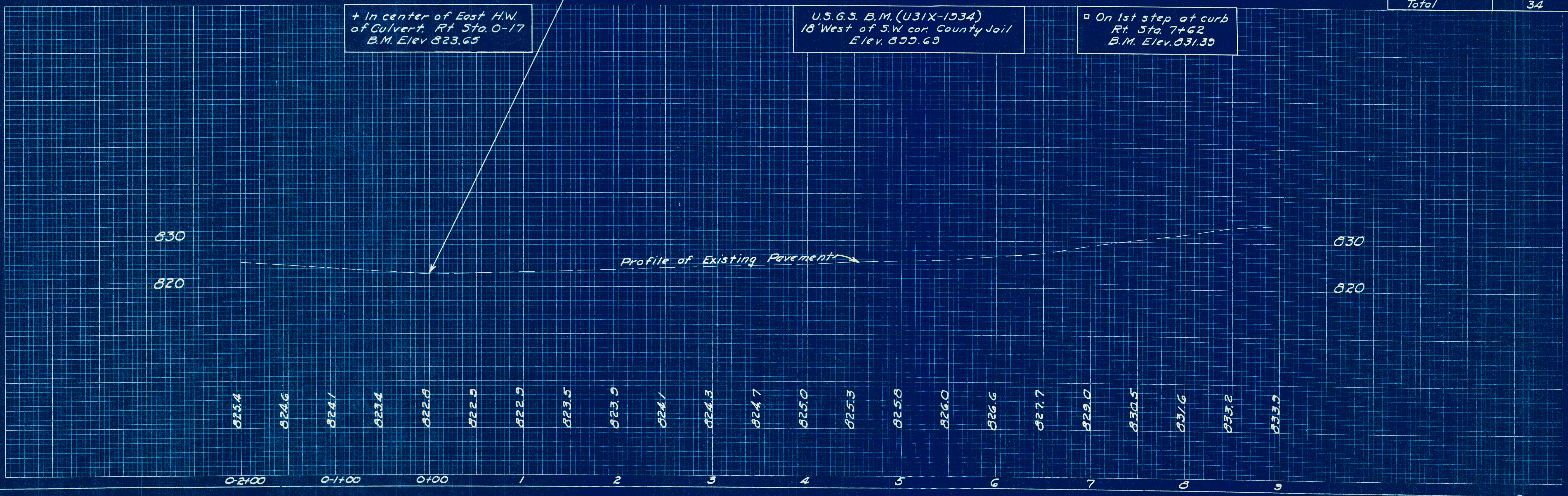

HOL-62-19.94 (UNIT 1)
HOL-76(304-307-327)(UNIT 2)

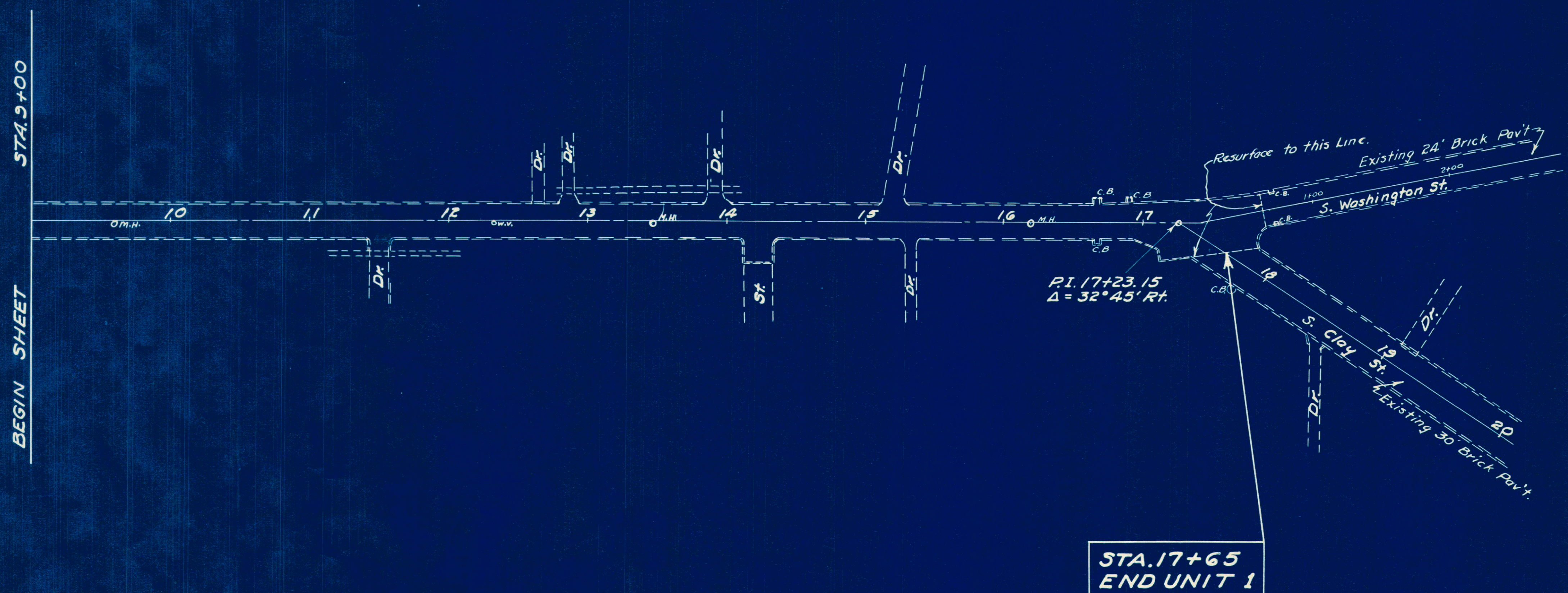

EXTRA PAVEMENT		
Station	Side &	Sq. Yds.
12+85	Lt.	5
13+92	Lt.	7
14+20	Rt.	7
15+16	Lt.	5
15+31	Rt.	4
17+23	Rt.	35
17+45	Lt.	150
Total		213

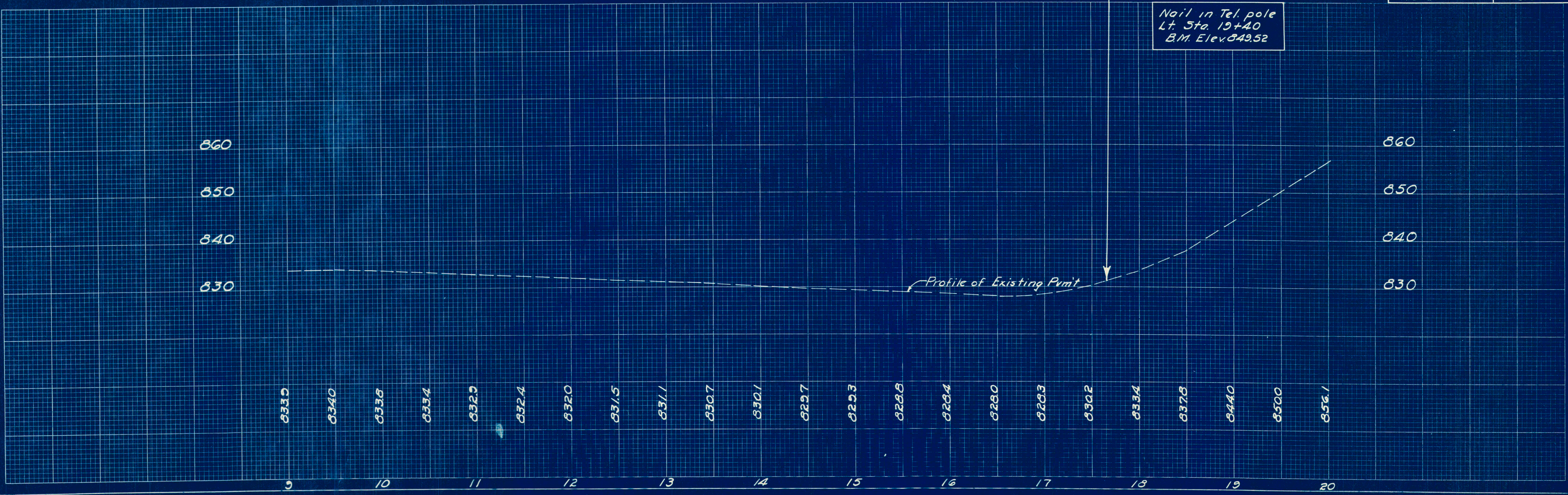

HOL-62-19.94 (UNIT 1)
HOL-76(304-907-927)(UNIT 2)

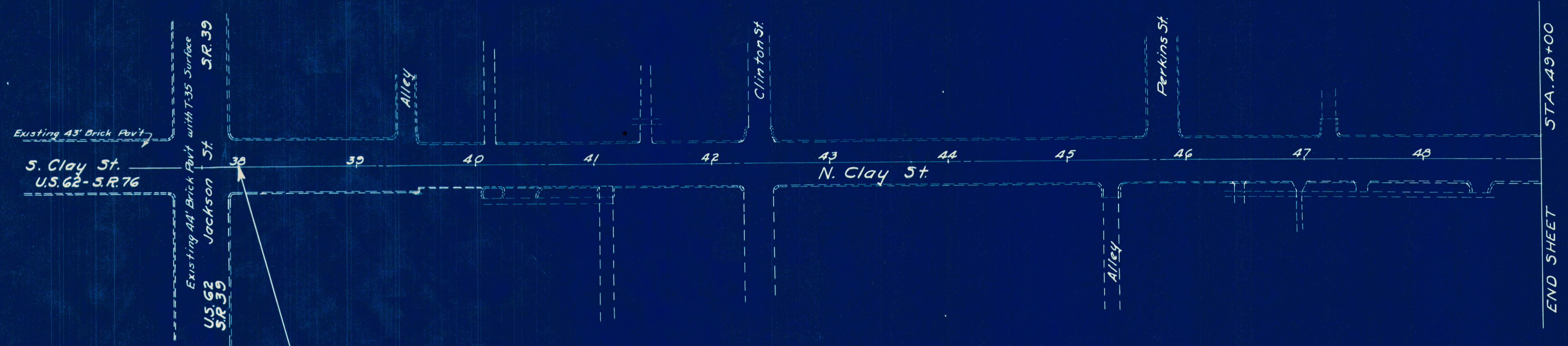

EXTRA PAVEMENT		
Station	Side	Sq. Yds.
39+43	Lt.	6
40+13	Lt.	3
41+46	Lt.	4
42+40	Lt.	9
42+40	Rt.	9
45+32	Rt.	5
45+81	Lt.	10
46+95	Rt.	4
47+21	Lt.	5
47+48	Rt.	5
48+47	Rt.	6
Total		66

STA 38+00
BEGIN UNIT 2

U.S.G.S. B.M. (U31X-1934)
18' West of S.W. Cor. County Jail
Elev. 899.69

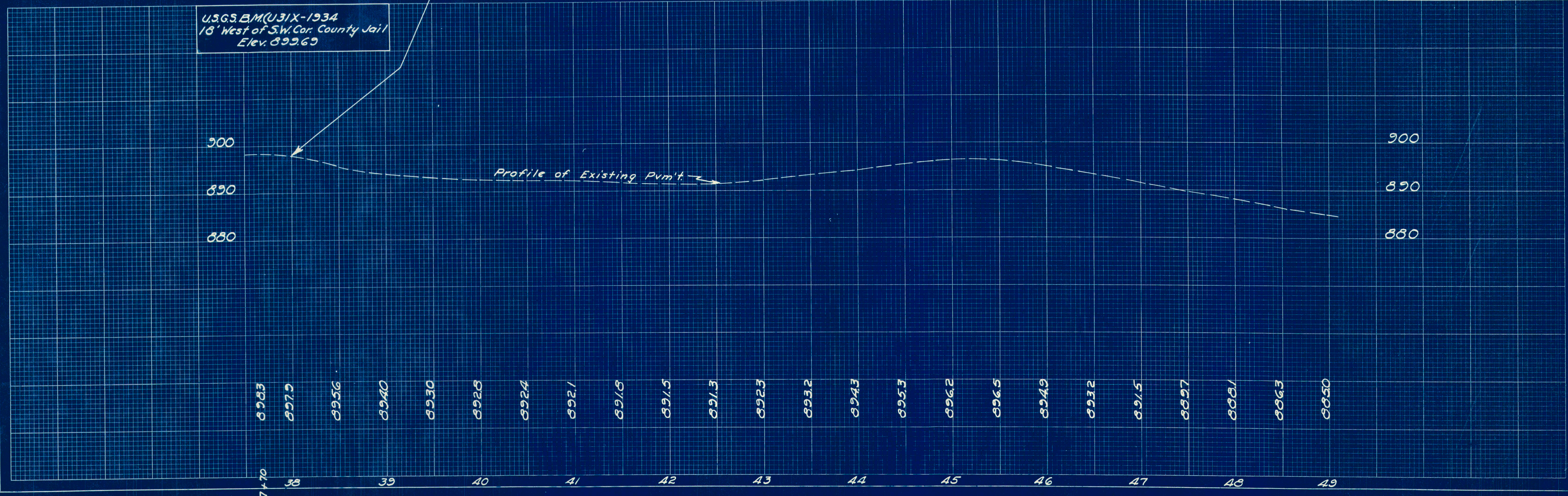

HOL-62-19.94 (UNIT 1)
HOL-76-(9.04-9.07-9.27) (UNIT 2)

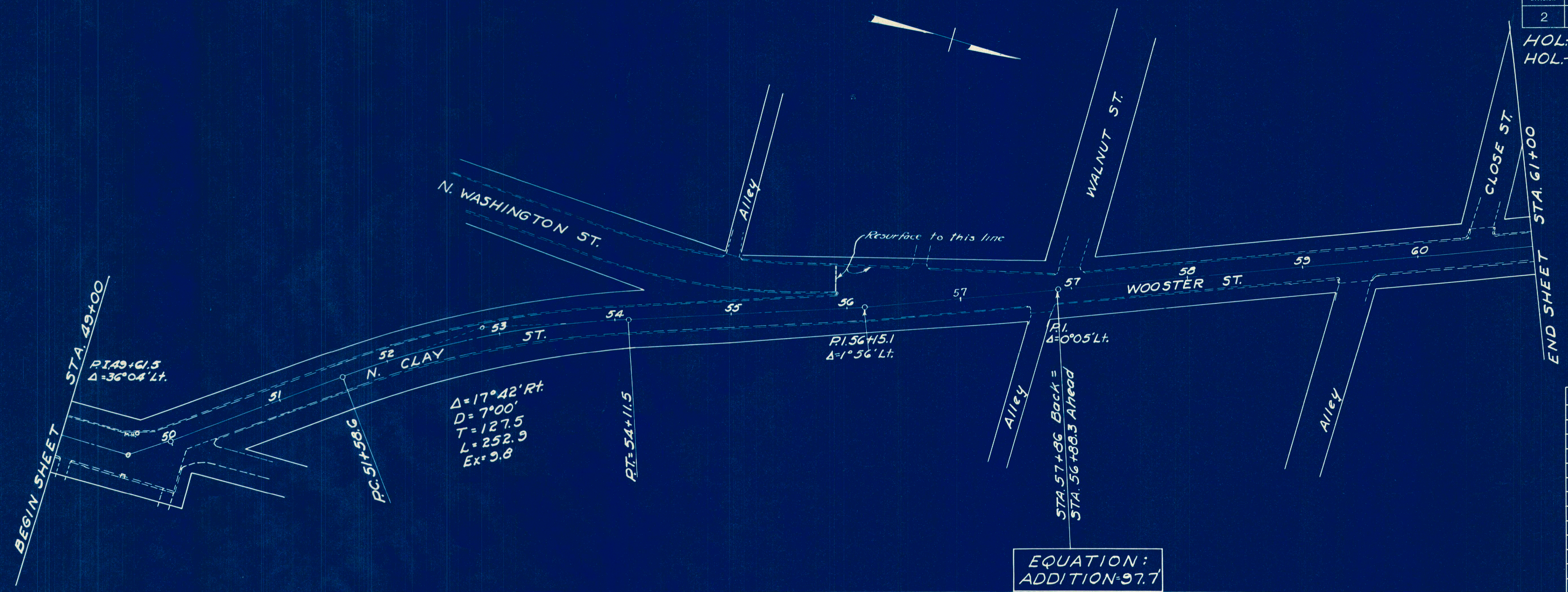

EXTRA PAVEMENT		
Station	Side	Sq. Yds.
49+08	Rt.	4
49+80	Lt.	17
50+00	Rt.	80
50+20	Rt.	15
56+90	Lt.	550
57+70	Rt.	6
57+86	Lt.	8
59+50	Rt.	11
60+50	Lt.	8
Total		699

EQUATION:
ADDITION-97.7

□ On Stone Curb
Rt. Sta. 49+61.5
B.M. Elev. 883.95

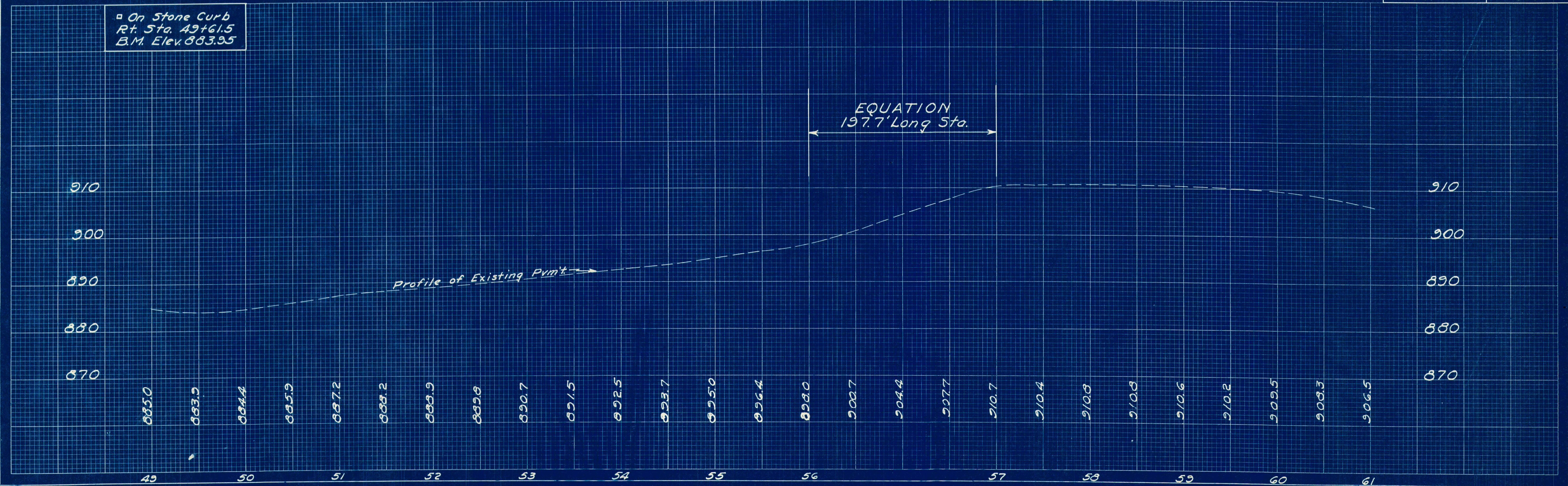

HOL-62-1994 (UNIT 1)
HOL-76(9.04-9.07-927)(UNIT 2)

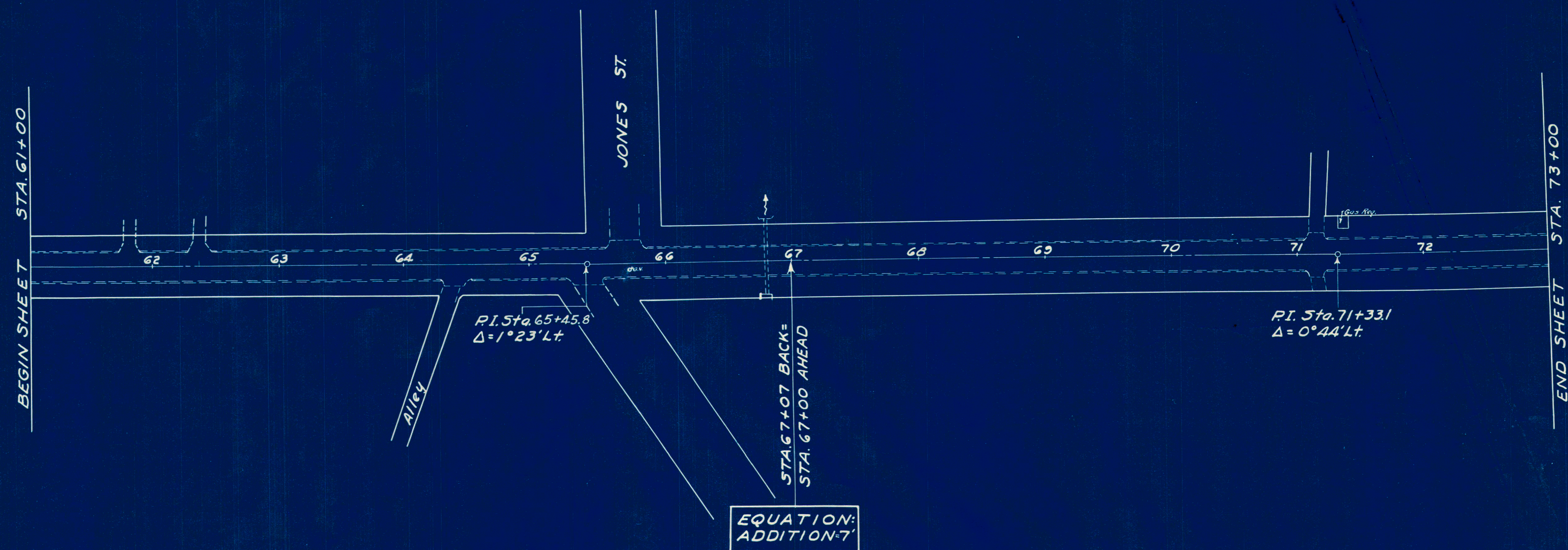

EXTRA PAVEMENT		
Station	Side	Sq. Yds.
61+80	Lt.	6
62+35	Lt.	6
64+45	Rt.	6
65+45	Rt.	8
65+75	Lt.	10
71+15	Rt.	5
71+15	Lt.	5
Total		46

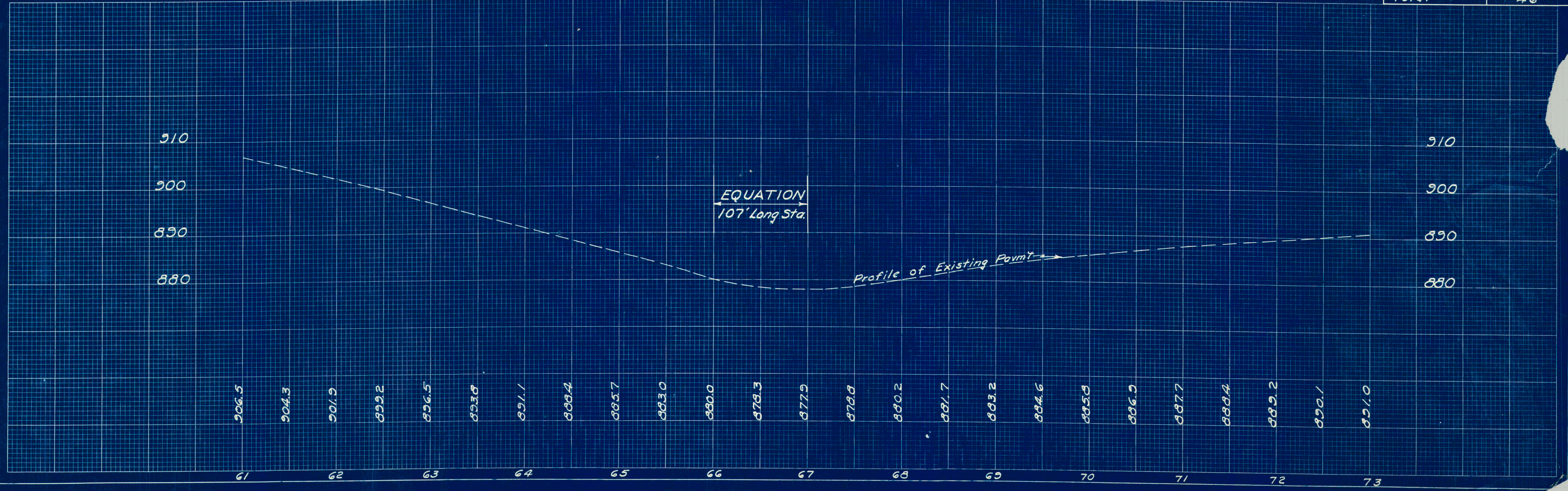

HOL-62-19.94 (UNIT 1)
HOL-76(304-307-327)(UNIT 2)

EXTRA PAVEMENT		
Station	Side &	Sq. Yds.
74+82	Rt.	5
75+15	Lt.	10
75+15	Rt.	11
78+85	Lt.	10
79+20	Rt.	9
79+75	Lt.	6
80+65	Lt.	5
80+65	Rt.	5
83+65	Lt.	10
Total		71

BEGIN SHEET STA. 73+00

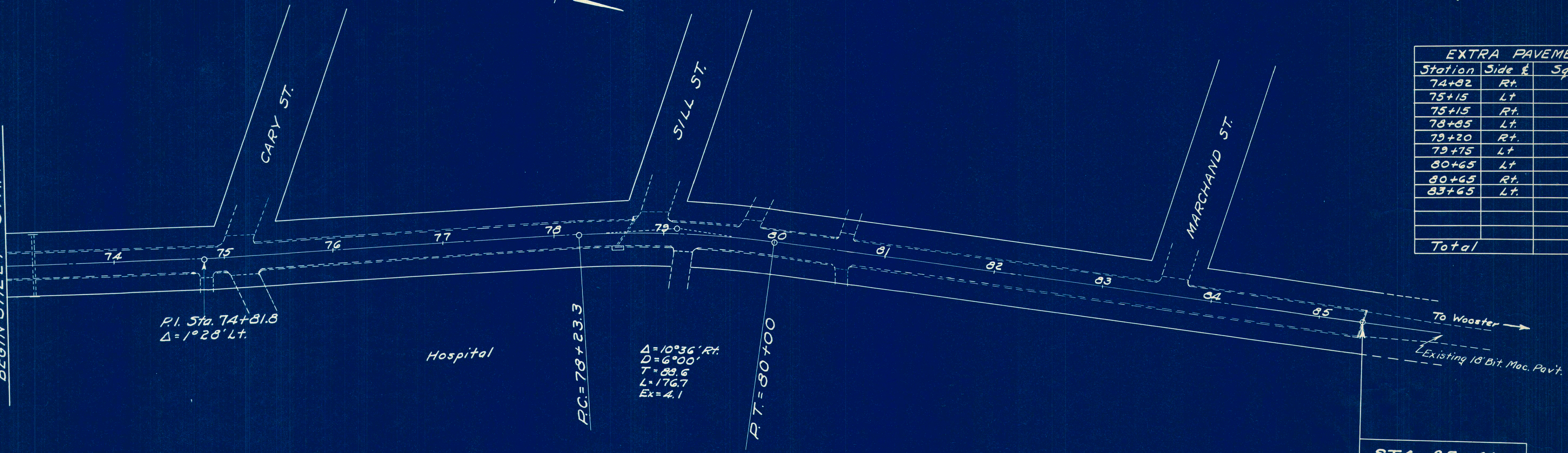

STA. 85+41
END UNIT 2
AND PROJECT

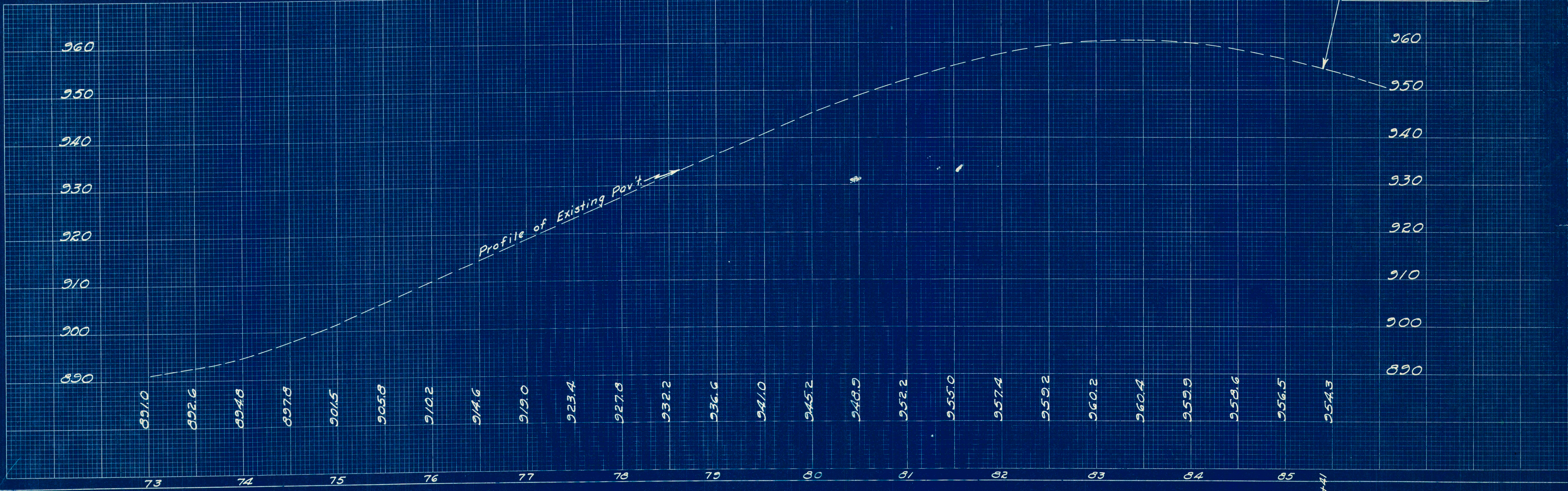

HOL-62-19.94 (UNIT 1) HOL-76(304-307-327)(UNIT 2)

STANDARD BARRICADES AND GATES

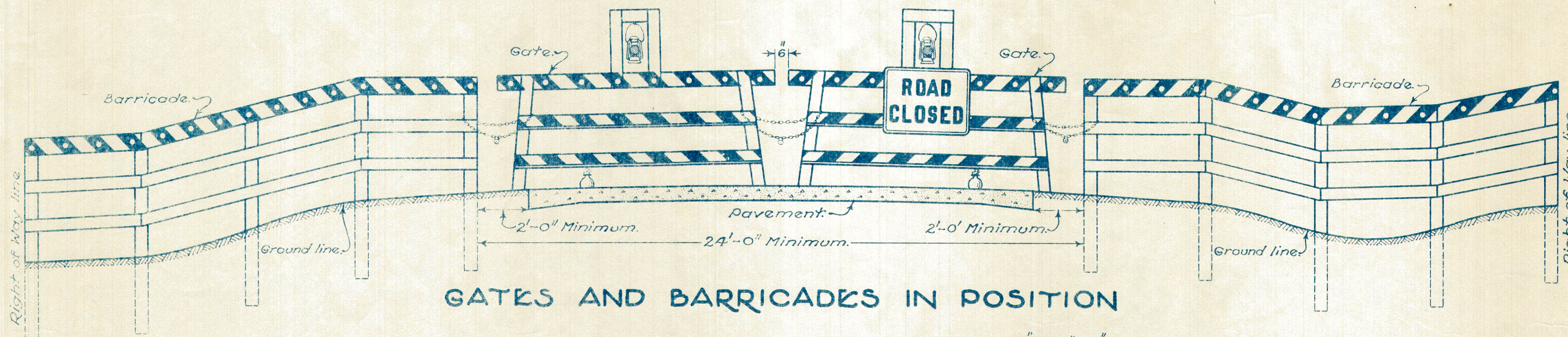

GATES AND BARRICADES IN POSITION

NOTES

LUMBER used in the construction of the gates and barricades shall be No. 1 common yellow pine or No. 1 common Douglas Fir, surfaced on four sides standard, in accordance with the requirements of the Specifications.

GATES:-The movable gates shall be constructed according to the details shown and shall be painted with alternate 6" black and white stripes on a 45° angle. One gate shall be erected for each traffic lane. The gates shall be well spiked, using spikes long enough to clinch.

BARRICADES shall be constructed according to the details shown. The top rail shall be painted on both sides with alternate 6" black and white stripes on a 45° angle sloping toward the roadway. The two lower rails and posts shall be painted white on both sides.

The barricades shall have an opening of a minimum width of 24 feet. For pavement widths greater than 20 feet, the minimum widths of the barricade openings shall be the pavement width plus 4 feet. The barricades shall remain in place following the re-opening of the road if better other work is not completed.

POSTS shall be 6" x 6" sawed or round posts and shall conform to the Specifications for Guard Rail Posts.

RAILS of the barricade shall be bolted to the posts with $\frac{3}{8}$ " bolts.

CHAINS:-Gates shall be chained and padlocked to one another and to adjacent posts of the barricades. Chains shall be of $\frac{5}{8}$ " stock with welded links.

REFLECTORS:-The top rail of the barricades and movable gates shall be reflectorized with red reflector buttons $\frac{3}{4}$ " minimum diameter, placed in the black stripes. When traffic is maintained, the top rails of the barricades shall be reflectorized on both sides. To install the buttons, drill holes into the top rail slightly less in diameter than that of the reflector housing. The button may be driven into the rail by placing a pipe over the reflector in such a manner that it will rest on the housing.

When traffic is maintained through the construction section, three glass crystal buttons $\frac{3}{4}$ " in diameter shall be mounted as shown on each side of the two posts adjacent to the traveled roadway.

SIGNS:-Upon the erection of the gates and barricades according to the above standards, the Division Traffic Engineer shall furnish ROAD CLOSED sign, size 40" x 30", which shall be mounted on the gate as shown. When three gates are used for closing 3-lane roads, the sign shall be mounted on the middle gate facing traffic approaching the closed section.

Where traffic is maintained a ROAD CONSTRUCTION TRAFFIC MAINTAINED sign, size 40" x 24", will be furnished for mounting on the barricade at the right-hand side of the roadway adjacent to the roadway facing traffic approaching the construction section. An END OF CONSTRUCTION sign, size 40" x 20", shall be mounted on the back of the barricade at the right-hand side of the road facing traffic leaving the construction section.

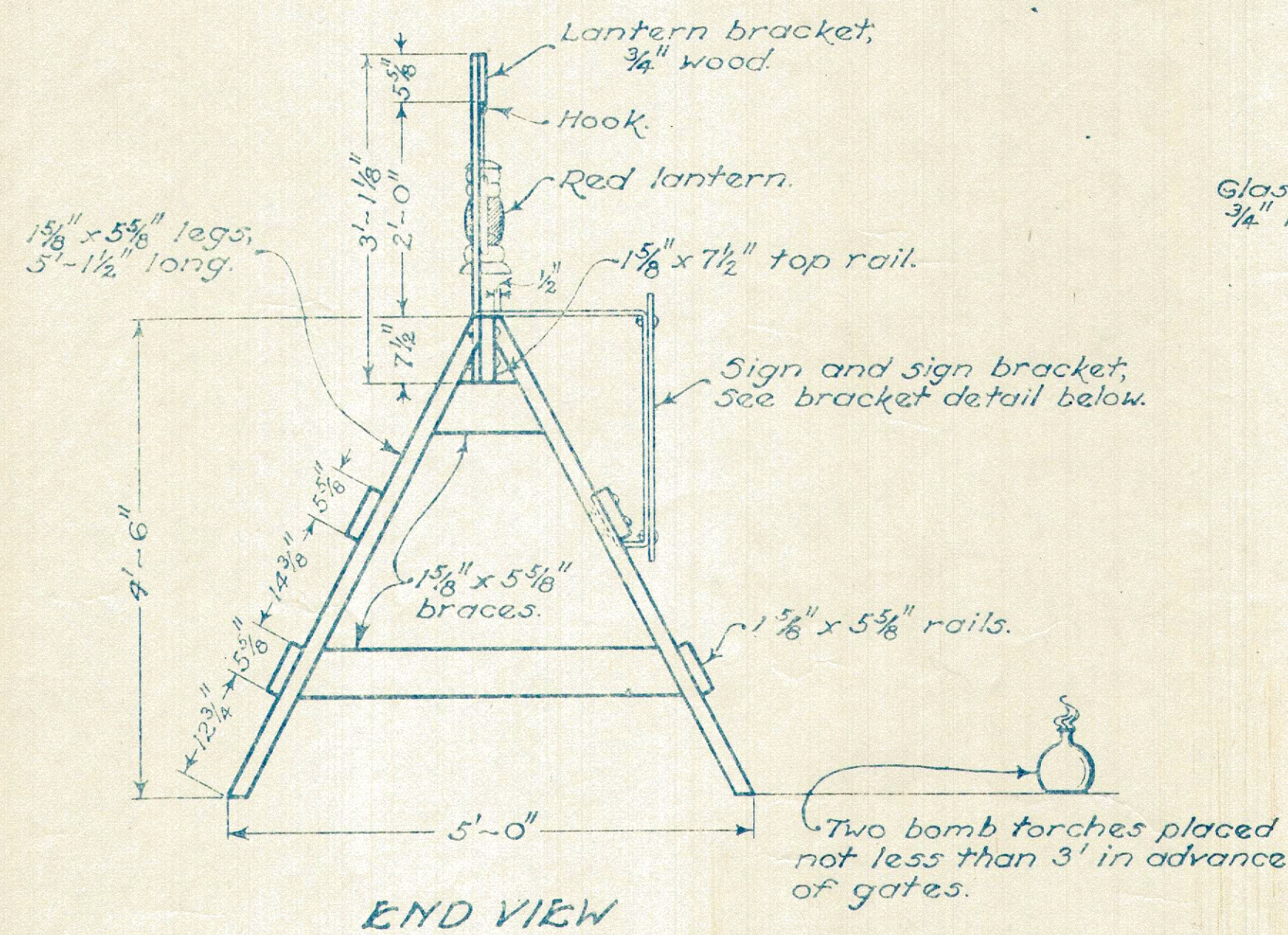

END VIEW

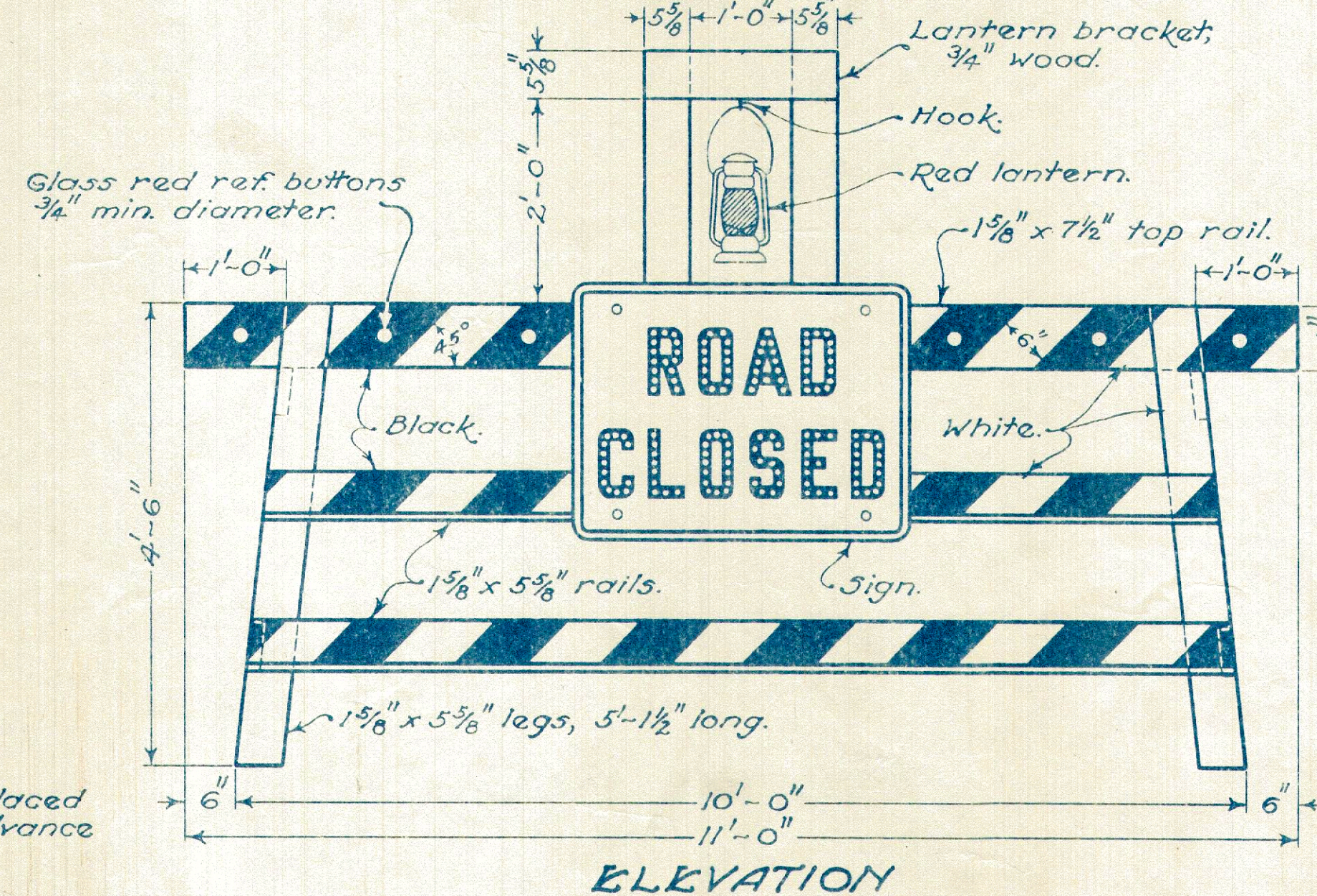

GATE

ELEVATION

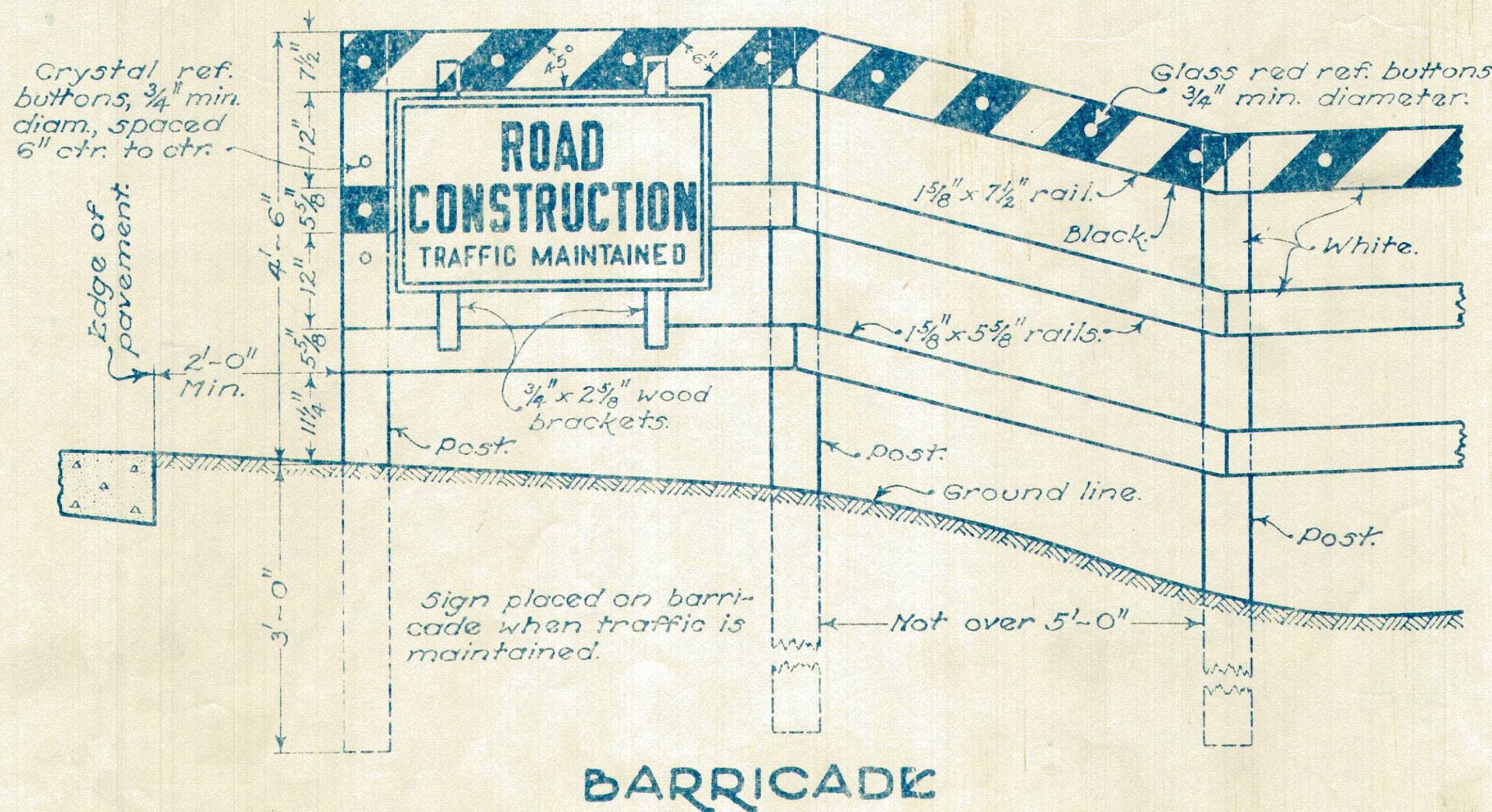

BARRICADE

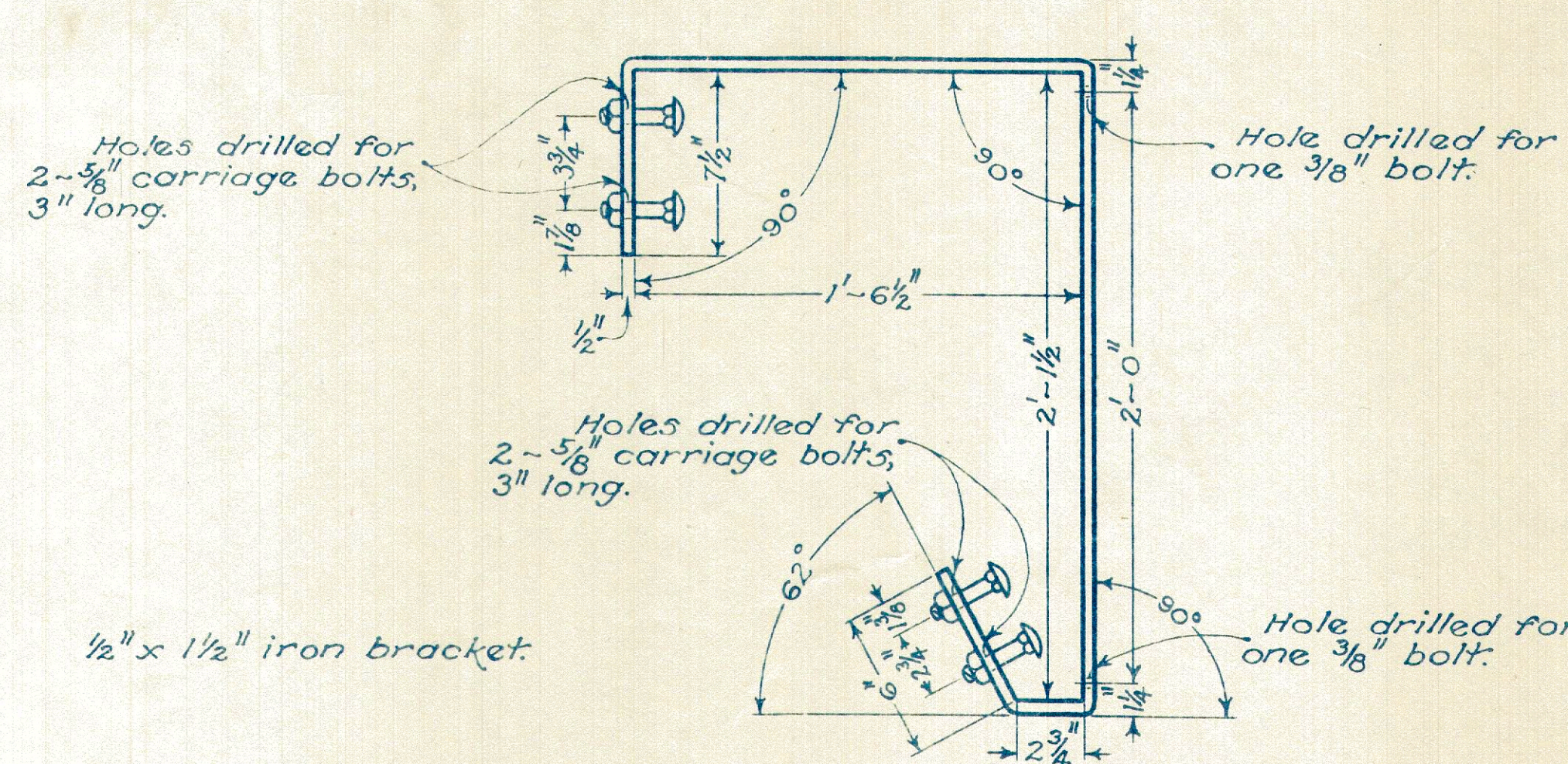

Two brackets spaced 28 inches apart in the center of the gate and bolted to top and center rails.

SIGN BRACKET

BUREAU OF LOCATION AND DESIGN
OHIO DEPARTMENT OF HIGHWAYS

**BARRICADES
AND GATES**

STANDARD
CONSTRUCTION
DRAWING **G-8.07**
APPROVED *g.g.* CHIEF ENGINEER

DATE:
10-19-33
6-1-42
2-1-47