

STATE OF OHIO  
DEPARTMENT OF HIGHWAYS  
**HOL-62-19.94**  
**HOL-76(9.04-9.07-9.27)**  
**HOLMES COUNTY**  
VILLAGE OF MILLERSBURG

FED. RD. DIVISION	STATE	PROJECT	FISCAL YEAR	1 9
2	OHIO		1947	

HOL-62-19.94 (UNIT 1)  
HOL-76(9.04-9.07-9.27) (UNIT 2)

**CONVENTIONAL SIGNS**

COUNTY LINE	-----
TOWNSHIP LINE	-----
SECTION LINE	-----
CORPORATION LINE	-----
PROPERTY LINE	-----
FENCE LINE	-----
CENTER LINE	-----
RAILROADS	-----

**INDEX OF SHEETS**

TITLE PAGE	SHEET 1
TYPICAL SECTIONS	" 2
GENERAL NOTES & SUMMARY OF QUANTITIES	" 3
PLAN & PROFILE	" 4-9

**LINE DATA**

BEGIN PROJECT & UNIT 1	STA. 0+00
END UNIT 1	STA. 17+65
NET LENGTH UNIT 1	1765 Ft. or .334 Mi.
BEGIN UNIT 2	STA. 38+00
END UNIT 2 & PROJECT	STA. 85+41
GROSS LENGTH UNIT 2	4741 Ft.
ADDITIONS (See Sheets NA7&8)	1047 Ft.
NET LENGTH UNIT 2	4845.7 Ft. or .917 Mi.
NET LENGTH PROJECT	6610.7 Ft. or 1.252 Mi.

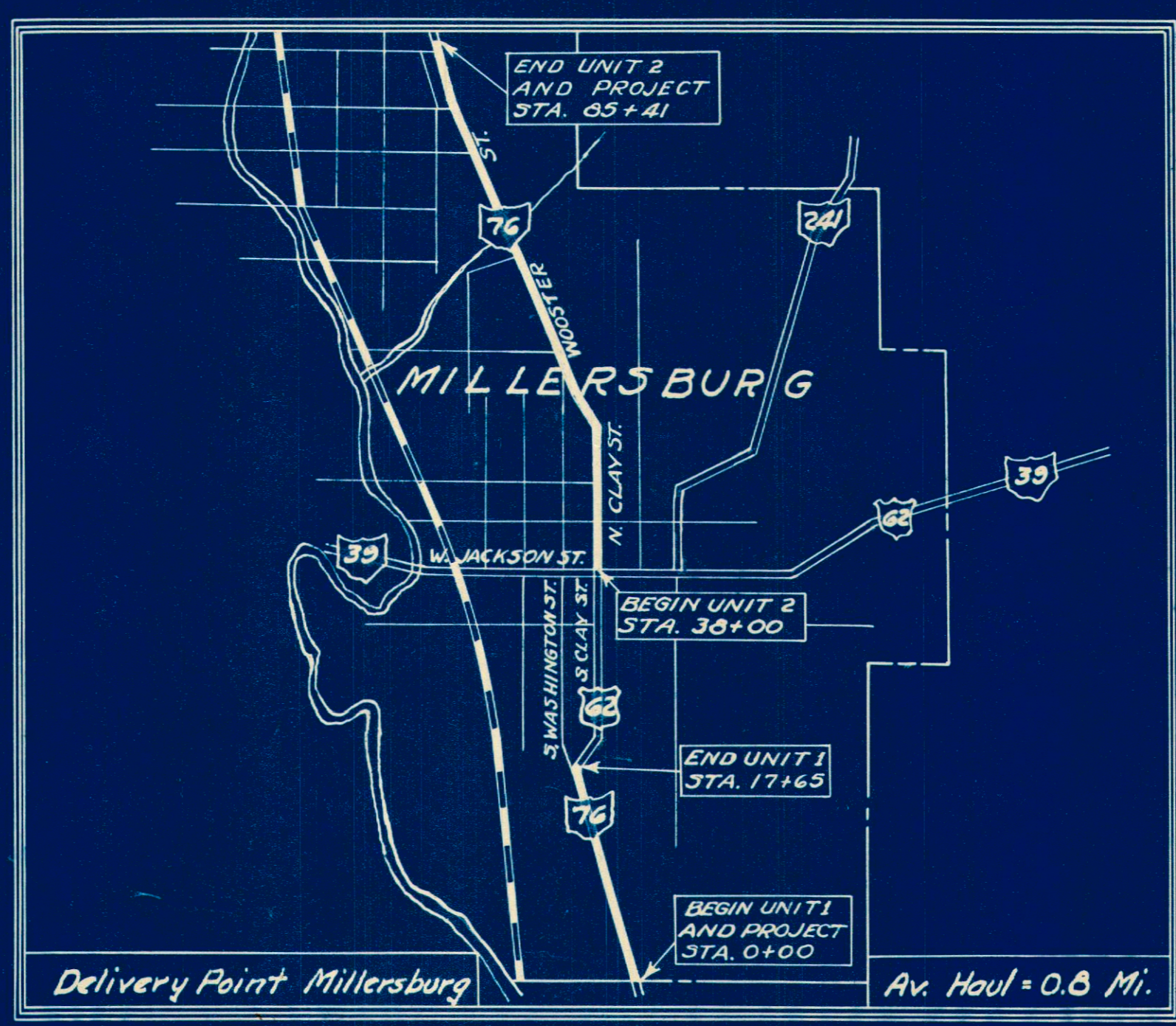
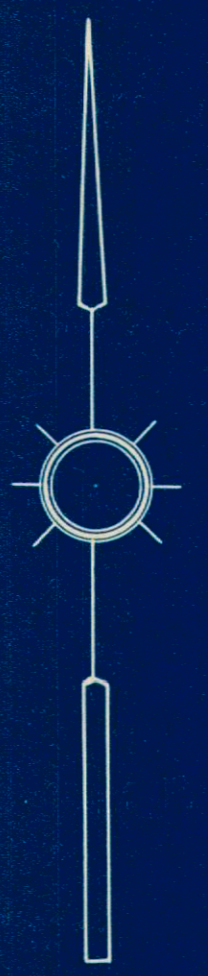

**LOCATION PLAN**  
Scale 1" = 1200'

PORTION TO BE IMPROVED   
FEDERAL HIGHWAYS   
STATE HIGHWAYS   
OTHER ROADS

**SCALES**

PLAN 1" = 100'  
PROFILE-HORIZONTAL 1" = 100'  
PROFILE-VERTICAL 1" = 10'

The Standard Specifications of the State of Ohio, Department of Highways, including changes and supplemental specifications listed in the proposal shall govern this improvement.

I hereby approve these plans and declare that the making of this improvement will not require the closing to traffic of the highway, and that provisions for maintenance and safety of traffic will be as set forth in these plans and estimates.

The right of way for this improvement will be provided by the State of Ohio.

Approved E.R. McCallough  
Date 7-10-47 Acting Resident Deputy Director.

Approved E.R. McCallough  
Date 7-10-47 Division Deputy Director.

Approved \_\_\_\_\_  
Date \_\_\_\_\_ Chief Engineer Bureau of Maintenance.

Approved G. P. Ralston  
Date 7-20-47 Chief Engineer Bureau of Bridges and R.R. Crossings.

Approved George J. Thornmyer  
Date 7-20-47 Chief Engineer Bureau of Location and Design.

Approved \_\_\_\_\_  
Date \_\_\_\_\_ First Ass't. Director & Chief Engineer.

Approved Wesley D. Shaffer  
Date 7-31-47 Director of Highways.

FILE NO	HOL-62-19.94
	HOL-76(9.04-9.07-9.27)
	VILLAGE OF MILLERSBURG
	DATE OF LETTING _____
	CONTRACT NO _____

**STANDARD DRAWINGS**

6-8.07	2-1-47		

**SUPPLEMENTAL SPECIFICATIONS**





# TYPICAL SECTIONS

## TYPE T-35

### SCALE 1/2"=1'-0"

FED. RD. DIVISION	STATE	PROJECT	FISCAL YEAR
2	OHIO		1947

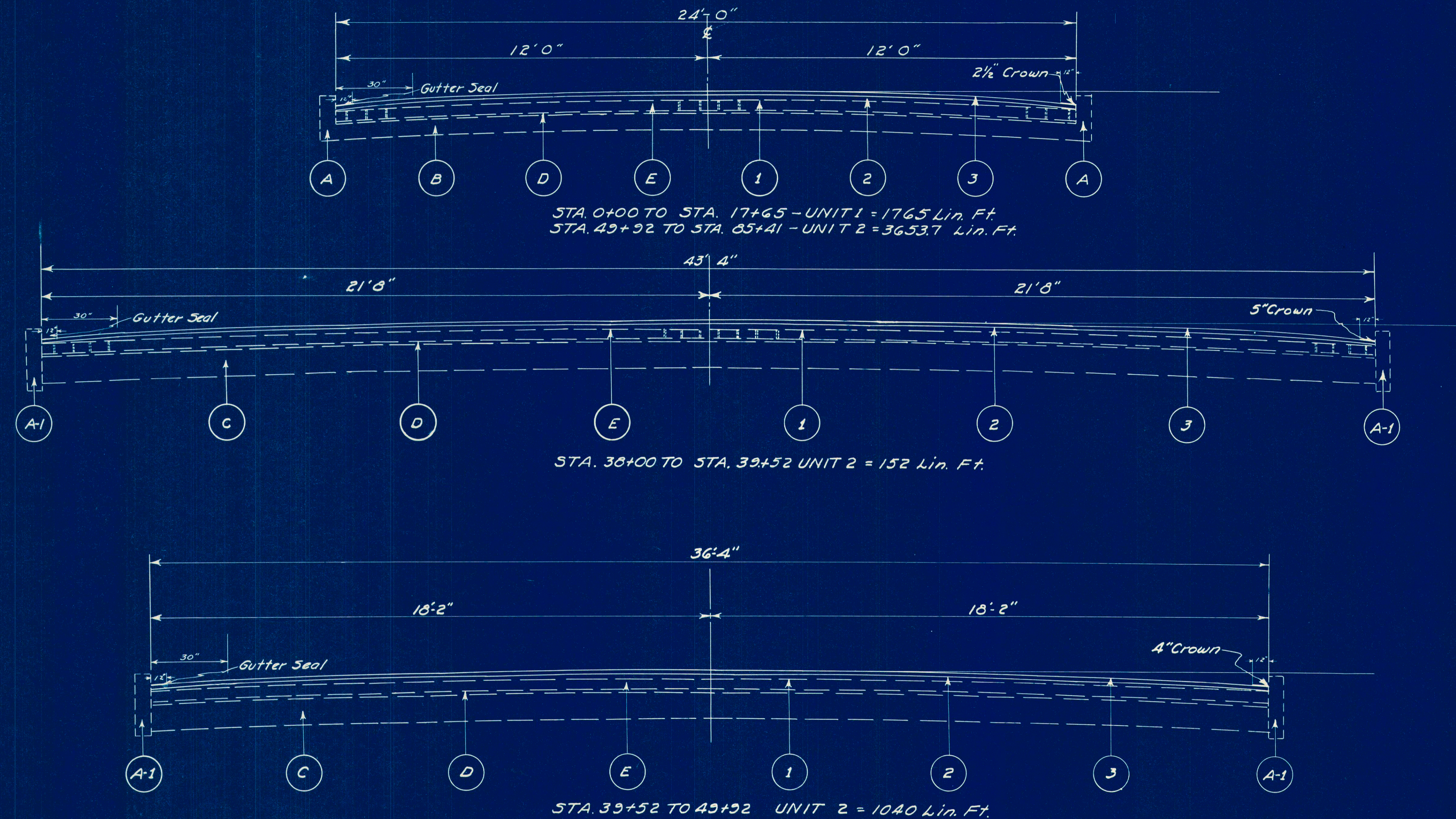
HOL-62-19.94 (UNIT 1)  
HOL-76-(9.04-9.07-927) (UNIT 2)



#### KEY

- (A) EXISTING 6" CONCRETE INTEGRAL CURB.
- (A-1) EXISTING 6" X 24" STONE CURB.
- (B) EXISTING 6" CONCRETE BASE.
- (C) EXISTING 10" SLAG BASE.
- (D) EXISTING 1" SAND CUSHION
- (E) EXISTING 4" BRICK.
- (1) T-30 TACK COAT AT 0.10 GAL. PER. SQ. YD.
- (2) B-35 1 1/2" MIN. ASPHALTIC CONCRETE LEVELING COURSE.
- (3) T-35 1" ASPHALTIC CONCRETE SURFACE COURSE (TYPE C)



# DETAILS, NOTES, & SUMMARY OF QUANTITIES

## PAVEMENT CALCULATIONS

Net Length Unit 1 1765 Ft. or .334 Mi.  
 Unit 1  $1765 \times 24 \div 9 = 4706.665$  Sq. Yds.  
 Extra Pavement (See Plan Sheets) 247,005 Sq. Yds.  
 Total Area Unit 1 4953.665 Sq. Yds.  
 Net Length Unit 2 4845.7 Ft. or .917 Miles  
 Unit 2  $3653.7 \times 24 \div 9 = 9743.2$  Sq. Yds.  
 $152 \times 43.33 \div 9 = 731.85$  Sq. Yds.  
 $1040 \times 36.33 \div 9 = 4198.15$  Sq. Yds.  
 Extra Pavement (See Line Sheets) 882.05 Sq. Yds.  
 Total Area Unit 2 15,555.15 Sq. Yds.

**T-30 TACK COAT**  
 Unit 1  $4953.66 \times 0.10 = 496$  Gal.  
 Unit 2  $15,555.1 \times 0.10 = 1556$  Gal.

**B-35 LEVELING COURSE**  
 Unit 1 -  $1765 - 50$  (See Sheet A) -  $1715 \times 24 \div 9 = 4573 + 247 = 4820$  Sq. Yds.  
 $4820 \times 1.25 \div 36 = 167 - 17$  (Wedge Course in Gutter) 150 Cu. Yds.  
 Extra Leveling (Estimated) 40 Cu. Yds.  
 Total B-35 Unit 1 190 Cu. Yds.  
 Unit 2 -  $15,555.1 \times 1.25 \div 36 = 540 - 47$  (Wedge Course in Gutter) 493 Cu. Yds.  
 Extra Leveling (Estimated) 125 Cu. Yds.  
 Total B-35 Unit 2 618 Cu. Yds.

**T-35 SURFACE COURSE**  
 Unit 1  $4953.66 \times 1 \div 36 = 138$  Cu. Yds.  
 Unit 2  $15,555.1 \times 1 \div 36 = 432$  Cu. Yds.

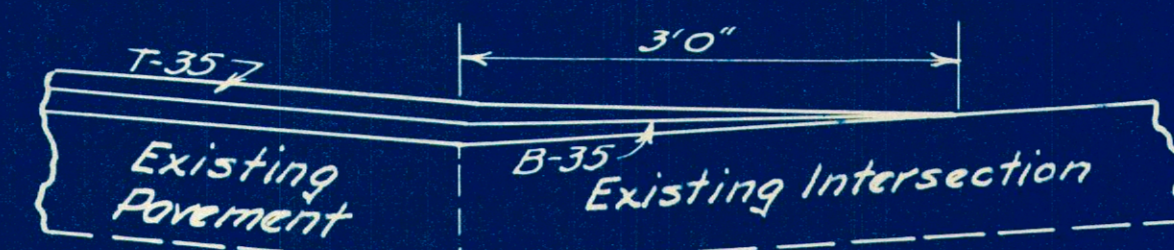

FEATHERING DETAIL AT INTERSECTIONS

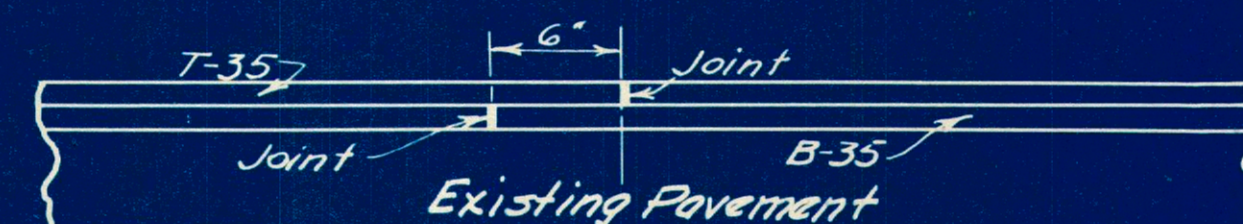

METHOD OF LAPPING LONGITUDINAL JOINTS

## ~ GENERAL NOTES ~

**TRAFFIC:** - Traffic shall be maintained at all times. The length of one way traffic zones shall be kept to a minimum consistent with the requirements of Sec. T-35.23. The item of "Maintaining Traffic" shall include furnishing lights, all signs, Barricades and watchmen according to requirements of Sec. G-8.07, Barricades, Danger and Warning Signs to secure the flow of Traffic Twenty four (24) hours daily.

**PROFILE:** - The profile of the proposed surface course shall be approximately  $\frac{1}{4}$  inches above that of the existing pavement.

**FILLING MAJOR DEPRESSIONS:** - Major depressions in existing pavement shall be filled and compacted with bituminous concrete leveling material in advance of placing of the surface course. These depressions shall be filled in layers not to exceed 3 inches in depth when compacted.

**EXTRA LEVELING MATERIAL:** - The Asphaltic concrete leveling course thickness shall be maintained by the use of extra leveling material where necessary.

**GUTTER RESURFACING:** - Special care shall be exercised during construction to obtain Maximum compaction of Bituminous concrete in all gutters.

## SUMMARY OF QUANTITIES

ITEM	QUANTITY		TOTAL	UNIT	DESCRIPTION
	UNIT 1	UNIT 2			
T-30	496	1556	2052	Gals.	Bituminous Tack Coat, Sec. M-5.5 M5-1
B-35	190	618	808	Cu. Yds.	Asphaltic Concrete Leveling Course.
T-35	138	432	570	Cu. Yds.	Asphaltic Concrete Surface Course, Type "C"
	Lump	Lump	Lump	Lump	Maintaining Traffic, including Lights, Signs, Barricades and Watchmen, twenty-four hours daily.



HOL-62-1934 (UNIT 1)  
HOL-76(9.04-9.07-927) (UNIT 2)

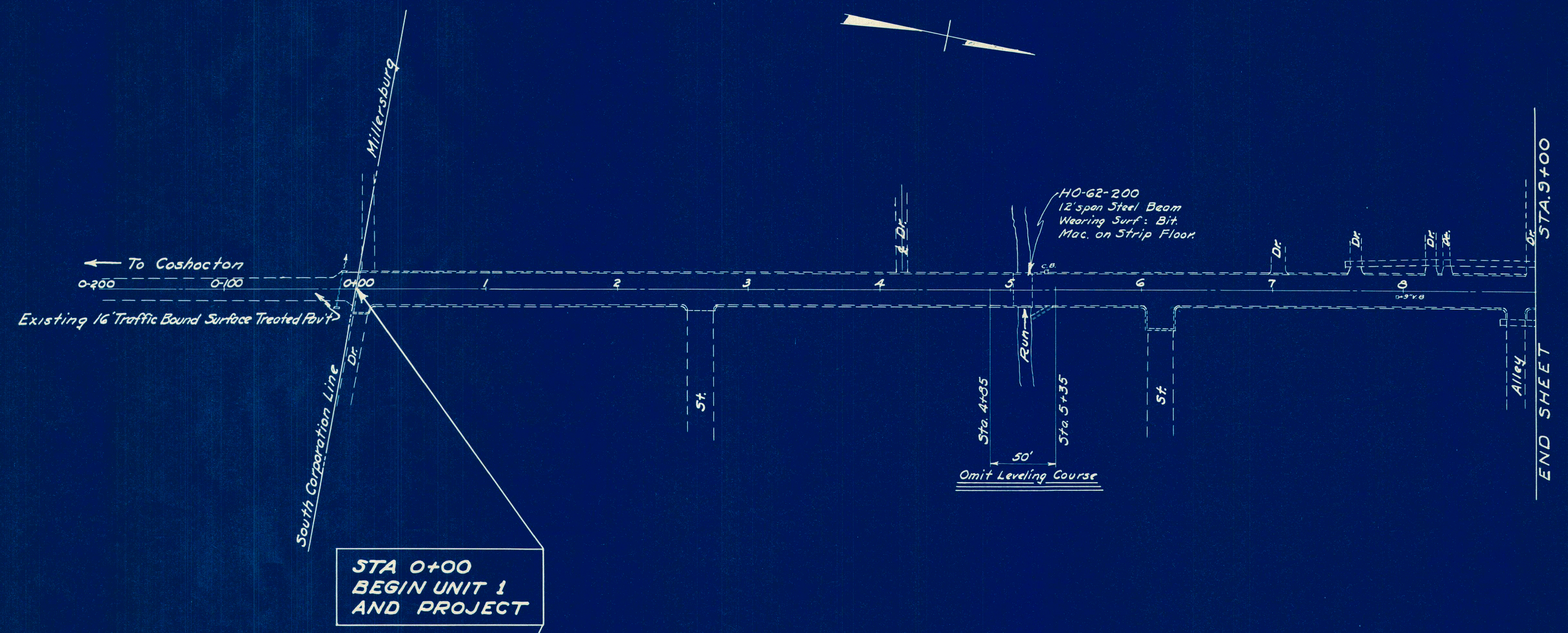

STA 0+00  
BEGIN UNIT 1  
AND PROJECT

EXTRA PAVEMENT		
Station	Side of	Sq. Yds.
0+06	Rt.	4
2+60	Rt.	7
4+12	Rt.	7
7+62	Lt.	4
8+20	Lt.	4
8+32	Lt.	4
8+96	Lt.	4
Total		34

+ In center of East H.W. of Culvert. Rt Sta. 0-17  
B.M. Elev 823.65

U.S.G.S. B.M. (U31X-1934)  
18' West of S.W. cor. County Jail  
Elev. 829.69

□ On 1st step at curb  
Rt. Sta. 7+62  
B.M. Elev. 831.39

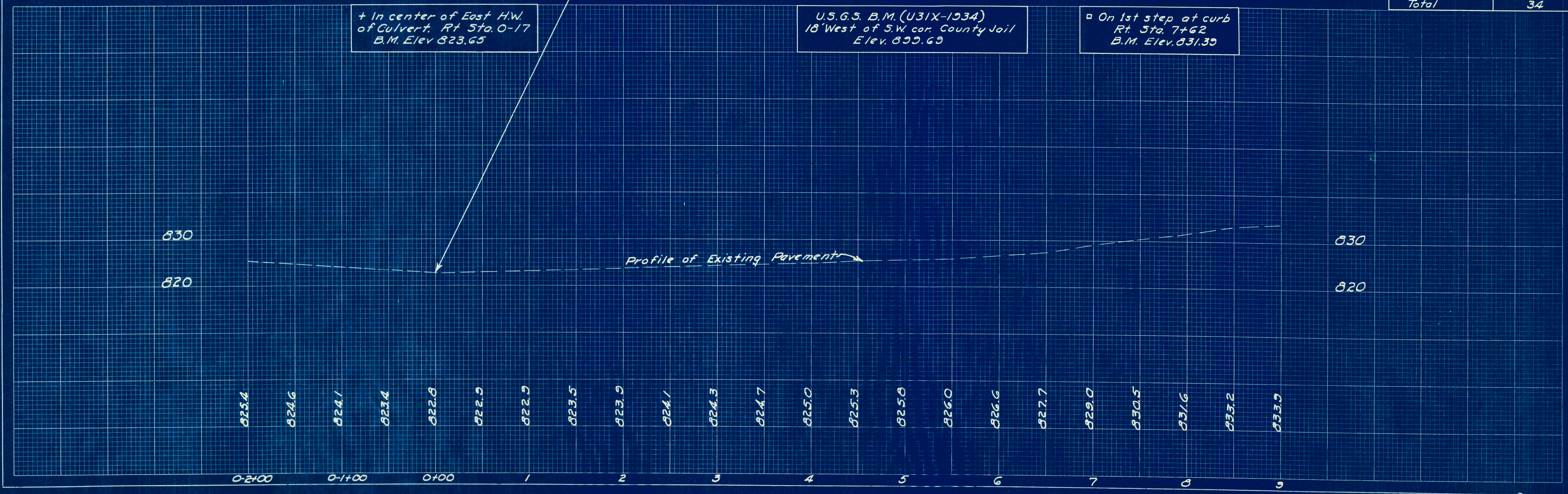



HOL-62-19.94 (UNIT 1)  
HOL-76(304-307-327)(UNIT 2)

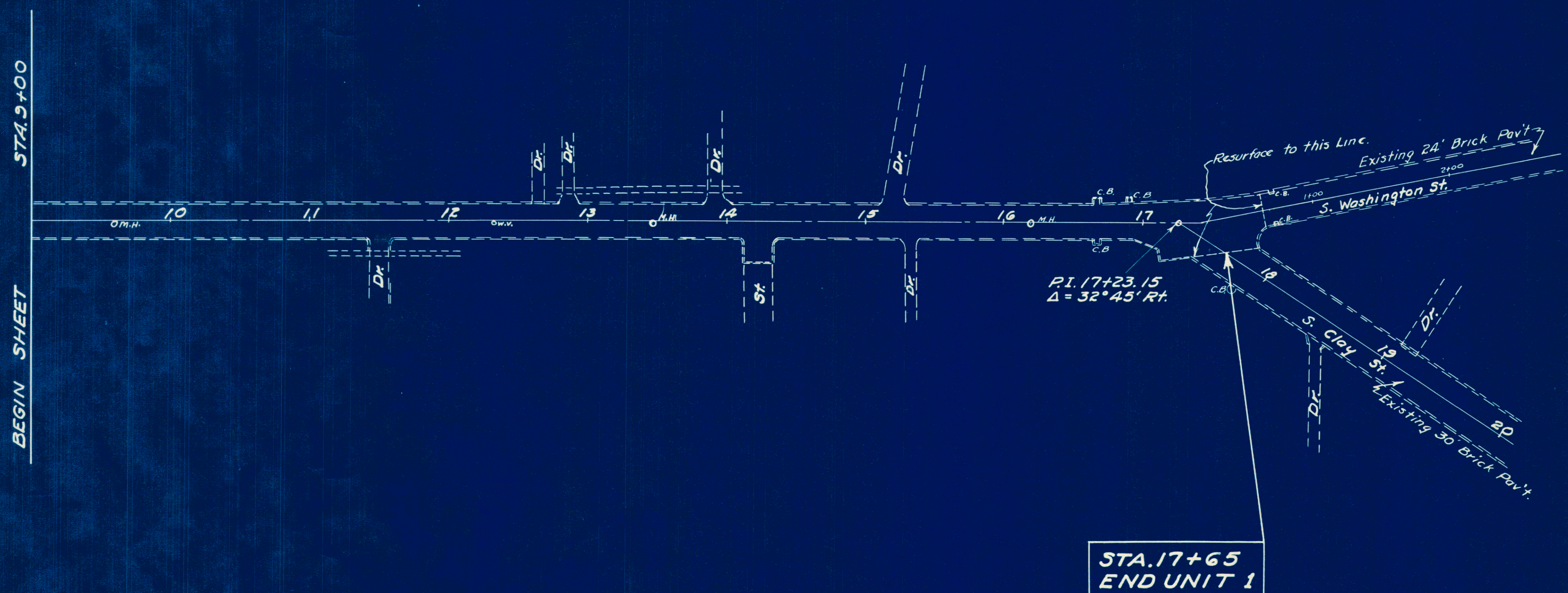

EXTRA PAVEMENT		
Station	Side &	Sq. Yds.
12+85	Lt.	5
13+92	Lt.	7
14+20	Rt.	7
15+16	Lt.	5
15+31	Rt.	4
17+23	Rt.	35
17+45	Lt.	150
Total		213

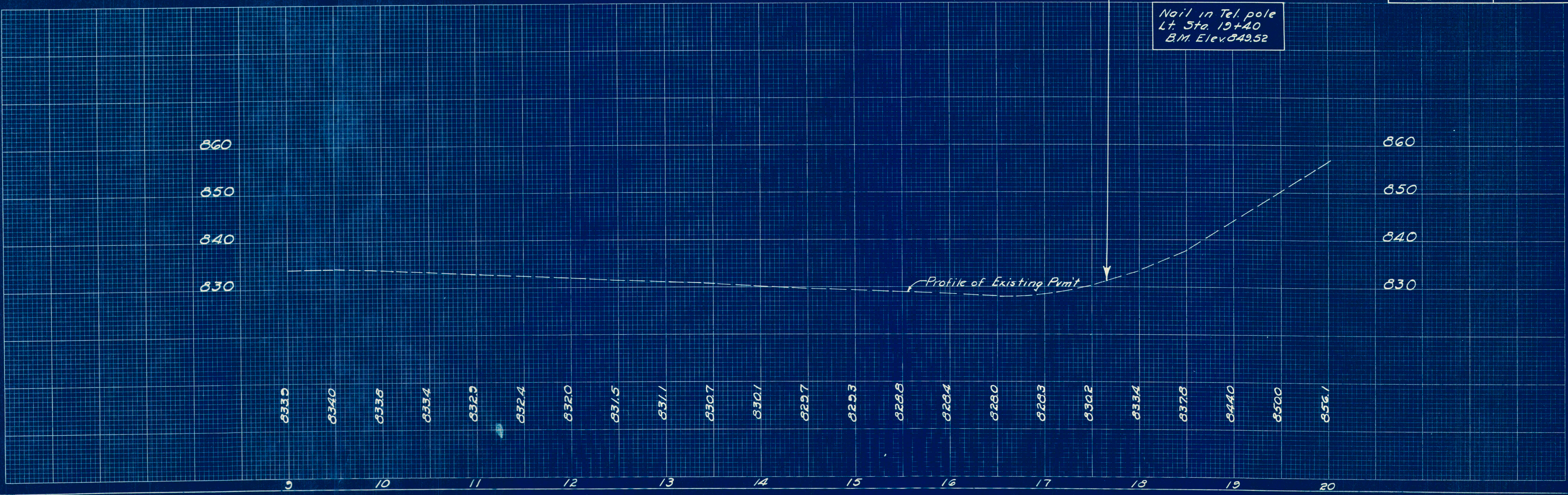



HOL-62-19.94 (UNIT 1)  
HOL-76(304-907-927)(UNIT 2)

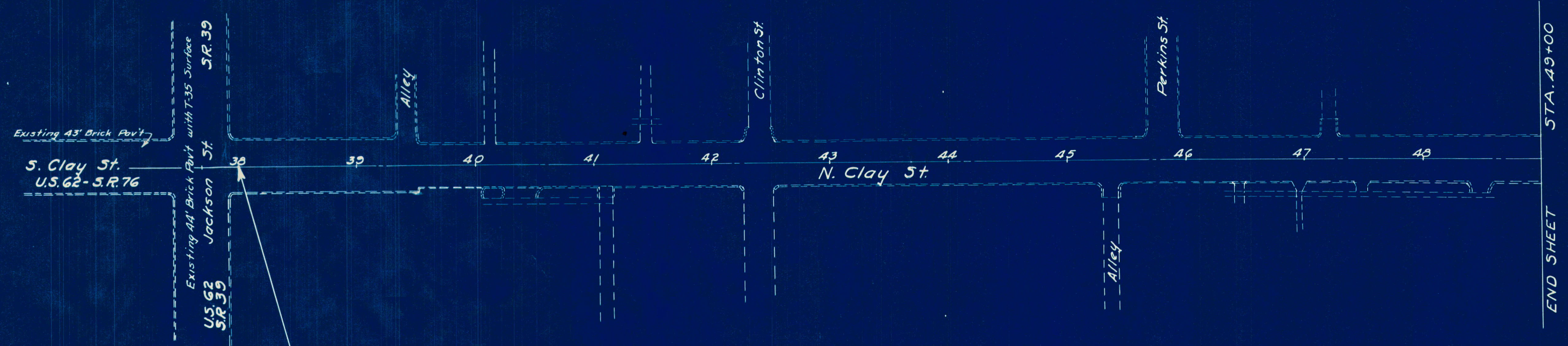

EXTRA PAVEMENT		
Station	Side	Sq. Yds.
39+43	Lt.	6
40+13	Lt.	3
41+46	Lt.	4
42+40	Lt.	9
42+40	Rt.	9
45+32	Rt.	5
45+81	Lt.	10
46+35	Rt.	4
47+21	Lt.	5
47+48	Rt.	5
48+47	Rt.	6
<b>Total</b>		<b>66</b>

STA 38+00  
BEGIN UNIT 2

U.S.G.S. B.M. (U31X-1934)  
18' West of S.W. Cor. County Jail  
Elev. 899.69

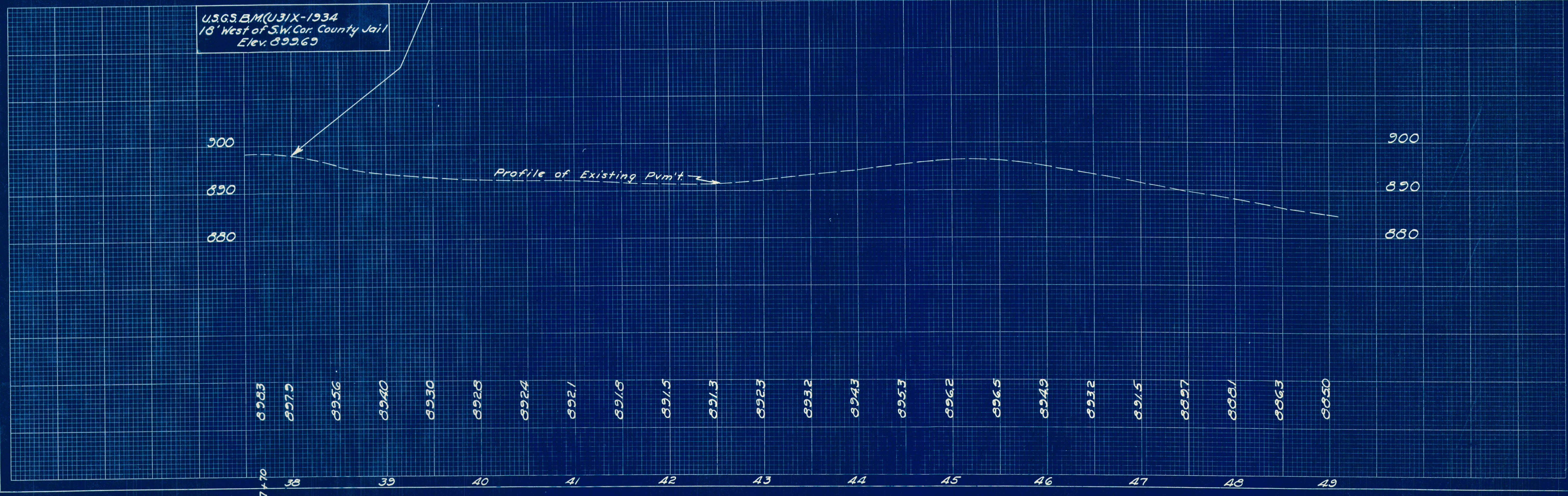



HOL-62-19.94 (UNIT 1)  
HOL-76-(9.04-9.07-9.27)(UNIT 2)

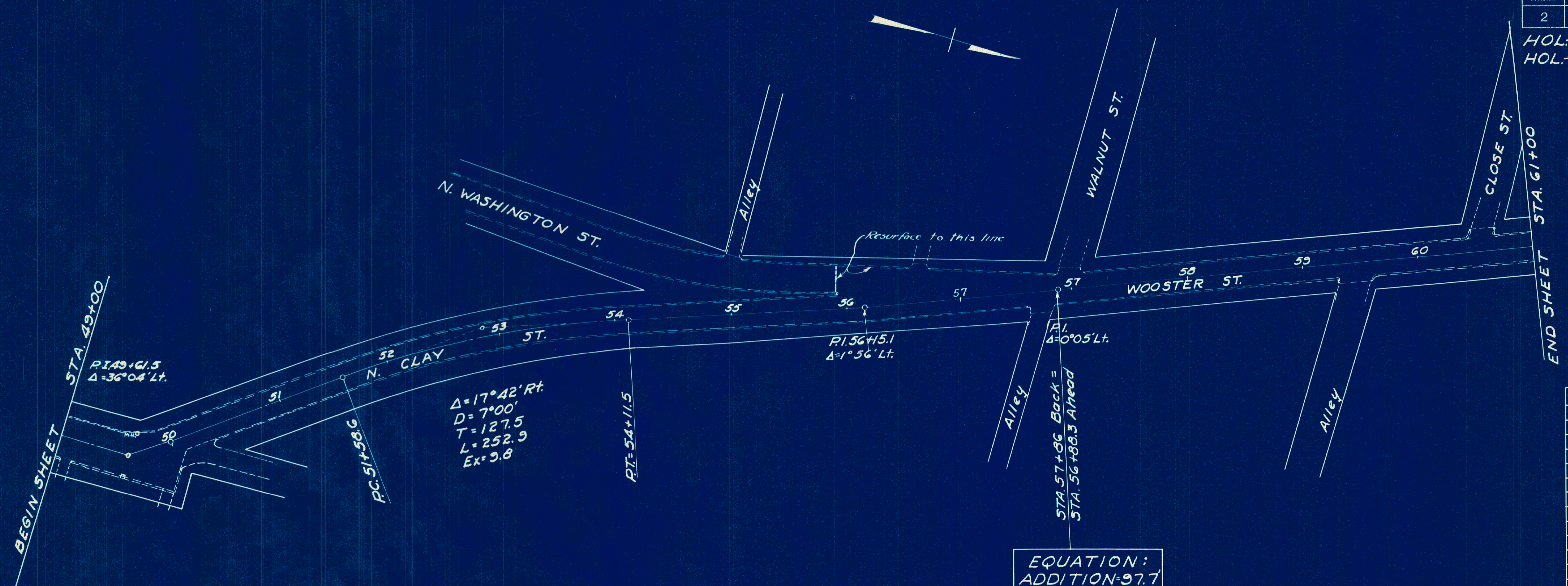

EXTRA PAVEMENT		
Station	Side	Sq. Yds.
49+08	Rt.	4
49+80	Lt.	17
50+00	Rt.	80
50+20	Rt.	15
56+90	Lt.	550
57+70	Rt.	6
57+86	Lt.	8
59+50	Rt.	11
60+50	Lt.	8
Total		699

□ On Stone Curb  
Rt. Sta. 49+61.5  
B.M. Elev. 883.95

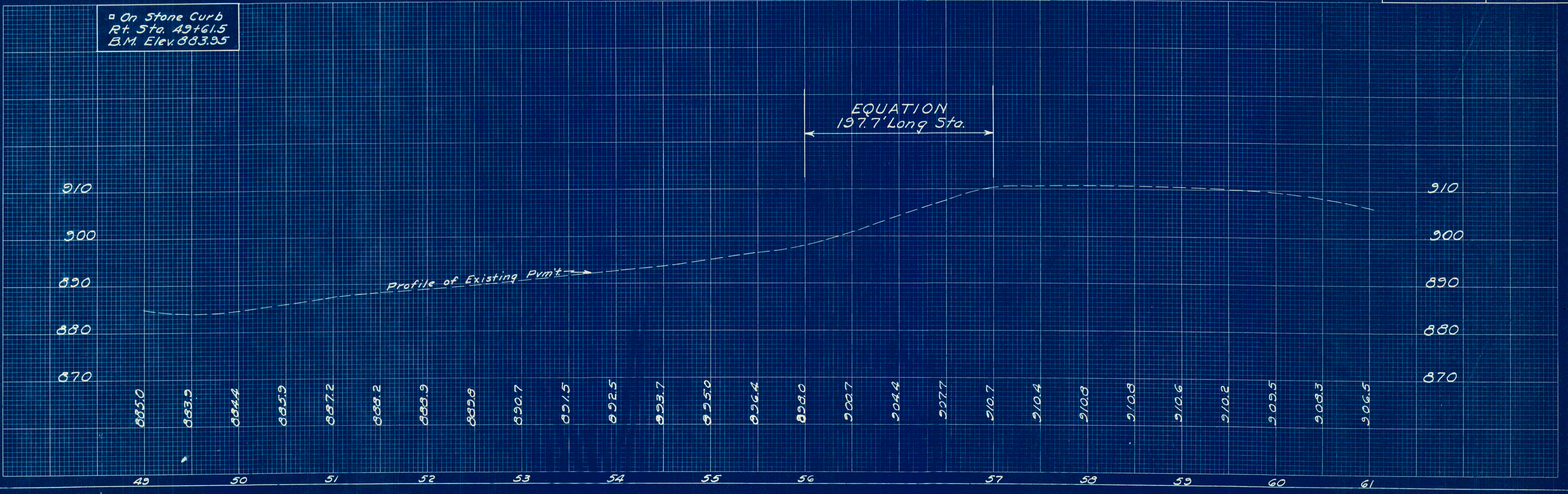



HOL-62-1994 (UNIT 1)  
HOL-76(9.04-9.07-927)(UNIT 2)

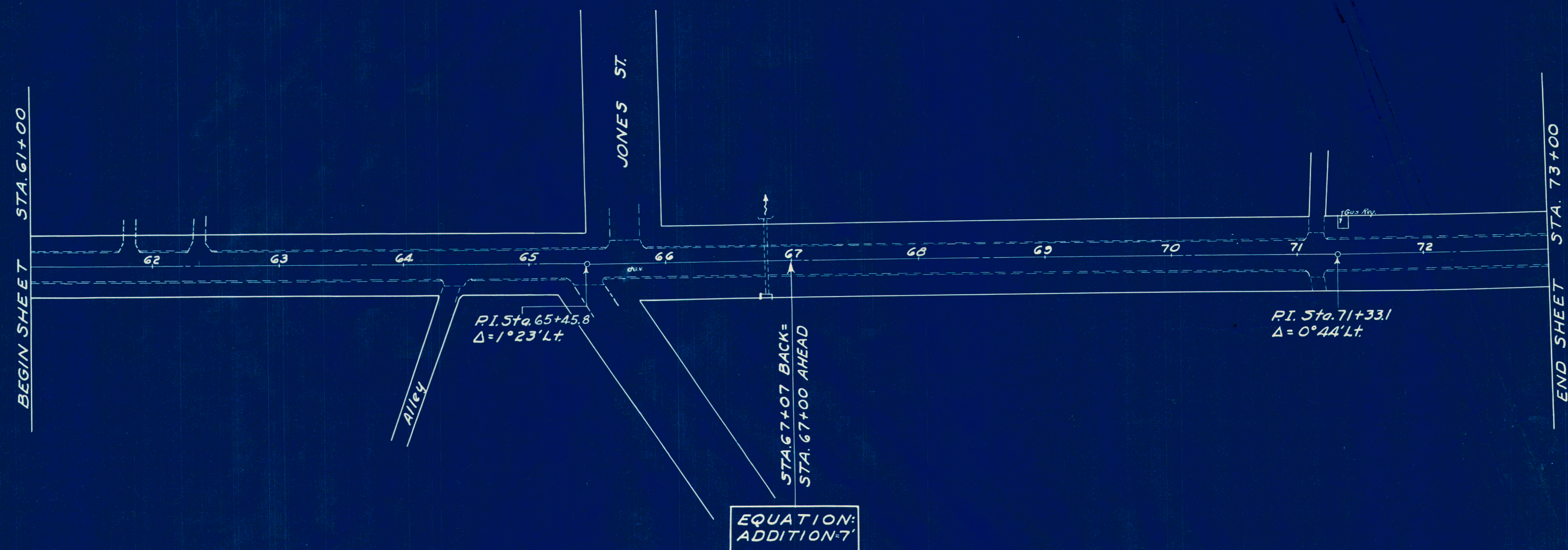

EXTRA PAVEMENT		
Station	Side	Sq. Yds.
61+80	Lt.	6
62+35	Lt.	6
64+45	Rt.	6
65+45	Rt.	8
65+75	Lt.	10
71+15	Rt.	5
71+15	Lt.	5
Total		46

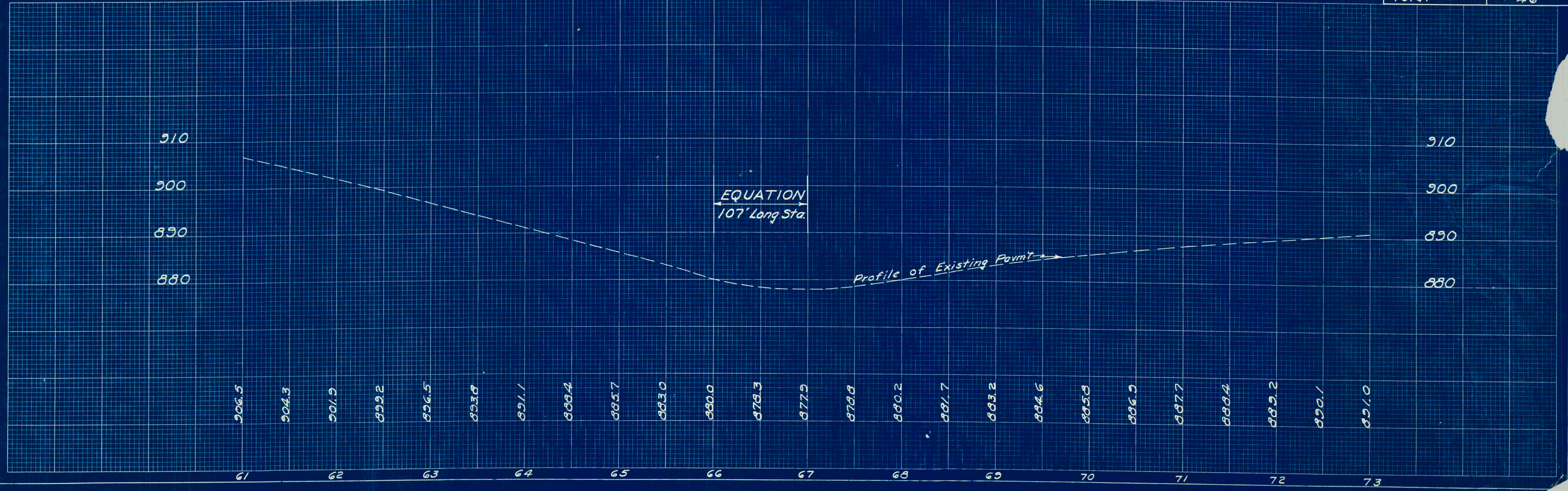



HOL-62-19.94 (UNIT 1)  
HOL-76(304-307-327)(UNIT 2)

EXTRA PAVEMENT		
Station	Side &	Sq. Yds.
74+82	Rt.	5
75+15	Lt.	10
75+15	Rt.	11
78+85	Lt.	10
79+20	Rt.	9
79+75	Lt.	6
80+65	Lt.	5
80+65	Rt.	5
83+65	Lt.	10
Total		71

BEGIN SHEET STA. 73+00

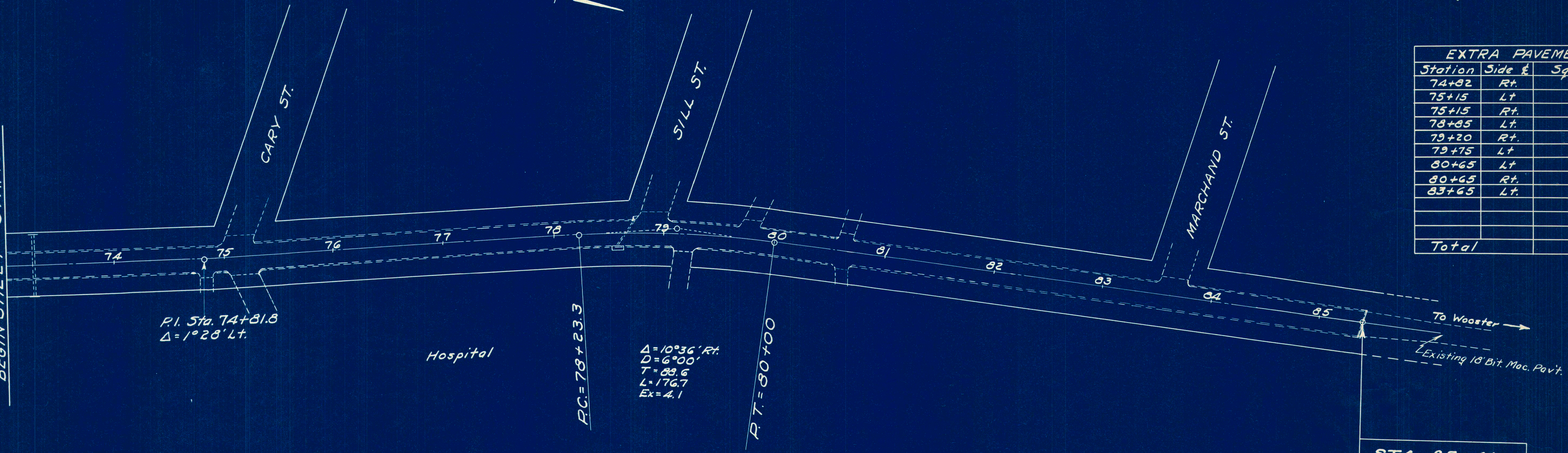

STA. 85+41  
END UNIT 2  
AND PROJECT

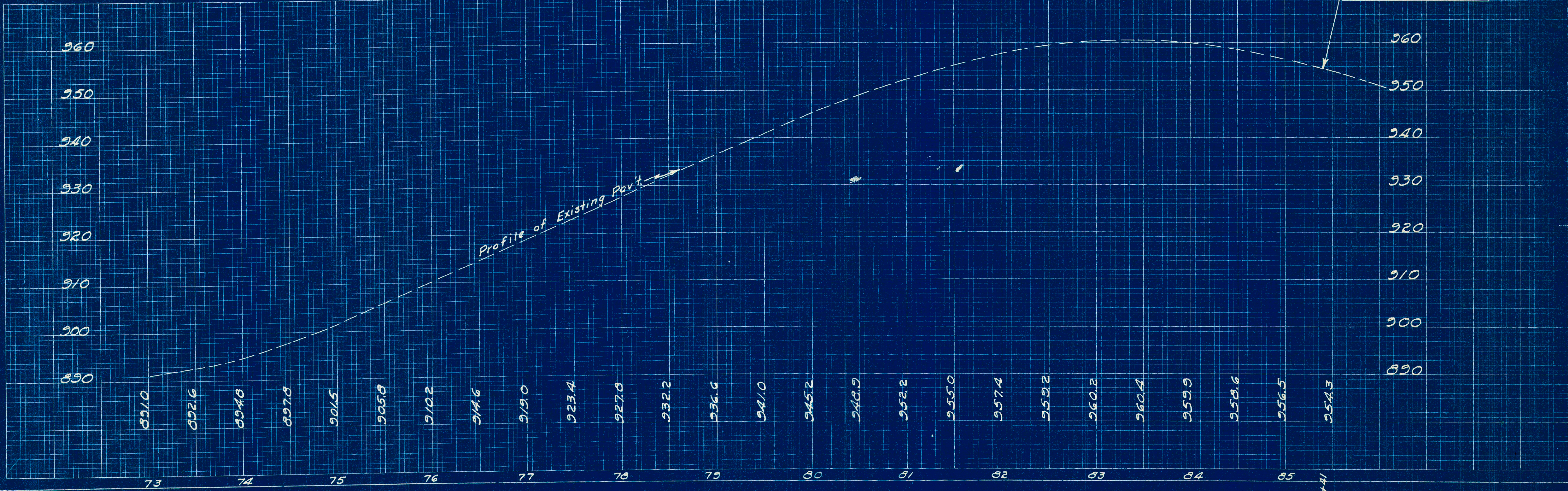

HOL-62-19.94 (UNIT 1) & HOL-76(304-307-327)(UNIT 2)



# STANDARD BARRICADES AND GATES

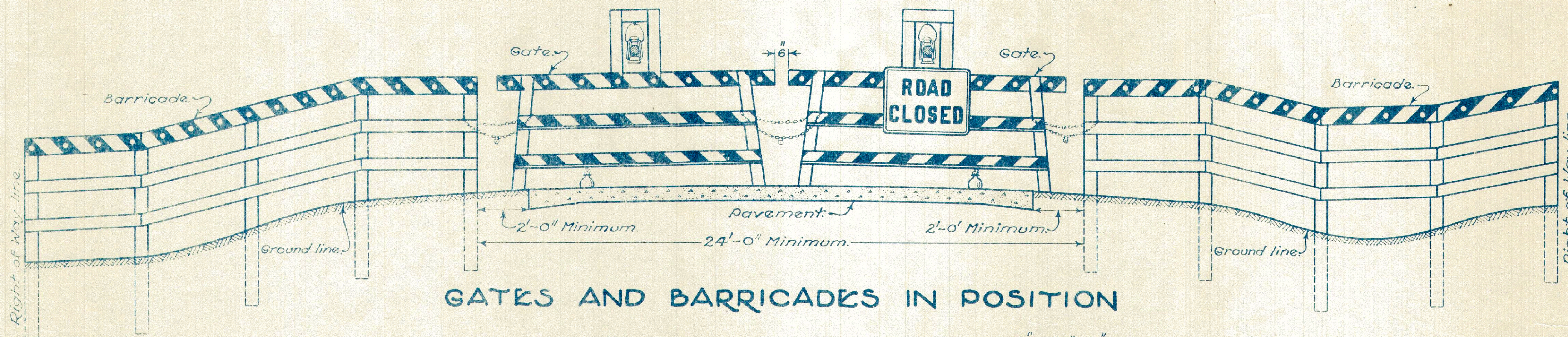

GATES AND BARRICADES IN POSITION

## NOTES

**LUMBER** used in the construction of the gates and barricades shall be No. 1 common yellow pine or No. 1 common Douglas Fir, surfaced on four sides standard, in accordance with the requirements of the Specifications.

**GATES**:-The movable gates shall be constructed according to the details shown and shall be painted with alternate 6" black and white stripes on a 45° angle. One gate shall be erected for each traffic lane. The gates shall be well spiked, using spikes long enough to clinch.

**BARRICADES** shall be constructed according to the details shown. The top rail shall be painted on both sides with alternate 6" black and white stripes on a 45° angle sloping toward the roadway. The two lower rails and posts shall be painted white on both sides.

The barricades shall have an opening of a minimum width of 24 feet. For pavement widths greater than 20 feet, the minimum widths of the barricade openings shall be the pavement width plus 4 feet. The barricades shall remain in place following the re-opening of the road if better other work is not completed.

**POSTS** shall be 6" x 6" sawed or round posts and shall conform to the Specifications for Guard Rail Posts.

**RAILS** of the barricade shall be bolted to the posts with 3/8" bolts.

**CHAINS**:-Gates shall be chained and padlocked to one another and to adjacent posts of the barricades. Chains shall be of 5/8" stock with welded links.

**REFLECTORS**:-The top rail of the barricades and movable gates shall be reflectorized with red reflector buttons 3/4" minimum diameter, placed in the black stripes. When traffic is maintained, the top rails of the barricades shall be reflectorized on both sides. To install the buttons, drill holes into the top rail slightly less in diameter than that of the reflector housing. The button may be driven into the rail by placing a pipe over the reflector in such a manner that it will rest on the housing.

When traffic is maintained through the construction section, three glass crystal buttons 3/4" in diameter shall be mounted as shown on each side of the two posts adjacent to the traveled roadway.

**SIGNS**:-Upon the erection of the gates and barricades according to the above standards, the Division Traffic Engineer shall furnish ROAD CLOSED sign, size 40" x 30", which shall be mounted on the gate as shown. When three gates are used for closing 3-lane roads, the sign shall be mounted on the middle gate facing traffic approaching the closed section.

Where traffic is maintained a ROAD CONSTRUCTION TRAFFIC MAINTAINED sign, size 40" x 24", will be furnished for mounting on the barricade at the right-hand side of the roadway adjacent to the roadway facing traffic approaching the construction section. An END OF CONSTRUCTION sign, size 40" x 20", shall be mounted on the back of the barricade at the right-hand side of the road facing traffic leaving the construction section.

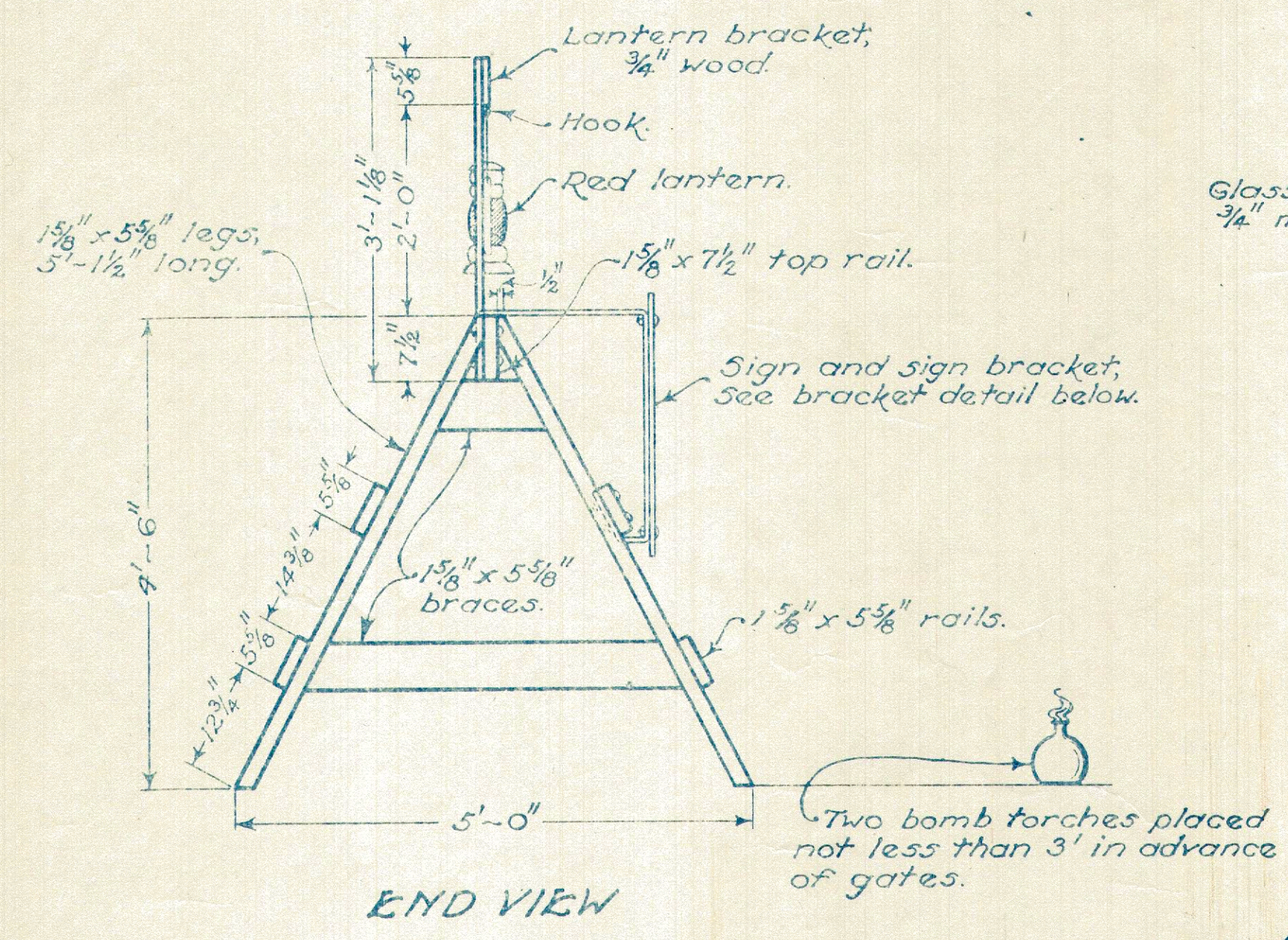

END VIEW

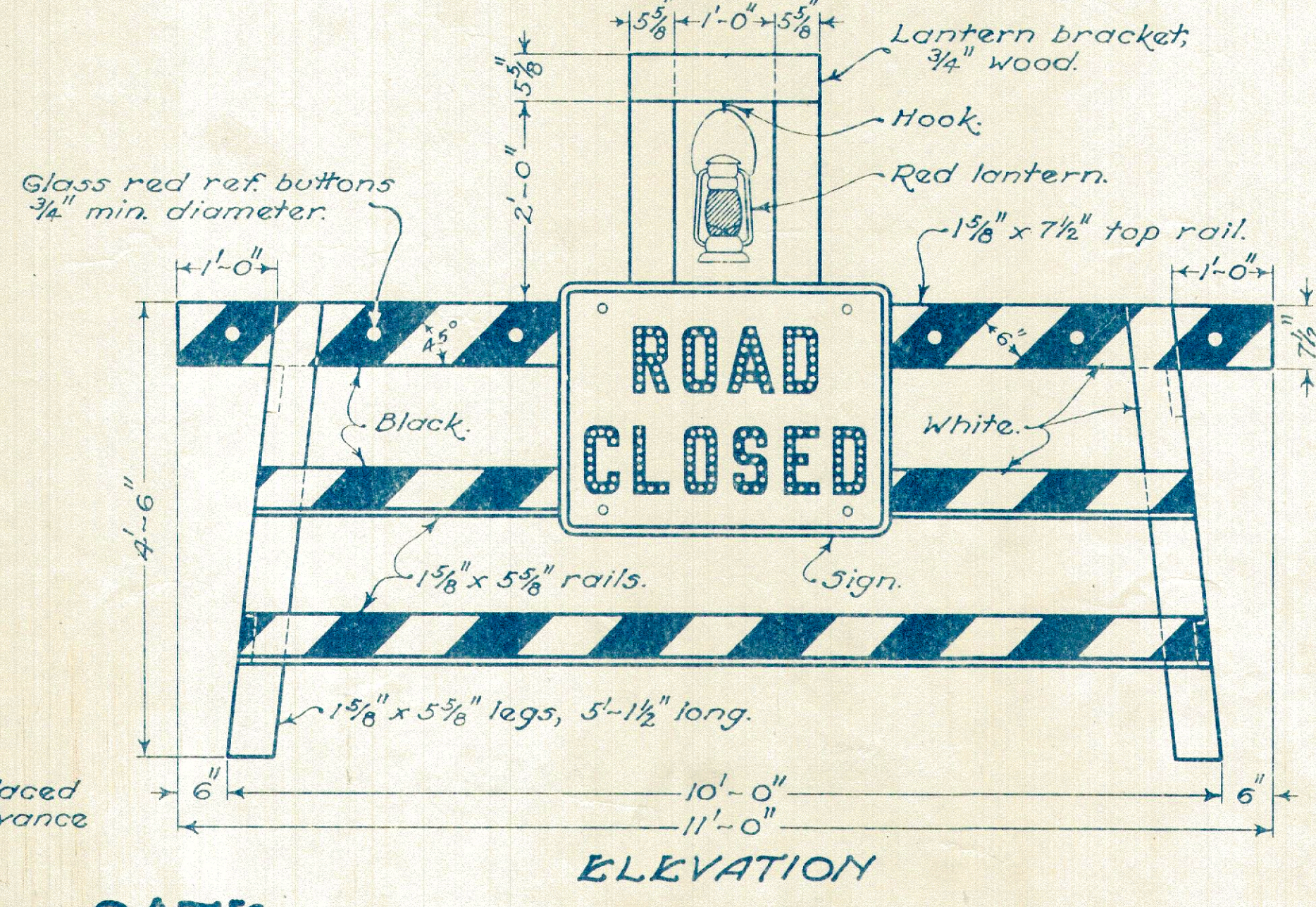

ELEVATION

GATE

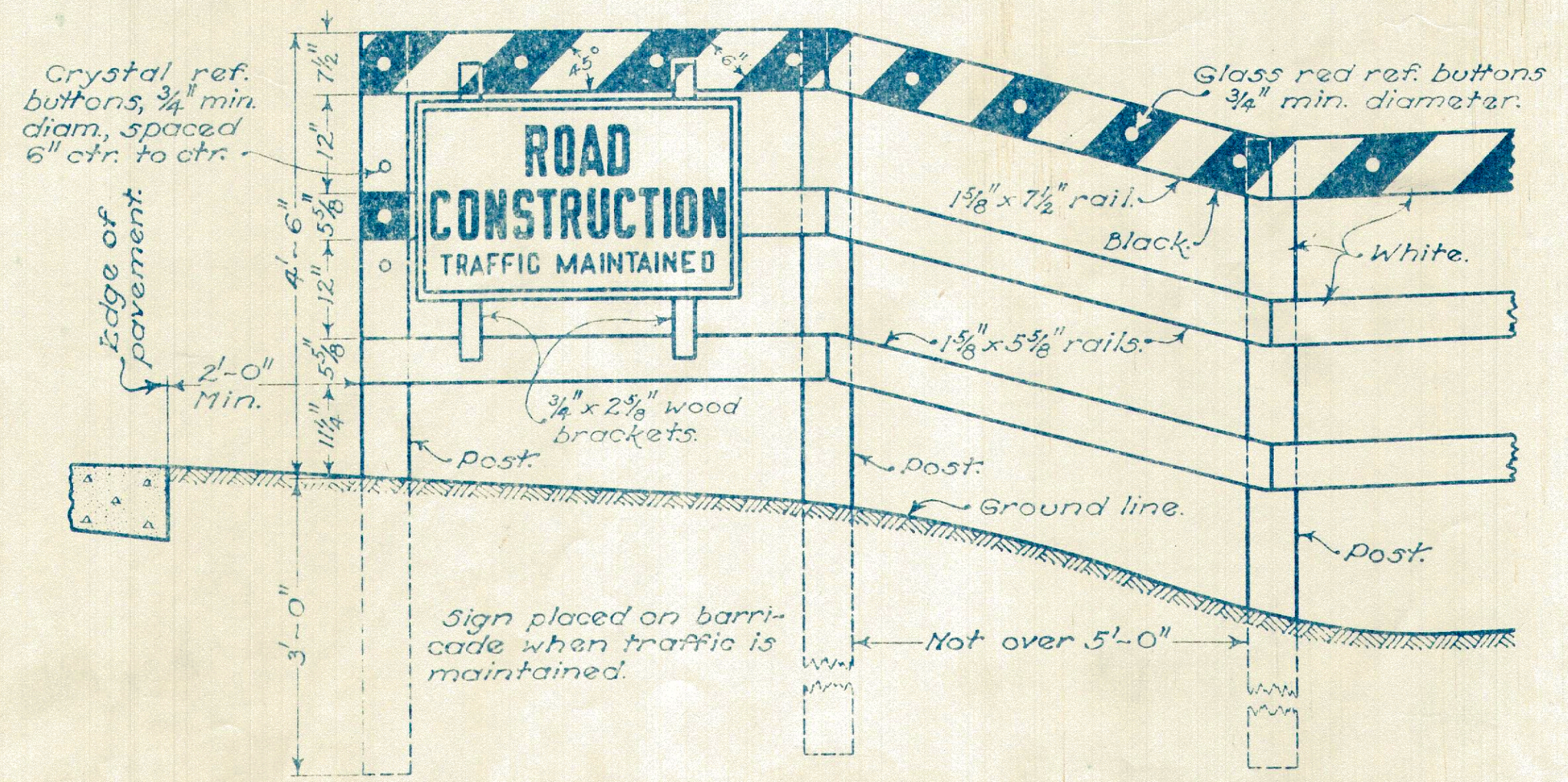

BARRICADE

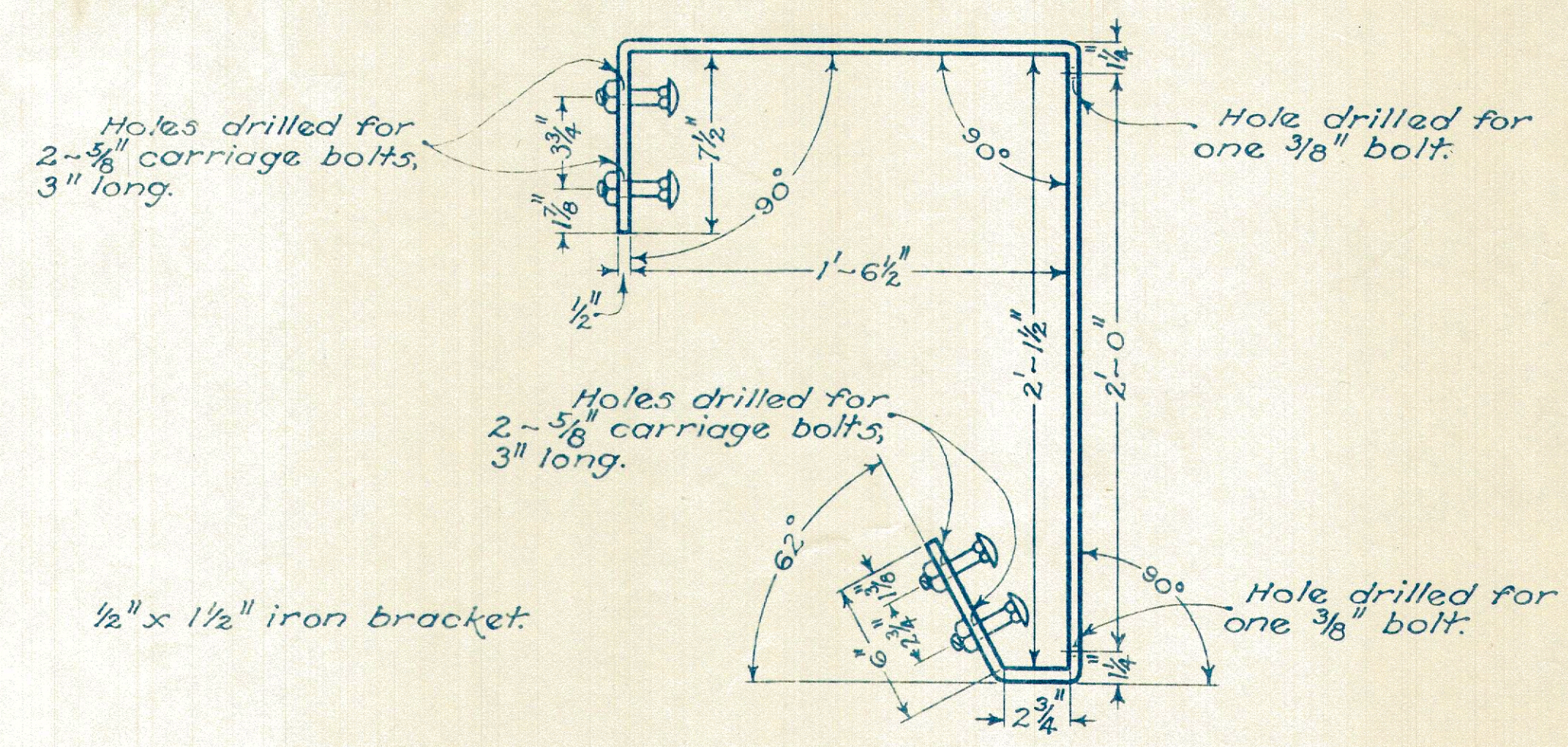

SIGN BRACKET

Two brackets spaced 28 inches apart in the center of the gate and bolted to top and center rails.

BUREAU OF LOCATION AND DESIGN OHIO DEPARTMENT OF HIGHWAYS	
<b>BARRICADES AND GATES</b>	
STANDARD CONSTRUCTION DRAWING	G-8.07
APPROVED <i>g.g.</i>	CHIEF ENGINEER

DATE:  
10-19-33  
6-1-42  
2-1-47