

HOLMES COUNTY  
DEDICATION PLAT OF  
SHREVE-KILLBUCK-SOUTH ROAD  
S.H.(I.C.H.) No. 589

KILLBUCK VILLAGE

HOLMES COUNTY  
WAYNE COUNTY

MONROE TWP  
KILLBUCK TWP  
RIPLEY TWP  
MONROE TWP

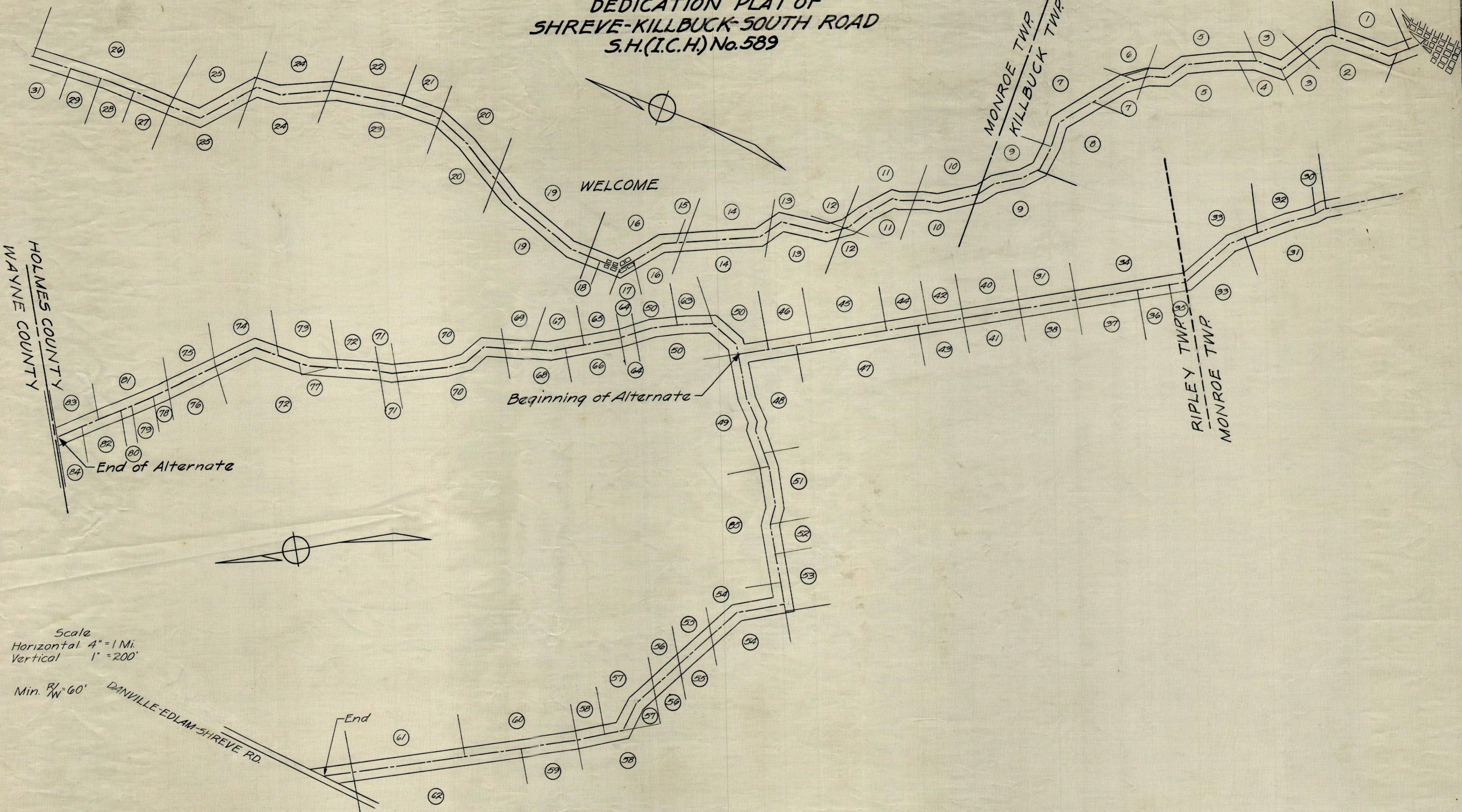

Scale  
Horizontal 4" = 1 Mi.  
Vertical 1" = 200'

Min. 1/4" W 60'

We, the undersigned owners of the above described property, dedicate the same to public use for road and other public purposes consistent therewith clear of all obstructions which interfere with the improvement and/or maintenance of the highway at the time of improvement.

Parcel No.	Owners	Witnesses	Parcel No.	Owners	Witnesses	Parcel No.	Owners	Witnesses
59	Mrs. E. Gasche	E. J. Frey	39	C. B. Martin	E. J. Frey	63	E. L. Corner	E. J. Frey
74	J. E. Gasche	E. J. Frey	39	Nellie Martin	E. J. Frey	63	E. L. Corner	E. J. Frey
1	R. P. Cunningham	E. J. Frey	42	Roscoe Chambers	E. J. Frey	65	P. B. Marshall	E. J. Frey
1	Linda Cunningham	E. J. Frey	41	Myra Chambers	E. J. Frey	65	E. J. Frey	E. J. Frey
2	Jessie M. Purdy	E. J. Frey	40	Clara Chambers	E. J. Frey	72	Frank Dye	E. J. Frey
2	Geo. E. King	E. J. Frey	40	Minnie G. Brown	E. J. Frey	72	Ella Dye	E. J. Frey
3	Ebert L. Shrimplin	E. J. Frey	43	Mary Chambers	E. J. Frey	68	D. A. Kreger	E. J. Frey
5	J. E. Lisle	E. J. Frey	43	Lula Chambers	E. J. Frey	68	Grace Kreger	E. J. Frey
5	Maryanne Lisle	E. J. Frey	44	John Chambers	E. J. Frey	66	Robert White	E. J. Frey
6	L. R. Mumma	E. J. Frey	44	Lulu Chambers	E. J. Frey	66	Bianca White	E. J. Frey
6	Allen M. Mumma	E. J. Frey	45	A. R. King & Wife	E. J. Frey	70	Quincy Spade	E. J. Frey
7	Geo. Rohsopf	E. J. Frey	45	Louanna King	E. J. Frey	70	Ethel Spade	E. J. Frey
7	Bernice Rohsopf	E. J. Frey	46	Irvin Arnold	E. J. Frey	70	Paul M. C. Bell and	E. J. Frey
8	Albert Tidball	E. J. Frey	46	Orpha Arnold	E. J. Frey	77	B. E. McMillan	E. J. Frey
8	Vera Tidball	E. J. Frey	48	Robert Zimmerman	E. J. Frey	71	Ernest Miller	E. J. Frey
9	Robert Reed	E. J. Frey	50	John W. Machel	E. J. Frey	73	J. Swainhart	E. J. Frey
9	Gladys Purdy	E. J. Frey	49	Grace Machel	E. J. Frey	73	John Swainhart	E. J. Frey
10	Clayton Purdy	E. J. Frey	49	Elmer Swires	E. J. Frey	76	Bernice Crawford	E. J. Frey
11	Ora Purdy	E. J. Frey	49	Grace Swires	E. J. Frey	76	George W. Wise	E. J. Frey
15	Amie Bink	E. J. Frey	51	John Swires	E. J. Frey	78	George E. Wise	E. J. Frey
16	W. L. Mann	E. J. Frey	51	Clara Core	E. J. Frey	79	Roy S. Easterday	E. J. Frey
16	Hotie Martin	E. J. Frey	52	A. D. Snyder	E. J. Frey	79	Ethel Spade	E. J. Frey
17	J. E. Conners	E. J. Frey	52	Lula Snyder	E. J. Frey	80	George A. Howell	E. J. Frey
17	Bernice Conners	E. J. Frey	53	L. H. Snyder	E. J. Frey	82	George Hague	E. J. Frey
18	Benny Miller	E. J. Frey	53	D. J. Miller	E. J. Frey	81	Clara Hague	E. J. Frey
19	D. E. Allison	E. J. Frey	54	Mary Swires	E. J. Frey	83	Elizabeth Hague	E. J. Frey
19	Bessie Allison	E. J. Frey	55	Barbara Reed	E. J. Frey	83	Nellie Peabody	E. J. Frey
20	B. E. Bird	E. J. Frey	55	George E. J.	E. J. Frey	84	Paul Wells	E. J. Frey
20	Mary E. Bird	E. J. Frey	57	Margaret W. Millard	E. J. Frey	84	Myrl Wells	E. J. Frey
22	Geo. Metcalf	E. J. Frey	58	C. E. Nussbaum	E. J. Frey			
22	Marie Metcalf	E. J. Frey	61	Ann C. E. Nussbaum	E. J. Frey			
23	Alta Waverport	E. J. Frey	61					
24	Jas. M. Cullough	E. J. Frey						
24	Jennie M. Cullough	E. J. Frey						
26	C. E. Carpenter	E. J. Frey						
26	Ella Carpenter	E. J. Frey						
27	J. C. Power	E. J. Frey						
28	D. S. Finney	E. J. Frey						
28	Nellie Finney	E. J. Frey						
29	Ray M. Wolford	E. J. Frey						
29	Emily Wolford	E. J. Frey						
30	B. B. Finney	E. J. Frey						
30	Bessie Finney	E. J. Frey						
31	John J. Hart	E. J. Frey						
31	Lana Hart	E. J. Frey						
32	E. S. Cornell	E. J. Frey						
32	Lottie Baker	E. J. Frey						
33	John J. Hart	E. J. Frey						
33	Lana Hart	E. J. Frey						
34	J. B. Hultz	E. J. Frey						
34	Ammon Baker	E. J. Frey						
36	Geo. Fleming	E. J. Frey						
36	Ida Fleming	E. J. Frey						
37	Ammon Baker	E. J. Frey						
37	Lottie Baker	E. J. Frey						
38	Ammon Baker	E. J. Frey						

County of Holmes  
State of Ohio  
On this 29 day of May 1936, before me a Notary Public in and for said County and State personally appeared: Mrs. J. E. Gasche; S. C. Critchfield; R. P. Cunningham and Linda Cunningham, husband and wife; Jennie M. King and Geo. E. King, wife and husband; Ebert L. Shrimplin; J. C. Lisle and Mary Jane Lisle; husband and wife; L. R. Mumma and Helen M. Mumma, husband and wife; Geo. Rohsopf and Bernice Rohsopf, husband and wife; Albert Tidball and Vera Tidball, husband and wife; Robert Reed and Carrie Reed, husband and wife; Gladys Purdy and Clayton Purdy, wife and husband; Ora Purdy; Annie Brink; S. A. Martin and Hulda Martin, husband and wife; J. E. Anderson and Bartha Anderson, husband and wife; Henry Miller; D. E. Allison and Bessie Allison, husband and wife; B. C. Bird and Mary E. Bird, husband and wife; Geo. W. Metcalf and Marie Metcalf, husband and wife; Alta Waverport; Jas. M. Cullough and Jennie M. Cullough; husband and wife; C. E. Carpenter and Ella Carpenter, husband and wife; J. C. Power; D. S. Finney and Nellie Finney, husband and wife; Lloyd Snyder and Alice Snyder, husband and wife; Roy M. Wolford and Emily Wolford, husband and wife; B. B. Finney and Bessie Finney, husband and wife; E. S. Cornell and Myrtle Cornell, husband and wife; John J. Hart and Lana Hart, husband and wife; J. B. Hultz; Geo. Fleming and Ida Fleming, husband and wife; Ammon Baker and Lottie Baker, husband and wife; Bryan Hostetler; C. R. Martin and Nellie Martin, husband and wife; Roscoe Chambers and Myra Chambers, husband and wife; John Chambers and Lulu Chambers, husband and wife; Mary Chambers and Laura Chambers, husband and wife; Irvin Arnold and Orpha Arnold, husband and wife; A. N. Kreig and Louanna Kreig, husband and wife; Elmer Swires and Grace Swires, husband and wife; Jacob Zimmerman; John H. Wachtel and Grace Wachtel, husband and wife; Elmer Swires and Grace Swires, husband and wife; Chas. Core and Clara Core, husband and wife; A. D. Snyder and Lula Snyder, husband and wife; L. H. Snyder; D. J. Miller; Mary Franks; Phillip Reed and Barbara Reed, husband and wife; George Lay; Margaret A. Mulhall; C. E. Nussbaum and Mrs. C. E. Nussbaum, husband and wife; C. Conner and Ella Conner, husband and wife; F. S. Varnell and Elva M. Varnell, husband and wife; Frank Dye and Ella Dye, husband and wife; A. A. Kreger and Grace Kreger, husband and wife; Robert White and Bianca White, husband and wife; Quincy Spade and Ethel Spade, husband and wife; Pearl M. Clelland and C. E. M. Clelland, wife and husband; Eva Miller; J. Swainhart and Cora Swainhart, husband and wife; Lewis C. Crawford and Bernice Crawford, husband and wife; George V. Wise and Florence E. Wise, husband and wife; Roy S. Easterday and Ala Easterday, husband and wife; Clarence Parcell; Isaac Hague; Chas. Hague and Elizabeth Hague, husband and wife; Nellie Peabody; Bird Wells and Myrl Wells, husband and wife; who acknowledged the signing of this plat to be their voluntary act and deed for the purposes hereon mentioned. Witness my hand this 29 day of May 1936.

E. J. Frey  
JUSTICE OF PEACE, HOLMES COUNTY, OHIO

OFFICE OF COUNTY COMMISSIONERS  
HOLMES COUNTY, OHIO

This plat has been approved and accepted by us  
this 29 day of May, 1936.

J. A. Yoder  
J. E. Lisle  
John Schaffer  
BOARD OF COUNTY COMMISSIONERS

APPROVED AND ACCEPTED BY ME THIS 29 DAY OF MAY, 1936.

Karl Snyder  
COUNTY ENGINEER

ATTEST H. E. Gray  
COUNTY AUDITOR

RECORDING DATA  
Recorded in Plat Book Vol. 2 Page 7  
Holmes County Plat Records Date July 27, 1936  
Genevieve D. Cressy  
COUNTY RECORDER