



**UTILITIES**

LISTED BELOW ARE ALL UTILITIES LOCATED WITHIN THE PROJECT CONSTRUCTION LIMITS TOGETHER WITH THEIR RESPECTIVE OWNERS:

ASPIRE ENERGY  
ATTN: BENJAMIN HARVEY  
300 TRACY BRIDGE ROAD  
ORRVILLE, OHIO 44667  
330-682-1636  
BHARVEY@CHPK.COM

CENTURYLINK CORPORATION  
ATTN: JEFFREY SCHOONOVER  
2025 AKRON ROAD  
WOOSTER, OHIO 44691  
330-262-1128  
JEFFREY.L.SCHOONOVER@CENTURYLINK.COM

HOLMES-WAYNE ELECTRIC CO-OP  
ATTN: TIM VICKERS  
6060 STATE ROUTE 83  
MILLERSBURG, OHIO 44654  
330-674-1055  
TVICKERS@HWECOOP.COM

VILLAGE OF KILLBUCK  
ATTN: THE HONORABLE DENNY HAHN  
138 S. MAIN ST.  
KILLBUCK, OHIO 44637  
330-276-6601

THE LOCATION OF THE UNDERGROUND UTILITIES SHOWN ON THE PLANS ARE AS OBTAINED FROM THE OWNERS AS REQUIRED BY SECTION 153.64 O.R.C.

**CLEARING AND GRUBBING**

ALTHOUGH THERE ARE NO TREES OR STUMPS SPECIFICALLY MARKED FOR REMOVAL WITHIN THE LIMITS OF THE PROJECT, A LUMP SUM QUANTITY IS INCLUDED IN THE GENERAL SUMMARY FOR ITEM 201, CLEARING AND GRUBBING. ALL PROVISIONS AS SET FORTH IN THE SPECIFICATIONS UNDER THIS ITEM ARE INCLUDED IN THE LUMP SUM PRICE BID FOR ITEM 201, CLEARING AND GRUBBING.

**WORK LIMITS**

THE WORK LIMITS SHOWN ON THESE PLANS ARE FOR PHYSICAL CONSTRUCTION ONLY. PROVIDE THE INSTALLATION AND OPERATION OF ALL WORK ZONE TRAFFIC CONTROL AND WORK ZONE TRAFFIC CONTROL DEVICES REQUIRED BY THESE PLANS WHETHER INSIDE OR OUTSIDE THESE WORK LIMITS.

**SURVEYING PARAMETERS**

PRIMARY PROJECT CONTROL MONUMENTS GOVERN ALL POSITIONING ON ODOT PROJECTS. SEE SURVEY CONTROL TABLE FOR PROJECT CONTROL INFORMATION.

USE THE FOLLOWING PROJECT CONTROL, VERTICAL POSITIONING, AND HORIZONTAL POSITIONING PARAMETERS FOR ALL SURVEYING:

PROJECT CONTROL  
POSITIONING METHOD: ODOT VRS  
MONUMENT TYPE: TYPE A

VERTICAL POSITIONING  
ORTHOMETRIC HEIGHT DATUM: NAVD 88  
GEOID: GEOID 12B

HORIZONTAL POSITIONING  
REFERENCE FRAME: NAD 83 (2011)  
ELLIPSOID: GRS 1980  
MAP PROJECTION: LAMBERT CONFORMAL CONIC  
COORDINATE SYSTEM: OHIO STATE PLANE, NORTH ZONE  
COMBINED SCALE FACTOR: 1.00004294914951  
ORIGIN OF COORDINATE SYSTEM:  
N 298663.957  
E 2112770.956

USE THE POSITIONING METHODS AND MONUMENT TYPE USED IN THE ORIGINAL SURVEY TO RESTORE ALL MONUMENTS RELATED TO PRIMARY PROJECT CONTROL THAT ARE DAMAGED OR DESTROYED BY CONSTRUCTION ACTIVITIES. RESTORE THE DAMAGED OR DESTROYED MONUMENTS IN ACCORDANCE WITH CMS 623.

UNITS ARE IN U.S. SURVEY FEET.

**ITEM 441 - ASPHALT CONCRETE SURFACE COURSE, TYPE 1, (448), AS PER PLAN, (PG70-22M)**

FOLLOW SPECIFICATION 703.05 EXCEPT DO NOT USE COARSE AGGREGATE FROM A SOURCE DESIGNATED "SR" OR "SRH" ACCORDING TO THE OFFICE OF MATERIALS MANAGEMENT (OMM) IN ANY JOB MIX FORMULA (JMF) FOR THIS ITEM.

**EXISTING PLANS**

THE FOLLOWING EXISTING PLANS ARE AVAILABLE FOR REFERENCE AT THE DISTRICT 11 OFFICE OF THE OHIO DEPARTMENT OF TRANSPORTATION, 2201 REISER AVE. S.E., NEW PHILADELPHIA, OHIO, 44663:

ORIGINAL CONSTRUCTION:  
HOL-62-(10.00-14.10)

IN ADDITION, THE EXISTING PLANS CAN BE FOUND ON THE DEPARTMENT'S WEBSITE AT THE FOLLOWING ADDRESS:

<http://www.dot.state.oh.us/pub/contracts/attach>

**AIRWAY/HIGHWAY CLEARANCE FOR AIRPORTS AND HELIPORTS**

THIS PROJECT HAS BEEN IDENTIFIED AS BEING WITHIN THE INFLUENCE AREA OF A PUBLIC USE AIRPORT OR HELIPORT. NO TEMPORARY STRUCTURES OR CONSTRUCTION EQUIPMENT AT MAXIMUM OPERATING HEIGHT SHALL EXCEED A HEIGHT OF 50 FT. IF ANY TEMPORARY STRUCTURES OR CONSTRUCTION EQUIPMENT WILL EXCEED THIS HEIGHT, FURTHER COORDINATION WITH THE FEDERAL AVIATION ADMINISTRATION (FAA), AND ODOT OFFICE OF AVIATION, WILL BE NECESSARY PRIOR TO ERECTING SUCH TEMPORARY STRUCTURES OR OPERATING SUCH EQUIPMENT ON THE PROJECT. THE CONTRACTOR WILL BE REQUIRED TO SUBMIT FORM 7460-1 TO THE FAA. NOTIFY THE ODOT OFFICE OF AVIATION WHEN SUBMITTING FAA FORM 7460-1.

NO TEMPORARY STRUCTURES OR CONSTRUCTION EQUIPMENT SHALL EXCEED THE PERMISSIBLE HEIGHT, UNTIL A COPY OF THE FAA APPROVAL AND THE ODOT OFFICE OF AVIATION PERMIT HAS BEEN FURNISHED TO THE PROJECT ENGINEER.

FEDERAL AVIATION ADMINISTRATION  
SOUTHWEST REGIONAL OFFICE  
OBSTRUCTION EVALUATION GROUP  
10101 HILLWOOD PARKWAY  
FORT WORTH, TX 76177  
FAX: (817) 222-5920  
HTTP://CEAAA.FAA.GOV

OHIO DEPARTMENT OF TRANSPORTATION  
OFFICE OF AVIATION  
2829 WEST DUBLIN-GRANVILLE ROAD  
COLUMBUS, OHIO 43235  
OHIO.AIRPORT.PROTECTION@DOT.OHIO.GOV

**ENDANGERED BAT HABITAT REMOVAL**

THE PROJECT IS LOCATED WITHIN THE KNOWN HABITAT RANGES OF THE FEDERALLY LISTED AND PROTECTED INDIANA BAT AND NORTHERN LONG-EARED BAT. NO TREES SHALL BE REMOVED UNDER THIS PROJECT FROM APRIL 1 THROUGH SEPTEMBER 30. ALL NECESSARY TREE REMOVAL SHALL OCCUR FROM OCTOBER 1 THROUGH MARCH 31. THIS REQUIREMENT IS NECESSARY TO AVOID AND MINIMIZE IMPACTS TO THESE SPECIES AS REQUIRED BY THE ENDANGERED SPECIES ACT. FOR THE PURPOSES OF THIS NOTE, A TREE IS DEFINED AS A LIVE, DYING, OR DEAD WOODY PLANT, WITH A TRUNK THREE INCHES OR GREATER IN DIAMETER AT A HEIGHT OF 4.5 FEET ABOVE THE GROUND SURFACE, AND WITH A MINIMUM HEIGHT OF 13 FEET.

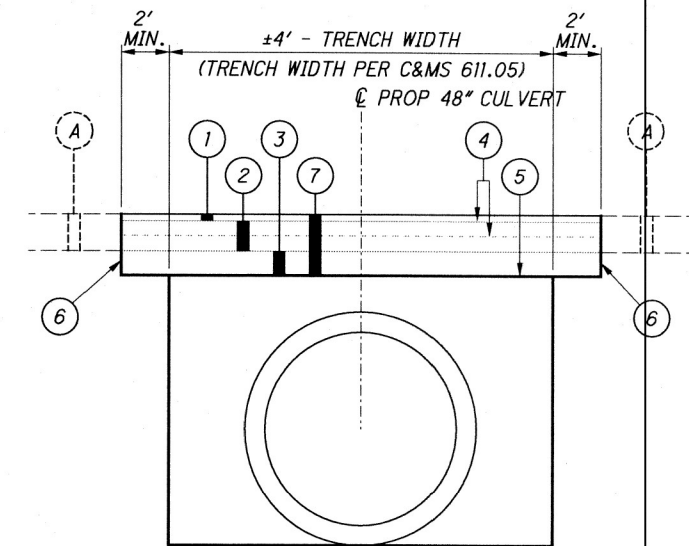

**PAVEMENT RESTORATION DETAIL**

**LEGEND**

- ① ITEM 441 - 1-1/4" ASPHALT CONCRETE SURFACE COURSE, TYPE 1, (448), AS PER PLAN (PG70-22M)
- ② ITEM 301 - 7-3/4" ASPHALT CONCRETE BASE (PG64-22)
- ③ ITEM 304 - 6" AGGREGATE BASE
- ④ ITEM 407 - TACK COAT (APPLIED AT 0.055 GAL./SY)
- ⑤ ITEM 204 - SUBGRADE COMPACTION
- ⑥ SAWCUT (INCLUDED WITH ITEM 202 - PAVEMENT REMOVED)
- ⑦ ITEM 202 - PAVEMENT REMOVED
- Ⓐ 8" EXISTING ASPHALT PAVEMENT

SURVEY CONTROL TABLE					
STATION	OFFSET	NORTHING	EASTING	ELEV.	REMARKS
PC 2+60.19	CL	298548.983	2112776.588	N/A	CL1
PT 5+23.92	CL	298801.937	2112705.790	N/A	CL2
2+54.40	-28.59	298531.845	2112752.978	807.440	S600
3+72.12	35.56	298663.957	2112770.956	807.845	S601

I:\ProjectData\109246\Design\Roadway\Sheets\109246\_GN001.dgn Sheet 5/13/2021 8:18:06 AM shorr1sb

CALCULATED SAH CHECKED DAH  
**GENERAL NOTES**  
**HOL-60-2-99**  
2  
13



I:\ProjectData\109246\Design\Roadway\Sheets\109246\_GN002.dgn Sheet 5/13/2021 8:18:07 AM shorrlisb

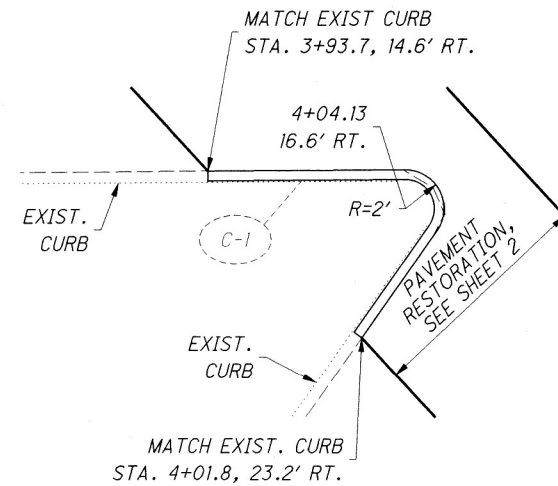

**CURBED ISLAND DETAIL**

**ITEM 646 - EPOXY PAVEMENT MARKINGS**

REPLACE THE EXISTING PAVEMENT MARKINGS WITHIN THE PROJECT LIMITS WITH NEW PAVEMENT MARKINGS AT THE SAME LOCATIONS AS PER CMS 641.06.

THE FOLLOWING QUANTITIES HAVE BEEN CARRIED TO THE GENERAL SUMMARY:

ITEM 646 - EDGE LINE, 6" (WHITE)

STA. 3+52 TO STA. 4+16 (LT.) =	0.01 MILE
STA. 3+63 TO STA. 4+16 (RT.) =	0.01 MILE
STA. 4+13 TO STA. 4+25 =	0.01 MILE
(RT SIDE - RT RETURN LANE)	
(YELLOW)	
STA. 3+63 TO STA 4+16 =	0.01 MILE
(LT SIDE - RT RETURN LANE)	
<b>TOTAL</b>	<b>0.04 MILE</b>

ITEM 646 - CENTER LINE

STA. 3+63 TO STA. 4+16 =	0.01 MILE
--------------------------	-----------

**TRAFFIC SIGNS**

REMOVE AND REPLACE TRAFFIC SIGN LOCATED IN THE RIGHT TURN ISLAND NEAR STA. 4+05. THE FOLLOWING ESTIMATED QUANTITIES HAVE BEEN CARRIED TO THE GENERAL SUMMARY FOR THIS WORK:

ITEM 630 - REMOVAL OF GROUND MOUNTED SIGN AND REERECTION	1 EACH
ITEM 630 - REMOVAL OF GROUND MOUNTED POST SUPPORT AND DISPOSAL	1 EACH
ITEM 630 - GROUND MOUNTED SUPPORT, NO. 3 POST	13 FT
ITEM 630 - SIGN POST REFLECTOR	1 EACH

**RAISED PAVEMENT MARKERS(RPM)**

THE CONTRACTOR SHALL REMOVE ALL EXISTING RAISED PAVEMENT MARKERS AND INSTALL NEW RPMS WITHIN THE PROJECT LIMITS. SPACING FOR THE NEW RPMS SHALL BE 40'.

THE FOLLOWING QUANTITIES HAVE BEEN CARRIED TO THE GENERAL SUMMARY:

ITEM 621 - RAISED PAVEMENT MARKER REMOVED	
STA. 3+80.37 TO STA. 3+96.56 =	1 EACH
ITEM 621 - RPM	
STA. 3+80.37 TO STA. 3+96.56 =	1 EACH

**ENVIRONMENTAL WORK**

BASED ON ENVIRONMENTAL STUDIES WITH TESTING CONDUCTED BY ODOT AND/OR FOR REGULATORY AGENCIES PETROLEUM CONTAMINATED SOILS WILL BE ENCOUNTERED DURING THE EXCAVATIONS FOR CONSTRUCTION ACTIVITIES AT THE SITES LISTED BELOW. THE ESTIMATED QUANTITIES HAVE BEEN INCLUDED IN THE GENERAL SUMMARY FOR THIS WORK. ALL EXCAVATIONS AT THE AFOREMENTIONED LOCATION SHALL BE PAID FOR UNDER THE ORIGINAL PLAN BID ITEMS.

1. THOMAS RICHARDS: 2578 SR 60, KILLBUCK, OH 44637

ALL EXCAVATED MATERIALS WITHIN THE AFOREMENTIONED LIMITS MAY BE STOCKPILED IN AN AREA PROVIDED BY THE CONTRACTOR AND APPROVED BY THE ENGINEER. THE ENGINEER MAY PERMIT TEMPORARY STORAGE OF THE SUSPECTED CONTAMINATED SOILS ON AN IMPERMEABLE MEMBRANE. THE MEMBRANE WILL BE SURROUNDED BY BALES OF STRAW TO PREVENT THE SUSPECTED SOILS FROM COMING IN CONTACT WITH THE ORIGINAL SOILS. AN IMPERMEABLE MEMBRANE WILL BE PLACED OVER THE STOCKPILE TO PREVENT CONTACT WITH PRECIPITATION AND/OR SURFACE RUN-OFF. AS A TEMPORARY STORAGE ALTERNATIVE, THE ENGINEER MAY PERMIT THE CONTRACTOR TO DIRECT LOAD THE EXCAVATED SOILS INTO TRUCKS. AS A THIRD ALTERNATIVE, THE CONTRACTOR MAY PLACE THE MATERIAL IN LEAK-PROOF, COVERED CONTAINERS PROVIDED BY THE CONTRACTOR. THE MATERIAL WILL REMAIN ON-SITE UNTIL ANALYTICAL RESULTS ARE RECEIVED BY THE ENGINEER.

THIS MATERIAL WILL BE PROPERLY TESTED (FOR DISPOSAL), TRANSPORTED, AND DISPOSED OF IN A LICENSED (BY THE LOCAL HEALTH DEPARTMENT) AND PERMITTED (BY THE OHIO ENVIRONMENTAL PROTECTION AGENCY) SOLID WASTE FACILITY.

IF EXCAVATIONS WITHIN THE AFOREMENTIONED LIMITS REQUIRE DEWATERING FOR CONSTRUCTION PURPOSES, THE CONTRACTOR WILL DEWATER, CONTAINERIZE, TEST THE WATER (FOR DISPOSAL) AND DISPOSE OF BY METHODS APPROVED BY THE ENGINEER. THE CONTRACTOR WILL OBTAIN ALL THE REQUIRED PERMITS AND /OR AUTHORIZATIONS NEEDED TO STORE, TRANSPORT AND DISPOSE OF THE WATER IN ACCORDANCE WITH APPLICABLE LOCAL, STATE OR FEDERAL REGULATIONS.

THE CONTRACTOR WILL FURNISH ALL THE LABOR, EQUIPMENT, AND MATERIALS NECESSARY TO PROPERLY HANDLE, STORE, TEST (FOR DISPOSAL), TRANSPORT, AND DISPOSAL; INCLUDING ANY REQUIRED PERMITS, APPROVALS, OR FEES WITHIN THE AFOREMENTIONED LOCATION. PAYMENT FOR THIS WORK WILL BE MADE AT THE CONTRACT PRICE BID PER TON, PER GALLON, PER CUBIC YARD AND PER UST. THE FOLLOWING ESTIMATED QUANTITY HAS BEEN INCLUDED IN THE GENERAL SUMMARY FOR THE WORK NOTED ABOVE:

ITEM SPECIAL - WORK INVOLVING PETROLEUM CONTAMINATED SOIL	15 TON
(6 + 4) x 1.5 TON/CY = 15 TON	

ITEM SPECIAL - WORK INVOLVING REGULATED WATER	505 GAL
0.25 x (6 + 4) x 201.974 GAL/CY = 505 GAL	

**ITEM 659 - SEEDING AND MULCHING**

THE FOLLOWING QUANTITIES ARE PROVIDED TO PROMOTE GROWTH AND CARE OF PERMANENT SEEDED AREAS:

659, SOIL ANALYSIS TEST	2 EACH
56 x 1 / 1000 = 0.006 EACH	
USE 2 EACH MIN.	
659, TOPSOIL	56 CU. YD.
500 x 111 / 1000 = 55.5	
659, COMMERCIAL FERTILIZER	0.07 TON
500 x 9 x 30 / 1000 / 2000 = 0.07	
659, LIME	0.10 ACRES
500 x 9 / 43560 = 0.10	
659, WATER	5 M. GAL.
500 x 9 x 300 / 1000 x 2 / 1000 = 2.70	
USE 5 M. GAL.	

SEEDING AND MULCHING SHALL BE APPLIED TO ALL AREAS OF EXPOSED SOIL BETWEEN THE RIGHT-OF-WAY LINES, AND WITHIN THE CONSTRUCTION LIMITS FOR AREAS OUTSIDE THE RIGHT-OF-WAY LINES COVERED BY WORK AGREEMENT OR SLOPE EASEMENT. QUANTITY CALCULATIONS FOR SEEDING AND MULCHING ARE BASED ON THESE LIMITS.

EARTHWORK AND SEEDING TABLE			
SHEET NO.	203		659
	EXCAVATION	EMBANKMENT	SEEDING AND MULCHING
	CY YD	CU YD	SQ YD
11	232	0	313
12	50	7	187
13	0	0	0
<b>TOTAL CARRIED TO GENERAL SUMMARY</b>	<b>282</b>	<b>7</b>	<b>500</b>

CALCULATED	SAH	CHECKED	DAH
GENERAL NOTES			
HOL-60-2.99			
3			
13			

**ITEM 614 - MAINTAINING TRAFFIC**

A MINIMUM OF ONE (1) 10' LANE OF TRAFFIC IN EACH DIRECTION SHALL BE MAINTAINED AT ALL TIMES, EXCEPT FOR A PERIOD NOT TO EXCEED 3 CONSECUTIVE CALENDAR DAYS, WHEN THROUGH TRAFFIC MAY BE DETOURED AS SHOWN ON SHEET 5. A DISINCENTIVE SHALL BE ASSESSED IN THE AMOUNT OF \$7,200 PER DAY FOR EACH CALENDAR DAY THE ROADWAY REMAINS CLOSED TO TRAFFIC BEYOND THE SPECIFIED LIMIT.

THE 3 DAY CLOSURE PERIOD MUST OCCUR BETWEEN JUNE 1, 2022 AND AUGUST 15, 2022, WHEN LOCAL SCHOOLS ARE NOT IN SESSION, BUT SHALL NOT BE PERFORMED CONCURRENT WITH THE DETOUR FOR HOL-60-6.60 (PART 1).

THE MAINTENANCE OF TRAFFIC SHALL BE IN CONFORMANCE WITH THE OHIO MANUAL OF UNIFORM TRAFFIC CONTROL DEVICES, LATEST REVISION; THE REFERENCED STANDARD CONSTRUCTION DRAWINGS INCLUDING DESIGNER NOTES; THE CONSTRUCTION AND MATERIAL SPECIFICATIONS (CMS); POLICY NO. 516-003(P) TRAFFIC MANAGEMENT IN WORK ZONES INTERSTATE AND OTHER FREEWAYS; ODOT LOCATION AND DESIGN MANUAL, VOLUME 1; ODOT TRAFFIC ENGINEERING MANUAL; AND ALL REQUIREMENTS DETAILED IN THESE PLANS.

LENGTH AND DURATION OF LANE RESTRICTIONS SHALL BE AT THE APPROVAL OF THE ENGINEER. IT IS THE INTENT TO MINIMIZE THE IMPACT TO THE TRAVELING PUBLIC. LANE RESTRICTIONS OVER SEGMENTS OF THE PROJECT IN WHICH NO WORK IS ANTICIPATED WITHIN A REASONABLE TIME FRAME, AS DETERMINED BY THE ENGINEER, SHALL NOT BE PERMITTED. THE LEVEL OF UTILIZATION OF MAINTENANCE OF TRAFFIC DEVICES SHALL BE COMMENSURATE WITH THE WORK IN PROGRESS.

NO WORK SHALL BE PERFORMED AND ALL EXISTING LANES SHALL BE OPEN TO TRAFFIC DURING THE FOLLOWING DESIGNATED HOLIDAYS OR EVENTS:

CHRISTMAS	FOURTH OF JULY
NEW YEAR'S	LABOR DAY
MEMORIAL DAY	THANKSGIVING

THE PERIOD OF TIME THAT THE LANES ARE TO BE OPEN DEPENDS ON THE DAY OF THE WEEK ON WHICH THE HOLIDAY OR EVENT FALLS. THE FOLLOWING SCHEDULE SHALL BE USED TO DETERMINE THIS PERIOD:

DAY OF HOLIDAY OR EVENT	TIME ALL LANES MUST BE OPEN TO TRAFFIC
SUNDAY	12:00N FRIDAY THROUGH 6:00AM MONDAY
MONDAY	12:00N FRIDAY THROUGH 6:00AM TUESDAY
TUESDAY	12:00N MONDAY THROUGH 6:00AM WEDNESDAY
WEDNESDAY	12:00N TUESDAY THROUGH 6:00AM THURSDAY
THURSDAY	12:00N WEDNESDAY THROUGH 6:00AM FRIDAY
THURSDAY (THANKSGIVING ONLY)	6:00AM WEDNESDAY THROUGH 6:00AM MONDAY
FRIDAY	12:00N THURSDAY THROUGH 6:00AM MONDAY
SATURDAY	12:00N FRIDAY THROUGH 6:00AM MONDAY

SHOULD THE CONTRACTOR FAIL TO MEET ANY OF THESE REQUIREMENTS, THE CONTRACTOR SHALL BE ASSESSED A DISINCENTIVE IN THE AMOUNT OF \$900 FOR EACH HOUR THE ABOVE DESCRIBED LANE CLOSURE RESTRICTIONS ARE VIOLATED.

(CONTINUED...)

**ITEM 614 - MAINTAINING TRAFFIC**

(CONTINUED...)

NOTICE OF CLOSURE SIGNS (W20-H13) SHALL BE ERECTED BY THE CONTRACTOR PRIOR TO THE SCHEDULED ROAD CLOSURE IN ACCORDANCE WITH THE NOTICE OF CLOSURE TIME TABLE BELOW.

THE SIGNS SHALL BE ERECTED ON THE RIGHT-HAND SIDE OF THE ROAD FACING TRAFFIC. THEY SHALL BE PLACED SO AS NOT TO INTERFERE WITH THE VISIBILITY OF ANY OTHER TRAFFIC CONTROL SIGNS. ON ROADWAYS, THEY SHOULD BE ERECTED AT OR NEAR THE POINT OF CLOSURE.

NOTICE OF CLOSURE SIGN TIME TABLE		
ITEM	DURATION OF CLOSURE	SIGN DISPLAYED TO PUBLIC
RAMP & ROAD CLOSURES	>= 2 WEEKS	14 CALENDAR DAYS PRIOR TO CLOSURE
	> 12 HOURS & < 2 WEEKS	7 CALENDAR DAYS PRIOR TO CLOSURE
	<= 12 HOURS	2 BUSINESS DAYS

THE SIGN SHALL DISPLAY THE DATE OF THE CLOSURE IN MMM-DD FORMAT AND THE NUMBER OF DAYS OF THE CLOSURE. THE LAST LINE OF THE W20-H13 SIGN LISTS A PHONE NUMBER WHICH A MOTORIST MAY CALL FOR ADDITIONAL INFORMATION. THIS IS TO BE A SPECIFIC OFFICE WITHIN THE DISTRICT RATHER THAN THE GENERAL SWITCHBOARD NUMBER.

SR 60 WILL BE CLOSED MMM-DD FOR 3 DAYS  
INFO: 330-339-6633

W20-H13-60

THE CONTRACTOR SHALL PROVIDE, ERECT AND MAINTAIN STANDARD 48 X 30 INCH ROAD CLOSED SIGNS, SIGN SUPPORTS, BARRICADES AND LIGHTS, AS DETAILED IN SCD MT-101.60 AT THE LOCATIONS SHOWN ON SHEETS 5 - 6 DURING PERIODS IN WHICH THE AFFECTED ROADS ARE CLOSED TO TRAFFIC.

ALL WORK AND TRAFFIC CONTROL DEVICES SHALL BE IN ACCORDANCE WITH C&MS 614 AND OTHER APPLICABLE PORTIONS OF THE SPECIFICATIONS, AS WELL AS THE OHIO MANUAL OF UNIFORM TRAFFIC CONTROL DEVICES. PAYMENT FOR ALL LABOR, EQUIPMENT AND MATERIALS SHALL BE INCLUDED IN THE LUMP SUM CONTRACT PRICE FOR ITEM 614, MAINTAINING TRAFFIC, UNLESS SEPARATELY ITEMIZED IN THE PLAN.

**NOTIFICATION OF TRAFFIC RESTRICTIONS**

THROUGHOUT THE DURATION OF THE PROJECT, THE CONTRACTOR SHALL NOTIFY THE PROJECT ENGINEER IN WRITING OF ALL TRAFFIC RESTRICTIONS AND UPCOMING MAINTENANCE OF TRAFFIC CHANGES. THE CONTRACTOR SHALL ENSURE THE WRITTEN NOTIFICATION IS SUBMITTED IN A TIMELY MANNER TO ALLOW THE PROJECT ENGINEER TO MEET THE REQUIRED TIME FRAMES SET FORTH IN THE TABLE BELOW TO INFORM THE SPECIAL HAULING PERMITS SECTION (HAULING.PERMITS@DOT.OHIO.GOV) AND THE DISTRICT PUBLIC INFORMATION OFFICER (PIO). THIS NOTIFICATION SHALL BE RECEIVED BY THE PROJECT ENGINEER PRIOR TO THE PHYSICAL SETUP OF ANY APPLICABLE SIGNS OR MESSAGE BOARDS.

INFORMATION SHOULD INCLUDE, BUT IS NOT LIMITED TO, ALL CONSTRUCTION ACTIVITIES THAT IMPACT OR INTERFERE WITH TRAFFIC AND SHALL LIST THE SPECIFIC LOCATION, TYPE OF WORK, ROAD STATUS, DATE AND TIME OF RESTRICTION, DURATION OF RESTRICTION, NUMBER OF LANES MAINTAINED, NUMBER OF LANES CLOSED, MINIMUM VERTICAL CLEARANCE, MINIMUM WIDTH OF DRIVABLE PAVEMENT, DETOUR ROUTES, IF APPLICABLE, AND ANY OTHER INFORMATION REQUESTED BY THE PROJECT ENGINEER.

NOTIFICATION TIME TABLE		
ITEM	DURATION OF CLOSURE	NOTICE DUE TO OFFICE OF COMMUNICATIONS
RAMP & ROAD CLOSURES	>= 2 WEEKS	21 CALENDAR DAYS PRIOR TO CLOSURE
	> 12 HOURS & < 2 WEEKS	14 CALENDAR DAYS PRIOR TO CLOSURE
	<= 12 HOURS	4 BUSINESS DAYS PRIOR TO CLOSURE
LANE CLOSURES & RESTRICTIONS	>= 2 WEEKS	14 CALENDAR DAYS PRIOR TO CLOSURE
	< 2 WEEKS	5 BUSINESS DAYS PRIOR TO CLOSURE
START OF CONSTRUCTION & TRAFFIC PATTERN CHANGES	N/A	14 CALENDAR DAYS PRIOR TO IMPLEMENTATION

ANY UNFORESEEN CONDITIONS NOT SPECIFIED IN THE PLANS REQUIRING TRAFFIC RESTRICTIONS SHALL ALSO BE REPORTED TO THE PROJECT ENGINEER USING THE NOTIFICATION TIME TABLE.

**WORK ZONE MARKINGS AND SIGNS**

THE FOLLOWING ESTIMATED QUANTITIES HAVE BEEN CARRIED TO THE GENERAL SUMMARY FOR USE AT LOCATIONS IDENTIFIED BY THE ENGINEER FOR WORK ZONE PAVEMENT MARKINGS AND SIGNS PER THE REQUIREMENTS OF C&MS 614.04 AND 614.11.

ITEM 614 - WORK ZONE CENTER LINE, CLASS III, 642 PAINT	0.02 MILES
ITEM 614 - WORK ZONE EDGE LINE, CLASS III, 6", 642 PAINT	0.04 MILES

**LOCAL ROAD REPAIR**

THE FOLLOWING ESTIMATED QUANTITIES ARE PROVIDED FOR USE AS DETERMINED BY THE ENGINEER TO MAINTAIN AND SUBSEQUENTLY RESTORE LOCAL ROADS THAT MAY BE DAMAGED DUE TO DETOURING TRAFFIC.

ITEM 614, ASPHALT CONCRETE FOR MAINTAINING TRAFFIC	10 CU. YD.
ITEM 617, COMPACTED AGGREGATE	5 CU. YD.

**COOPERATION BETWEEN CONTRACTORS**

THE CONTRACTOR IS HEREBY ADVISED THAT PROJECT HOL-520-9.83/9.87, PID 109012 MAY BE UNDER CONSTRUCTION DURING THE SAME PERIOD THIS PROJECT IS BEING CONSTRUCTED. UPON AWARD OF THIS CONTRACT, THE CONTRACTOR SHALL NOTIFY THE ENGINEER AND THE OTHER CONTRACTORS OF THE EFFECTS OF THIS CONTRACT UPON THE HOL-520-9.83/9.87 PROJECT. THE CONTRACTOR SHALL COOPERATE WITH THE OTHER CONTRACTORS IN ACCORDANCE WITH SEC. 105.08 AND ARRANGE A MUTUALLY ACCEPTABLE WORK SCHEDULE, SUBJECT TO THE APPROVAL OF THE ENGINEER. ANY CONFLICTS BETWEEN CONTRACTORS INVOLVING WORK SCHEDULES, WORK AREAS OR COOPERATION WILL BE RESOLVED BY THE ENGINEER.

I:\ProjectData\109246\Design\Roadway\Sheets\109246\_MN001.dgn Sheet 5/13/2021 10:01:46 AM shorrlsb

MAINTENANCE OF TRAFFIC NOTES

HOL-60-2.99

CALCULATED  
SAH  
CHECKED  
DAH

**ITEM 614, DETOUR SIGNING**

THE FOLLOWING SIGNS SHALL BE ERECTED ALONG THE DESIGNATED OFFICIAL DETOUR ROUTE AND SHALL BE ASSEMBLED AS SHOWN ON THIS SHEET. ALL DETOUR SIGNING SHALL BE INSTALLED BEFORE COMMENCING ANY OF THE PROPOSED WORK REQUIRING THE DETOUR.

EACH SIGN ASSEMBLY SHALL BE PLACED 100 FT. (OR AS DIRECTED) IN ADVANCE OF THE IMPENDING CHANGE OF ROUTE. OFFSET SHALL BE AS PER STANDARD CONSTRUCTION DRAWING TC-42.20.

IN ADDITION TO THE SIGNS INCLUDED IN THE LEGEND AND SHOWN ON THE DETOUR MAPS, PLACE THE FOLLOWING SIGN ASSEMBLY:

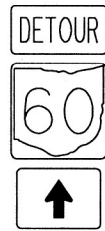

AT INTERVALS NOT TO EXCEED 2 MILES IN RURAL AREAS AND AT INTERVALS NOT TO EXCEED 2 BLOCKS WITHIN URBANIZED AREAS. IT IS ANTICIPATED THAT 12 SIGN ASSEMBLIES WILL BE REQUIRED TO MEET THIS MAXIMUM SPACING.

ALL ANTICIPATED QUANTITIES ARE SHOWN IN THE TABLE BELOW AND ARE PROVIDED FOR INFORMATION ONLY.

SIGN CODE	NO. OF SIGNS	SIZE
R11-3A-60	1	60 IN. x 30 IN.
M4-10R-48	1	48 IN. x 18 IN.
M4-8-24	34	24 IN. x 12 IN.
M1-5-24-2	36	24 IN. x 24 IN.
M3-1-24	9	24 IN. x 12 IN.
M3-3-24	11	24 IN. x 12 IN.
M5-1L-21	3	21 IN. x 15 IN.
M6-1L-21	3	21 IN. x 15 IN.
M5-1R-21	3	21 IN. x 15 IN.
M6-1R-21	3	21 IN. x 15 IN.
M4-8A-24	2	24 IN. x 18 IN.
W20-2-36	1	36 IN. x 36 IN.
R11-2-48	2	48 IN. x 30 IN.
M4-10L-48	1	48 IN. x 18 IN.
M6-3-21	16	21 IN. x 15 IN.

PAYMENT FOR ALL LABOR, EQUIPMENT & MATERIALS SHALL BE INCLUDED IN THE LUMP SUM CONTRACT PRICE FOR ITEM 614, DETOUR SIGNING, UNLESS SEPERATELY ITEMIZED IN THE PLAN.

**SIGN LEGEND**

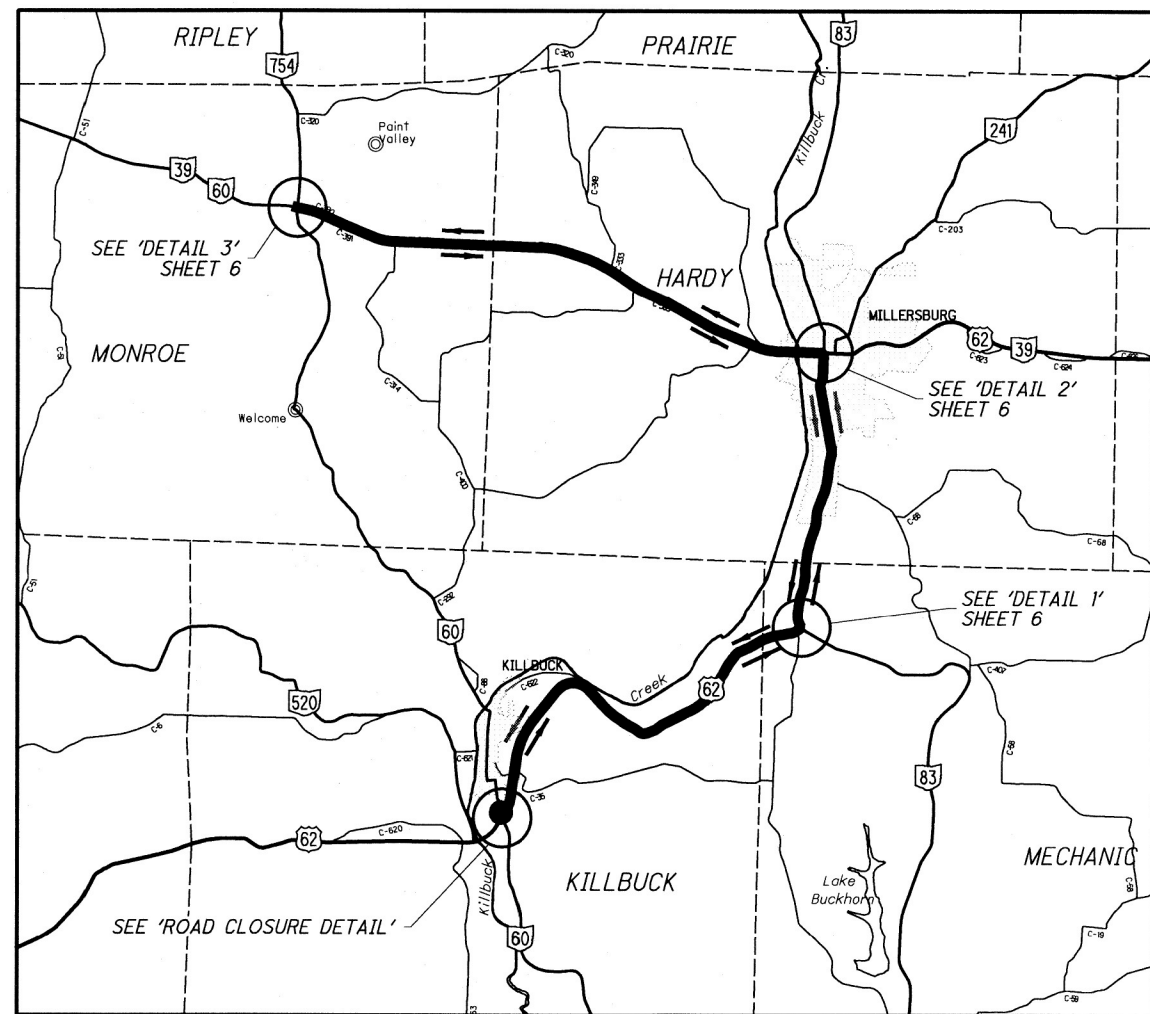
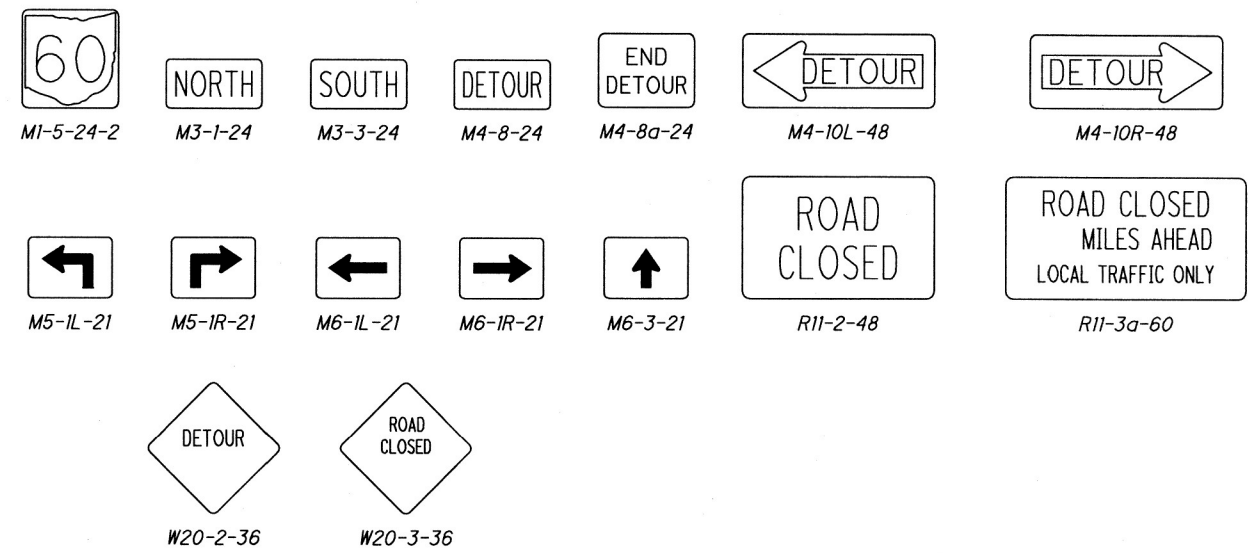

OFFICIAL DETOUR ROUTE



NOT TO SCALE

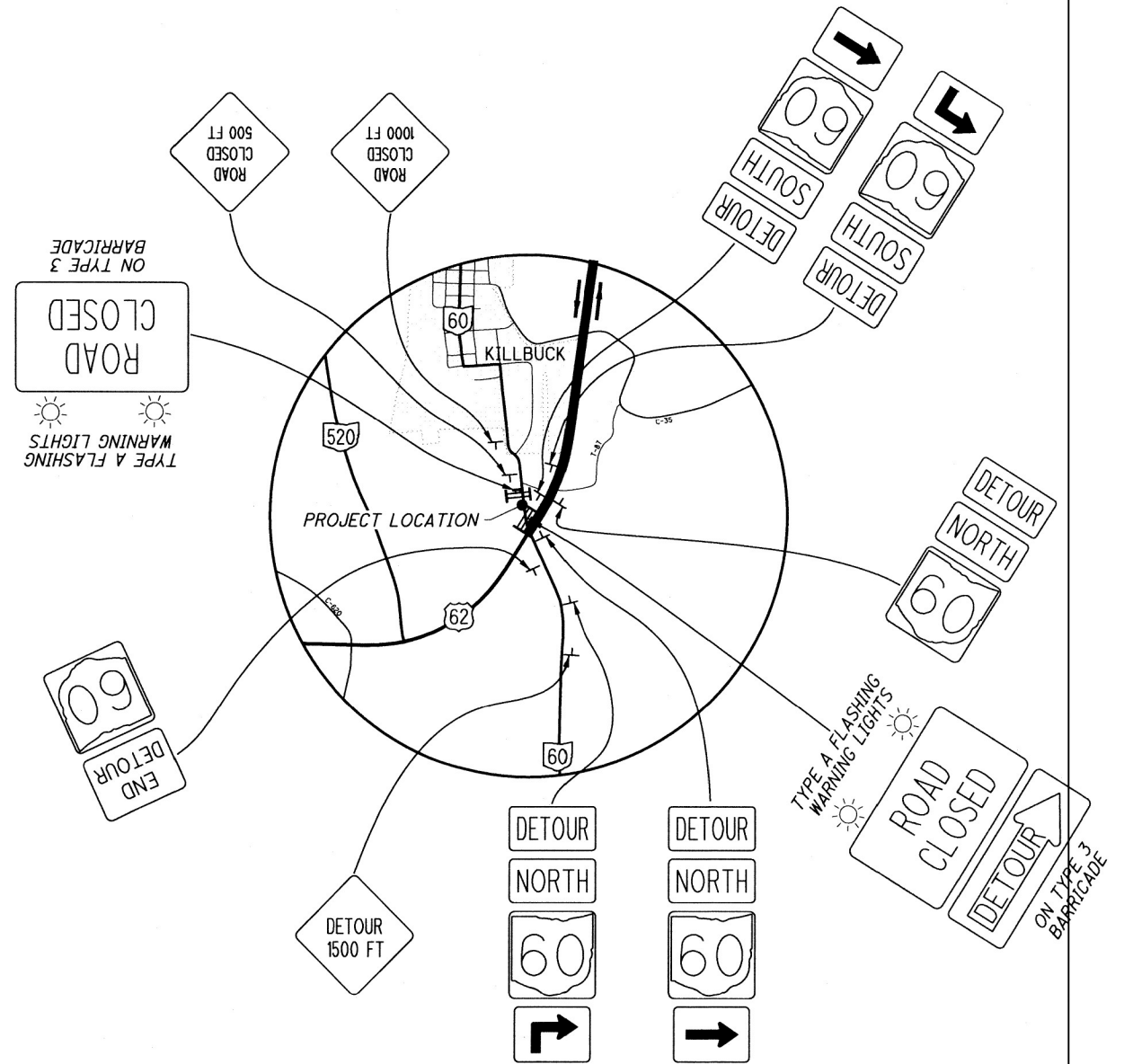

ROAD CLOSURE DETAIL

I:\ProjectData\109246\Design\Roadway\Sheets\109246\_MDO01.dgn Detour Route 5/13/2021 8:18:10 AM shorrrib

CALCULATED  
SAH  
CHECKED  
DAH

DETOUR PLAN

HOL-60-2.99

5  
13



I:\ProjectData\109246\Design\Roadway\Sheets\109246\_MDD001.dgn Sign Details 5/13/2021 8:18:11 AM shorr\isb

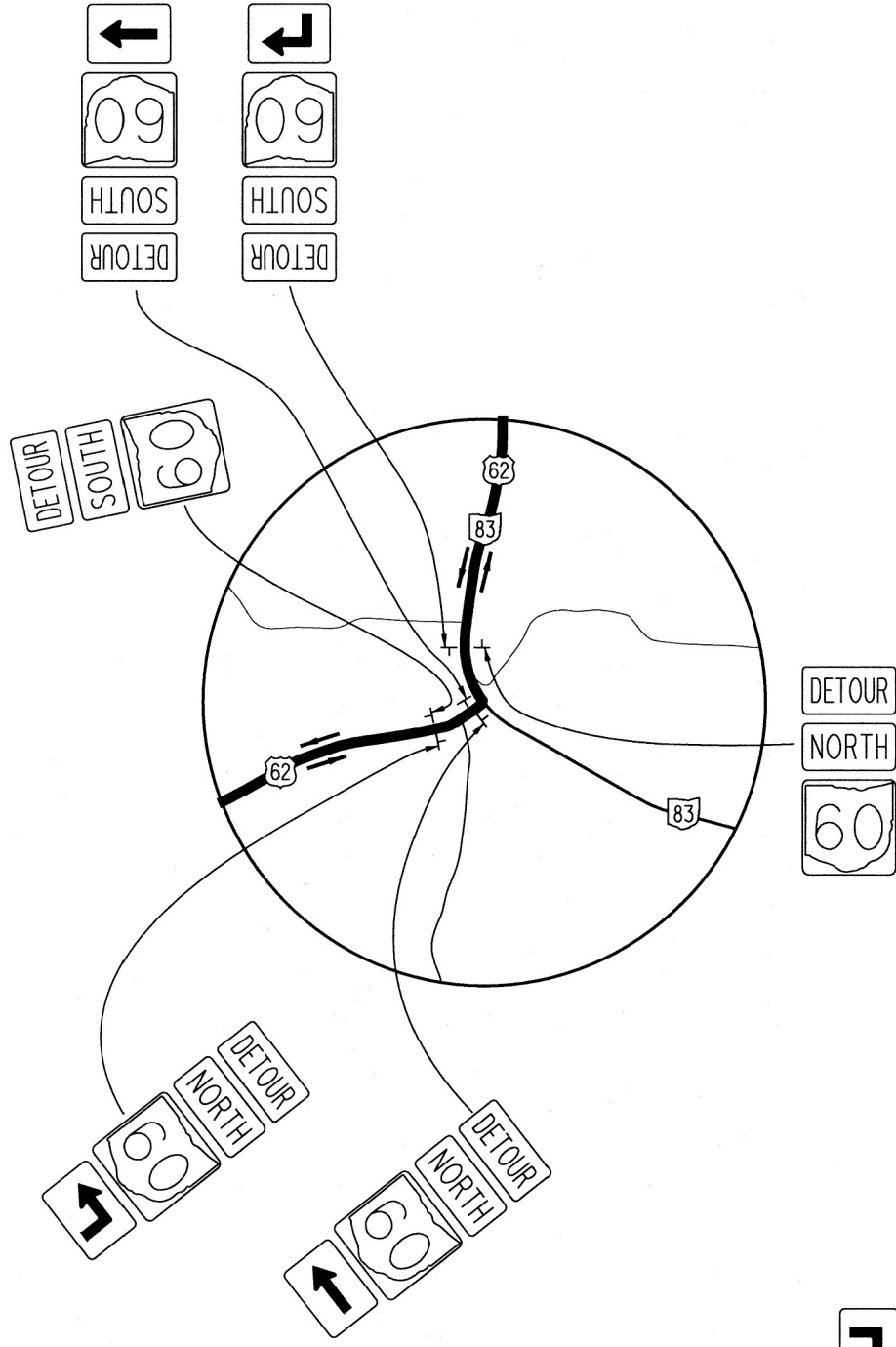

**DETAIL 1**  
U.S. 62 & S.R. 83 INTERSECTION

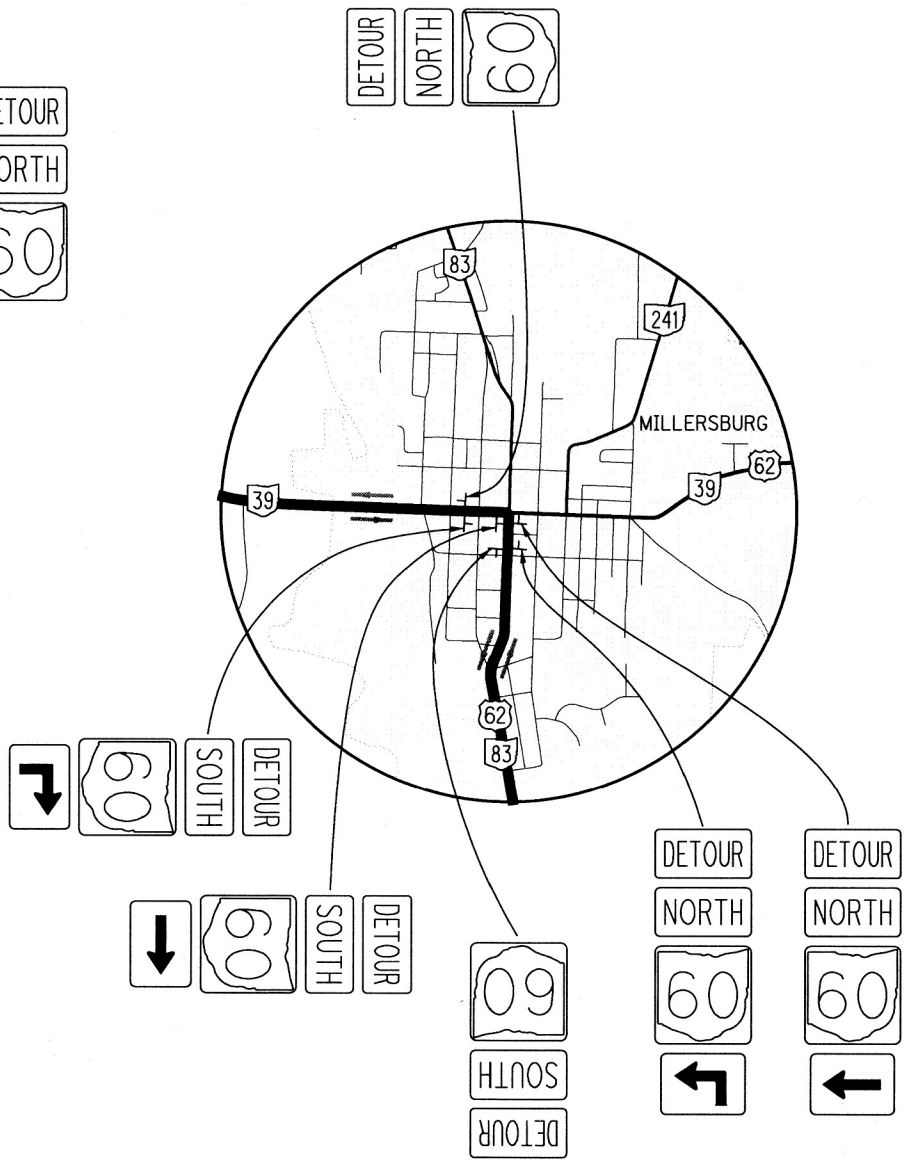

**DETAIL 2**  
U.S. 62/S.R. 83 & S.R. 39 INTERSECTION

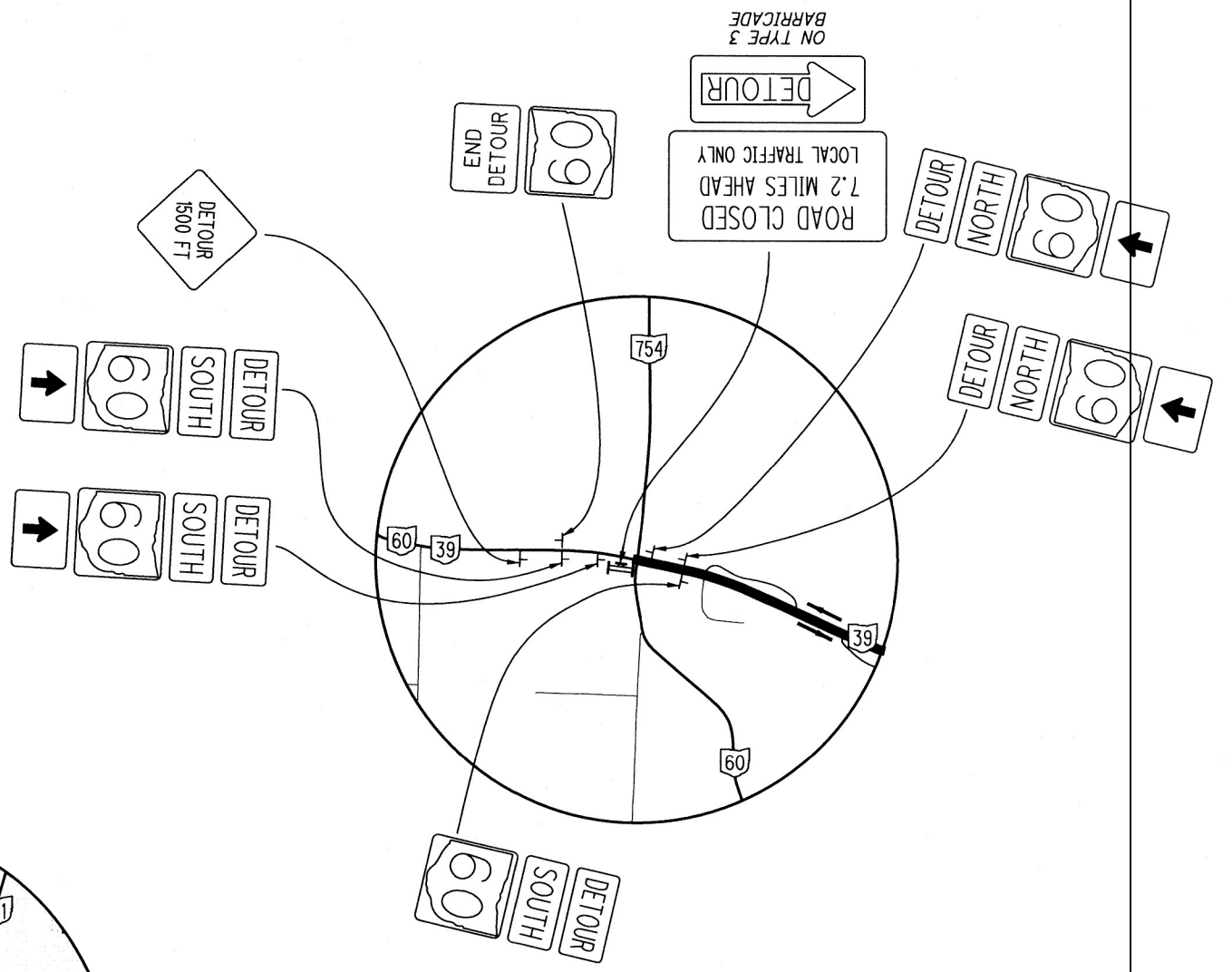

**DETAIL 3**  
S.R. 60, S.R. 754 & S.R. 39 INTERSECTION

CALCULATED  
SAH  
CHECKED  
DAH

**DETOUR PLAN**

**HOL -60-2.99**

SHEET NUM.										OFFICE CALCS	PART.	ITEM	ITEM EXT	GRAND TOTAL	UNIT	DESCRIPTION	SEE SHEET NO.	
2	3	4	5				9			02/ NFA/CV								
LS																<b>ROADWAY</b>		
									75	LS	201	11000	LS			CLEARING AND GRUBBING		
									75	75	202	23000	75	SY		PAVEMENT REMOVED		
							21			21	202	32000	21	FT		CURB REMOVED		
							180			180	202	35200	180	FT		PIPE REMOVED, OVER 24"		
			282							282	203	10000	282	CY		EXCAVATION		
			7							7	203	20000	7	CY		EMBANKMENT		
									78	78	204	10000	78	SY		SUBGRADE COMPACTION		
							21			21	609	26000	21	FT		CURB, TYPE 6		
																<b>EROSION CONTROL</b>		
							5			5	601	11000	5	SY		RIPRAP, TYPE D		
							10			10	601	32110	10	CY		ROCK CHANNEL PROTECTION, TYPE B WITH AGGREGATE FILTER		
							9			9	601	32210	9	CY		ROCK CHANNEL PROTECTION, TYPE C WITH AGGREGATE FILTER		
			2							2	659	00100	2	EACH		SOIL ANALYSIS TEST		
			56							56	659	00300	56	CY		TOPSOIL		
			500							500	659	10000	500	SY		SEEDING AND MULCHING		
										0.07	659	20000	0.07	TON		COMMERCIAL FERTILIZER		
										0.1	659	31000	0.1	ACRE		LIME		
										5	659	35000	5	MGAL		WATER		
										2,000	832	30000	2,000	EACH		EROSION CONTROL		
																<b>ENVIRONMENTAL / REMEDIATION</b>		
							15			15	SPECIAL	69065016	15	TON		WORK INVOLVING PETROLEUM CONTAMINATED SOIL	3	
							505			505	SPECIAL	69065024	505	GAL		WORK INVOLVING REGULATED WATER	3	
																<b>DRAINAGE</b>		
							2.2			2.2	602	20000	2.2	CY		CONCRETE MASONRY		
							114			114	611	20700	114	FT		48" CONDUIT, TYPE A, 706.02		
																<b>PAVEMENT</b>		
										16	16	301	46000	16	CY		ASPHALT CONCRETE BASE, PG64-22	
										13	13	304	20000	13	CY		AGGREGATE BASE	
										8	8	407	10000	8	GAL		TACK COAT	
										3	3	441	50101	3	CY		ASPHALT CONCRETE SURFACE COURSE, TYPE 1, (448), AS PER PLAN (PG70-22M)	2
						5				5	617	10100	5	CY		COMPACTED AGGREGATE		
																<b>TRAFFIC CONTROL</b>		
										1	621	00100	1	EACH		RPM		
										1	621	54000	1	EACH		RAISED PAVEMENT MARKER REMOVED		
										13	630	03100	13	FT		GROUND MOUNTED SUPPORT, NO. 3 POST		
										1	630	08600	1	EACH		SIGN POST REFLECTOR		
										1	630	85100	1	EACH		REMOVAL OF GROUND MOUNTED SIGN AND REERECTION		
										1	630	86002	1	EACH		REMOVAL OF GROUND MOUNTED POST SUPPORT AND DISPOSAL		
										0.04	646	10010	0.04	MILE		EDGE LINE, 6"		
										0.01	646	10200	0.01	MILE		CENTER LINE		
																<b>MAINTENANCE OF TRAFFIC</b>		
					LS					LS	614	12420	LS			DETOUR SIGNING		
					10					10	614	13000	10	CY		ASPHALT CONCRETE FOR MAINTAINING TRAFFIC		
					0.02					0.02	614	21550	0.02	MILE		WORK ZONE CENTER LINE, CLASS III, 642 PAINT		
					0.04					0.04	614	22360	0.04	MILE		WORK ZONE EDGE LINE, CLASS III, 6", 642 PAINT		
																<b>INCIDENTALS</b>		
					LS					LS	614	11000	LS			MAINTAINING TRAFFIC		
					4					4	619	16010	4	MNTH		FIELD OFFICE, TYPE B		
											623	10000	LS			CONSTRUCTION LAYOUT STAKES AND SURVEYING		
											624	10000	LS			MOBILIZATION		

I:\ProjectData\109246\Design\Roadway\Sheets\109246\_GP001.dgn Sheet 5/13/2021 8:18:20 AM shorr\risb

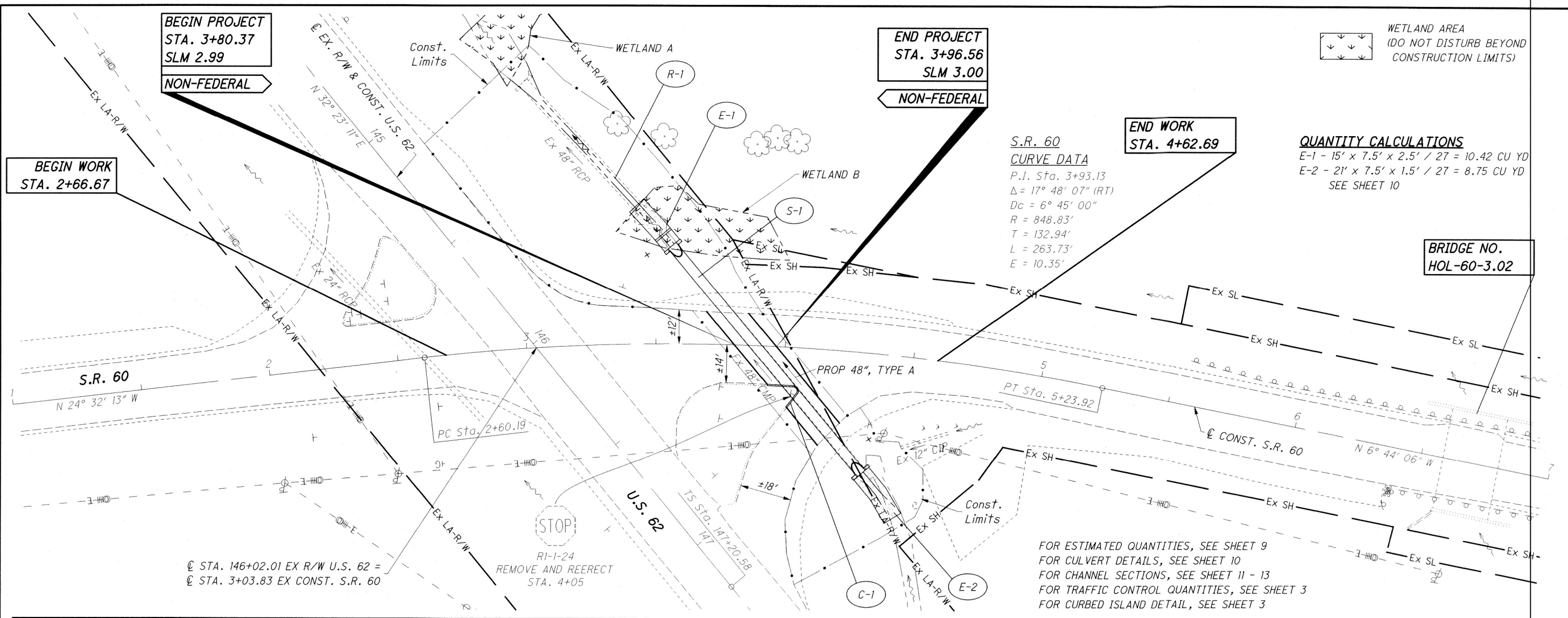

WETLAND AREA  
(DO NOT DISTURB BEYOND  
CONSTRUCTION LIMITS)

S.R. 60  
CURVE DATA  
P.I. Sta. 3+93.13  
Δ = 17° 48' 07" (RT)  
Dc = 6° 45' 00"  
R = 848.83'  
T = 132.94'  
L = 263.73'  
E = 10.35'

QUANTITY CALCULATIONS  
E-1 - 15' x 7.5' x 2.5' / 27 = 10.42 CU YD  
E-2 - 21' x 7.5' x 1.5' / 27 = 8.75 CU YD  
SEE SHEET 10

BRIDGE NO.  
HOL-60-3.02

FOR ESTIMATED QUANTITIES, SEE SHEET 9  
FOR CULVERT DETAILS, SEE SHEET 10  
FOR CHANNEL SECTIONS, SEE SHEET 11 - 13  
FOR TRAFFIC CONTROL QUANTITIES, SEE SHEET 3  
FOR CURBED ISLAND DETAIL, SEE SHEET 3

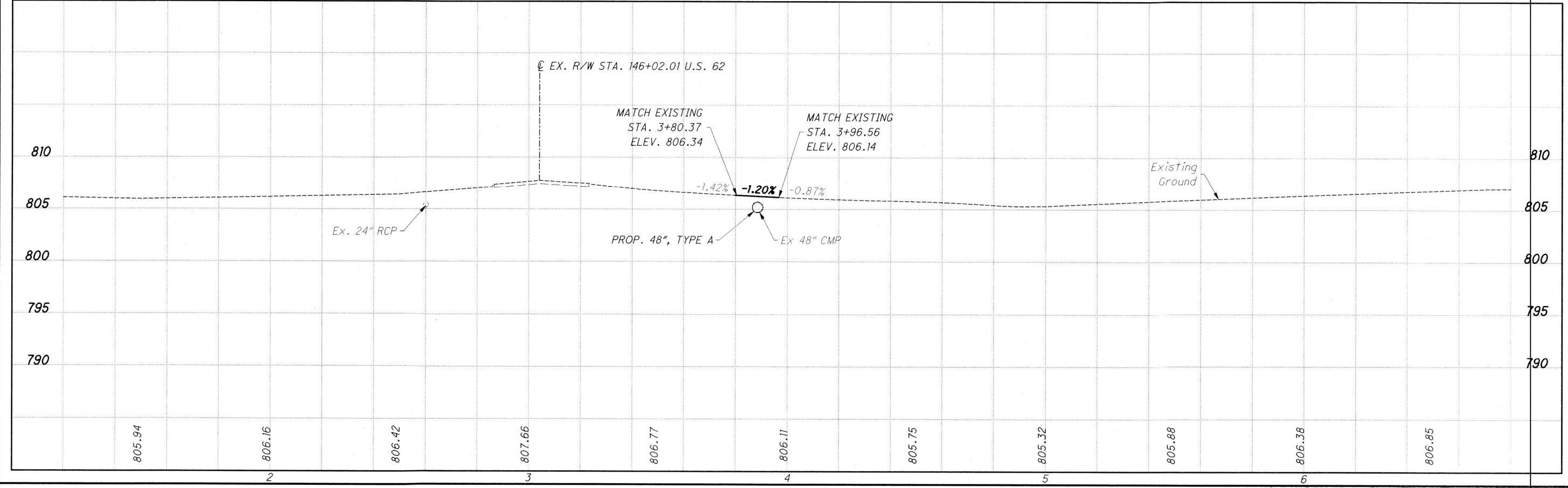

S.R. 60 - PLAN AND PROFILE  
STA. 1+00 TO STA. 7+00

HOL-60-2.99

CALCULATED	SAH	CHECKED	DAH
------------	-----	---------	-----

8  
13



I:\ProjectData\109246\Design\Roadway\Sheets\109246\_C0002.dgn Sheet 5/13/2021 8:21 AM shorr\lsb

REF. NO.	SHEET NO.	STATION		SIDE	202				601			602	609	611								
		FROM	TO					CURB REMOVED FT	PIPE REMOVED, OVER 24" FT	ROCK CHANNEL PROTECTION TYPE B WITH AGGREGATE FILTER CU YD	ROCK CHANNEL PROTECTION TYPE C WITH AGGREGATE FILTER CU YD	RIPRAP, TYPE D SQ YD	CONCRETE MASONRY CY YD	CURB, TYPE 6 FT	48" CONDUIT, TYPE A, 706.02 FT							
C-1	8	3+93.7	4+06.2	RT.			21						21									
R-1	8	3+05	3+45	LT.																		
E-1	8, 10	3+47	3+56.36	LT				10														
E-2	8, 10	4+33.88	4+49	RT					9													
S-1	8, 10	3+56.30	4+33.88	LT & RT						5	2.18											
SUBTOTAL											2.18											
<b>TOTALS CARRIED TO GENERAL SUMMARY</b>							21	180	10	9	5	2.2	21									

CALCULATED  
SAH  
CHECKED  
DAH

**ESTIMATED QUANTITIES**

**HOL -60-2.99**

9  
13



**QUANTITY CALCULATIONS**

ITEM 601, RIPRAP, TYPE D - 7.5' x 5.75' / 9 = 4.79 SQ. YD.

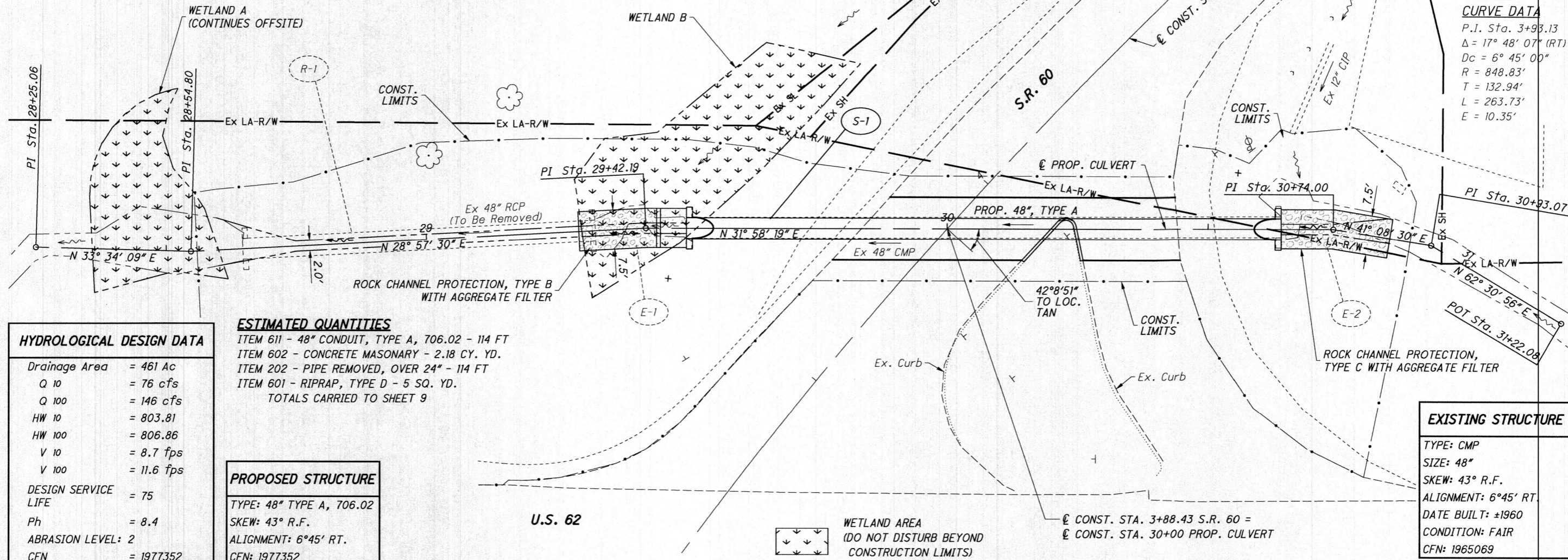

**S.R. 60 CURVE DATA**

P.I. Sta.	3+93.13
$\Delta$	17° 48' 07" (RT)
Dc	6° 45' 00"
R	848.83'
T	132.94'
L	263.73'
E	10.35'

**HYDROLOGICAL DESIGN DATA**

Drainage Area	= 461 Ac
Q 10	= 76 cfs
Q 100	= 146 cfs
HW 10	= 803.81
HW 100	= 806.86
V 10	= 8.7 fps
V 100	= 11.6 fps
DESIGN SERVICE LIFE	= 75
Ph	= 8.4
ABRASION LEVEL:	2
CFN	= 1977352

**ESTIMATED QUANTITIES**

- ITEM 611 - 48" CONDUIT, TYPE A, 706.02 - 114 FT
- ITEM 602 - CONCRETE MASONRY - 2.18 CY. YD.
- ITEM 202 - PIPE REMOVED, OVER 24" - 114 FT
- ITEM 601 - RIPRAP, TYPE D - 5 SQ. YD.
- TOTALS CARRIED TO SHEET 9

**PROPOSED STRUCTURE**

TYPE: 48" TYPE A, 706.02  
 SKEW: 43° R.F.  
 ALIGNMENT: 6°45' RT.  
 CFN: 1977352

**EXISTING STRUCTURE**

TYPE: CMP  
 SIZE: 48"  
 SKEW: 43° R.F.  
 ALIGNMENT: 6°45' RT.  
 DATE BUILT: ±1960  
 CONDITION: FAIR  
 CFN: 1965069

I:\ProjectData\109246\Design\Roadway\Sheets\109246.DC001.dgn Sheet 5/13/2021 8:18:22 AM shorr:lsb

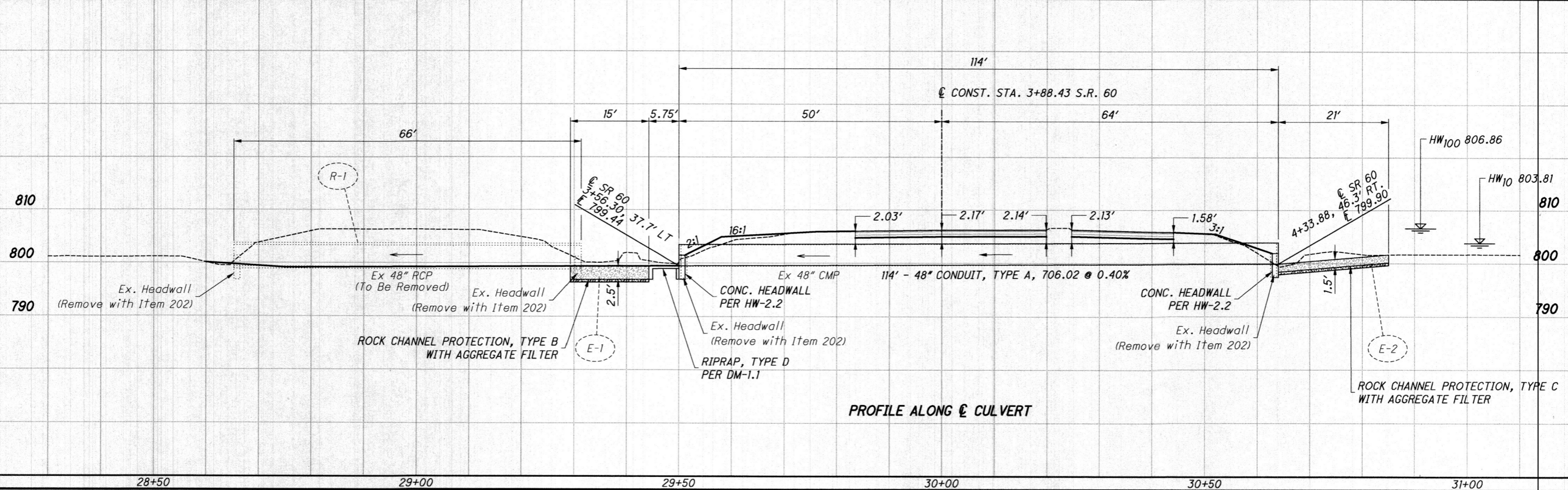

**PROFILE ALONG  $\bar{C}$  CULVERT**

CALCULATED SAH CHECKED DAH  
 HORIZONTAL SCALE IN FEET  
 1" = 20'  
 S-1 - CULVERT DETAIL  
 HOL-60-2.99  
 10/13



I:\ProjectData\109246\Design\Roadway\Sheets\109246.X5000.dgn Sheet 5/13/2021 8:18:24 AM shorrlisb

SEEDING	SO. YDS.	
	END WIDTH	
128	60	60
49	128	128
43	128	128
57	128	128
25	128	128
313	60	60

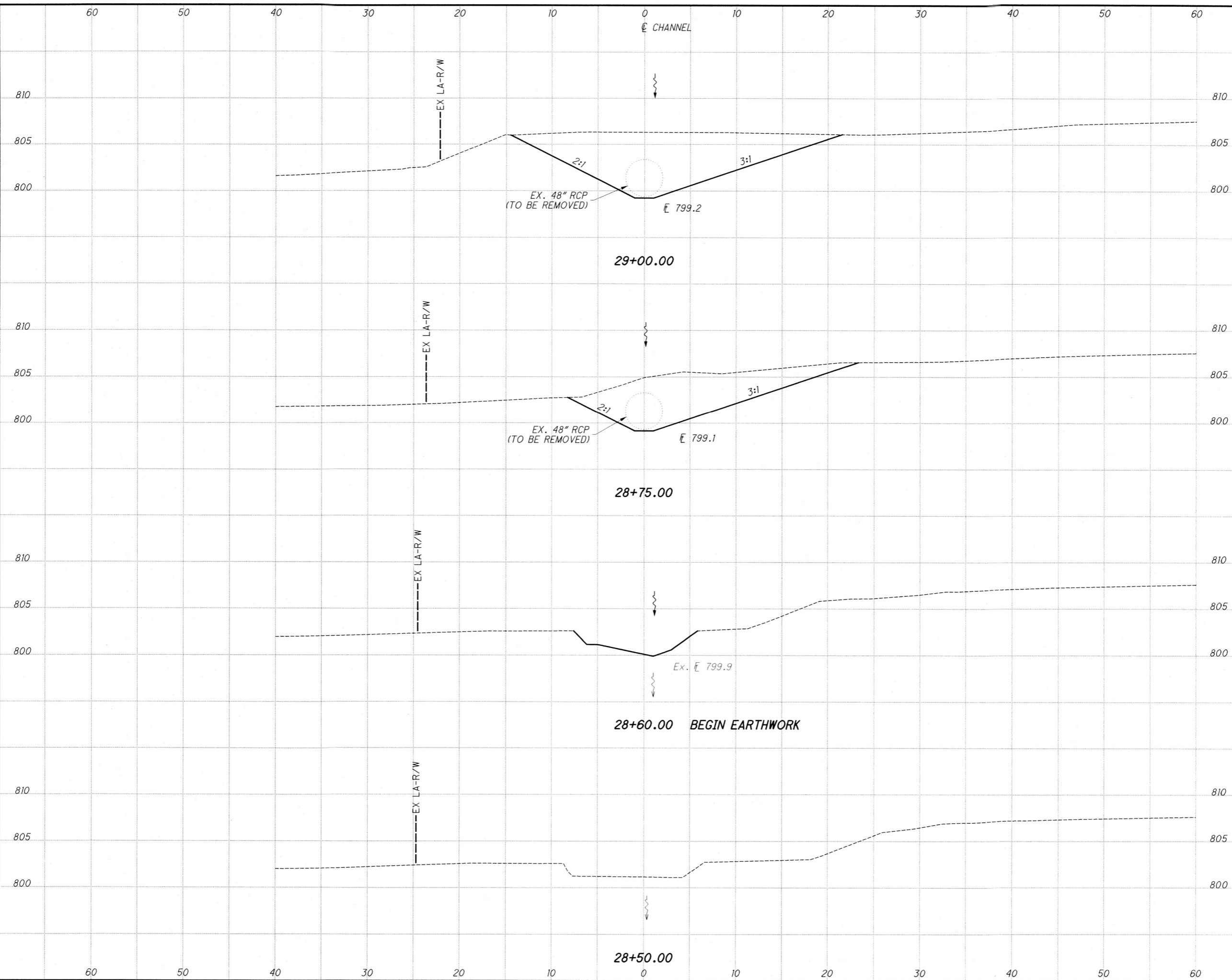

END AREA	VOLUME	
	CUT	FILL
98	0	0
136	0	0
107	0	0
96	0	0
27	0	0
0	0	0
232	0	0

CHANNEL SECTIONS  
 STA. 28+50 TO STA. 29+00  
 HOL-60-2.99  
 11  
 13



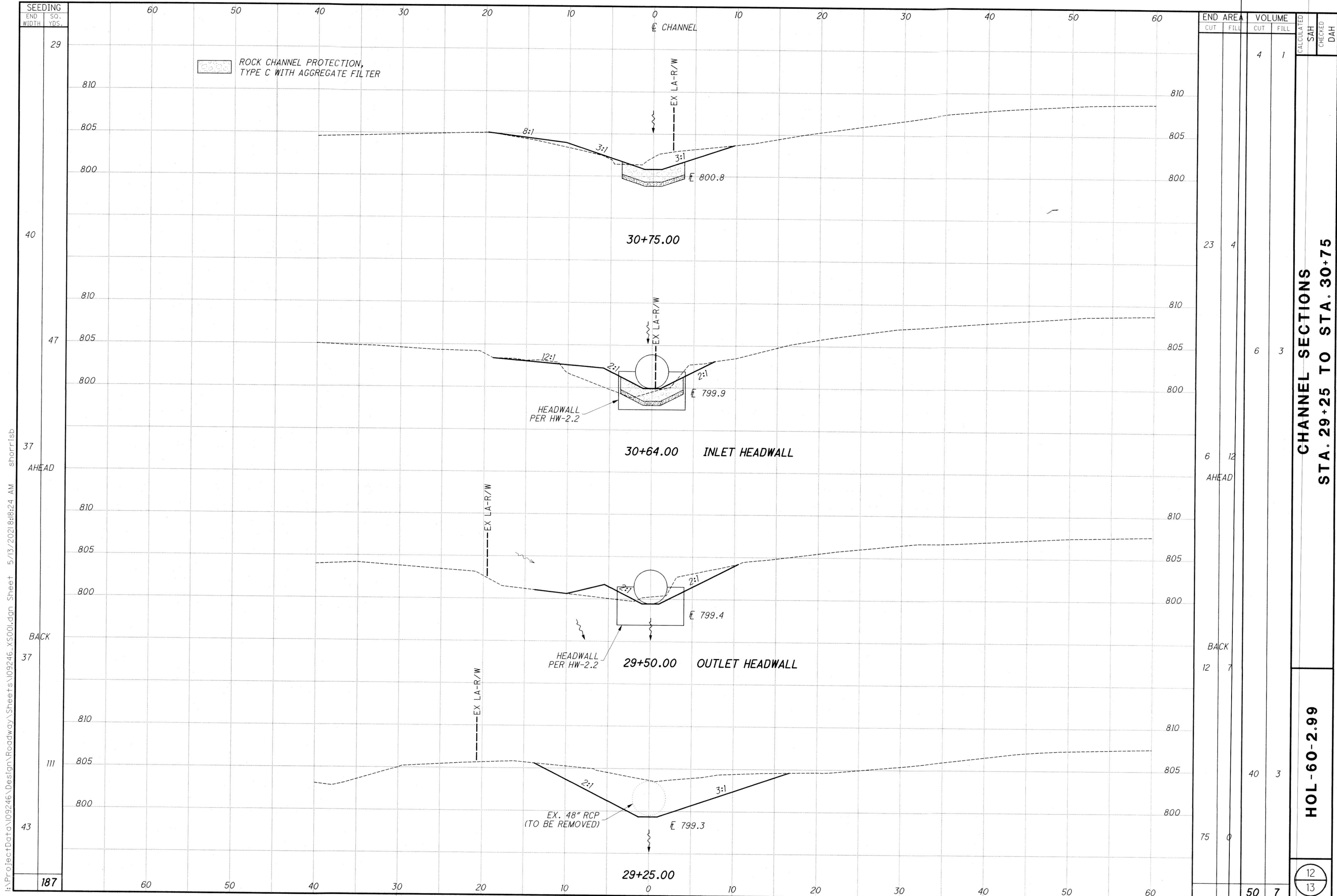

**CHANNEL SECTIONS  
STA. 29+25 TO STA. 30+75**

**HOL-60-2.99**

I:\ProjectData\109246\Design\Roadway\Sheets\109246.XS001.dgn Sheet 5/13/2021 8:18:24 AM shorr\rsb

I:\ProjectData\09246\Design\Roadway\Sheets\09246.XS001.dgn Sheet 5/13/2021 8:25 AM shorrisb

SEEDING	
END WIDTH	SO. YDS.
0	

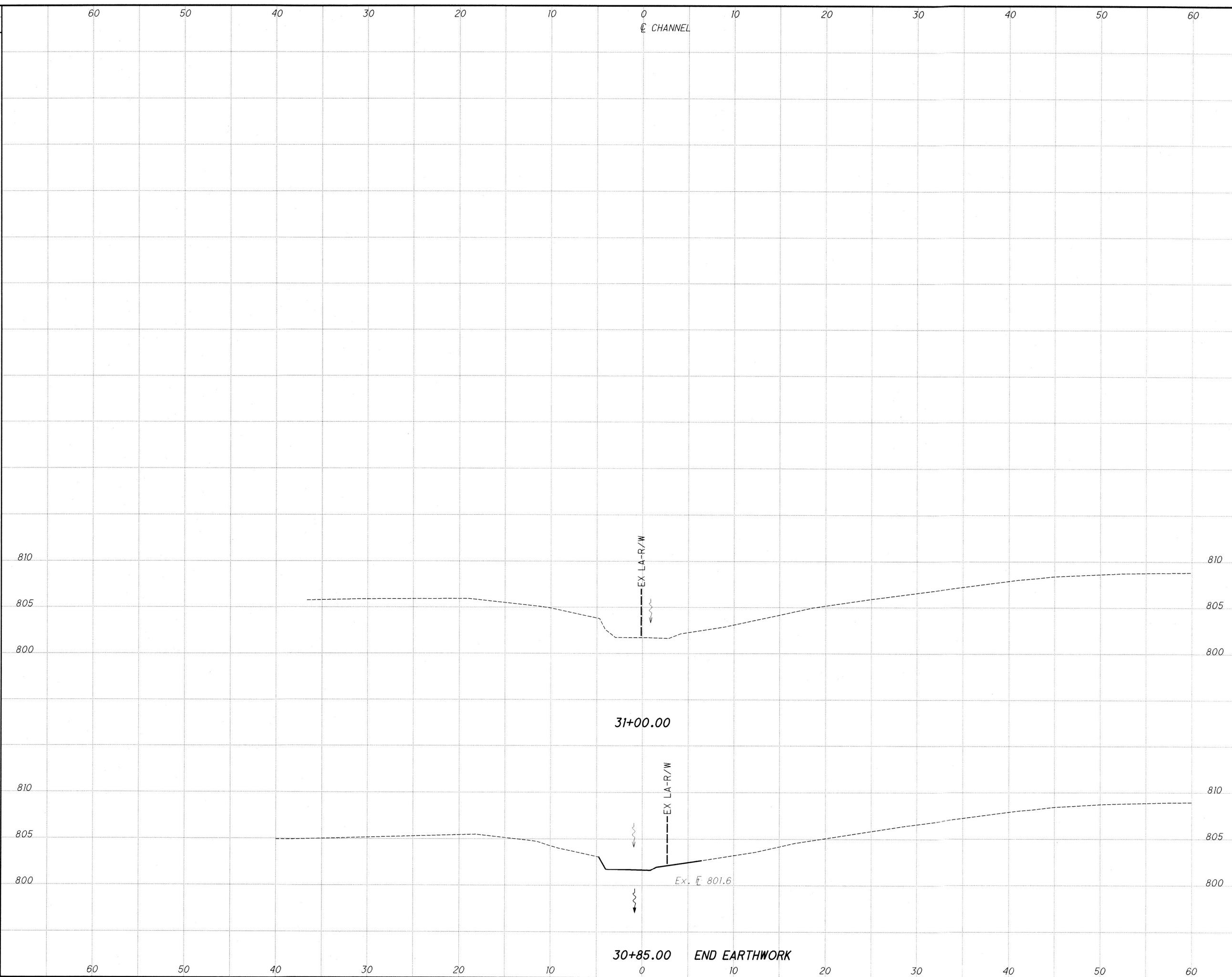

END AREA		VOLUME		CALCULATED	
CUT	FILL	CUT	FILL	SAH	DAH
0	0	0	0		

CHANNEL SECTIONS  
STA. 30+85 TO STA. 31+00

HOL-60-2.99

13  
13

# SPECIAL PROVISIONS

## WATERWAY PERMITS CONDITIONS

C-R-S: HOL-62/60-  
5.24/6.60

PID: 109013

Date: 05/26/2020

1. Waterway Permits Time Restrictions:

Regional General Permit (RGP) Section B is authorized for HOL-62/60-5.24/6.60 PID 109013. The permit is effective starting: May 26, 2020. The permit expires: October 24, 2024.

For authorized work in aquatic resources (including streams, wetlands, jurisdictional ditches, captured streams, lakes, ponds), the Department will consider the Contractor's submission of a reauthorization to the waterway permit expiration date based on project constraints. If more than one permit is authorized for the project, then all permits become invalid once the first permit expires. In order for the request to be considered, the Contractor must submit a justification to the Engineer at least 90 days prior to the waterway permit expiration date. The Engineer will submit the request for a time extension to the Ohio Department of Transportation, Office of Environmental Services, Waterway Permits Unit (ODOT-OES-WPU) for consideration and coordination with the U.S. Army Corps of Engineers (USACE), Ohio Environmental Protection Agency (OEPA), U.S. Coast Guard (USCG), U.S. Fish and Wildlife Service (USFWS), and Ohio Department of Natural Resources (ODNR) as appropriate.

2. Deviations From Permitted Construction Activities:

No deviation from the requirements for work in aquatic resources depicted in the plans, Special Provisions, and/or Working Drawings may be made unless a modification has been submitted to ODOT-OES-WPU and approved by the appropriate agencies (i.e., USACE, OEPA, USCG, ODNR, and USFWS).

For emergency situations resulting in unanticipated impacts to aquatic resources, provide notification (verbal or written) to the Engineer as soon as possible following discovery of the situation. Written notification to the Engineer and notification to the ODOT-OES-WPU (614-466-7100) must be made within 24 hours.

For non-emergency situations, notify the Engineer in writing for submission to the ODOT-OES-WPU (614-466-7100) for consideration and coordination with the appropriate agencies. Notification must be made at least 90 days prior to planned, non-permitted activities. Consideration of the requested deviation is at the discretion of the Director and must be coordinated with the appropriate regulatory agencies.

3. In-Stream Work Restrictions:

Work in the following aquatic resources is further restricted as follows:

Stream Name /Description	Location	Work restriction dates (No in-stream work permitted)
Stream 1	STA 348+38	none
Stream 2	STA 16+57	none

In-stream work has been defined as the placement and/or removal of fill materials (temporary or permanent) below ordinary high water of a stream. Examples of "fill" include, but are not limited to: bridge piers, abutments, culverts, rock channel protection, scour protection, and temporary access fills.

Fills placed within a stream identified in the above table (outside of the work restriction dates) can continue to be worked from during the work restriction dates, but cannot be expanded, removed, or otherwise modified (below ordinary high water) until once again outside of the work restriction dates.



**4. Materials:**

Materials utilized in or adjacent to aquatic resources for temporary or permanent fill or bank protection shall consist of suitable material free from toxic contaminants in other than trace quantities. Broken asphalt is specifically excluded. Chromated Copper Arsenate (CCA), creosote, and other pressure treated lumber shall not be used in structures that are placed in aquatic resources.

**5. Cultural Resources:**

Per CMS 107.10, if archeological sites, historical sites, or human remains are discovered, cease all work in the immediate area and notify the Engineer who will immediately contact the ODOT-District Environmental Coordinator and ODOT-OES-Cultural Resource Section at 614-466-7100. In the event of human remains are identified by OES-Cultural Resources Section, the Engineer shall also contact the Holmes County Sheriff's Office at 330-674-1936.

**6. Aquatic Resource Demarcation:**

The table below or attached includes detailed fill quantities authorized within the aquatic resources. Aquatic resources not authorized for impact by these Special Provisions shall be demarcated in the field as per SS 832 prior to site disturbance. The fence shall remain in place and be maintained throughout the construction process. Following the completion of the project, the fence and posts shall be removed.

Resource ID	Resource Location	Impact Location	Temporary Impact Amount	Permanent Impact Amount
Stream 1	HOL-60-6.60	STA 348+38	133 feet (0.020 acre)*	126 feet (0.018 acre)*
Stream 2	HOL-62-5.24	STA 16+57	90 feet (0.006 acre)**	69 feet (0.005 acre)**
Wetland A	HOL-60-6.60	STA 348+00	0	0.008 acre

\*Total upstream to downstream impact shall not exceed 133 feet (0.020 acre)

\*\*Total upstream to downstream impact shall not exceed 90 feet (0.006 acre)

**7. Spill containment:**

Provide and Maintain an Oil Spill Kit with a minimum capacity of 65 gallons. The Spill Kit shall contain:

- 6 - 3 in. X 8 ft. Oil only socks
- 4 - 18 in. X18 in. Oil only pillows
- 2 - 5 in. X 10ft. Booms
- 50 - 16in. X 20 in. Oil only pads
- 10- Disposable Bags
- 1 - 65 Gallon drum with lid
- 25 pounds of Granular Oil Absorbent

The Oil Spill Kit shall be located within 150 feet of any equipment working in a stream or wetland. The oil Spill Kit shall be maintained for the life of the contract. Any materials utilized during the project will be replaced within 48 hours. All costs associated with furnishing and maintaining the above referenced spill containment kit is incidental to work.

**8. Blasting:**

State law requires notification to the Ohio Department of Natural Resources should blasting be required within or near stream channels (See ORC 1533.58 & CMS 107.09). Notify the Engineer, in writing, a minimum of 30 days in advance of blasting, for submission to ODOT-OES-WPU (614-466-7100) for coordination with ODNR.

**9. Project Inspection:**

Inspection of Work may include inspection by representatives of other government agencies or railroad corporations that pay a portion of the cost of the Work or regulate the Work through State and Federal law. Comments from the representatives of these agencies shall be directed to the Engineer. Please forward a copy to ODOT-OES-WPU (614-466-7100).

**10. Temporary Access Fills:**

**Special Provisions Notes:**

**Definitions:**

**Hydraulic Opening**

The cross-sectional area allowing an unimpeded discharge equal to twice the highest monthly flow without producing a rise in the backwater above the Ordinary High Water Mark (OHWM).

**Standard Temporary Discharge**

Discharge equal to twice the *highest monthly flow* without producing a rise in the backwater above the OHWM. The U.S. Geologic Service publication "Techniques for estimating Selected Streamflow Characteristics of Rural Unregulated Streams in Ohio" provides equations that estimate monthly flow for Ohio Waterways These flows are also available in a web application by USGS StreamStats, (<https://water.usgs.gov/osw/streamstats/ohio.html>).

**Average Monthly Flow**

The average monthly flow represents the estimated "normal" flow.

**Temporary Access Fills (TAFs)**

Include, but are not limited to, dewatering fills, causeways, cofferdams, access pads, temporary bridges, etc. below the OHWM.

**Requirements**

21 calendar days prior to the initiation of any in-stream work, provide the Engineer with Working Drawings that include:

- Plan view drawing (50 scale or less) showing the location of all TAFs proposed for use on the project
- Scaled cross section and profile drawing showing the OHWM and the proposed hydraulic opening.
- Calculations analyzing the hydraulic impacts of the TAF on the waterway. Include in the calculations an analysis of the hydraulic opening sized adequately to pass the Standard Temporary Discharge without producing a rise in backwater above the OHWM. Include, in the analysis, calculated channel velocities adjacent to the TAF, culvert exit velocities, calculated headwater and tailwater elevations, and any additional appropriate calculations to assess potential impacts to the waterway during normal and anticipated high flow (twice the highest monthly flow) events.

- A description of all temporary material to be placed below the OHWM elevation.
- A description of the installation and staging of all temporary fill over the life of the contract.
- Volume of temporary fill below the OHWM elevation.
- A description of the diversion ditches, equipment, conduits or means for maintaining normal flows in the waterway.
- A description of the removal of all temporary fill and restoration of the channel and all areas impacted by the TAFs.
- A schedule outlining the timing of the placement and removal of all temporary fill.
- Have competent individuals prepare and check the Working Drawings and hydraulic calculations. Provide a cover sheet containing the preparer(s) and checker(s): First Name, Last Name and Initials. The preparer(s) and checker(s) shall not be the same individual. Have an Ohio Registered Engineer review, approve, sign, seal and date the Working Drawings and hydraulic calculations according to ORC 4733 and OAC 4733-35. Include the following statement on the Working Drawings: "These Working Drawings were prepared in compliance with the terms of these Special Provisions and all contract documents."

Do not begin in-stream work until the Engineer has accepted the Working Drawings and hydraulic calculations.

The design of the Contractor's TAF must minimize impacts to water bodies, stream banks, stream beds, and riparian zones to the maximum extent practicable.

Fording of waterways and other aquatic resources is prohibited.

Construct TAFs in such a manner that will maintain flows, minimize upstream flooding, and avoid overtopping the TAF on a regular basis. ***TAFs shall be designed and constructed so that the hydraulic opening provides capacity for a discharge equal to twice the highest monthly flow without producing a rise in the backwater above the (OHWM).***

If the Contractor proposes a TAF which does not meet all the requirements of these Special Provisions, the Contractor must submit a request in writing for a modified TAF to the Engineer. The request must include all Working Drawings and hydraulic calculations required by these Special Provisions. The Department makes no guarantee to grant the request. The Contractor's proposed TAF request will be coordinated by OES with the USACE and the OEPA, as appropriate. The time frame allowed for the coordination of the contractor's proposed TAF will be a minimum of 60 days.

Installation of any temporary fill without appropriate authorization is strictly prohibited. All direct coordination with the USACE and/or OEPA will be performed through OES.

#### TAFs Construction and Payment

Begin planning and installing causeways and access fills as early in construction as possible to avoid conflicts with these Special Provisions or other environmental commitments that have been included in the construction plans.

TAFs in Streams and Rivers may include, but are not limited to, causeways, cofferdams, access pads, sheet piling, temporary bridges, etc. The Contractor must make every attempt to minimize disturbance to waterbodies, stream banks, stream beds and riparian zones during the construction, maintenance, and removal of the TAF. Construct the TAFs as narrow as practical. Install in-stream conduits parallel to the stream banks. Make the TAFs in shallow areas rather than deep pools where possible. Minimize clearing, grubbing, and excavation of stream banks, and approach sections. Construct the TAFs as to not cause erosion or allow sediment deposits in the waterway.

Prior to the initiation of any in-stream work, establish a monument upstream of the proposed TAF to

visually monitor the water elevation in the waterway where the fill is permitted. Maintain the monument throughout the project. Provide a visual mark on the monument that identifies the elevation 1 foot above the OHWM. Ensure that the monument can be read from the bank of the waterway. Have this elevation set and certified by an Ohio Registered Surveyor. All costs associated with furnishing and maintaining the above referenced monument is incidental to the work.

Should the surface water elevation exceed the elevation 1 foot above OHWM, the Department will compensate the Contractor for repair of any resulting damage to the TAF up to the elevation of 1 foot above the OHWM, except as noted. The Department will recognize this event as an excusable, non-compensable delay in accordance with Section 108.06 B. of the Construction & Materials Specifications.

Follow the requirements in Item 502 for Structures for Maintaining Traffic and in Item 503 for Cofferdams and Excavation Bracing and any modifications to these items as shown in the plans. The Department will not pay for repair and maintenance of TAFs associated with Items 502 and 503 as a result of surface water elevation exceeding 1 foot above the OHWM. Compensation for damages associated with waterway flows will be provided as described in Items 502 and 503.

Construct the TAFs, not including Items 502 and 503, to a water elevation at least 1 foot (0.3 m) above the OHWM. If more than one-third the width of the stream is filled, then use culvert pipes to allow the movement of aquatic life. Ensure that any ponding of water behind the TAF will not damage property, flood roadways, or threaten human health and safety.

The following minimum requirements apply to TAFs where culverts are used.

- Furnish culverts on the existing stream bottom.
- Avoid a drop in water elevation at the downstream end of the culvert that would result in an adverse impact to the waterway.
- Furnish a sufficient number of culverts in addition to stream openings to provide a discharge equal to twice the highest monthly flow without producing a rise in the backwater above the OHWM.
- Furnish culverts with a minimum diameter of 18 inches (0.5 m).

All TAFs must be constructed of suitable materials. Causeways and access fills must be encapsulated with clean, non-erodible, nontoxic Dumped Rock Fill, Type A, B, C, or D, as specified in C&MS 703.19.B. Extend rock fill up the slope from original stream bank for 50 feet (10 m) to catch and remove erodible material from equipment.

When the work requiring TAF is complete, all portions of the TAF (including all rock and culverts) will be removed in its entirety. Do not dispose of TAF material in other aquatic resources or where erosion into another aquatic resource is possible. The stream bottom affected by the TAFs will be restored to its pre-construction elevations. The TAFs will not be paid as a separate item but will be included by the Contractor as part of the total project cost.

Unless specific TAF compensation is included in the plans, all environmental protection and control associated with the authorized activities, are incidental to the work within the boundaries of the aquatic resources.

#### 11. Excavation Activities:

Excavated material will be placed at an upland site and disposed of in such a manner that sediment and runoff to streams and other aquatic resources is controlled and minimized. Additionally, no more than incidental fallback into jurisdictional waters of the U.S. is permitted during the excavation process. If any changes to the proposed work are deemed necessary, you must notify and coordinate with the ODOT-OES-WPU (614-466-7100).



**12. Demolition Debris:**

The temporary discharge of demolition debris into aquatic resources (including but not limited to bridges, culverts, abutments, wing walls, piers) is conditionally authorized for this project. Perform demolition activities in a manner to prevent the discharge of fine (erodible) debris into aquatic resources. Utilize TAF or other catchment methods accepted by the Engineer and authorized by these Special Provisions to prevent erodible demolition debris from entering aquatic resources. Demolition debris may not remain in the waterway for more than 72 hours and must be removed in its entirety. If removal of debris material cannot be achieved within 72 hours, notify the Engineer in writing and contact ODOT-OES-WPU at 614-466-7100.

Version: 2019

# **SPECIAL PROVISIONS**

---

---

## **WATERWAY PERMITS CONDITIONS**

**C-R-S: HOL-60-2.99**

**PID: 109246**

**Date: 11/16/20**



**1. Waterway Permits Time Restrictions:**

Regional General Permit (RGP) Section B (Maintenance) is authorized for HOL-60-2.99, PID 109246. A copy of the RGP and authorization letter (ID LRH-2020-00737-WAL - UNT Killbuck Creek) shall be kept at the work site at all times and made available to all contractors and subcontractors. The permit is effective starting: **November 16, 2020**. The permit expires: **October 24, 2024**.

For authorized work in aquatic resources (including streams, wetlands, jurisdictional ditches, captured streams, lakes, ponds), the Department will consider the Contractor's submission of a reauthorization to the waterway permit expiration date based on project constraints. If more than one permit is authorized for the project, then all permits become invalid once the first permit expires. In order for the request to be considered, the Contractor must submit a justification to the Engineer at least 90 days prior to the waterway permit expiration date. The Engineer will submit the request for a time extension to the Ohio Department of Transportation, Office of Environmental Services, Waterway Permits Unit (ODOT-OES-WPU) for consideration and coordination with the U.S. Army Corps of Engineers (USACE), Ohio Environmental Protection Agency (OEPA), U.S. Coast Guard (USCG), U.S. Fish and Wildlife Service (USFWS), and Ohio Department of Natural Resources (ODNR) as appropriate.

**2. Deviations From Permitted Construction Activities:**

No deviation from the requirements for work in aquatic resources depicted in the plans, Special Provisions, and/or Working Drawings may be made unless a modification has been submitted to ODOT-OES-WPU and approved by the appropriate agencies (i.e., USACE, OEPA, USCG, ODNR, and USFWS).

NOTE: Plan sheets submitted with the Pre-Construction Notification were approved by the USACE in accordance with RGP and are included in these Special Provisions.

For emergency situations resulting in unanticipated impacts to aquatic resources, provide notification (verbal or written) to the Engineer as soon as possible following discovery of the situation. Written notification to the Engineer and notification to the ODOT-OES-WPU (614-466-2159) must be made within 24 hours.

For non-emergency situations, notify the Engineer in writing for submission to the ODOT-OES-WPU (614-466-2159) for consideration and coordination with the appropriate agencies. Notification must be made at least 90 days prior to planned, non-permitted activities. Consideration of the requested deviation is at the discretion of the Director and must be coordinated with the appropriate regulatory agencies.

**3. In-Stream Work Restrictions:**

Work in the following aquatic resources is further restricted as follows:

Stream Name /Description	Location	Work restriction dates (No in-stream work permitted)
None	STA	None

In-stream work has been defined as the placement and/or removal of fill materials (temporary or permanent) below ordinary high water of a stream. Examples of "fill" include, but are not limited to: bridge piers, abutments, culverts, rock channel protection, scour protection, and temporary access fills.

Fills placed within a stream identified in the above table (outside of the work restriction dates) can continue to be worked from during the work restriction dates, but cannot be expanded, removed, or otherwise modified (below ordinary high water) until once again outside of the work restriction dates.

**4. Materials:**

Materials utilized in or adjacent to aquatic resources for permanent fill or bank protection shall consist of suitable material free from toxic contaminants in other than trace quantities. Asphalt products are specifically excluded for use as fill. Chromated Copper Arsenate (CCA), creosote, and other pressure treated lumber shall not be used in structures that are placed in aquatic resources.

**5. Cultural Resources:**

Per CMS 107.10, if archeological sites, historical sites, or human remains are discovered, cease all work in the immediate area and notify the Engineer who will immediately contact the ODOT-District Environmental Coordinator and ODOT-OES-Cultural Resource Section at 614-466-2159. In the event of human remains are identified by OES-Cultural Resources Section, the Engineer shall also contact the Holmes County Sheriff's Office at (330) 674-1936.

**6. Aquatic Resource Demarcation:**

The attached Table D includes detailed fill quantities authorized within the aquatic resources. Aquatic resources not authorized for impact by these Special Provisions shall be demarcated in the field as per SS 832 prior to site disturbance. The fence shall remain in place and be maintained throughout the construction process. Following the completion of the project, the fence and posts shall be removed.



**7. Spill containment:**

Provide and Maintain an Oil Spill Kit with a minimum capacity of 65 gallons. The Spill Kit shall contain:

- 6 - 3 in. X 8 ft. Oil only socks
- 4 - 18 in. X18 in. Oil only pillows
- 2 - 5 in. X 10ft. Booms
- 50 - 16in. X 20 in. Oil only pads
- 10- Disposable Bags
- 1 - 65 Gallon drum with lid
- 25 pounds of Granular Oil Absorbent

The Oil Spill Kit shall be located within 150 feet of any equipment working in a stream or wetland. The oil Spill Kit shall be maintained for the life of the contract. Any materials utilized during the project will be replaced within 48 hours. All costs associated with furnishing and maintaining the above referenced spill containment kit is incidental to work.

**8. Blasting:**

State law requires notification to the Ohio Department of Natural Resources should blasting be required within or near stream channels (See ORC 1533.58 & CMS 107.09). Notify the Engineer, in writing, a minimum of 30 days in advance of blasting, for submission to ODOT-OES-WPU (614-466-2159) for coordination with ODNR.

**9. Project Inspection:**

Inspection of Work may include inspection by representatives of other government agencies or railroad corporations that pay a portion of the cost of the Work or regulate the Work through State and Federal law. Comments from the representatives of these agencies shall be directed to the Engineer. Please forward a copy to ODOT-OES-WPU (614-466-2159).

**10. Temporary Fill Activities:**

Temporary fill in aquatic resources is not authorized for this project. Temporary fill includes, but is not limited to, causeways, work pads, cofferdams, sheet piling, temporary bridges, and construction equipment. Any unauthorized temporary impacts that occur will be in violation of Section 404 and 401 of the Clean Water Act.

**11. Excavation Activities:**

Excavated material will be placed at an upland site and disposed of in such a manner that sediment and runoff to streams and other aquatic resources is controlled and minimized. Additionally, no more than incidental fallback into jurisdictional waters of the U.S. is permitted during the excavation process. If any changes to the proposed work are deemed necessary,

Notify the Engineer who will immediately contact the ODOT-District Environmental Coordinator and ODOT-OES-WPU (614-466-2159).

**12. Demolition Debris:**

The temporary discharge of demolition debris into aquatic resources (including but not limited to bridges, culverts, abutments, wing walls, piers) is conditionally authorized for this project. Perform demolition activities in a manner to prevent the discharge of fine (erodible) debris into aquatic resources. Utilize TAF or other catchment methods accepted by the Engineer and authorized by these Special Provisions to prevent erodible demolition debris from entering aquatic resources. Demolition debris may not remain in the waterway for more than 72 hours and must be removed in its entirety. If removal of debris material cannot be achieved within 72 hours, notify the Engineer in writing and contact ODOT-OES-WPU at 614-466-2159.

**13. Construction Completion Certification:**

Upon completion of the work, notify the Engineer. The USACE Construction Completion Certification must be completed and signed by the Engineer then provided via US mail or email to:

Waterway Permits Program Manager  
 ODOT - Office of Environmental Services  
 1980 West Broad Street, Mail Stop 4170  
 Columbus, Ohio 43223  
 Adrienne.Earley@dot.ohio.gov

A copy of the certification has been attached to these Special Provisions.

Version: 2020



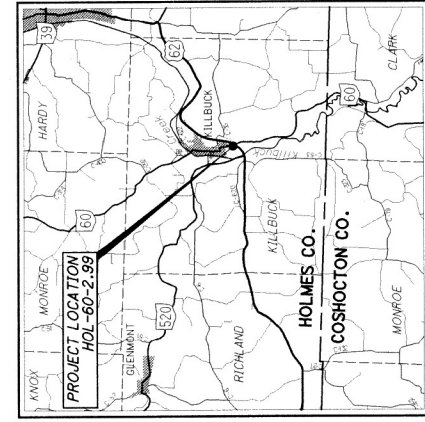

LATITUDE: 40°29'01" N LONGITUDE: 81°58'55" W



- PORTION TO BE IMPROVED..... 650
- INTERSTATE HIGHWAY..... 700
- FEDERAL ROUTES..... 70
- STATE ROUTES..... 56%
- COUNTY & TOWNSHIP ROADS..... 8%
- DESIGN YEAR ADT (2022)..... 650
- DESIGN YEAR ADT (2042)..... 700
- DESIGN HOURLY VOLUME (2042)..... 70
- DIRECTIONAL DISTRIBUTION..... 56%
- TRUCKS (24 HOUR 85C)..... 8%
- DESIGN SPEED..... 55 MPH
- LEGAL SPEED..... 55 MPH
- DESIGN FUNCTIONAL CLASSIFICATION: RURAL MINOR COLLECTOR
- NHS PROJECT..... NO

**DESIGN EXCEPTIONS**  
NONE

**UNDERGROUND UTILITIES**  
Contact Two Working Days Before You Dig

OHIO811, 8-1-1, or 1-800-382-2744  
(Non-members must be called directly)

PLAN PREPARED BY:  
OHIO DEPARTMENT OF TRANSPORTATION  
DISTRICT II ENGINEERING  
NEW PHILADELPHIA, OHIO

STATE OF OHIO  
DEPARTMENT OF TRANSPORTATION  
**HOL-60-2.99**  
**PART 2**  
KILLBUCK TOWNSHIP  
HOLMES COUNTY

FOR PART 1, SEE HOL-62/60-5.24/6.60  
(PID 109013)

**INDEX OF SHEETS:**  
TITLE SHEET  
GENERAL NOTES  
MAINTENANCE OF TRAFFIC  
GENERAL SUMMARY PROFILE  
CULVERT DETAILS  
CHANNEL SECTIONS  
RIGHT-OF-WAY

**STAGE 2 SUBMISSION**  
**MARCH 2020**

STANDARD CONSTRUCTION DRAWINGS	SUPPLEMENTAL SPECIFICATIONS	SPECIAL PROVISIONS
<b>SEE PART 1</b>		

ENGINEERS SEAL:

SIGNED: \_\_\_\_\_  
DATE: \_\_\_\_\_

(1)	HOL-60-2.99	RAILROAD INVOLVEMENT	NONE	CONSTRUCTION PROJECT NO.	109246	FEDERAL PROJECT NO.	NON-FEDERAL
-----	-------------	----------------------	------	--------------------------	--------	---------------------	-------------

**PROJECT DESCRIPTION**  
IMPROVEMENT OF 0.01 MILES (1171') OF S.R. 60 BY REPLACING AN EXISTING 48" CMP CULVERT WITH A NEW 48" CULVERT INCLUDING REMOVAL OF ADJACENT 48" RCP CULVERT AND CHANNEL GRADING.

**EARTH DISTURBED AREAS**  
PROJECT EARTH DISTURBED AREA: N/A  
ESTIMATED CONTRACTOR EARTH DISTURBED AREA: N/A  
NOTICE OF INTENT EARTH DISTURBED AREA: N/A  
\* - (MAINTENANCE PROJECT)

**2019 SPECIFICATIONS**  
THE STANDARD SPECIFICATIONS OF THE STATE OF OHIO, DEPARTMENT OF TRANSPORTATION, INCLUDING SUPPLEMENTAL SPECIFICATIONS LISTED IN THE PLANS AND CHANGES LISTED IN THE PROPOSAL SHALL GOVERN THIS IMPROVEMENT.

I HEREBY APPROVE THESE PLANS AND DECLARE THAT THE MAKING OF THIS IMPROVEMENT WILL REQUIRE THE CLOSING TO TRAFFIC OF THE HIGHWAY AND THAT DETOURS WILL BE PROVIDED AS INDICATED ON SHEET \_\_\_\_\_.

APPROVED DATE: \_\_\_\_\_ DISTRICT DEPUTY DIRECTOR

APPROVED DATE: \_\_\_\_\_ DIRECTOR, DEPARTMENT OF TRANSPORTATION

**UTILITIES**

LISTED BELOW ARE ALL UTILITIES LOCATED WITHIN THE PROJECT CONSTRUCTION LIMITS TOGETHER WITH THEIR RESPECTIVE OWNERS:

- ASPRE ENERGY  
300 TRACY BRIDGE ROAD  
GRYVILLE, OHIO 44667  
PHONE: 330-682-1634  
CONTACT: JOHN CRAMER
- AT&T LEGACY  
5980-G WILCOX PLACE  
DUBLIN, OHIO 43016  
PHONE: 614-216-1160  
CONTACT: BEFF BALLINGER
- DIVERSIFIED OIL AND GAS  
1026 COOKSON AVENUE SE  
NEW PHILADELPHIA, OHIO 44663  
PHONE: 224-523-8641  
CONTACT: CHRIS BELCH
- GENIUSLINK CORPORATION  
ATTN: JEFFREY SCHOONOVER  
2025 AKRON ROAD  
WOOSTER, OHIO 44891  
330-762-1128
- HOLMES-WAYNE ELECTRIC COOPERATIVE  
6060 STATE ROUTE 39  
MILLERSBURG, OHIO 44654  
PHONE: 330-674-1055  
CONTACT: TIM VICKERS
- VILLAGE OF KILLBUCK  
131 SOUTH MAIN STREET  
KILLBUCK, OHIO 44637  
PHONE: 330-276-4803  
CONTACT: BERRY W. HAHN, MAYOR

THE LOCATION OF THE UNDERGROUND UTILITIES SHOWN ON THE PLANS ARE AS OBTAINED FROM THE OWNERS AS REQUIRED BY SECTION 153.64 O.R.C.

**CLEARING AND GRUBBING**

ALTHOUGH THERE ARE NO TREES OR STUMPS SPECIFICALLY MARKED FOR REMOVAL WITHIN THE LIMITS OF THE PROJECT, A LUMP SUM QUANTITY IS INCLUDED IN THE GENERAL SUMMARY FOR ITEM 201, CLEARING AND GRUBBING. ALL TREE REMOVALS ARE TO BE PERFORMED BY THE CONTRACTOR. THE QUANTITY OF TREE REMOVALS IS INCLUDED IN THE LUMP SUM PRICE BID FOR ITEM 201, CLEARING AND GRUBBING.

**EXISTING PLANS**

THE FOLLOWING EXISTING PLANS ARE AVAILABLE FOR REFERENCE AT THE DISTRICT OFFICE, OHIO DEPARTMENT OF TRANSPORTATION, 2601 REISER AVE., S.E., NEW PHILADELPHIA, OHIO, 44663:

ORIGINAL CONSTRUCTION  
HOL-62-10.00-14.10

IN ADDITION, THE EXISTING PLANS CAN BE FOUND ON THE DEPARTMENT'S WEBSITE AT THE FOLLOWING ADDRESS:

<https://www.dot.state.oh.us/pub/contracts/otftech>

**WORK LIMITS**

THE WORK LIMITS SHOWN ON THESE PLANS ARE FOR PHYSICAL CONSTRUCTION ONLY. PROVIDE TRAFFIC CONTROL AND WORK ZONE TRAFFIC CONTROL DEVICES REQUIRED BY THESE PLANS WHETHER INSIDE OR OUTSIDE THESE WORK LIMITS.

**ITEM 441 - ASPHALT CONCRETE SURFACE COURSE, TYPE I (448), AS PER PLAN, (PG70-22M)**

FOLLOW SPECIFICATION 703.05 EXCEPT DO NOT USE COARSE AGGREGATE FROM A SOURCE DESIGNATED "SR" OR "SRH" ACCORDING TO THE OFFICE OF MATERIALS MANAGEMENT (OMM) IN ANY JOB MIX FORMULA (JMF) FOR THIS ITEM.

**SURVEYING PARAMETERS**

PRIMARY PROJECT CONTROL MONUMENTS GOVERN ALL POSITIONING ON ODOT PROJECTS. SEE SHEET 8X OF THE PLANS FOR A TABLE CONTAINING PROJECT CONTROL INFORMATION.

USE THE FOLLOWING PROJECT CONTROL, VERTICAL POSITIONING, AND HORIZONTAL POSITIONING PARAMETERS FOR ALL SURVEYING:

PROJECT CONTROL  
POSITIONING METHOD: ODOT VRS  
MONUMENT TYPE: TYPE 4

VERTICAL POSITIONING  
ORTHOMETRIC HEIGHT DATUM: NAVD 88  
GEOD: GEOD 12B

HORIZONTAL POSITIONING  
REFERENCE FRAME: MAD 83 (2011)  
ELLIPSOID: GRS 1980

MAP PROJECTION: LAMBERT CONFORMAL CONIC  
COORDINATE SYSTEM: OHIO STATE PLANE, NORTH ZONE  
COMBINED SCALE FACTOR: 1.0000429494951  
ORIGIN OF COORDINATE SYSTEM:  
N 298663.957  
E 212770.956

USE THE POSITIONING METHODS AND MONUMENT TYPE USED IN THE ORIGINAL SURVEY TO RESTORE ALL MONUMENTS RELATED TO PRIMARY PROJECT CONTROL THAT ARE DAMAGED OR DESTROYED BY CONSTRUCTION ACTIVITIES. RESTORE THE DAMAGED OR DESTROYED MONUMENTS IN ACCORDANCE WITH C&G 621.

UNITS ARE IN U.S. SURVEY FEET.

**AIRWAY/HIGHWAY CLEARANCE FOR AIRPORTS AND HELIPORTS**

THIS PROJECT HAS BEEN IDENTIFIED AS BEING WITHIN THE INFLUENCE AREA OF A PUBLIC USE AIRPORT OR HELIPORT. NO TEMPORARY STRUCTURES OR CONSTRUCTION EQUIPMENT AT MAXIMUM OPERATING HEIGHT SHALL EXCEED A HEIGHT OF --- FT. IF ANY TEMPORARY STRUCTURES OR CONSTRUCTION EQUIPMENT WILL EXCEED THIS HEIGHT, FURTHER COORDINATION WITH THE FEDERAL AVIATION ADMINISTRATION (FAA), AND ODOT OFFICE OF AVIATION, WILL BE NECESSARY PRIOR TO ERECTING SUCH TEMPORARY STRUCTURES OR OPERATING SUCH EQUIPMENT ON THE PROJECT. THE CONTRACTOR WILL BE REQUIRED TO SUBMIT FORM 7460-1 TO THE FAA, NOTIFY THE ODOT OFFICE OF AVIATION WHEN SUBMITTING FAA FORM 7460-1.

NO TEMPORARY STRUCTURES OR CONSTRUCTION EQUIPMENT SHALL EXCEED THE PERMISSIBLE HEIGHT, UNTIL A COPY OF THE FAA APPROVAL AND THE ODOT OFFICE OF AVIATION PERMIT HAS BEEN FURNISHED TO THE PROJECT ENGINEER.

EXPRESS PROCESSING CENTER  
THE FEDERAL AVIATION ADMINISTRATION  
SOUTHWEST REGIONAL OFFICE  
AIR TRAFFIC AIRSPACE BRANCH 45W-520  
2601 MEACHAM BLVD.  
FORT WORTH, TX 76137-4298

OHIO DEPARTMENT OF TRANSPORTATION  
OFFICE OF AVIATION  
2029 WEST DUBLIN/MAINVILLE ROAD  
COLUMBUS, OHIO 43235  
614-387-2346

**ENDANGERED BAT HABITAT REMOVAL**

THE PROJECT IS LOCATED WITHIN THE KNOWN HABITAT RANGES OF THE FEDERALLY LISTED AND PROTECTED INDIANA BAT AND NORTHERN LONG-EARED BAT. THE ODOT COUNTY MAINTENANCE FORCES SHALL NOT REMOVE TREES UNDER THIS PROJECT FROM APRIL 1 THROUGH SEPTEMBER 30. ALL NECESSARY TREE REMOVAL SHALL OCCUR FROM OCTOBER 1 THROUGH MARCH 31. THE ODOT COUNTY MAINTENANCE FORCES SHALL DEMARKATE CLEARING LIMITS IN THE FIELD TO AVOID ANY UNAUTHORIZED TREE CLEARING. THIS PROJECT IS NOT A NECESSARY TREE REMOVAL PROJECT. THESE SPECIES AS REQUIRED BY THE ENDANGERED SPECIES ACT. FOR THE PURPOSES OF THIS NOTE, A TREE IS DEFINED AS A LIVE, DYING, OR DEAD WOODY PLANT, WITH A TRUNK THREE INCHES OR GREATER IN DIAMETER AT A HEIGHT OF 4.5 FEET ABOVE THE GROUND SURFACE, AND WITH A MINIMUM HEIGHT OF 13 FEET.

(2)	HOL-60-2.99	GENERAL NOTES
-----	-------------	---------------



HYM  
CHECKED  
SMH  
DATE

**GENERAL NOTES**

HOL-60-2.99

10

**ITEM 659 - SEEDING AND MULCHING**

THE FOLLOWING QUANTITIES ARE PROVIDED TO PROMOTE GROWTH AND CARE OF PERMANENT SEEDED AREAS:

659. SOIL ANALYSIS TEST ----- EACH  
 659. TOPSOIL ----- CU. YD.  
 659. SEEDING AND MULCHING ----- SO. YD.  
 659. REPAIR SEEDING AND MULCHING ----- SO. YD.  
 659. INTER-SEEDING ----- SO. YD.  
 659. COMMERCIAL FERTILIZER ----- TON  
 659. LIME ----- ACRES  
 659. WATER ----- M. GAL.

SEEDING AND MULCHING SHALL BE APPLIED TO ALL AREAS OF EXPOSED SOIL BETWEEN THE RIGHT-OF-WAY LINES, AND WITHIN THE CONSTRUCTION LIMITS FOR AREAS OUTSIDE THE RIGHT-OF-WAY LINES COVERED BY WORK AGREEMENT OR SLOPE EASEMENT. QUANTITY CALCULATIONS FOR SEEDING AND MULCHING ARE BASED ON THESE LIMITS.

**ENVIRONMENTAL WORK**

BASED ON ENVIRONMENTAL STUDIES WITH TESTING CONDUCTED BY ODOT AND/OR FOR REGULATORY AGENCIES PETROLEUM CONTAMINATED SOILS WILL BE ENCOUNTERED DURING THE EXCAVATIONS FOR CONSTRUCTION ACTIVITIES AT THE SITES LISTED BELOW. THE ESTIMATED QUANTITIES HAVE BEEN INCLUDED IN THE GENERAL SUMMARY FOR THIS WORK. ALL EXCAVATIONS AT THE AFOREMENTIONED LOCATION SHALL BE PAID FOR UNDER THE ORIGINAL PLAN BID ITEMS.

1. THOMAS RICHARDS- 2578 SR 60, KILLBUCK, OH 44637
- ALL EXCAVATED MATERIALS WITHIN THE AFOREMENTIONED LIMITS MAY BE STOCKPILED IN AN AREA PROVIDED BY THE CONTRACTOR. THE CONTRACTOR SHALL BE RESPONSIBLE FOR THE ENGINEER MAY PERMIT TEMPORARY STORAGE OF SUSPECTED CONTAMINATED SOILS ON AN IMPERMEABLE MEMBRANE. THE MEMBRANE WILL BE SURROUNDED BY BALES OF STRAW TO PREVENT THE SUSPECTED SOILS FROM COMING IN CONTACT WITH THE ORIGINAL SOILS. AN IMPERMEABLE MEMBRANE WILL BE PLACED OVER THE STOCKPILE TO PREVENT CONTACT WITH PRECIPITATION AND/OR SURFACE RUN-OFF. AS A TEMPORARY STORAGE ALTERNATIVE, THE ENGINEER MAY PERMIT THE CONTRACTOR TO DIRECT LOAD THE EXCAVATED SOILS INTO TRUCKS, OR AS A THIRD ALTERNATIVE, THE CONTRACTOR MAY PLACE THE MATERIAL IN LEAK-PROOF, COVERED CONTAINERS PROVIDED BY THE CONTRACTOR. THE MATERIAL WILL REMAIN ON-SITE UNTIL ANALYTICAL RESULTS ARE RECEIVED BY THE ENGINEER.
- THIS MATERIAL WILL BE PROPERLY TESTED (FOR DISPOSAL), TRANSPORTED, AND DISPOSED OF IN A LICENSED (BY THE OHIO LOCAL HEALTH DEPARTMENT) AND PERMITTED (BY THE OHIO ENVIRONMENTAL PROTECTION AGENCY) SOLID WASTE FACILITY.

IF EXCAVATIONS WITHIN THE AFOREMENTIONED LIMITS REQUIRE DEWATERING FOR CONSTRUCTION PURPOSES, THE CONTRACTOR WILL Dewater, CONTAINERIZE, TEST THE WATER (FOR DISPOSAL) AND DISPOSE OF BY METHODS APPROVED BY THE ENGINEER. THE CONTRACTOR WILL OBTAIN ALL THE NECESSARY PERMITS AND APPROVALS AND SHALL BE RESPONSIBLE TO STORE, TRANSPORT AND DISPOSE OF THE WATER IN ACCORDANCE WITH APPLICABLE LOCAL, STATE OR FEDERAL REGULATIONS.

THE CONTRACTOR WILL FURNISH ALL THE LABOR, EQUIPMENT, AND MATERIALS NECESSARY TO PROPERLY HANDLE, STORE, TEST (FOR DISPOSAL), TRANSPORT, AND DISPOSAL, INCLUDING ANY REQUIRED PERMITS, APPROVALS, OR FEES. WITHIN THE AFOREMENTIONED LOCATION, PAYMENT FOR THIS WORK WILL BE MADE AT THE CONTRACT PRICE BID PER TON, PER GALLON, PER CUBIC YARD AND PER YD<sup>3</sup>. THE FOLLOWING EXCAVATION QUANTITIES HAVE BEEN INCLUDED IN THE GENERAL SUMMARY FOR THE WORK NOTED ABOVE:

- 690E65018 ITEM SPECIAL - WORK INVOLVING PETROLEUM CONTAMINATED SOIL TON
- 690E65024 ITEM SPECIAL - WORK INVOLVING REGULATED WATER GAL

DATE

HOL-60-2.99

10

10

**S.R. 60 - PLAN AND PROFILE**

HOL-60-2.99

10

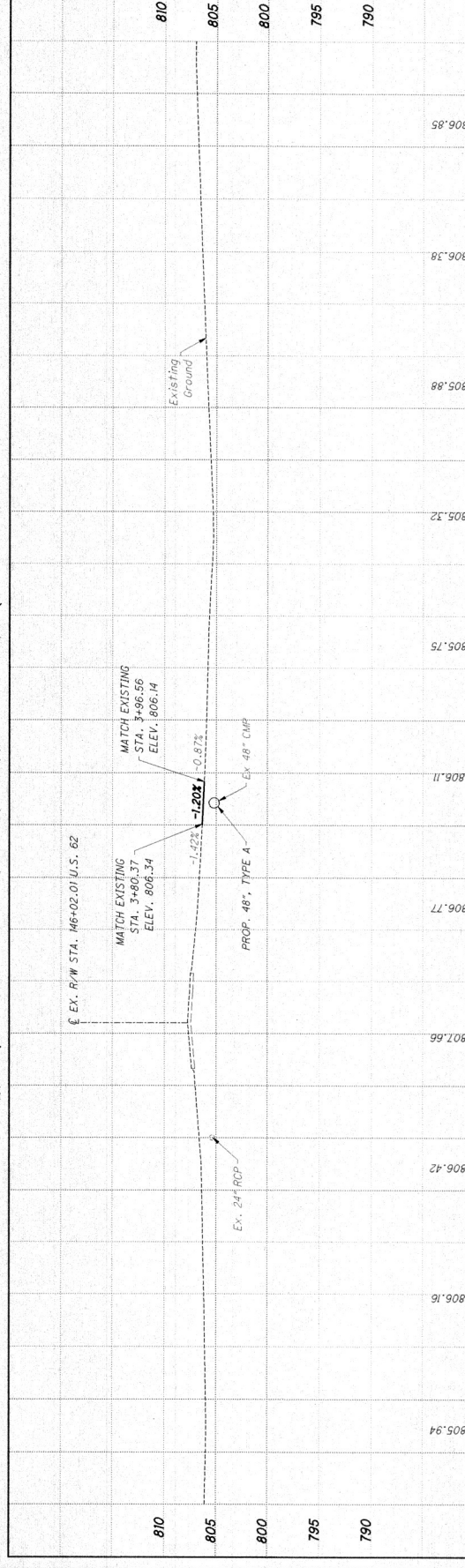
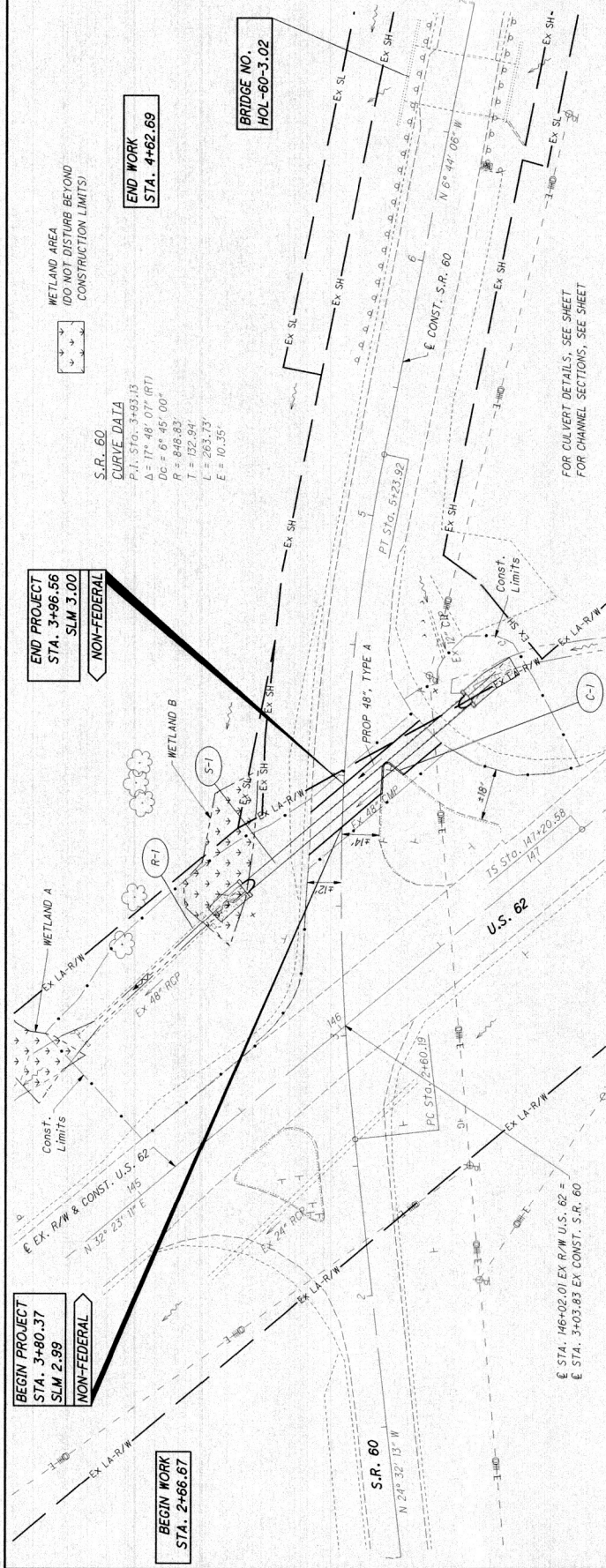

DATE

HOL-60-2.99

10





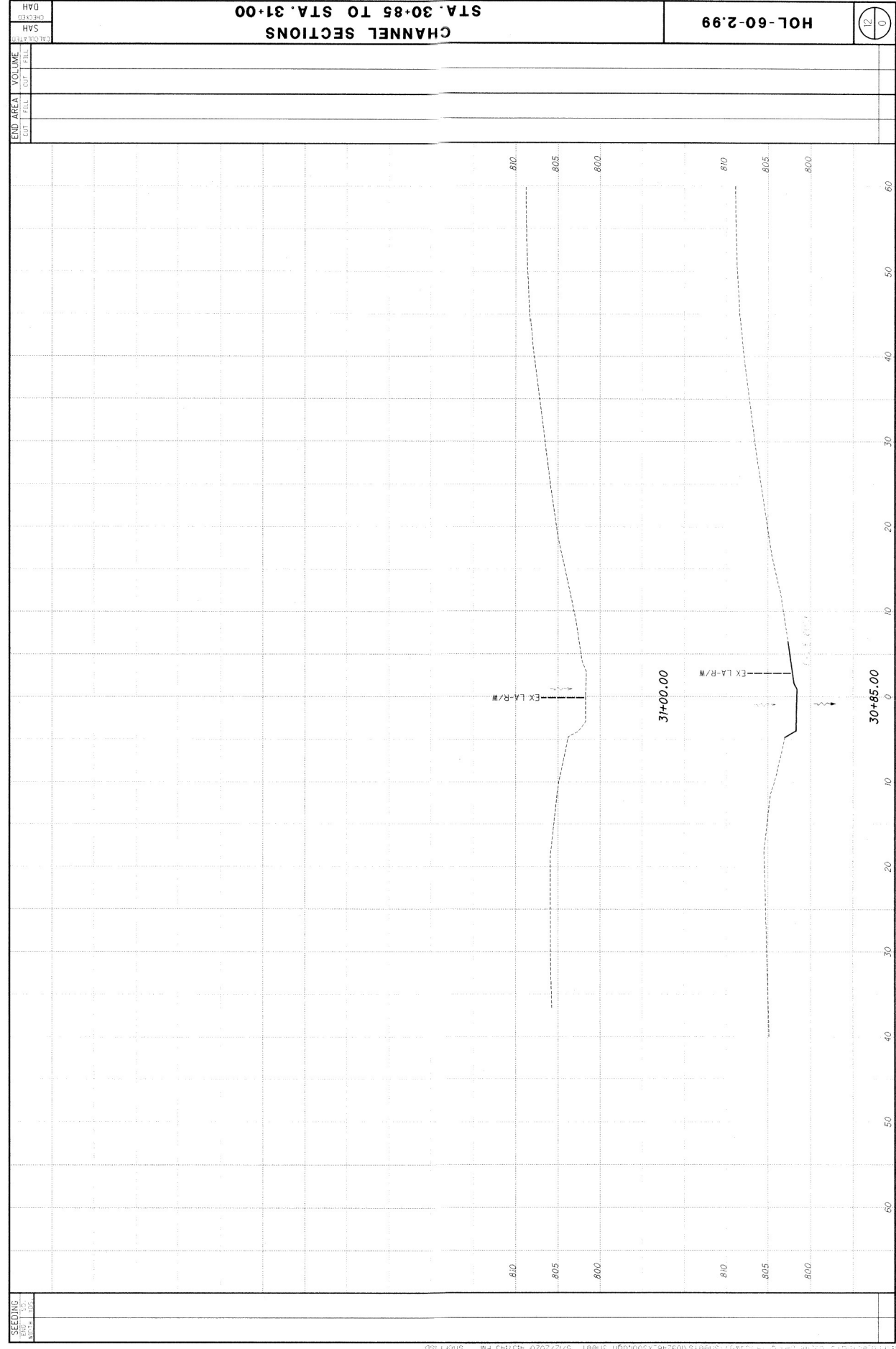
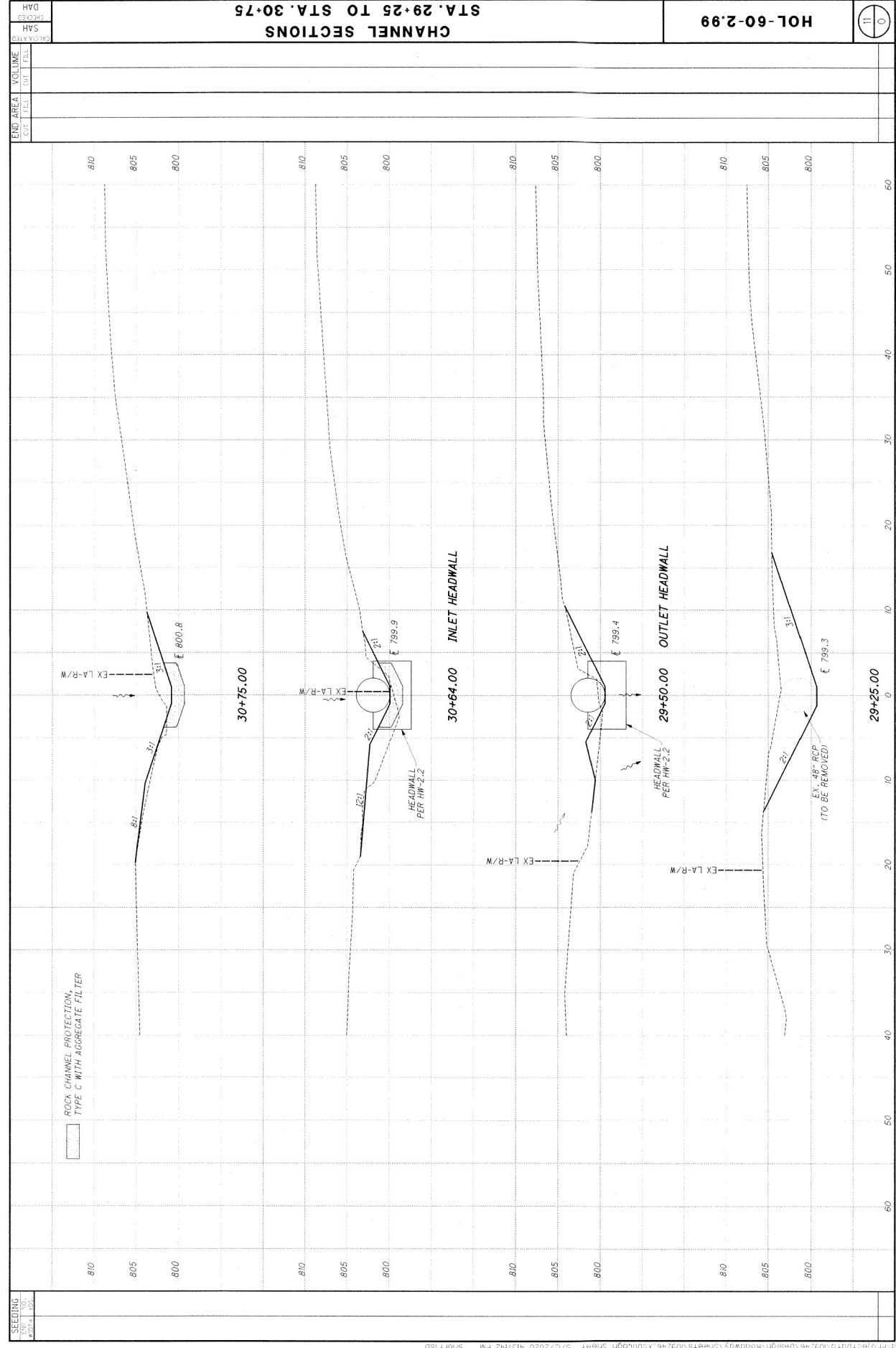
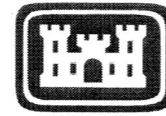



TABLE D. DISCHARGE AND FILL QUANTITIES

Aquatic Resource ID	Station	Description of Impacts/Activities Within OHWM	STREAMS				Existing Culvert		Existing Culvert Replaced (overlap)		Permanent Fill Within/Below OHWM						Total Permanent Fill Within OHWM			Total Temporary Fill Within OHWM			TOTAL IMPACT (Upstream to Downstream)		TOTAL NEW IMPACT (Total Impact Minus Pre-Existing Impacts)																									
			Total Length Within Project Area	Stream Width (LF)	Stream Depth (LF)	Length (LF)	Volume (CY)	Proposed RCP		Proposed Earthfill, Granular, or Embankment Fill		Length (LF)	Area (AC)	Volume (CY)	Length (LF)	Area (AC)	Volume (CY)	Length (LF)	Area (AC)	Volume (CY)	Length (LF)	Area (AC)	Volume (CY)	Length (LF)	Area (AC)	Volume (CY)	Length (LF)	Area (AC)	Volume (CY)	Length (LF)	Area (AC)																			
								Length (LF)	Area (AC)	Length (LF)	Area (AC)																					Length (LF)	Area (AC)	Length (LF)	Area (AC)	Length (LF)	Area (AC)	Length (LF)	Area (AC)	Length (LF)	Area (AC)	Length (LF)	Area (AC)							
N/A																																																		
SUM:																																																		
WETLANDS, JURISDICTIONAL DITCHES, PONDS																																																		
Aquatic Resource ID	Station	Description of Impacts/Activities within Wetland Boundary	Total Acreage Within Project Area	Width (LF)	Depth (LF)	Existing Culvert		Existing Culvert Replaced (overlap)		Permanent Fill Within Wetland Boundary						Total Permanent Fill Within Wetland Boundary			Total Temporary Fill Within Wetland Boundary			TOTAL IMPACT		TOTAL NEW IMPACT (Total - Existing)																										
						Length (LF)	Volume (CY)	Length (LF)	Volume (CY)	Length (LF)	Area (AC)	Volume (CY)	Length (LF)	Area (AC)	Volume (CY)	Length (LF)	Area (AC)	Volume (CY)	Length (LF)	Area (AC)	Volume (CY)	Length (LF)	Area (AC)	Volume (CY)	Length (LF)	Area (AC)	Volume (CY)	Length (LF)	Area (AC)	Volume (CY)	Length (LF)	Area (AC)	Volume (CY)	Length (LF)	Area (AC)	Volume (CY)	Length (LF)	Area (AC)	Volume (CY)											
Wetland A	28-54.80	Grading, Clean Fill	0.001	N/A	1	0.000	0.000	0.000	0.000	N/A	0.000	0.000	0.000	0.001	0.001	1.660	N/A	N/A	0.001	0.001	1.660	N/A	N/A	0.000	0.000	0.000	0.000	0.000	0.000	0.000	0.000	0.000	0.000	0.000	0.000	0.000	0.000	0.000	0.000	0.000	0.000	0.000	0.000	0.001	0.001	0.001	0.001			
Wetland B	28-42.19	Culvert Removal, Grading, RCP, Culvert Replacement	0.01	N/A	1	114.000	114.000	114.000	0.65000	N/A	0.002	4.16000	N/A	N/A	0.076	12.26000	N/A	N/A	0.079	126.480	0.079	126.480	0.000	0.000	0.000	0.000	0.000	0.000	0.000	0.000	0.000	0.000	0.000	0.000	0.000	0.000	0.000	0.000	0.000	0.000	0.000	0.000	0.000	0.000	0.000	0.000	0.0764	0.0764	0.0764	0.0764
SUM:																																																		

LF = linear feet; AC = acres; CY = cubic yards; RCP = rock channel protection or the like (specify if different, i.e. concrete block matting); NA = Not Applicable



U.S. Army Corps of Engineers  
 Huntington District

Permit Number: LRH-2020-00737-WAL

Name of Permittee: The Ohio Department of Transportation

Date of Issuance: 10 November 2020

Upon completion of the activity authorized by this permit and any mitigation required by the permit, sign this certification and return it to the following address:

U.S. Army Corps of Engineers  
 Huntington District  
 Ohio Regulatory Transportation Office  
 Building 10 / Section 10  
 PO Box 3990  
 Columbus, Ohio 43218-3990

Please note that your permitted activity is subject to a compliance inspection by an U.S. Army Corps of Engineers representative. If you fail to comply with this permit you are subject to permit suspension, modification, or revocation.

I hereby certify that the work authorized by the above-referenced permit has been completed in accordance with the terms and conditions of the said permit, and required mitigation was completed in accordance with the permit conditions.

Signature of Permittee

Date