

# HOLMES COUNTY DEDICATION PLAT OF GLENMONT-WESTERN ROAD S.H. (I.C.H.) No. 676

GLENMONT VILLAGE

DANVILLE-EDLAM-SHREVE RD

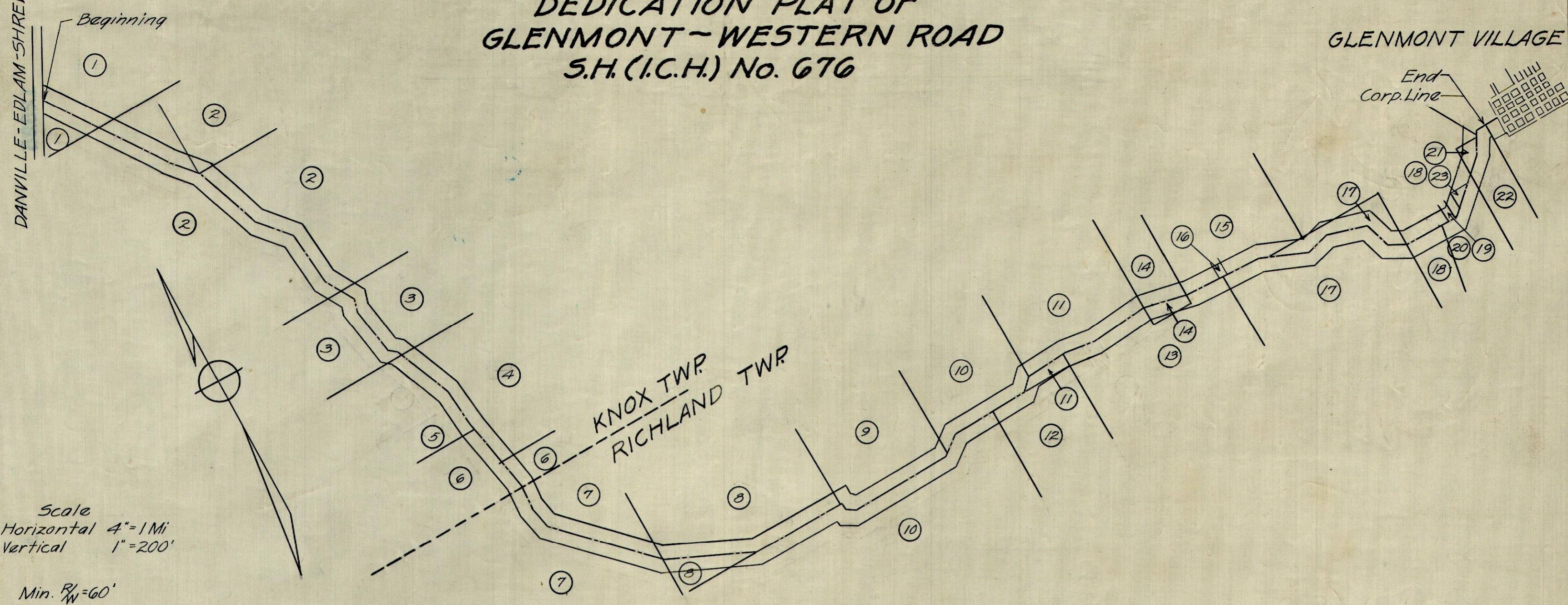

Scale  
Horizontal 4"=1 Mi  
Vertical 1"=200'  
Min. P<sub>W</sub>=60'

We, the undersigned owners of the above described property, dedicate the same to public use for road and other public purposes consistent therewith clear of all obstructions which interfere with the improvement and/or maintenance of the highway at the time of improvement.

Parcel No.	Owners	Witnesses	Parcel No.	Owners	Witnesses
21	S. L. Mackey	L. Mast E. Fry	7	L. P. Young	L. Mast E. Fry
21	Bertha L. Mackey	L. Mast E. Fry	11	Dora E. Young	L. Mast E. Fry
23	Bella Conner	L. Mast E. Fry	9	Wallis Conner	L. Mast E. Fry
19	John Jones	L. Mast E. Fry	13	Charles J. Dete	L. Mast E. Fry
19	Lucy Jones	L. Mast E. Fry	15	S. W. Augsburg	L. Mast E. Fry
18	Harvey Clark	L. Mast E. Fry	15	Laura Augsburg	L. Mast E. Fry
18	Lola Clark	L. Mast E. Fry	4	<i>(Signature)</i>	L. Mast E. Fry
16	Paul S. Neal	L. Mast E. Fry	6	<i>(Signature)</i>	L. Mast E. Fry
16	Bernice Neal	L. Mast E. Fry	6	<i>(Signature)</i>	L. Mast E. Fry
14	J. A. Marks	L. Mast E. Fry			
14	Kate Marks	L. Mast E. Fry			
12	Willis Manchester	L. Mast E. Fry			
11	Geo Manchester	L. Mast E. Fry			
11	Maggie Manchester	L. Mast E. Fry			
10	Charles Manchester	L. Mast E. Fry			
10	Lizzie Manchester	L. Mast E. Fry			
8	Bertha Weaver	L. Mast E. Fry			
7	Frieda Lang	L. Mast E. Fry			
3	Herman Young	L. Mast E. Fry			
3	Erma Young	L. Mast E. Fry			
2	John M. Young	L. Mast E. Fry			
2	Mabel Young	L. Mast E. Fry			

County of Holmes  
State of Ohio.  
On this 29 day of May 1936, before me a Notary Public in and for said County and State personally appeared: S.L. Mackey and Bertha L. Mackey, husband and wife; John Jones and Lucy Jones, brother and sister; Harvey Clark and Lola Clark; husband and wife; Paul S. Neal and Bernice Neal; husband and wife; J.A. Marks and Kate Marks, husband and wife; Willis Manchester; Geo. Manchester and Maggie Manchester, husband and wife; Charles J. Manchester and Lizzie Manchester, husband and wife; Bertha Weaver; Frieda Lang; Herman Young and Erma Young, husband and wife; John M. Young and Mabel Young, husband and wife; L.P. Young and Dora E. Young, husband and wife; Walter Ruble; S.W. Augsburg and Laura Augsburg, husband and wife; Bell Conner; Charles Dete; The Farmers and Savings Bank, by D.C. Nouse Cashier; L.F. Young and Mona Young, husband and wife; who acknowledged the signing of this plat to be their voluntary act and deed for the purposes hereon mentioned. Witness my hand this 29 day of May, 1936.

JUSTICE OF PEACE, HOLMES COUNTY, OHIO.  
  
APPROVED AND ACCEPTED BY ME  
THIS 29 DAY OF MAY 1936.  
  
*Karl Snyder*  
COUNTY ENGINEER

OFFICE OF COUNTY COMMISSIONERS  
HOLMES COUNTY, OHIO.  
This plat has been approved and accepted by us  
this 29 day of May, 1936.

*J. A. Snyder*  
*J. L. Lisle*  
*John Schoppers*

BOARD OF COUNTY COMMISSIONERS

ATTEST- *H. E. Gray*  
COUNTY AUDITOR

RECORDING DATA  
Recorded in Plat Book Vol. 2 Page 4  
of County Plat Records. Date July 20, 1936  
  
*Geneva D. Crissey*  
COUNTY RECORDER