

**DESIGN DESIGNATION**

CURRENT ADT (1989) = 1200  
 DESIGN YEAR ADT (2009) = 2256  
 D. H. V. = 192  
 D = 60%  
 T = 5%  
 DESIGN SPEED = 55 MPH  
 LEGAL SPEED = 55 MPH  
 FUNCTIONAL CLASSIFICATION COLLECTOR (RURAL)  
 DESIGN EXCEPTIONS APPROVAL DATE  
 VERTICAL ALIGNMENT 5/27/88  
 STOPPING SIGHT DISTANCE 5/27/88

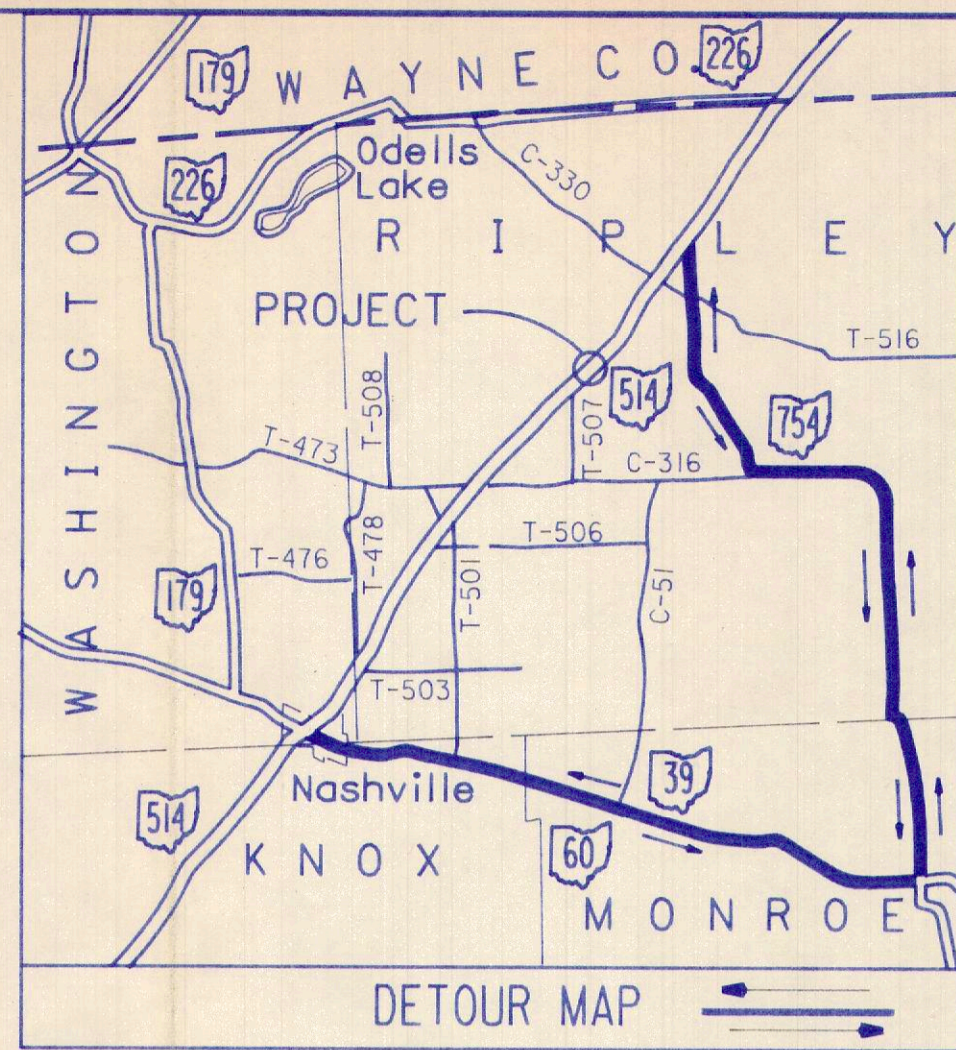

STATE OF OHIO  
 DEPARTMENT OF TRANSPORTATION

**HOL-514-9.30**

RIPLEY TOWNSHIP

HOLMES COUNTY

HOL-514-9.30

BRS-435 (4)

OHIO

FHWA REGION 5

FEDERAL PROJECT



BRS-435 (4)

1989 SPECIFICATIONS

The standard specifications of the State of Ohio, Department of Transportation, including changes and supplemental specifications listed in the proposal shall govern this improvement.

I hereby approve these plans and declare that the making of this improvement will require the closing to traffic of the highway and that detours will be provided as indicated on the plans.

*Jerry Hayes*

COUNTY LINE ---  
 TOWNSHIP LINE ---  
 SECTION LINE ---  
 CORPORATION LINE --- OR ---  
 FENCE (EXISTING) \* \* \* (PROPOSED) \* \* \*  
 CENTERLINE ---  
 TREES (TO BE REMOVED) (TO BE REMOVED)  
 UTILITY POLES: TELEPHONE (TO BE REMOVED) POWER (TO BE REMOVED) LIGHT (TO BE REMOVED)

LIMITED ACCESS (ONLY) --- L/A ---  
 RIGHT OF WAY (ONLY) --- RW ---  
 LIMITED ACCESS & RIGHT OF WAY --- LA & RW ---  
 EXISTING RIGHT OF WAY ---  
 PROPERTY LINE --- R --- (IN EXISTING FENCE) --- R-X ---  
 RAILROAD --- OR ---  
 GUARDRAIL (EXISTING) --- (PROPOSED) ---

**CONVENTIONAL SIGNS**

**INDEX OF SHEETS**

TITLE SHEET	1
TYPICAL SECTION	2
GENERAL NOTES	3
PAVEMENT DETAILS	4
DRIVE DETAILS	5
CALCULATIONS	6
GENERAL SUMMARY	7
PLAN AND PROFILE	8
CROSS SECTIONS	9, 10
STRUCTURES, 20' SPAN AND UNDER	11
RIGHT OF WAY PLAN	

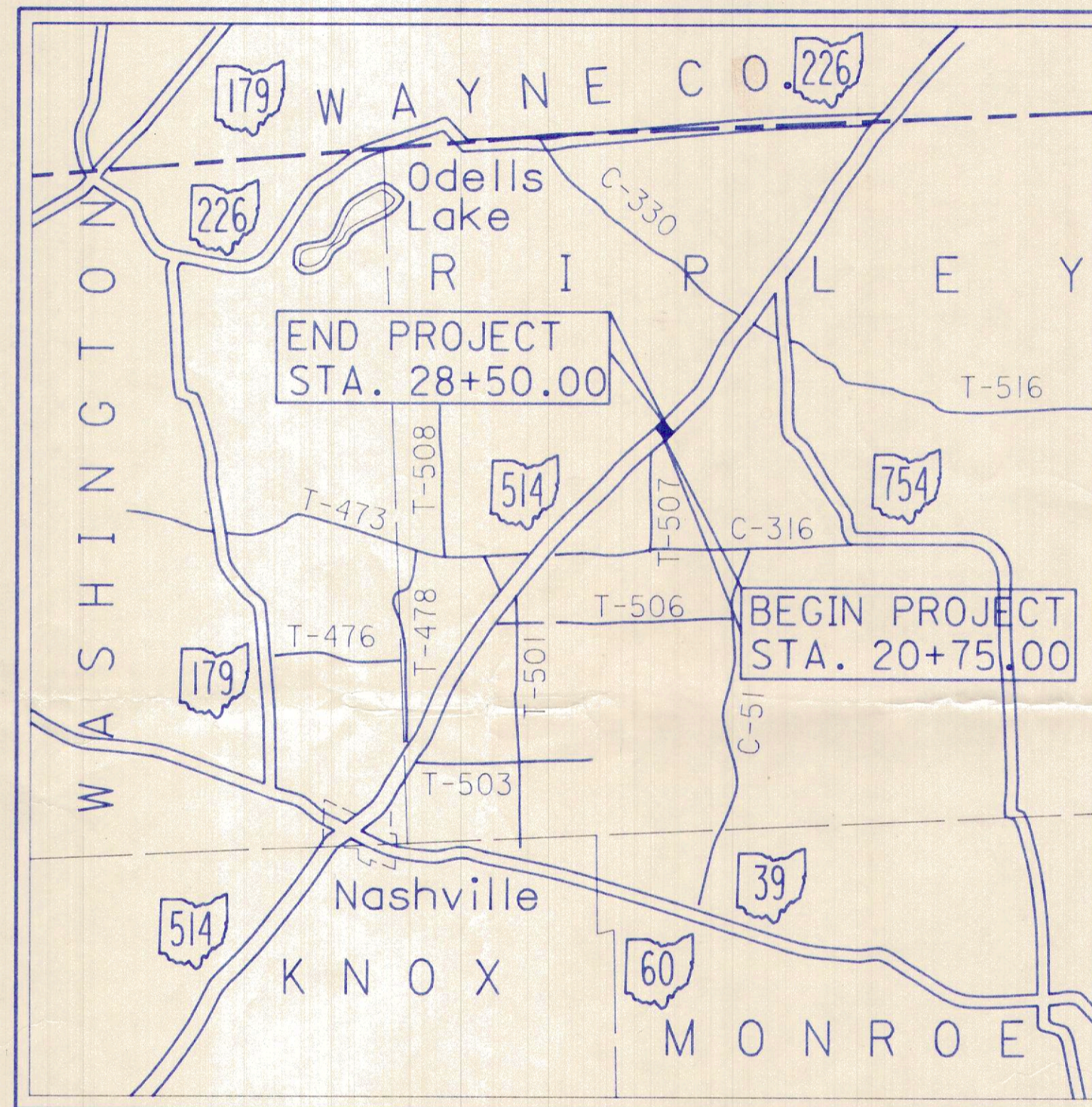

LOCATION MAP

SCALE IN MILES

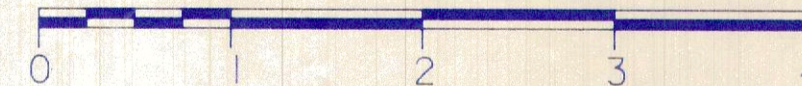

**LINE DATA**

BEGIN PROJECT = STATION 20+75.00  
 END PROJECT = STATION 28+50.00  
 NET LENGTH OF PROJECT = 775.00 LIN. FT. OR 0.147 MILE

BEGIN WORK = STATION 20+50.00  
 END WORK = STATION 30+50.00  
 TOTAL NET LENGTH OF WORK = 1000.00 LIN. FT. OR 0.189 MILE

**UNDERGROUND UTILITIES**  
 2 WORKING DAYS  
**BEFORE YOU DIG**  
 CALL 800-362-2764 (TOLL FREE)  
 OHIO UTILITIES PROTECTION SERVICE  
 NON-MEMBERS  
 MUST BE CALLED DIRECTLY

PORTION TO BE IMPROVED ---  
 STATE & FEDERAL ROUTES ---  
 OTHER ROADS ---

**SCALES**

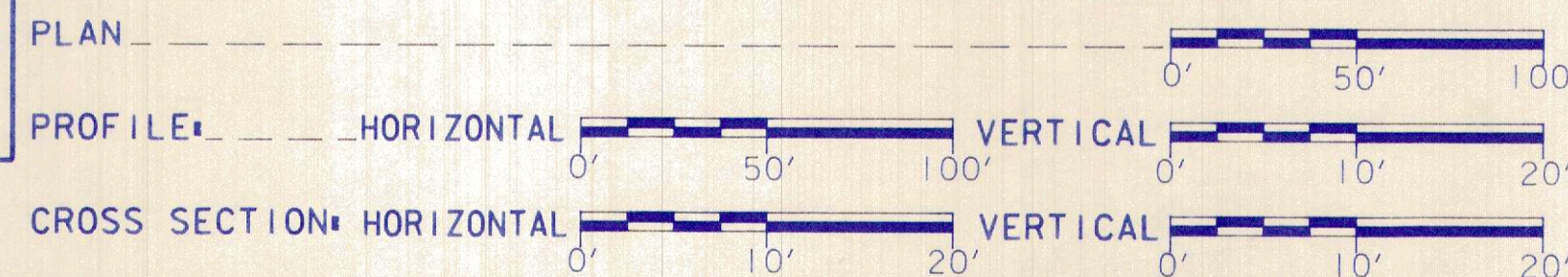

SUPPLEMENTAL SPECIFICATIONS	
802	5-4-88
847	10-17-88
947	10-17-88

APPROVED \_\_\_\_\_  
 DATE \_\_\_\_\_ DISTRICT DEPUTY DIRECTOR OF TRANSPORTATION

APPROVED \_\_\_\_\_  
 DATE \_\_\_\_\_ ENGINEER, BUREAU OF BRIDGES AND STRUCTURAL DESIGN

APPROVED \_\_\_\_\_  
 DATE \_\_\_\_\_ DEPUTY DIRECTOR, PLANNING AND DESIGN

APPROVED \_\_\_\_\_  
 DATE \_\_\_\_\_ DIRECTOR, DEPARTMENT OF TRANSPORTATION

PLAN PREPARED BY:  
 OHIO DEPARTMENT OF TRANSPORTATION  
 DISTRICT II

SEAL

PROJECT: HOL-514-9.30  
 DATE OF LETTING \_\_\_\_\_ 19 \_\_\_\_\_, CONTRACT NO. \_\_\_\_\_

SUPPLEMENTAL PRINTS OF STANDARD CONSTRUCTION DRAWINGS					
BP-5	10-1-87	HW-4A	4-1-80	MT-99.10	11-14-86
BP-6	10-1-87	HW-4B	4-1-80		
GR-1	1-11-85	MC-1	6-13-69		
GR-2B	2-5-82	MC-4	7-26-76		
GR-4	2-5-82	MC-10	5-1-76		
		MC-11	8-1-78		

DEPARTMENT OF TRANSPORTATION  
 FEDERAL HIGHWAY ADMINISTRATION

APPROVED

DIVISION ADMINISTRATOR

DATE



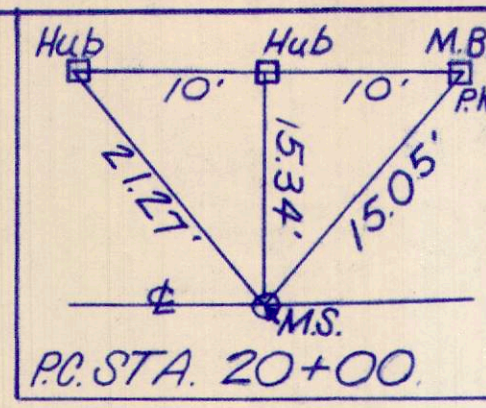

**CURVE DATA**  
 P.I. STA. 22+37.89  
 $\Delta = 2^\circ 56' \text{ Lt.}$   
 $D_s = 0^\circ 37'$   
 $T = 237.89'$   
 $L = 475.68'$   
 $R = 9291.21'$   
 $E = 3.04'$

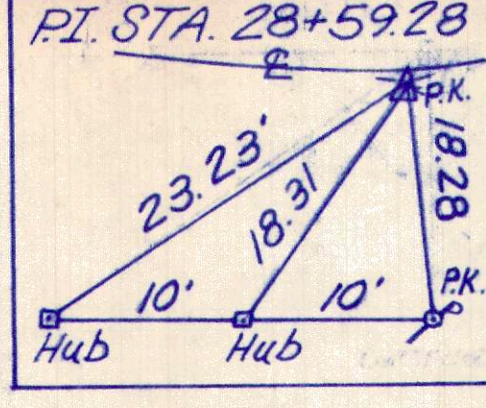
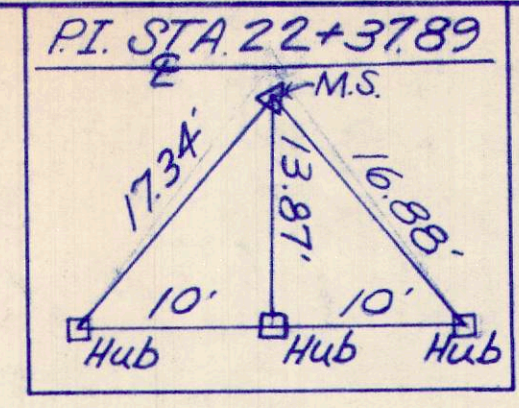

**CURVE DATA**  
 P.I. STA. 28+59.28  
 $\Delta = 6^\circ 58' 20" \text{ Lt.}$   
 $D_s = 2^\circ 07' 15"$   
 $T = 164.58'$   
 $L = 328.75'$   
 $R = 2701.57'$   
 $E = 5.91'$

QUANTITIES	
Calc. by:	Chkd. by:
Date:	Date:

FHWA REGION	STATE	PROJECT
5	OHIO	

HOL-514-9.30

**EXISTING STRUCTURE DATA**  
 Type: Concrete Beam Bridge with 6" Concrete Slab  
 Span: 22'-0" Clear  
 Roadway: 22' f/f of Railing  
 Skew: 20° L.F.  
 Surface Course: Bituminous  
 To Be Removed

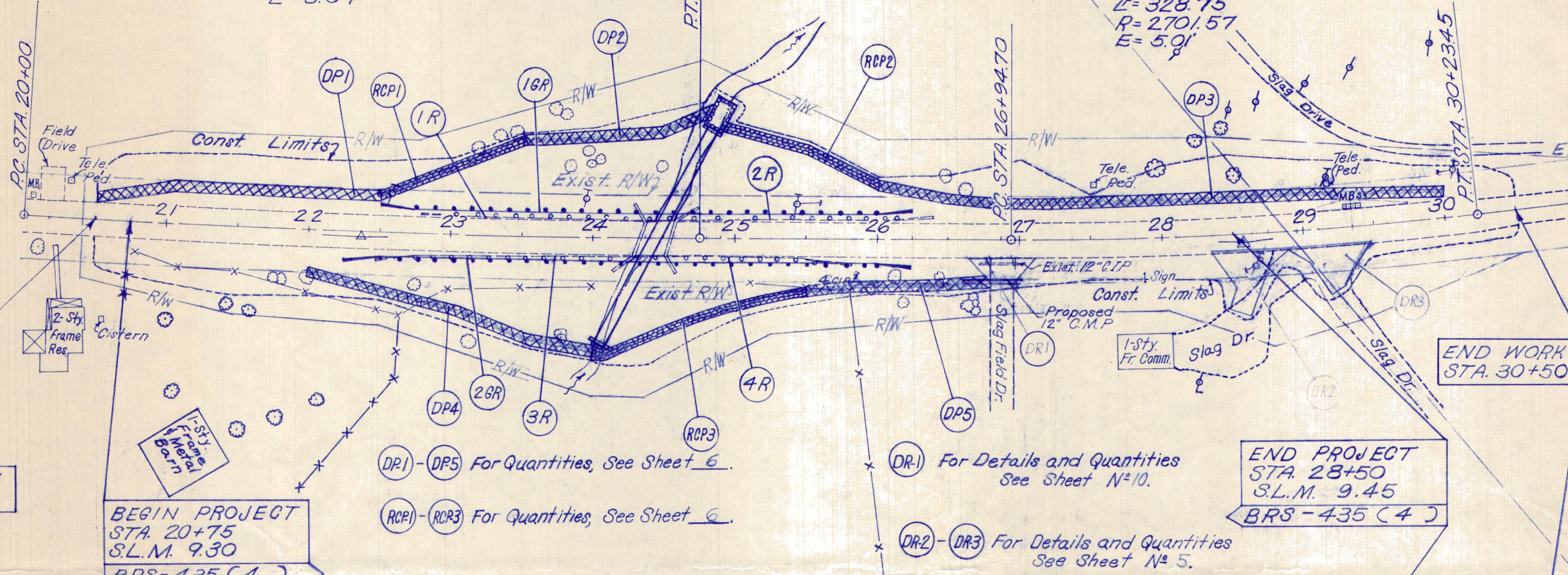

Ref. No.	STATION	SIDE	GUARDRAIL				
			ITEM 606		802	ITEM 202	
			Guardrail Type 5	Anchor Assembly Type A	Barrier Reflectors Type A (W)	Guardrail Removed	
	From	To	LIN. FT.	EACH	EACH	LIN. FT.	
	1GR	22+50	26+254	Lt.	325	2	5
	2GR	22+25	26+245	Rt.	350	2	5
	1R	22+80.5	24+36.5	Lt.			156
	2R	24+58	26+40	Lt.			182
	3R	22+48	24+30	Rt.			182
	4R	24+52	25+82	Rt.			130
	<b>TOTAL</b>				<b>675</b>	<b>4</b>	<b>10</b>

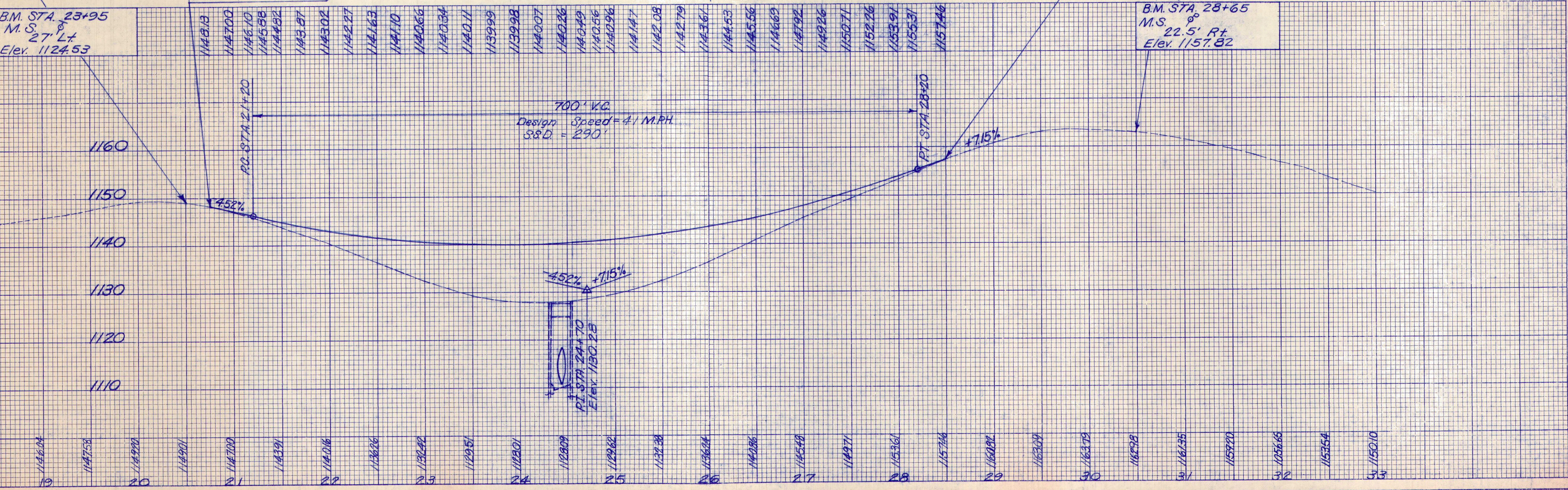











QUANTITIES  
 Calc. by: Chkd. by:  
 Date: Date:

FHWA REGION	STATE	PROJECT
5	OHIO	

HOL-514-9.30

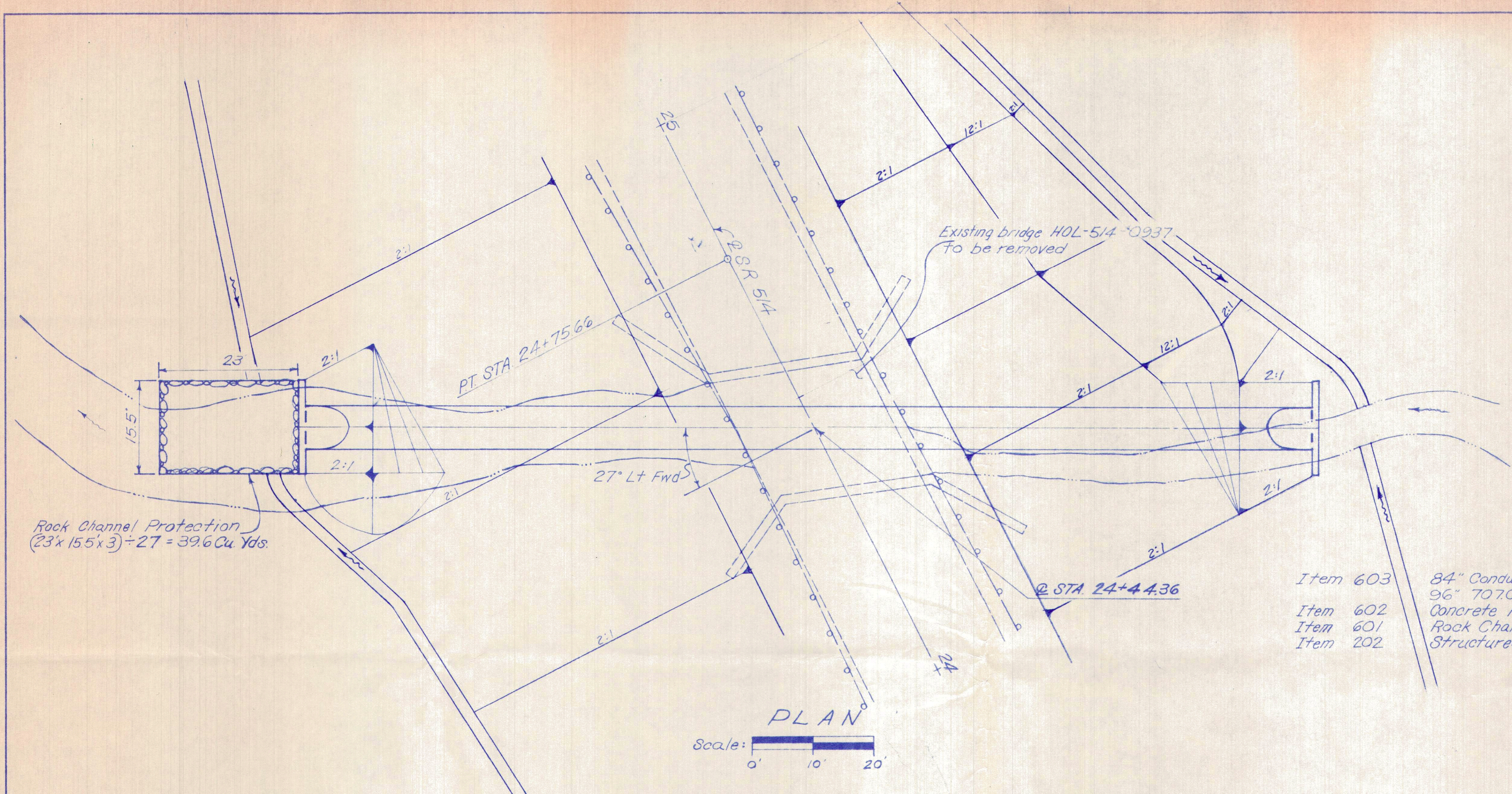

**QUANTITIES**

Item 603	84" Conduit Type A, 706.02 2000 D-Load or 96" 707.09 (0.109)	170	Lin. Ft.
Item 602	Concrete Masonry	8.8	Cu. Yd.
Item 601	Rock Channel Protection, Type A with Filter	40	Cu. Yd.
Item 202	Structures Removed		Lump

Area 1.25 Sq. Mi.  
 Q25 439 C.F.S.  
 Q100 612 C.F.S.  
 HW25 1120.9'  
 HW100 1125.0'

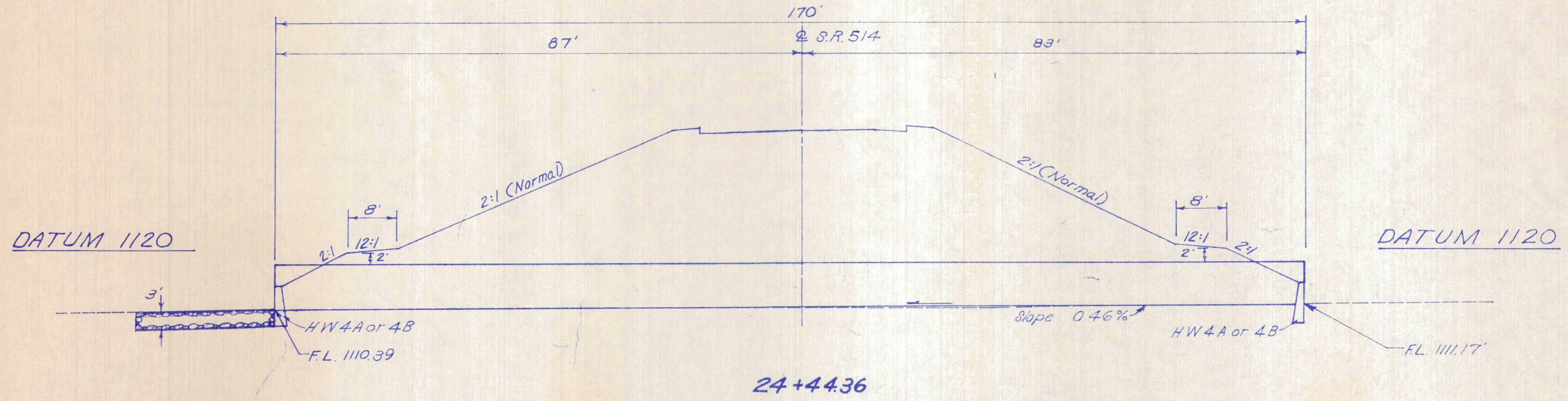

**STA. 24+44.36  
 PIPE CONDUIT**